

LEGEND

- CLAIM POST - 3" DIA X 5' PVC PIPE
- LOCATION MONUMENT - 3" DIA X 50' PVC PIPE W/NOTICE ATTACHED
- WC# WITNESS CORNER

WITNESS CORNER	TRUE CORNER BEARS	
1	N 89° 47' 01" E	117.5'
2	S 89° 43' 21" W	90.9'
3	N 79° 01' 41" E	81.7'
4	WEST	192.0'
5	WEST	18.0'
6	WEST	193.0'
7	S 16° 00' 30" E	102.0'
8	S 73° 12' 56" E	253'
9	EAST	100.0'

LOCATOR:
BOB GOODSON
169 GEORGE STREET
ELKO, NEVADA, 89801

LOCATION DATES:
GUTSY 1311 THRU 1334 MAY 6, 1987
GUTSY 1335 THRU 1382 MAY 7, 1987

MONUMENTATION COMPLETED:
MAY 29, 1987

NOTE:
SURVEYED BY A COMBINATION OF EPM & BRUNTON & CHAIN METHODS

T. 32N., R. 51 & 52E., M.D.M.
EUREKA COUNTY

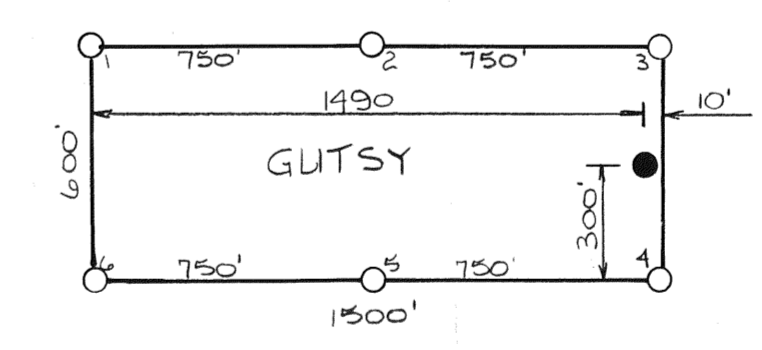

TYPICAL CLAIM DIMENSIONS FOR SECTION 30

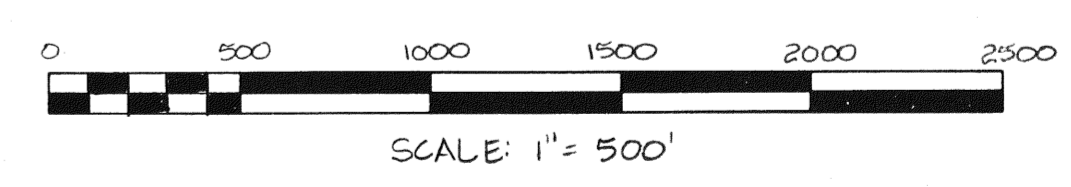

FILED AT THE REQUEST OF Bob Goodson
on June 5, 1987 at 1 mins past 10 A.M.
EUREKA COUNTY, NEVADA RECORDS OF M.N. REBALEATI, Recorder
File No. 108344 Fee \$ 4,080.00

NO.	DATE	DESCRIPTION	CHK'D	APP'D
REVISIONS				
DRAWN BY		APPROVED BY		
JOB NO.		DATE		

MAP OF GUTSY NO. 1311 thru 1382 LODE MINING CLAIMS

SITUATED WITHIN
SECS. 7, 8, 17, 18, 19, 20, 30 & 31, T. 32N., R. 52 E.
AND
SECS. 12, 13, 24 & 25, T. 32N., R. 51 E., M.D.M.
EUREKA COUNTY, NEVADA

1987
12/1
7/1