

NOTES

- 1.) BEARINGS SHOWN ARE GRID AND REFERENCED TO THE NEVADA STATE PLANE COORDINATE SYSTEM, EAST ZONE (DISTANCES SHOWN ARE SURFACE, NOT SEA LEVEL)
- 2.) LOCATION MONUMENTS ARE 10' FROM END LINE OF CLAIM UNLESS OTHERWISE SHOWN
- 3.) SECTION CORNERS AND LINES ARE FROM THE NEVADA PROTRACTOR DIAGRAM (NO SECTION CORNERS WERE FOUND OR SET EXCEPT WHERE OTHERWISE SHOWN)
- 4.) A MODIFIED STATE PLANE COORDINATE SYSTEM HAS BEEN COMPUTED FOR APPLICATION IN THE USE OF FIELD MEASUREMENTS. THE MODIFIED SYSTEM INCORPORATES A COMBINATION FACTOR OF 0.999645365, WHICH WHEN MULTIPLIED BY A "MODIFIED" X AND Y VALUE STATE PLANE COORDINATE GIVES A TRUE X AND Y STATE PLANE COORDINATE - NEVADA EAST ZONE.

LEGEND

- — 3 1/2" x 3 1/2" x 4" WOOD POST LOCATION MONUMENT — MONUMENTS 10' FROM CLAIM ENDLINE
- — 3 1/2" x 3 1/2" x 4" WOOD POST ADJACENT TO 5/8" x 18" REBAR
- — SECTION CORNER FROM PROTRACTOR DIAGRAM - NO MONUMENT FOUND OR SET
- ◆ — MARKED STONE (FOUND)

LOCATION DATES

- NOVEMBER 15, 1987 — 61A, 62A, 69A, 70A
- NOVEMBER 16, 1987 — 74A
- NOVEMBER 17, 1987 — 102A
- NOVEMBER 18, 1987 — 71A, 72A

STATE OF WYOMING) S.S.
COUNTY OF FREMONT)

I, RICHARD D. INBERG, A REGISTERED LAND SURVEYOR OF THE STATE OF NEVADA HEREBY CERTIFY THAT THE ACCOMPANYING MAP REPRESENTS THE PLATTED FIELD NOTES OF A SURVEY MADE DURING THE PERIOD FROM NOVEMBER 15 TO NOVEMBER 18 OF WHICH I WAS IN RESPONSIBLE CHARGE AND IS A CORRECTLY DIMENSIONED REPRESENTATION OF SAID SURVEY.

Richard D. Inberg
NEVADA L.S. REGISTRATION NO. 05950

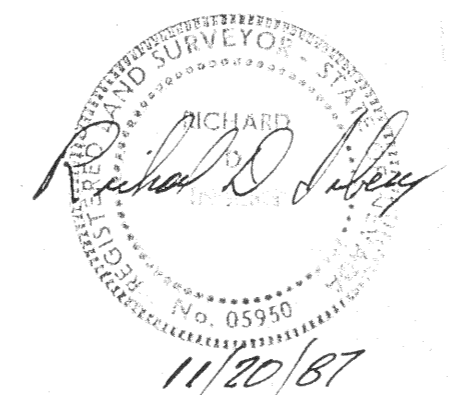

FILED AT THE REQUEST OF *Apex Surveying, Inc.*
on Nov 24 19 87, at 57 mms. past 10:14 A.M.
RECORDS OF EUREKA COUNTY, NEVADA M. N. REBALEATI, Recorder
File No. 114553 Fee \$ 20.00

<p>MAP OF THE AMENDED W1 LODE MINING CLAIMS CLAIMS 61A, 62A, 69A, 70A, 71A, 72A, 74A & 102A EUREKA COUNTY, NEVADA</p>
<p>LOCATED BY: TERRY ZENK AGENT FOR ATLAS PRECIOUS METALS INC. P.O. BOX 1207 MOAB, UTAH 84532 NOVEMBER 17, 1987</p>
<p>APEX SURVEYING INC. RIVERTON, WYOMING</p>

