

112439

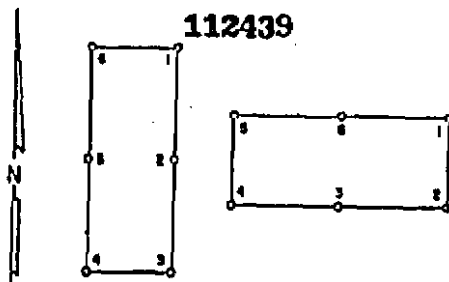

RECORDED AT THE REQUEST OF
ATLAS PRECIOUS METALS INC
 BOOK 165 PAGE 107

'87 OCT 13 P12:10

OFFICIAL RECORDS
 EUREKA COUNTY, NEVADA
 FILE NO. 112439

CERTIFICATE OF LOCATION - NEVADA

THE UNDERSIGNED, hereby certifies that ATLAS PRECIOUS METALS INC., by its Agent, the undersigned, does hereby locate the NORTH 74 Lode Mining Claim on this 8th day of August, 1987, situated in the Unknown Mining District, Eureka County, Nevada.

Said Claim is located in the SE(SW) (Quarter) Section(s) 21(22), Township 25 North, Range 50 East, Mt. Diablo P.M., and is more particularly described as follows, to wit:

Beginning at the northeast corner post No. 1,

Thence, <u>600</u> feet in a <u>S25°W</u> direction to Post No. 2, marked - <u>NORTH 74</u> - 2
Thence, <u>750</u> feet in a <u>N65°W</u> direction to Post No. 3, marked - <u>NORTH 74</u> - 3
Thence, <u>750</u> feet in a <u>N65°W</u> direction to Post No. 4, marked - <u>NORTH 74</u> - 4
Thence, <u>600</u> feet in a <u>N25°E</u> direction to Post No. 5, marked - <u>NORTH 74</u> - 5
Thence, <u>750</u> feet in a <u>S65°E</u> direction to Post No. 6, marked - <u>NORTH 74</u> - 6
Thence, <u>750</u> feet in a <u>S65°E</u> direction to Post No. 1, marked - <u>NORTH 74</u> - 1

the point of beginning and all posts being 3"x4" durable plastic pipe.

The number of linear feet claimed in length along the course of the vein from the point of discovery is 10 feet in a N 65°W direction and 1490 feet in a S65°E direction, together with 300 feet on each side of the center of the vein or lode for the entire length of the claim.

The general course of the vein or lode is N65°W and S65°E.

To tie this Claim to the Public Survey, begin at the SE corner, Section 33, Township 25 N., Range 50 E., Mt. Diablo P.M., and bear N65°W, 4669 feet and N25°E, 10459 feet to the northeast corner of this Claim.

The work of location consisted of making the maps as provided in NMS 517.040. Dated October 1 A.D., 1987, and filed in duplicate.

Atlas Precious Metals Inc.
 P.O. Box 1207
 Moab, Utah 84532

By: Richard D. Inberg
 Its Agent
 -Locator-

STATE OF WYOMING)
 COUNTY OF FREMONT) SS

Sworn to and acknowledged before me this 5th day of October, 1987, by Richard D. Inberg as Agent for Atlas Precious Metals Inc.

Robert W. Schlichting
 Notary Public

My Commission Expires:

May 25, 1988

