

BASIS OF BEARINGS

Bearing basis for this Parcel Map is Record of Survey, Document No. 104686.

NOTE

Due to finding original monuments at the SE corner and the S. 1/4 corner of Section 17 that were not found nor used on the survey for the Large Division Map of the E. 1/2 of Section 17 (Document No. 81925) and subsequent Parcel Map for Parcel "F" (Document No. 82268) and corners set thereby, this data could not be used for this survey except of lot size and shape and the location of streets and street easements. Corners erroneously set pertaining to Parcel "F" have been removed to avoid confusion. See Record of Survey, Document No. 104686.

OWNER'S CERTIFICATE

This is to certify that the undersigned, Earl A. Rasmussen and Lavernia C. Rasmussen are the owners of record of Lot 1 of Parcel "F" of the East 1/2 of Section 17, T. 20 N., R. 53 E., M. D. B. & M., and have consented to the preparation and recordation of our parcelling of said Lot 1 and do hereby reserve and set apart forever the easement for El Toro Avenue.

Earl A. Rasmussen *Lavernia C. Rasmussen*
Earl A. Rasmussen Lavernia C. Rasmussen

PLANNING COMMISSION APPROVAL

At a regular meeting of the Eureka County Planning Commission held on April 1, 1988, this map was approved for subdivision purposes pursuant to N. R. S. 278.461 to 278.469 inclusive.

Earl A. Rasmussen *Lavernia C. Rasmussen*
Chairman Clerk
Eureka County Planning Commission Eureka County

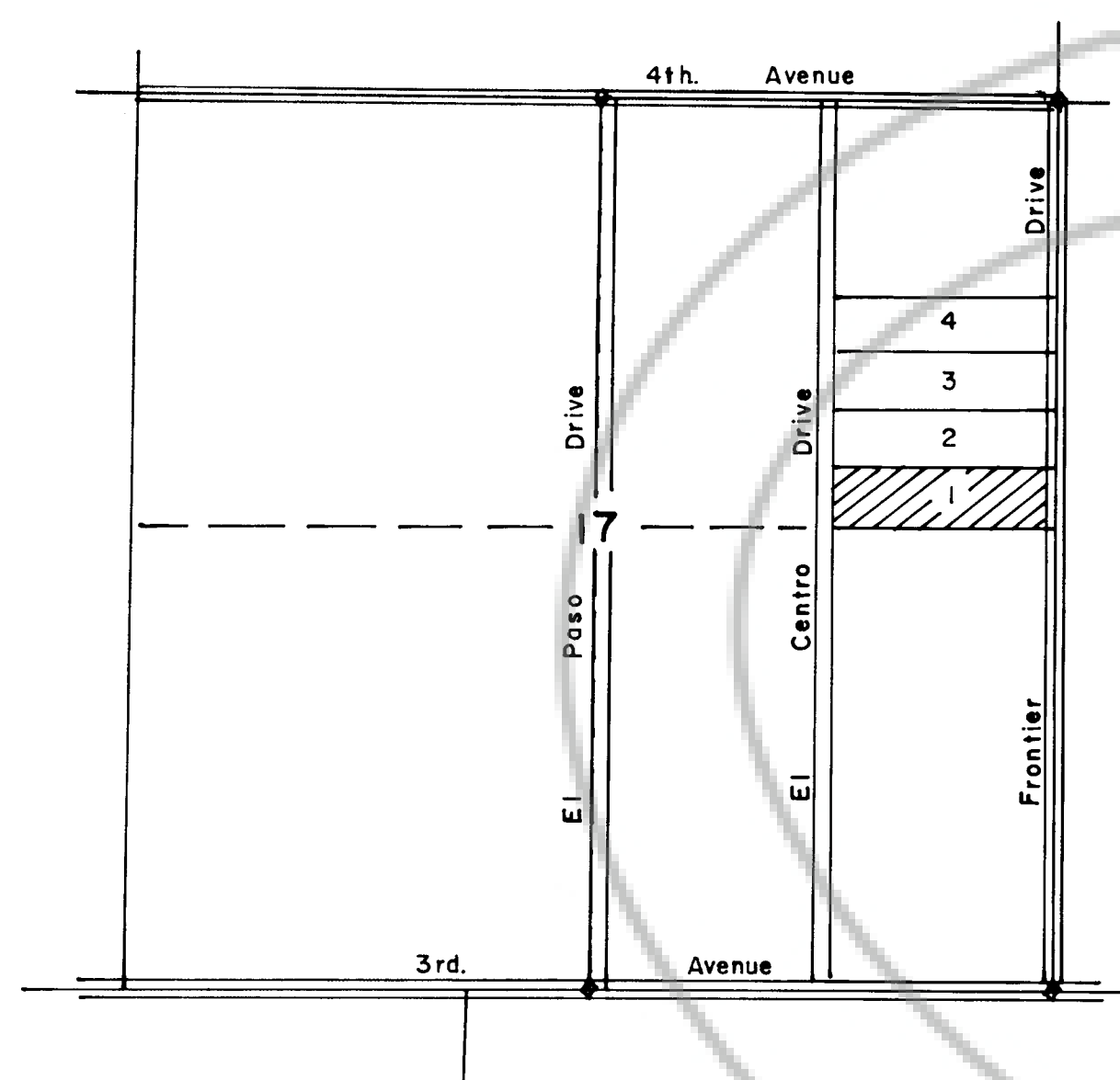

LOCATION SKETCH
PARCEL "F"

CONDITIONS

1. That all parcel lines and easements remain as shown to the Planning Commission until the map is recorded.
2. That all requirements of government agencies with permit authority be met.
3. That the streets shown on this Parcel Map be provided in accordance with Eureka County specifications relating to County Roads and their acceptance.

FLOOD ZONE

The parcels shown on this Parcel Map are in Flood Zone A as indicated on maps prepared by FEMA.

SURVEYOR'S CERTIFICATE

I, Ernest E. Muller, Sr., a Registered Land Surveyor in the State of Nevada, certify that:

1. This is a true and accurate representation of the lands surveyed by me at the instance of Earl A. Rasmussen.
2. The lands surveyed lie within the East 1/2 of Section 17, T. 20 N., R. 53 E., M. D. B. & M., and the survey was completed on the 19th day of October, 1987.
3. This plat complies with the applicable state statutes and any local ordinances.
4. The monuments are of the character shown and occupy the positions indicated, and are sufficient to retrace this survey.

Ernest E. Muller, Sr.
Ernest E. Muller, Sr., RLS 827
REGISTERED LAND SURVEYOR STATE OF NEVADA
2-10-88

RECORDER'S CERTIFICATE

File Number 117990 Fee: \$ 10.00
Filed for record at the request of Ernest E. Muller, Sr. on this 24 day of April, 1988 at 95 minutes past 2 o'clock P. M., Official Records of Eureka County, Nevada.

M. M. Rasmussen
Recorder

COUNTY COMMISSIONER'S APPROVAL

At a regular meeting of the Eureka County Commissioners held on April 20, 1988, this map, consisting of one sheet, was presented as a proposed Parcel Map of Lot 1 of Parcel "F" of the East 1/2 of Section 17, T. 20 N., R. 53 E., M. D. B. & M., located in Eureka County, Nevada by Earl A. and Lavernia C. Rasmussen.

Ernest E. Muller, Sr. *Lavernia C. Rasmussen*
Chairman Clerk
Eureka County Commissioners Eureka County

MAP AREA

Total area of this Parcel Map is 9.526± Acres.

PARCEL MAP
FOR
E. A. and L. C. RASMUSSEN
PARCELLING OF LOT 1
OF PARCEL "F" OF LARGE DIVISION MAP
E. ½ SEC. 17, T. 20 N., R. 53 E., M.D.B. & M.
EUREKA COUNTY, NEVADA

BIG E, INC. 750 W. PUEBLO ST. RENO, NV, 89509 87.11.13