

30 29 T14N, R54E MDBM  
31 32 UNSURVEYED

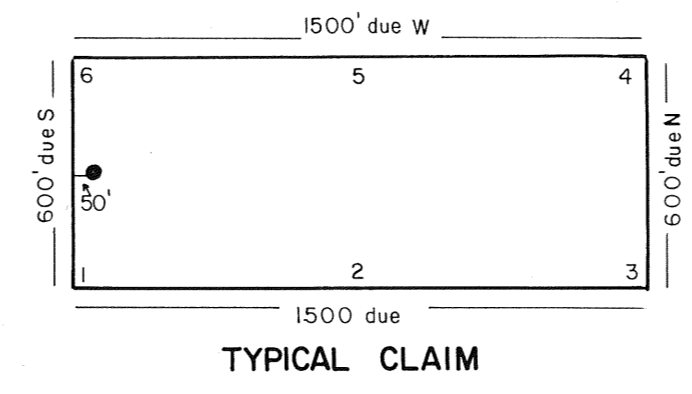

FILED AT THE REQUEST OF *J. C. Prochnau & Co.*  
 on *July 13*, 19 *88*, at *22* mins. past *12* M.  
 RECORDS OF EUREKA COUNTY, NEVADA M. N. REBELETTI, Recorder  
 File No. 119948 Fee \$ 375.00

## HORN LODE CLAIMS

Location: Unsurveyed sections 29 & 30 T19N, R54E MDBM  
 Unknown mining district, Eureka Co., Nevada

Location Date: All Horn claims April 27, 1988

Locator: J. Prochnau & Co.  
 127 Cheney St.  
 Reno, Nevada, 89501

Tie: The discovery monument of Horn #22 is located approximately 300' N10°E from the peak of Hornitos Cone.

• Discovery monuments are located 50' from end lines

All Claims measure 600' X 1500'