

Compared State of _____
 County of _____
 RECORD NO. _____
 Vol. _____ of _____
 Page _____ Request of _____

 County Auditor _____
 Deputy _____
 Mail to _____

 Fee _____

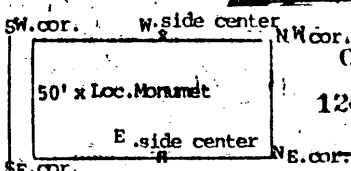

CERTIFICATE OF LOCATION

120561 STATE OF NEVADA
 EUREKA COUNTY

SE.cor. NE.cor.
 This diagram explains method of description of claim. Maggie Cr. MINING DISTRICT

NOTICE IS HEREBY GIVEN That the undersigned, having complied with the requirements of Chapter Six, Title thirty-two of the Revised Statutes of the United States, and the laws of the above State, and the local customs and regulations of said district,

has located and do hereby locate 1500 linear feet in length, and 600 feet in width on the 1X 33

lode, vein, ledge or deposit (or placer ground), situated in above State, County or Mining District, and further described as follows: Commencing at a post marked SE corner located about 300' east from the monument of location, thence 750 feet in Northerly direction to a Eastside center post marked, thence 750 feet in Northerly direction to a corner post marked NE corner, thence 600 feet in Westerly direction to a corner post marked NW corner, thence 750 feet in Southeasterly direction to a post marked Westside Center, thence 750 feet in Southerly direction to a corner post marked SW corner, thence 600 feet in Easterly direction to the SE corner hereby locating and intending to claim 1450 feet in a northerly direction from monument of location to the north and line, and 50 feet in the opposite direction from discovery to the south and line, and 300 feet on each side of the middle of said lode or ledge, for the purpose of mining the same and claiming all surface rights, privileges and minerals, with all dips, spurs, angles and variations, and other rights granted by existing laws and customs. This claim is further described as follows: The Monument of Location of this claim is approximately 1500 ft. southerly and 900 ft. westerly of the NE. corner of Section 14, Township 33 N, Range 51 E, Nevada Meridian, Eureka County, Nevada.

The adjoining claims are Fee land on the north; 1X 34 on the south; 1X 35 on the west; 1X 31 on the east.

The location work consisted of making & preparing maps as required in Nevada Revised Statutes 517:040. A notice of location is placed at Location Monument; Posts are placed at each corner at the center of each side line and the name of this lode and date of location, are placed on all posts.

Located this 14th day of June 1888

WITNESSES:

Peter W. Laczay
 Peter W. Laczay,
 P. O. Box 488
 Coeur d'Alene, Id. 83814 Locators

RECORDED AT THE REQUEST OF
 BOOK 181 PAGE 584
Peter W. Laczay
 '88 AUG -5 P2915

OFFICIAL RECORDS
 EUREKA COUNTY, NEVADA
 M.N. REBALATI, RECORDER
 FILE NO. FEE \$ 6.25
 120561