

RECORDING REQUESTED  
BY AND RETURN TO:  
Santa Fe Pacific Mining, Inc.  
Attn: Land Dept.  
Box 27019  
Albuquerque, NM 87125

ASSESSMENT  
WORK  
AFFIDAVIT  
AND  
PROOF  
OF  
LABOR

SHEEP CREEK  
29-085-0001, 2, 3, 5, 7, 10

STATE OF NEVADA )  
COUNTY OF EUREKA ) ss. 123229

BEFORE ME, personally appeared Ronald L. Parratt who being first duly sworn upon oath, deposes and says that:

1. SANTA FE PACIFIC MINING, INC. ("Santa Fe"), a corporation organized and existing under the laws of the State of Kansas and qualified to do business in the State of Nevada, formerly Santa Fe Mining, Inc., is the owner, optionee or lessee of the unpatented lode mining claims ("Claims") situated in the unknown Mining District, County of Eureka, State of Nevada, located in Section (See attached Exhibit "A"), Township 35 North & 36 North Range 48 East, listed and described in attached Exhibit "A".

2. The name of the owner or claimant of these Claims is SANTA FE PACIFIC MINING, INC.. The work, or improvements, described below was performed or made at the expense of Santa Fe.

3. Santa Fe has caused to be done and performed upon and for the benefit of the Claims the assessment work and improvements required by law for the assessment year beginning at noon on September 1, 19 87 and ending at noon on September 1, 19 88.

4. The date on which the work was done or improvements were made are between September 1, 19 87 and September 1, 19 88.

5. The character and type of work done, and improvements made include drilling, drill site construction, road work, geophysical surveys (see attached summary report) and other work authorized by law, and was completed at an actual cost of at least \$100.00 for each of the Claims.

6. The work was performed by employees, contractors and agents of Santa Fe as follows: Eklund Drilling, Carlin, Nevada; Great Basin Geophysical, Inc., Reno, Nevada; Taylor Services, Grants, New Mexico.

7. Affiant is the authorized agent of Santa Fe for purposes of making this affidavit, is cognizant of the facts stated above and is Exploration Manager of Santa Fe.

By: Ronald L. Parratt  
Affiant

Witness \_\_\_\_\_

Witness \_\_\_\_\_

STATE OF NEVADA )  
COUNTY OF WASHOE ) ss.

The foregoing instrument was acknowledged before me this 14<sup>th</sup> day of October, 19 88, by Ronald L. Parratt and was subscribed and sworn to before me by Affiant.

Witness my hand and official seal.

Barbara A. Olarreaga  
Notary Public

My Commission Expires:

October 5, 1989

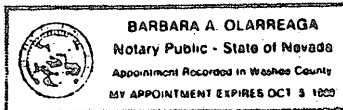

BOOK 187 PAGE 471

## EXHIBIT "A"

EDEN Group unpatented lode claims, located in the unknown Mining District in Section(s)  
 8, 20; and 18, 20, 30, 32, Township(s) 35 North and 36 North, Range(s) 48 East,  
 Eureka County, Nevada.

Said claim group is more particularly described as follows:

| Claim Name            | County Recorder Information |         |            | BLM<br>MC Number |
|-----------------------|-----------------------------|---------|------------|------------------|
|                       | Book #                      | Page #  | Document # |                  |
| Eden 26               | 159                         | 278     |            | 418819           |
| Eden 28               | 159                         | 279     |            | 418821           |
| Eden 53               | 159                         | 280     |            | 418846           |
| Eden 54               | 159                         | 281     |            | 418847           |
| Eden 55               | 159                         | 282     |            | 418848           |
| Eden 55 (amended)     | 177                         | 611     |            |                  |
| Eden 56               | 159                         | 283     |            | 418849           |
| Eden 56 (amended)     | 177                         | 613     |            |                  |
| Eden 77-112           | 159                         | 284-319 |            | 418870-418905    |
| Eden 77-112 (amended) | 167                         | 386-351 |            |                  |
| Eden 127-130          | 159                         | 320-323 |            | 418920-418923    |
| Eden 145-148          | 159                         | 324-327 |            | 418938-418941    |
| Eden 169-204          | 159                         | 328-363 |            | 418962-418997    |
| Eden 245-276          | 159                         | 364-395 |            | 419038-419069    |
| Eden 337-350          | 159                         | 396-409 |            | 419130-419143    |
| Eden 355-368          | 159                         | 410-423 |            | 419148-419161    |

ATTACHMENT TO THAT CERTAIN  
1988 PROOF OF LABOR  
COVERING THE EDEN 26, 28, 53, 54, 55, 56, 77-112, 127-130,  
145-148, 169-204, 245-276, 337-350, 355-368 CLAIMS

This report is filed in compliance with the requirements of title 30, U.S. Code, Section 28-1, for the Eden 26, 28, 53, 54, 55, 56, 77-112, 127-130, 145-148, 169-204, 245-276, 337-350, and 355-368 lode mining claims situated in Eureka County, Nevada.

The work consisted of geophysical surveys of parts of the claim block (see attached location map). The work was conducted in order to identify and evaluate the extent of mineralized areas within the claim block, and to assist in planning further exploration work. The work was performed between the dates of May 1, 1988 and May 31, 1988 by Great Basin Geophysical Inc., 1835 King Edward Dr., Reno, Nevada 89503 under the supervision of Ronald L. Parratt, Exploration Manager, with sixteen years experience in minerals exploration with a Bachelor of Science and Masters of Science from Purdue University. The cost of the surveys exceeded \$100.00 per claim and was paid for by Santa Fe Pacific Mining, Inc. The geophysical surveys delineated areas of anomalous conductivity. All technical data and results are in the possession of and considered to be the exclusive property of Santa Fe Pacific Mining, Inc.

*Ronald L. Parratt*

Ronald L. Parratt  
Exploration Manager

BOOK 187 PAGE 473

T  
35  
N

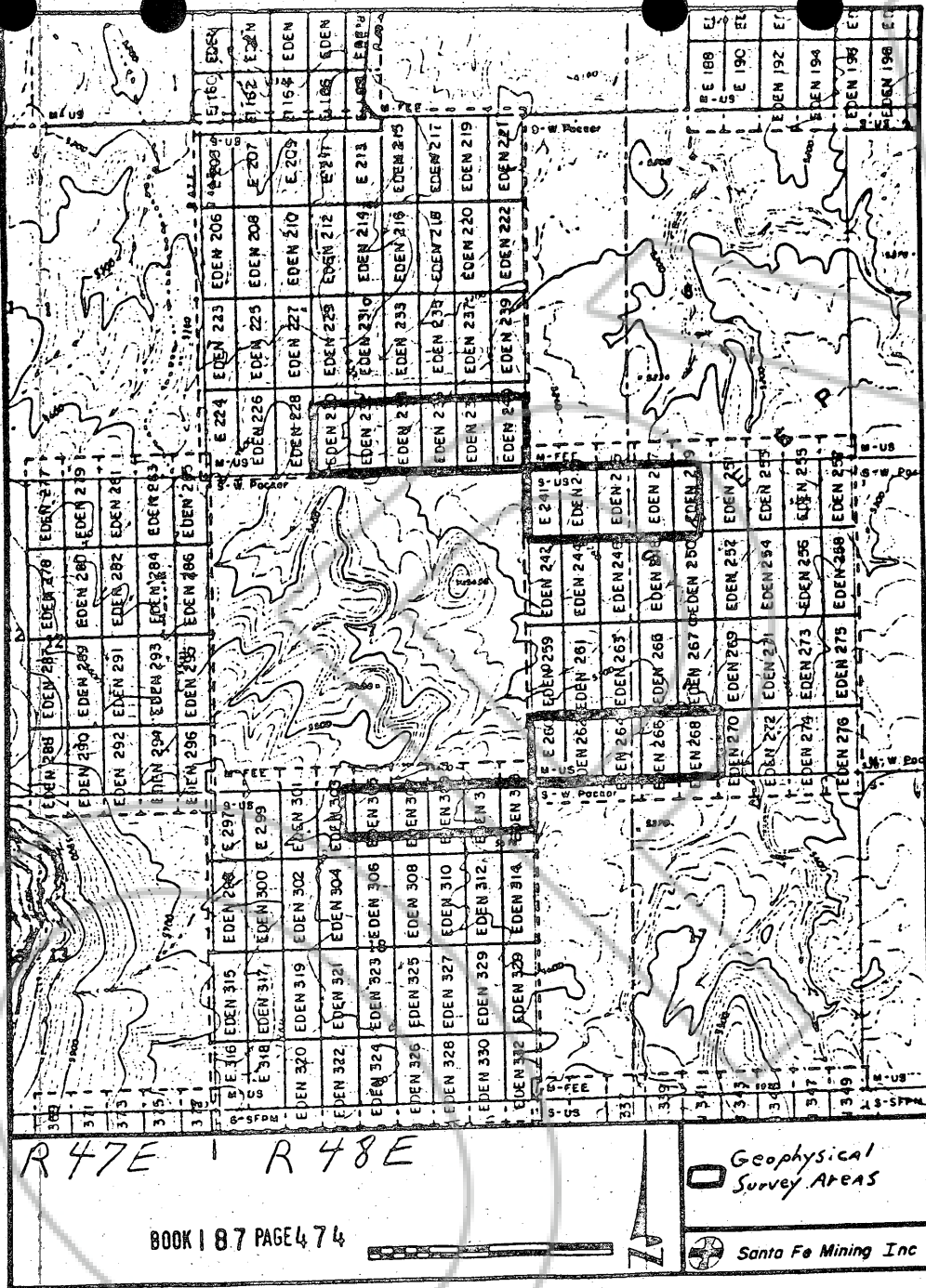

SANTA FE PACIFIC  
MINING, INC.  
RECORDED AT THE REQUEST OF  
BOOK 187 PAGE 471

'88 OCT 19 AM 33

OFFICIAL RECORDS  
EUREKA COUNTY, CALIFORNIA  
M.M. REGALE A.I. RECORDER  
FILE NO. FEE \$ 255 <sup>50</sup>  
123229

BOOK 187 PAGE 475