

121180
 CERTIFICATE OF LOCATION
 LOBE MINING CLAIM

MOLYCORP, INC., whose mailing address is P. O. Box 37, Louviers, Colorado 80131, by its undersigned agent, hereby certifies that it has located the BF- 290 lode mining claim in Eureka, County, Nevada, on the 9th day of September, 1988. The claim is located in the following Mount Diablo Meridian quarter section(s):

Quarter	Section	Township	Range
<u>NE</u>	<u>33</u>	<u>19 N</u>	<u>49 E</u>
<u>SE</u>	<u>33</u>	<u>19 N</u>	<u>49 E</u>

The claim is approximately 1500 feet long and 600 feet wide, such that 1485 feet is claimed in a southerly direction and 15 feet in a northerly direction from the point of discovery (monument of location), at which the Notice of Location was posted, together with 300 feet on each side of the monument of location and center line of the claim. The general course of the lode is north-south.

The NW corner of this claim is located approximately 7250 feet in a South direction, thence 12,800 feet in a WEST direction from the NE corner of Section 26, Township 19 North, Range 49 East, Mount Diablo Meridian.

Monument posts defining the boundaries of this claim are located and marked as follows: Beginning at the NW corner post No. 1 of this claim, marked NW corner, thence 600 feet east to the NE corner post No. 2 of this claim, marked NE corner, thence 750 feet south to the east side center post No. 3 of this claim, marked E side center, thence 750 feet south to the SE corner post No. 4 of this claim, marked SE corner, thence 600 feet west to the SW corner post No. 5 of this claim, marked SW corner, thence 750 feet north to the west side center post No. 6 of this claim, marked W side center, thence 750 feet north to the point of beginning (see map below). Monument posts are 3 inch diameter durable plastic pipe at least 4.5 feet long, set 1 foot in the ground or place in a mound of earth and stone as prescribed by NRS 517.030. All monument posts are marked by metal tags inscribe so as to appropriately identify the monument.

The location work consisted of making a claim map as provided in NRS 517.040.

Dated this 18th day of October, 1988

Molycorp, Inc.

By: Ray W. Hammitt
 Ray W. Hammitt
 Agent for Molycorp, Inc.

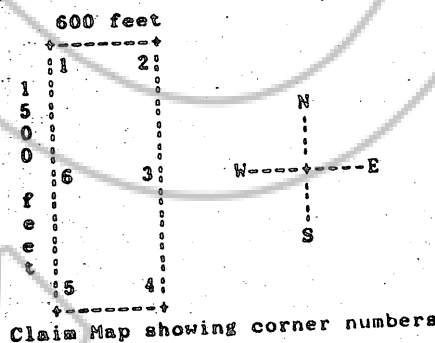

Recorder's Stamp

121180
 FILE NO.
 OFFICIAL RECORDS
 EUREKA COUNTY, NEVADA
 MINERAL RIGHTS RECORDER
 FEE \$2.55

BOOK 189 PAGE 364

RECORDED AT THE REQUEST OF MOLYCORP INC
 BOOK 189 PAGE 364

BOOK 189 PAGE 364