

121783

Compared State of	County of	SW. cor.	W. side center	NW. cor.	<b>CERTIFICATE OF LOCATION</b> STATE OF NEVADA EUREKA COUNTY Mineral Hill MINING DISTRICT
58	HERSHBRED	50' x Loc. Monument			
Vol. of	Request of	E. side center	SE. cor.	NE. cor.	
Page	10	This diagram explains method of description of claim.			
County Auditor	Deputy	NOTICE IS HEREBY GIVEN, That the undersigned, having complied with the requirements of Chapter Six, Title thirty-two of the Revised Statutes of the United States, and the laws of the above State, and the local customs and regulations of said district,			
Mail to		has located and do hereby locate 1500 linear feet in length,			
Fee		and 600 feet in width on the PETE 200.			

lode, vein, ledge or deposit (or placer ground), situated in above State, County or Mining District, and further described as follows: Commencing at a post marked SE corner located about 300' east from the monument of location, thence 750 feet in a Northerly

direction to a Eastside center post marked, thence 750 feet in a Northerly

direction to a corner post marked NE corner, thence 600 feet in a Westerly

direction to a corner post marked NW corner, thence 750 feet in a Southeasterly

direction to a post marked Westside Center, thence 750 feet in a Southerly

direction to a corner post marked SW corner, thence 600 feet in a Easterly

direction to the SE. corner hereby locating and intending to claim 1450

feet in a northerly direction from monument of location to the north

and thence and 50 feet in the opposite direction from discovery to the

south and thence and 300 feet on each side of the middle of

said lode or ledge for the purpose of mining the same and claiming all surface rights, privileges and minerals, with all dips, spurs, angles and variations, and other rights granted by existing laws and customs. This claim is further described as follows:

The Monument of Location of this claim is approximately 2000 ft.

southerly and 3500 ft. westerly of the NE. corner of Section 6,

Township 27 N, Range 53 E. Nevada Meridian, Eureka County, Nevada.

The adjoining claims are on the north; Pete 210 on the south;

Pete 201 on the west; P.N. Group on the east.

The location work consisted of making & preparing maps as required in Nevada Revised

Statutes 517:040. A notice of location is placed at Location Monument; Posts are

placed at each corner at the center of each side line and the name of this lode and

date of location, are placed on all posts.

Located this 12th day of September 1898

Witnesses: *Peter W. Laczay*

Peter W. Laczay.

P. O. Box 488

Cosumnes, Idaho. 83814 Locators

121783

 OFFICIAL RECORDS  
 EUREKA COUNTY, NEVADA  
 M. M. REBALEATI, RECORDER  
 FILE NO. 121783  
 SEE PG 25

 RECORDED AT THE REQUEST OF  
 BOOK 190 PAGE 557  
*Peter W. Laczay*  
 MAY 14 1898

BOOK 190 PAGE 557

12-1781

Number of pages of this record	Recorded on	State of	County of	SW. cor.	W. side center	NW. cor.	<b>CERTIFICATE OF LOCATION</b> STATE OF NEVADA EUREKA COUNTY Mineral Hill MINING DISTRICT
Vol. of	Request of	50' x Loc. Monument			E. side center	NE. cor.	
Page	County Auditor	This diagram explains method of description of claim.			PETE 201'		
County Auditor	Deputy	NOTICE IS HEREBY GIVEN, That the undersigned, having complied with the requirements of Chapter Six, Title thirty-two of the Revised Statutes of the United States, and the laws of the above State, and the local customs and regulations of said district,			has located and do hereby locate 1500 linear feet in length,		
Mail to		and 600 feet in width on the			PETE 201'		
Fee		lode, vein, ledge or deposit (or placer ground), situated in above State, County or Mining District, and further described as follows: Commencing at a post marked SE corner located about 300' east from the monument of location, thence			750 feet to a Northerly		

direction to a Eastside center post marked, thence 750 feet to a Northerly

direction to a corner post marked NE corner, thence 600 feet to a Westerly

direction to a corner post marked NW corner, thence 750 feet to a Southeasterly

direction to a post marked Westside Center, thence 750 feet to a Southerly

direction to a corner post marked SW corner, thence 600 feet to a Easterly

direction to the SE. corner hereby locating and intending to claim 1450 feet in a northerly direction from monument of location to the north end line, and 50 feet in the opposite direction from discovery to the south end line, and 300 feet on each side of the middle of said lode or ledge, for the purpose of mining the same and claiming all surface rights, privileges and minerals, with all dips, spurs, angles and variations, and other rights granted by existing laws and customs. This claim is further described as follows: The Monument of Location of this claim is approximately 2000 ft. southerly and 4100 ft. westerly of the NE. corner of Section Township 27 N, Range 53 E, Nevada Meridian, Eureka County, Nevada.

The adjoining claims are on the north; Pete 211 on the south; Pete 202 on the west; Pete 200 on the east.

The location work consisted of making & preparing maps as required in Nevada Revised Statutes 517:040. A notice of location is placed at Location Monument; Posts are placed at each corner at the center of each side line and the name of this lode and date of location, are placed on all posts.

Located this 12th day of September 1988.

WITNESSES:

Peter W. Laczay  
P. O. Box 488

Cosumnes, Id. 93814 Locators

RECORDED AT THE REQUEST OF  
BOOK 190 PAGE 558  
12-1781  
OFFICIAL RECORDS  
EUREKA COUNTY, NEVADA  
MIN. RECORDS DIV.  
FILE NO. 12-1781  
FEE \$ 2.25  
NOV 14 1988

BOOK 190 PAGE 558

121785

Compared State of	County of	W. cor.	W. side center	NW cor.	<b>CERTIFICATE OF LOCATION</b> STATE OF NEVADA EUREKA COUNTY Mineral Hill MINING DISTRICT
50' x Loc. Monument					
Vol. of		E. side center			
Page of	Request of	SE. cor.	NE. cor.		

This diagram explains method of description of claim.

NOTICE IS HEREBY GIVEN That the undersigned, having complied with the requirements of Chapter Six, Title thirty-two of the Revised Statutes of the United States, and the laws of the above State, and the local customs and regulations of said district,

has located and do hereby locate 1500 linear feet in length, and 600 feet in width on the PETE 202

lode, vein, ledge or deposit (or placer ground), situated in above State, County or Mining District, and further described as follows: Commencing at a post marked SE corner located about 300' east from the monument of location, thence 750 feet in a Northerly direction to a Eastside center post marked, thence 750 feet in a Northerly direction to a corner post marked NE corner, thence 600 feet in a Westerly direction to a corner post marked NW corner, thence 750 feet in a Southeasterly direction to a post marked Westside Center, thence 750 feet in a Southerly direction to a corner post marked SW corner, thence 600 feet in a Easterly direction to the SE. corner hereby locating and intending to claim 1450 feet in a northerly direction from monument of location to the north end line, and 50 feet in the opposite direction from discovery to the south and line, and 300 feet on each side of the middle of said lode or ledge, for the purpose of mining the same and claiming all surface rights, privileges and minerals, with all dips, spurs, angles and variations, and other rights granted by existing laws and customs. This claim is further described as follows: The Monument of Location of this claim is approximately 2000 ft. southerly and 4700 ft. westerly of the NE. corner of Section 6 Township 27 N. Range 53 E. Nevada Meridian, Eureka County, Nevada.

The adjoining claims are - on the north; Pete 212 on the south; Pete 203 on the west; Pete 201 on the east.

The location work consisted of making & preparing maps as required in Nevada Revised Statutes 517:040. A notice of location is placed at Location Monument; Posts are placed at each corner at the center of each side line and the name of this lode and date of location, are placed on all posts.

Located this 12th day of September, 1988

WITNESSES:

*Peter W. Lacey*  
 Peter W. Lacey  
 P. O. Box 488  
 Coeur d'Alene, Id. 83814 Locators

RECORDED AT THE REQUEST OF  
 BOOK 190 PAGE 559  
*Peter Lacey*  
 SEP 14 1988  
 OFFICIAL RECORDS  
 EUREKA COUNTY, NEVADA  
 MINERAL & MINE RECORDS  
 FILE NO. 121785  
 FEE \$6.25

BOOK 190 PAGE 559

121786

State of _____ County of _____ Val. of _____ Page _____ Request of _____ County Auditor _____ Deputy _____ Mail to _____ Fee _____	W. cor.      W. side center      NW cor. <div style="border: 1px solid black; padding: 5px; width: fit-content; margin: 0 auto;">           50' x Loc. Monument         </div> E. side center      NE cor.	<b>CERTIFICATE OF LOCATION</b> STATE OF NEVADA EUREKA COUNTY Mineral Hill MINING DISTRICT
------------------------------------------------------------------------------------------------------------------------------------------------------------	---------------------------------------------------------------------------------------------------------------------------------------------------------------------------------------------------------------	----------------------------------------------------------------------------------------------------

This diagram explains method of description of claim.

NOTICE IS HEREBY GIVEN, That the undersigned, having complied with the requirements of Chapter Six, Title thirty-two of the Revised Statutes of the United States, and the laws of the above State, and the local customs and regulations of said district,

has located and do hereby locate 1500 linear feet in length, and 600 feet in width on the PETE 203

lode, vein, ledge or deposit (or placer ground), situated in above State, County or Mining District, and further described as follows: Commencing at a post marked SE corner located about 300' east from the monument of location, thence 750 feet to Northerly direction to a Eastside center post marked, thence 750 feet to Northerly direction to a corner post marked NE corner, thence 600 feet to Westerly direction to a corner post marked NW corner, thence 750 feet to Southeasterly direction to a post marked Westside Center, thence 750 feet to Southerly direction to a corner post marked SW corner, thence 600 feet to Easterly direction to the SE corner hereby locating and intending to claim 1450 feet in a northerly direction from monument of location to the north end line, and 50 feet in the opposite direction from discovery to the south

and 300 feet on each side of the middle of said lode or ledge, for the purpose of mining the same and claiming all surface rights, privileges and minerals, with all dips, spurs, angles and variations, and other rights granted by existing laws and customs. This claim is further described as follows: The Monument of Location of this claim is approximately 2000 ft. southerly and 5300 ft. westerly of the NE corner of Section 6, Township 27 N, Range 53 E, Nevada Meridian, Eureka County, Nevada.

The adjoining claims are \_\_\_\_\_ on the north; Pete 213 on the south; Pete 204 on the west; Pete 202 on the east.

The location work consisted of making & preparing maps as required in Nevada Revised Statutes 517:040. A notice of location is placed at Location Monument; Posts are placed at each corner at the center of each side line and the name of this lode and date of location, are placed on all posts.

Located this 12th day of September 1988  
 WITNESSES:  
 \_\_\_\_\_  
 \_\_\_\_\_  
 Peter W. Laczay,  
 P. O. Box 488  
 Cosumnes Bluffs, Id. 93814 Locators

121786  
 OFFICIAL RECORDS  
 EUREKA COUNTY, NEVADA  
 M. M. REBALIANT, RECORDER  
 FILE NO. \_\_\_\_\_  
 FEE \$2.50  
 RECORDED AT THE REQUEST OF  
 BOOK 190 PAGE 560  
 Peter Laczay  
 NOV 14 4 27 PM '88

121787

Compared State of	County of	W. cor.	W. side center	NW cor.	<b>CERTIFICATE OF LOCATION</b>
50' x Loc. Monument					
Vol. of	Request of	E. side center	NE cor.	EUREKA	COUNTY
Page	19	SE cor.	Mineral Hill	MINING DISTRICT	
County Auditor	Deputy	This diagram explains method of description of claim.			
Mail to		NOTICE IS HEREBY GIVEN, That the undersigned, having complied with the requirements of Chapter Six, Title thirty-two of the Revised Statutes of the United States, and the laws of the above State, and the local customs and regulations of said district,			
Fee		has located and do hereby locate <u>1500</u> linear feet in length,			
		and <u>600</u> feet in width on the <u>PETE 204</u> .			

lode, vein, ledge or deposit (or placer ground), situated in above State, County or Mining District, and further described as follows: Commencing at a post marked SE corner located about 300' east from the monument of location, thence 750 feet in a Northerly direction to a Eastside center post marked, thence 750 feet in a Northerly direction to a corner post marked NE corner, thence 600 feet in a Westerly direction to a corner post marked NW corner, thence 750 feet in a Southeasterly direction to a post marked Westside Center, thence 750 feet in a Southerly direction to a corner post marked SW corner, thence 600 feet in a Easterly direction to the SE corner hereby locating and intending to claim 1450 feet in a northerly direction from monument of location to the north end line, and 50 feet in the opposite direction from discovery to the south and line, and 300 feet on each side of the middle of said lode or ledge for the purpose of mining the same and claiming all surface rights, privileges and minerals, with all dips, spurs, angles and variations, and other rights granted by existing laws and customs. This claim is further described as follows:

The Monument of Location of this claim is approximately 2000 ft. southerly and 400 ft. westerly of the NE. corner of Section 6, Township 27 N, Range 52 E, Nevada Meridian, Eureka County, Nevada. The adjoining claims are Pete 20 on the north; Pete 214 on the south; Pete 205 on the west; Pete 203 on the east.

The location work consisted of making & preparing maps as required in Nevada Revised Statutes 517:040. A notice of location is placed at Location Monument; Posts are placed at each corner at the center of each side line and the name of this lode and date of location, are placed on all posts.

Located this 12th day of September 1988.

WITNESSES:

*Peter W. Laczay*  
Peter W. Laczay,  
P. O. Box 488  
Coeur d'Alene, Id. 83814 Locators

121787

OFFICIAL RECORDS  
EUREKA COUNTY, NEVADA  
M. M. REBALLA, RECORDER  
FILE NO. 625

RECORDED AT THE REQUEST OF  
BOOK 190 PAGE 561  
88 NOV 14 4 27 PM  
*Peter W. Laczay*

BOOK 190 PAGE 561

121788

Completed by \_\_\_\_\_  
 State of \_\_\_\_\_ County of \_\_\_\_\_  
 W. cor. W. side center NW cor.  
 RECORDED as  
 Vol. \_\_\_\_\_ of \_\_\_\_\_  
 Page \_\_\_\_\_ Request of \_\_\_\_\_  
 is \_\_\_\_\_  
 County Auditor \_\_\_\_\_ Deputy \_\_\_\_\_  
 Mail to \_\_\_\_\_  
 Fee \_\_\_\_\_

CERTIFICATE OF LOCATION

STATE OF NEVADA

EUREKA

COUNTY

Mineral Hill

MINING DISTRICT

This diagram explains method of description of claim.

NOTICE IS HEREBY GIVEN That the undersigned, having complied with the requirements of Chapter Six, Title thirty-two of the Revised Statutes of the United States, and the laws of the above State, and the local customs and regulations of said district,

has located and do hereby locate 1500 linear feet in length, and 600 feet in width on the PETE 205

lode, vein, ledge or deposit (or placer ground), situated in above State, County or Mining District, and further described as follows: Commencing at a post marked SE corner located about 300' east from the monument of location, thence 750 feet in Northerly direction to a Eastside center post marked, thence 750 feet in Northerly direction to a corner post marked NE corner, thence 600 feet in Westerly direction to a corner post marked NW corner, thence 750 feet in Southeasterly direction to a post marked Westside Center, thence 750 feet in Southerly direction to a corner post marked SW corner, thence 600 feet in Easterly direction to the SE corner hereby locating and intending to claim 1450 feet in a northerly direction from monument of location to the north end line, and 50 feet in the opposite direction from discovery to the south end line, and 300 feet on each side of the middle of said lode or ledge, for the purpose of mining the same and claiming all surface rights, privileges and minerals, with all dips, spurs, angles and variations, and other rights granted by existing laws and customs. This claim is further described as follows: The Monument of Location of this claim is approximately 2000 ft. southerly and 1000 ft. westerly of the NE corner of Section 6

Township 27 N, Range 52 E, Nevada Meridian, Eureka County, Nevada.  
 The adjoining claims are Pete 20 on the north; Pete 215 on the south; Pete 206 on the west; Pete 204 on the east.

The location work consisted of making & preparing maps as required in Nevada Revised Statutes 517:040. A notice of location is placed at Location Monument; Posts are placed at each corner at the center of each side line and the name of this lode and date of location, are placed on all posts.

Located this 12th day of September 1988  
 WITNESSES:  
 \_\_\_\_\_  
 Peter W. Laczay.  
 P. O. Box 488  
 Coeur d'Alene, Id. 83814 Locators

121788

OFFICIAL RECORDS  
EUREKA COUNTY, NEVADA  
MIN. RESOURCES RECORDER  
FEE \$ 6.25

RECORDED AT THE REQUEST OF  
BOOK 190 PAGE 562  
Peter W. Laczay  
288 NOV 14 1988

12-1789

Compared State of	County of	SW. cor.	W. side center	NW. cor.	<b>CERTIFICATE OF LOCATION</b>
RECORDED					
Vol. of		50' x Loc. Monument			STATE OF NEVADA
Page of	Request of	E. side center			EUREKA
		SE. cor.		NE. cor.	COUNTY
	County Auditor	This diagram explains method of description of claim.			
	Deputy	Mineral Hill MINING DISTRICT			
Mall to		NOTICE IS HEREBY GIVEN, That the undersigned, having complied with the requirements of Chapter Six, Title thirty-two of the Revised Statutes of the United States, and the laws of the above State, and the local customs and regulations of said district,			
Pee		has located and do hereby locate <u>1500</u> linear feet in length,			
		and <u>600</u> feet in width on the <u>PETE 206</u>			

lode, vein, ledge or deposit (or placer ground), situated in above State, County or Mining District, and further described as follows: Commencing at a post marked SE corner located about 300' east from the monument of location, thence 750 feet in a Northerly direction to a Eastside center post marked, thence 750 feet in a Northerly direction to a corner post marked NE corner, thence 600 feet in a Westerly direction to a corner post marked NW corner, thence 750 feet in a Southeasterly direction to a post marked Westside Center, thence 750 feet in a Southerly direction to a corner post marked SW corner, thence 600 feet in a Easterly direction to the SE. corner hereby locating and intending to claim 1450 feet in a northerly direction from monument of location to the north end line, and 50 feet to the opposite direction from discovery to the south and line, and 300 feet on each side of the middle of

said lode or ledge for the purpose of mining the same and claiming all surface rights, privileges and minerals, with all dips, spurs, angles and variations, and other rights granted by existing laws and customs. This claim is further described as follows: The Monument of Location of this claim is approximately 2000 ft. southerly and 1600 ft. westerly of the NE. corner of Section 1,

Township 27 N, Range 52 E. Nevada Meridian, Eureka County, Nevada.

The adjoining claims are Pete 59 on the north; Pete 216 on the south;

Pete 207 on the west; Pete 205 on the east.

The location work consisted of making & preparing maps as required in Nevada Revised Statutes 517:040. A notice of location is placed at Location Monument; Posts are placed at each corner at the center of each side line and the name of this lode and date of location, are placed on all posts.

Located this 12th day of September, 1988.

WITNESSES:

Peter W. Laczay  
Peter W. Laczay.  
P. O. Box 488  
Coeur d'Alene, Id. 83814 Locators

RECORDED AT THE REQUEST OF  
BOOK 190 PAGE 563  
Peter W. Laczay  
88 NOV 14 P427  
OFFICIAL RECORDS  
EUREKA COUNTY, NEVADA  
MIN. RES. & RECL. RECORDER  
FEE \$ 6.25  
FILE NO. 12-1789

BOOK 190 PAGE 563

121790

Computed State of	County of	SW. cor.	W. side center	NW. cor.	<b>CERTIFICATE OF LOCATION</b> STATE OF NEVADA EUREKA COUNTY Mineral Hill MINING DISTRICT
RECORDED		50' x Loc. Monument			
Vol. of	Page of	SE. cor.	E. side center	NE. cor.	
County Auditor		This diagram explains method of description of claim.			
Deputy		NOTICE IS HEREBY GIVEN. That the undersigned, having complied with the requirements of Chapter Six, Title thirty-two of the Revised Statutes of the United States, and the laws of the above State, and the local customs and regulations of said district,			
Mail to		has located and do hereby locate 1500 linear feet in length,			
Fee		and 600 feet in width on the PETE 207.			

lode, vein, ledge or deposit (or placer ground), situated in above State, County or Mining District, and further described as follows: Commencing at a post marked SE corner located about 300' east from the monument of location, thence 750 feet to a Northerly direction to a Eastside center post marked, thence 750 feet to a Northerly direction to a corner post marked NE corner, thence 600 feet to a Westerly direction to a corner post marked NW corner, thence 750 feet to a Southeasterly direction to a post marked Westside Center, thence 750 feet to a Southerly direction to a corner post marked SW corner, thence 600 feet to a Easterly direction to the SE. corner hereby locating and intending to claim 1450 feet to a northerly direction from monument of location to the north and line, and 50 feet in the opposite direction from discovery to the south and line, and 300 feet on each side of the middle of said lode or ledge, for the purpose of mining the same and claiming all surface rights, privileges and minerals, with all dips, apures, angles and variations, and other rights granted by existing laws and customs. This claim is further described as follows: The Monument of Location of this claim is approximately 2000 ft. southerly and 2100 ft. westerly of the NE. corner of Section 1 Township 27 N, Range 52 E, Nevada Meridian, Eureka County, Nevada.

The adjoining claims are Pete 59 on the north; Pete 217 on the south; Pete 208 on the west; Pete 206 on the east.

The location work consisted of making & preparing maps as required in Nevada Revised Statutes 517:040. A notice of location is placed at Location Monument; Posts are placed at each corner at the center of each side line and the name of this lode and date of location, are placed on all posts.

Located this 12th day of September, 1908.

WITNESSES:

*Peter W. Laczny*  
 Peter W. Laczny,  
 P. O. Box 488  
 Coeur d'Alene, Id. 83814 Locators

121790

OFFICIAL RECORDS  
 EUREKA COUNTY, NEVADA  
 M. M. RECALLATI, RECORDER  
 FILE NO. FEE \$ 6.25

RECORDED AT THE REQUEST OF  
 BOOK 190 PAGE 564  
 288 NOV 14 PM 4 27  
*Peter Laczny*

BOOK 190 PAGE 564



124791

Completed State of	County of	SW. cor.	W. side center	NW. cor.	<b>CERTIFICATE OF LOCATION</b>
Vol. of	Page	50' x Loc. Monument		STATE OF NEVADA	
Request of	Request of	E. side center	NE. cor.	EUREKA	COUNTY
County Auditor	Deputy	This diagram explains method of description of claim.		Mineral Hill	MINING DISTRICT
Mail to		NOTICE IS HEREBY GIVEN, That the undersigned, having complied with the requirements of Chapter Six, Title thirty-two of the Revised Statutes of the United States, and the laws of the above State, and the local customs and regulations of said district,			
Fee		has located and do hereby locate		1500	linear feet in length,
		and		600	feet in width on the
				PETE 208	

lode, vein, ledge or deposit (or placer ground), situated in above State, County or Mining District, and further described as follows: Commencing at a post marked SE corner located about 300' east from the monument of location, thence

750 feet to a Northerly direction to a Eastside center post marked, thence 750 feet to a Northerly direction to a corner post marked NE corner, thence 600 feet to a Westerly direction to a corner post marked NW corner, thence 750 feet to a Southeasterly direction to a post marked Westside Center, thence 750 feet to a Southerly direction to a corner post marked SW corner, thence 600 feet to a Easterly direction to the SE. corner hereby locating and intending to claim 1450 feet in a northerly direction from monument of location to the north end line, and 50 feet in the opposite direction from discovery to the south end line, and 300 feet on each side of the middle of said lode or ledge, for the purpose of mining the same and claiming all surface rights, privileges and minerals, with all dips, spurs, angles and variations, and other rights granted by existing laws and customs. This claim is further described as follows: The Monument of location of this claim is approximately 2000 ft. southerly and 2600 ft. westerly of the NE. corner of Section 1, Township 27 N, Range 52 E. Nevada Meridian, Eureka County, Nevada.

The adjoining claims are on the north; Pete 218 on the south; Pete 209 on the west; Pete 207 on the east.

The location work consisted of making & preparing maps as required in Nevada Revised Statutes 517:040. A notice of location is placed at Location Monument; Posts are placed at each corner at the center of each side line and the name of this lode and date of location, are placed on all posts.

Located this 12th day of September 1908

WITNESSES:

Peter W. Laczay  
P. O. Box 488  
Coeur d'Alene, Id. 83814 Locators

124791

OFFICIAL RECORDS  
EUREKA COUNTY, NEVADA  
MIN. REBALANCE, REGISTER  
FILE NO. FEE \$ 6.25

RECORDED AT THE REQUEST OF  
BOOK 190 PAGE 565  
Pete Laczay  
NOV 14 1908

BOOK 190 PAGE 565

CERTIFICATE OF LOCATION

50' x 100' Monument  
 STATE OF NEVADA  
 E. side center NE. cor. EUREKA COUNTY  
 SE. cor. Mineral Hill MINING DISTRICT  
 This diagram captures method of description of claim.  
 NOTICE IS HEREBY GIVEN, That the undersigned, having complied with the requirements of Chapter Six, Title thirty-two of the Revised Statutes of the United States, and the laws of the above State, and the local customs and regulations of said district,  
 has located and do hereby locate 1500 linear feet in length,  
 and 600 feet in width on the PETE 209

lode, vein, ledge or deposit (or placer ground), situated in above State, County or Mining District, and further described as follows: Commencing at a post marked SE corner located about 300' east from the monument of location, thence 750 feet in a Northerly direction to a Eastside center post marked, thence 750 feet in a Northerly direction to a corner post marked NE corner, thence 600 feet in a Westerly direction to a corner post marked NW corner, thence 750 feet in a Southeasterly direction to a post marked Westside Center, thence 750 feet in a Southerly direction to a corner post marked SW corner, thence 600 feet in a Easterly direction to the SE corner hereby locating and locating to claim 1450 feet in a northerly direction from monument of location to the north end line, and 50 feet in the opposite direction from discovery to the south end line, and 300 feet on each side of the middle of

said lode or ledge, for the purpose of mining the same and claiming all surface rights, privileges and minerals, with all dips, spurs, angles and variations, and other rights granted by existing laws and customs. This claim is further described as follows: The Monument of Location of this claim is approximately 2000 ft. southerly and 3200 ft. westerly of the NE. corner of Section 1,

Township 27 N, Range 52 E. Nevada Meridian, Eureka County, Nevada.

The adjoining claims are on the north; Pete 219 on the south; Pete 227 on the west; Pete 208 on the east.

The location work consisted of making & preparing maps as required in Nevada Revised Statutes 517:040. A notice of location is placed at Location Monument; Posts are placed at each corner at the center of each side line and the name of this lode and date of location, are placed on all posts.

Located this 21st day of September 1988

WITNESSES:

Peter W. Laczay  
 P. O. Box 488  
 Coeur d'Alene, Id. 83814

RECORDED AT THE REQUEST OF  
 BOOK 190 PAGE 566  
 Peter Laczay  
 88 NOV 14 P427

OFFICIAL RECORDS  
 EUREKA COUNTY, NEVADA  
 M.M. REBALLAH, RECORDER  
 FILE NO. 122792  
 FEE \$ 6.50

CERTIFICATE OF LOCATION

RECORDED  
 Vol. \_\_\_\_\_ of \_\_\_\_\_  
 Page \_\_\_\_\_ Request of \_\_\_\_\_  
 No. \_\_\_\_\_  
 County Auditor \_\_\_\_\_ Deputy \_\_\_\_\_  
 Mail to \_\_\_\_\_  
 Fee \_\_\_\_\_

Loc. Monument 50'  
 Side center cor.  
 SE. COR. \_\_\_\_\_ NE. COR. \_\_\_\_\_

STATE OF NEVADA  
 EUREKA COUNTY  
 Mineral Hill MINING DISTRICT

This diagram explains method of description of claim.

NOTICE IS HEREBY GIVEN, That the undersigned, having complied with the requirements of Chapter Six, Title thirty-two of the Revised Statutes of the United States, and the laws of the above State, and the local customs and regulations of said district, has located and do hereby locate \_\_\_\_\_ linear feet in length, and \_\_\_\_\_ feet in width on the \_\_\_\_\_

lode, vein, ledge or deposit (or placer ground), situated in above State, County or Mining District and further described as follows: Commencing at a post marked NE corner located about 300 feet east from the Monument of Location, thence 750 feet in a Southerly direction to a post marked East Side center, thence 750 feet in a Southerly direction to a corner post marked SE corner, thence 600 feet in a Westerly direction to a corner post marked SW corner, thence 750 feet in a Northerly direction to a post marked Westside center, thence 750 feet in a Northerly direction to a corner post marked NW corner, thence 600 feet in a Easterly direction to the NE. corner hereby locating and intending to claim 1,450 feet in a Southerly direction from monument of location to the South end line, and 50 feet in the opposite direction from discovery to the North and line, and 300 feet on each side of the middle of said lode or ledge, for the purpose of mining the same and claiming all surface rights, privileges and minerals, with all dips, apura, angles and variations, and other rights granted by existing laws and customs. This claim is further described as follows: The Monument of Location of this claim is approximately 2000 ft. southerly and 3500 ft. westerly of the NE. corner of Section 6 Township 27 N, Range 53 E. Nevada Meridian, Eureka County, Nevada.

The adjoining claims are Pete 200 on the north; Five 0#96 on the south; Pete 211 on the west; P. N. Group on the east.

The location work consisted of making & preparing maps as required in Nevada Revised Statutes 517:040. A notice of location is placed at Location Monument; Posts are placed at each corner at the center of each side line and the name of this lode and date of location, are placed on all posts.

Located this 12th day of September 1908

WITNESSES: \_\_\_\_\_

Peter W. Laczay,  
 P. O. Box 488  
 Coeur d'Alene, Id. 83814 Locators

121793  
 OFFICIAL RECORDS  
 EUREKA COUNTY, NEVADA  
 MIN. RECORDS DIVISION  
 FILE NO. \_\_\_\_\_  
 RECORDED AT THE REQUEST OF  
 BOOK 190 PAGE 567  
 28 NOV 14 PM 27  
 Peter Laczay

221791

Completed State of Nevada  
 County of Eureka  
 Recorder  
 Vol. of  
 Page Request of  
 19  
 County Auditor  
 Deputy  
 Mail to  
 Fee

Side center  
 SW. cor. X NW. cor.  
 Loc. Monument 50'  
 Side center cor.  
 SE. cor. NE. cor.

## CERTIFICATE OF LOCATION

STATE OF NEVADA

EUREKA

COUNTY

Mineral Hill MINING DISTRICT

This diagram contains method of description of claim.

NOTICE IS HEREBY GIVEN, That the undersigned, having complied with the requirements of Chapter Six, Title thirty-two of the Revised Statutes of the United States, and the laws of the above State, and the local customs and regulations of said district,

has located and do hereby locate 1500 linear feet in length, and 600 feet in width on the PETE 211

lode, vein, ledge or deposit (or placer ground), situated in above State, County of Mining District and further described as follows: Commencing at a post marked NE corner located about 300 feet east from the Monument of Location, thence 750 feet in a Southerly direction to a post marked East Side center, thence 750 feet in a Southerly direction to a corner post marked SE corner, thence 600 feet in a Westerly direction to a corner post marked SW corner, thence 750 feet in a Northerly direction to a post marked Westside center, thence 750 feet in a Northerly direction to a corner post marked NW corner, thence 600 feet in a Easterly direction to the NE corner hereby locating and intending to claim 1,450 feet in a Southerly direction from monument of location to the South end line, and 50 feet in the opposite direction from discovery to the North end line, and 300 feet on each side of the middle of said lode or ledge, for the purpose of mining the same and claiming all surface rights, privileges and minerals, with all dips, spurs, angles and variations, and other rights granted by existing laws and customs. This claim is further described as follows: The Monument of Location of this claim is approximately 2000 ft. southerly and 4100 ft. westerly of the NE. corner of Section 6 Township 27 N, Range 53 E. Nevada Meridian, Eureka County, Nevada.

The adjoining claims are Pete 201 on the north; Five 0496 on the south; Pete 212 on the west; Pete. 210 on the east.

The location work consisted of making & preparing maps as required in Nevada Revised Statutes 517:040. A notice of location is placed at Location Monument; Posts are placed at each corner at the center of each side line and the name of this lode and date of location, are placed on all posts.

Located this 12th day of September 1888

WITNESSES:

*Peter W. Lacey*

Peter W. Lacey,  
 P. O. Box 488  
 Coeur d'Alene, Id. 83814 Locators

OFFICIAL RECORDS  
 EUREKA COUNTY, NEVADA  
 MINERAL CLAIM RECORDER  
 FILE NO. 221791  
 FEB 8 1888

RECORDED AT THE REQUEST OF  
 BOOK 190 PAGE 568  
*Peter W. Lacey*  
 FEB 14 1888

BOOK 190 PAGE 568

121795

Contested State of \_\_\_\_\_  
 County of \_\_\_\_\_  
 Vol. \_\_\_\_\_ of \_\_\_\_\_  
 Page \_\_\_\_\_ Request of \_\_\_\_\_  
 County Auditor \_\_\_\_\_  
 Deputy \_\_\_\_\_  
 Mail to \_\_\_\_\_  
 Fee \_\_\_\_\_

Side center  
 SW. cor. X cor. NW. cor.

Loc. Monument: 50'  
 Side center cor.  
 SE. cor. NE. cor.

### CERTIFICATE OF LOCATION

STATE OF NEVADA

EUREKA

COUNTY

Mineral Hill MINING DISTRICT

This diagram explains method of description of claim.

NOTICE IS HEREBY GIVEN, That the undersigned, having complied with the requirements of Chapter Six, Title thirty-two of the Revised Statutes of the United States, and the laws of the above State, and the local customs and regulations of said district,

has located and do hereby locate 1500 linear feet in length, and 500 feet in width on the PETE 212

lode, vein, ledge or deposit (or placer ground), situated in above State, County or Mining District and further described as follows: Commencing at a post marked NE corner located about 300 feet east from the Monument of Location, thence 750 feet in a Southerly direction to a post marked East Side center, thence 750 feet in a Southerly direction to a corner post marked SE corner, thence 600 feet in a Westerly direction to a corner post marked SW corner, thence 750 feet in a Northerly direction to a post marked Westside center, thence 750 feet in a Northerly direction to a corner post marked NW corner, thence 600 feet in a Easterly direction to the NE corner hereby locating and intending to claim 1,450 feet in a Southerly direction from monument of location to the South end line, and 50 feet in the opposite direction from discovery to the

North and line, and 300 feet on each side of the middle of said lode or ledge for the purpose of gaining the same and claiming all surface rights, privileges and minerals, with all dips, spurs, angles and variations, and other rights granted by existing laws and customs. This claim is further described as follows:

The Monument of Location of this claim is approximately 2000 ft. southerly and 4700 ft. westerly of the NE. corner of Section 6

Township 27 N, Range 53 E. Nevada Meridian, Eureka County, Nevada.

The adjoining claims are Pete 202 on the north; Five 0996 on the south;

Pete 213 on the west; Pete 211 on the east.

The location work consisted of making & preparing maps as required in Nevada Revised Statutes 517:040. A notice of location is placed at Location Monument; Posts are placed at each corner at the center of each side line and the name of this lode and date of location, are placed on all posts.

Located this 12th day of September 88

WITNESSES:

Peter W. Laczay,  
 P. O. Box 488

Coeur d'Alene, Id. 83814

RECORDED AT THE REQUEST OF  
 BOOK 190 PAGE 569

Peter Laczay  
 NOV 14 1988

OFFICIAL RECORDS  
 EUREKA COUNTY, NEVADA  
 MIN. RECAL. DIV. RECORDER  
 FILE NO. 121795  
 FEE \$ 6.00

BOOK 190 PAGE 569

State of Nevada  
County of Eureka  
Request of  
County Auditor  
Deputy  
Mail to  
Fee

Side center  
SW. cor. X NW. cor.  
Loc. Monument 50'  
Side center cor.  
SE. cor. NE. cor.

### CERTIFICATE OF LOCATION

STATE OF NEVADA

EUREKA

COUNTY

Mineral Hill

MINING DISTRICT

This diagram explains method of description of claim.

NOTICE IS HEREBY GIVEN, That the undersigned, having complied with the requirements of Chapter Six, Title thirty-two of the Revised Statutes of the United States, and the laws of the above State, and the local customs and regulations of said district,

has located and do hereby locate 1500 linear feet in length, and 600 feet in width on the PETE 213.

lode, vein, ledge or deposit (or placer ground), situated in above State, County or Mining District, and further described as follows: Commencing at a post marked NE corner located about 300 feet east from the Monument of Location, thence 750 feet in a Southerly direction to a post marked East Side center, thence 750 feet in a Southerly direction to a corner post marked SE corner, thence 600 feet in a Westerly direction to a corner post marked SW corner, thence 750 feet in a Northerly direction to a post marked Westside center, thence 750 feet in a Northerly direction to a corner post marked NW corner, thence 600 feet in a Easterly direction to the NE corner hereby locating and intending to claim 1,450 feet in a Southerly direction from monument of location to the South and line, and 50 feet in the opposite direction from discovery to the

North and line, and 300 feet on each side of the middle of said lode or ledge, for the purpose of mining the same and claiming all surface rights, privileges and minerals, with all dips, opura, angles and variations, and other rights granted by existing laws and customs. This claim is further described as follows: The Monument of Location of this claim is approximately 2000 ft. southerly and 5300 ft. westerly of the NE corner of Section 6

Township 27 N, Range 53 E. Nevada Meridian, Eureka County, Nevada.

The adjoining claims are Pete 203 on the north; Five 0#96 on the south; Pete 214 on the west; Pete 212 on the east.

The location work consisted of making & preparing maps as required in Nevada Revised Statutes 517:040. A notice of location is placed at Location Monument; Posts are placed at each corner at the center of each side line and the name of this lode and date of location, are placed on all posts.

Located this 12th day of September 1908

WITNESSES:

*Peter W. Laczay*  
Peter W. Laczay,  
P. O. Box 488

Coeur d'Alene, Id. 83814 Locators

121796

OFFICIAL RECORDS  
EUREKA COUNTY RECORDER  
MIN. REBALANCE RECORDER  
FILE NO. FEE \$ 6.25

RECORDED AT THE REQUEST OF  
BOOK 190 PAGE 570  
Peter Laczay  
88 NOV 14 4 21

BOOK 190 PAGE 570

624 RV.2

121797

State of	County of	Side center cor.	SW. cor.	X	cor.	NW. cor.
RECORDED	of	Loc. Monument: 50'	Side center cor.			
Page	Request of		SE. cor.		NE. cor.	
	County Auditor		This diagram explains method of description of claim.			
	Deputy		Mineral Hill MINING DISTRICT			
Mail to			NOTICE IS HEREBY GIVEN, That the undersigned, having complied with the requirements of Chapter Six, Title thirty-two of the Revised Statutes of the United States, and the laws of the above State, and the local customs and regulations of said district,			
Fee			has located and do hereby locate 1500 linear feet in length,			

## CERTIFICATE OF LOCATION

STATE OF NEVADA

EUREKA

COUNTY

Mineral Hill

MINING DISTRICT

NOTICE IS HEREBY GIVEN, That the undersigned, having complied with the requirements of Chapter Six, Title thirty-two of the Revised Statutes of the United States, and the laws of the above State, and the local customs and regulations of said district,

has located and do hereby locate 1500 linear feet in length,

and 600 feet in width on the PETE 214.

lode, vein, ledge or deposit (or placer ground), situated in above State, County or Mining District, and further described as follows: Commencing at a post marked NE corner located about 300 feet east from the Monument of Location, thence

750 feet in a Southerly

direction to a post marked East Side center, thence 750 feet in a Southerly

direction to a corner post marked SE corner, thence 600 feet in a Westerly

direction to a corner post marked SW corner, thence 750 feet in a Northerly

direction to a post marked Westside center, thence 750 feet in a Northerly

direction to a corner post marked NW corner, thence 600 feet in a Easterly

direction to the NE. corner hereby locating and intending to claim 1,450

feet in a Southerly direction from monument of location to the South

and line, and 50 feet in the opposite direction from discovery to the

North and line, and 300 feet on each side of the middle of

said lode or ledge for the purpose of mining the same and claiming all surface rights, privileges and minerals, with all dips, spurs, angles and variations, and other rights granted by existing laws and customs. This claim is further described as follows: The Monument of Location of this claim is approximately 2000 ft.

southerly and 400 ft. westerly of the NE. corner of Section 1

Township 27 N, Range 52 E. Nevada Meridian, Eureka County, Nevada.

The adjoining claims are Pete 204 on the north; - on the south;

Pete 215 on the west; Pete 213 on the east.

The location work consisted of making & preparing maps as required in Nevada Revised

Statutes 517:040. A notice of location is placed at Location Monument; Posts are

placed at each corner at the center of each side line and the name of this lode and

date of location, are placed on all posts.

Located this 12th day of September, 1908

Witness:

Peter W. Laczay,

P. O. Box 488

Coeur d'Alene, Id. 83814 Locators

RECORDED AT THE REQUEST OF  
BOOK 190 PAGE 571  
Peter Laczay  
88 NOV 14 PM 27  
OFFICIAL RECORDS  
EUREKA COUNTY, NEVADA  
MINERAL CLAIM REGISTER  
FILE NO. 121797

BOOK 190 PAGE 571

124798

State of	County of	Side center SW.cor. X cor. NW.cor.	<b>CERTIFICATE OF LOCATION</b>
RECORDED		Loc. Monument 50'	
Vol. of	Request of	Side center cor.	STATE OF NEVADA
Page		SE.cor. NE.cor.	EUREKA COUNTY
County Auditor			Mineral Hill MINING DISTRICT
Deputy			
Mail to			
Fee			

This diagram explains method of description of claim.

NOTICE IS HEREBY GIVEN, That the undersigned, having complied with the requirements of Chapter Six, Title thirty-two of the Revised Statutes of the United States, and the laws of the above State, and the local customs and regulations of said district,

has located and do hereby locate 1500 linear feet in length,

and 600 feet in width on the PETE 215

lode, vein, ledge or deposit (or placer ground), situated in above State, County or Mining District and further described as follows: Commencing at a post marked NE corner located about 300 feet east from the Monument of Location, thence 750 feet in a Southerly direction to a post marked East Side center, thence 750 feet in a Southerly direction to a corner post marked SE corner, thence 600 feet in a Westerly direction to a corner post marked SW corner, thence 750 feet in a Northerly direction to a post marked Westside center, thence 750 feet in a Northerly direction to a corner post marked NW corner, thence 600 feet in a Easterly direction to the NE corner hereby locating and intending to claim 1,450 feet in a Southerly direction from monument of location to the South and line, and 50 feet in the opposite direction from discovery to the North and line, and 300 feet on each side of the middle of said lode or ledge for the purpose of mining the same and claiming all surface rights, privileges and minerals, with all dips, spurs, angles and variations, and other rights granted by existing laws and customs. This claim is further described as follows:

The Monument of Location of this claim is approximately 2000 ft. southerly and 1000 ft. westerly of the NE corner of Section 1

Township 27 N, Range 52 E, Nevada Meridian, Eureka County, Nevada.

The adjoining claims are Pete 205 on the north; on the south; Pete 216 on the west; Pete 214 on the east.

The location work consisted of making & preparing maps as required in Nevada Revised Statutes 517:040. A notice of location is placed at Location Monument; Posts are placed at each corner at the center of each side line and the name of this lode and date of location, are placed on all posts.

Located this 12th day of September, 1988

WITNESSES:

*Peter W. Laczay*  
Peter W. Laczay,  
P. O. Box 488  
Coeur d'Alene, Id. 83814 Locators

RECORDED AT THE REQUEST OF  
BOOK 190 PAGE 572  
*Peter Laczay*  
88 NOV 14 4 27  
OFFICIAL RECORDS  
EUREKA COUNTY, NEVADA  
MINERAL CLAIM RECORDER  
FILE NO. 625  
124798

BOOK 190 PAGE 572



121799

State of \_\_\_\_\_  
 County of \_\_\_\_\_  
 Recorder \_\_\_\_\_  
 Vol. \_\_\_\_\_ of \_\_\_\_\_  
 Page \_\_\_\_\_ Request of \_\_\_\_\_  
 \_\_\_\_\_  
 County Auditor \_\_\_\_\_  
 Deputy \_\_\_\_\_  
 Mail to \_\_\_\_\_  
 Fee \_\_\_\_\_

Side center  
 SW. cor. X cor. NW. cor.  
 Loc. Monument 50'  
 Side center cor.  
 SE. cor. NE. cor.

## CERTIFICATE OF LOCATION

STATE OF NEVADA

EUREKA

COUNTY

Mineral Hill

MINING DISTRICT

This diagram explains method of description of claim.

NOTICE IS HEREBY GIVEN That the undersigned, having complied with the requirements of Chapter Six, Title thirty-two of the Revised Statutes of the United States, and the laws of the above State, and the local customs and regulations of said district,

has located and do hereby locate 1500 linear feet in length, and 600 feet in width on the PETE 216

lode, vein, ledge or deposit (or placer ground), situated in above State, County or Mining District and further described as follows: Commencing at a post marked NE corner located about 300 feet east from the Monument of Location, thence 750 feet in a Southerly direction to a post marked East Side center, thence 750 feet in a Southerly direction to a corner post marked SE corner, thence 600 feet in a Westerly direction to a corner post marked SW corner, thence 750 feet in a Northerly direction to a post marked Westside center, thence 750 feet in a Northerly direction to a corner post marked NW corner, thence 600 feet in a Easterly direction to the NE corner hereby locating and intending to claim 1,450 feet in a Southerly direction from monument of location to the South end line, and 50 feet in the opposite direction from discovery to the

North end line, and 300 feet on each side of the middle of said lode or ledge, for the purpose of mining the same and claiming all surface rights, privileges and minerals, with all dips, spurs, angles and variations, and other rights granted by existing laws and customs. This claim is further described as follows: The Monument of Location of this claim is approximately 2000 ft. southerly and 1600 ft. westerly of the NE. corner of Section 1

Township 27 N, Range 52 E. Nevada Meridian, Eureka County, Nevada.

The adjoining claims are Pete 206 on the north; on the south; Pete 217 on the west; Pete 215 on the east.

The location work consisted of making & preparing maps as required in Nevada Revised Statutes 517:040. A notice of location is placed at Location Monument; Posts are placed at each corner at the center of each side line and the name of this lode and date of location, are placed on all posts.

Located this 12th day of September 1988

WITNESSES:

*Peter W. Laczay*

Peter W. Laczay,  
P. O. Box 488

Coeur d'Alene, Id. 83814

Locators

121799

OFFICIAL RECORDS  
EUREKA COUNTY, NEVADA  
MINERAL DISTRICT RECORDER  
FILE NO. 621

RECORDED AT THE REQUEST OF  
BOOK 190 PAGE 573  
Peter W. Laczay  
88 NOV 14 PM 2:27

624 RV-2

BOOK 190 PAGE 573

121800

Compared \_\_\_\_\_  
 State of \_\_\_\_\_ County of \_\_\_\_\_  
 RECORDED  
 Vol. \_\_\_\_\_ of \_\_\_\_\_  
 Page \_\_\_\_\_ Request of \_\_\_\_\_  
 \_\_\_\_\_  
 \_\_\_\_\_  
 County Auditor  
 Deputy  
 Mail to \_\_\_\_\_  
 \_\_\_\_\_  
 Fee \_\_\_\_\_

Side center  
SW. cor. X cor. NW. cor.

**CERTIFICATE OF LOCATION**

STATE OF NEVADA  
EUREKA COUNTY

Mineral Hill MINING DISTRICT

Loc. Monument 50'  
Side center cor.

SE. cor. NE. cor.

This diagram explains method of description of claim.

NOTICE IS HEREBY GIVEN, That the undersigned, having complied with the requirements of Chapter Six, Title thirty-two of the Revised Statutes of the United States, and the laws of the above State, and the local customs and regulations of said district, has located and do hereby locate 1500 linear feet in length, and 600 feet in width on the PETE 217.

lode, vein, ledge or deposit (or placer ground), situated in above State, County or Mining District, and further described as follows: Commencing at a post marked NE corner located about 300 feet east from the Monument of Location, thence 750 feet in a Southerly direction to a post marked East Side center, thence 750 feet in a Southerly direction to a corner post marked SE corner, thence 600 feet in a Westerly direction to a corner post marked SW corner, thence 750 feet in a Northerly direction to a post marked Westside center, thence 750 feet in a Northerly direction to a corner post marked NW corner, thence 600 feet in a Easterly direction to the NE corner hereby locating and intending to claim 1,450 feet in a Southerly direction from monument of location to the South end line, and 50 feet in the opposite direction from discovery to the

North end line, and 300 feet on each side of the middle of said lode or ledge, for the purpose of mining the same and claiming all surface rights, privileges and minerals, with all dips, spurs, angles and variations, and other rights granted by existing laws and customs. This claim is further described as follows: The Monument of Location of this claim is approximately 2000 ft. southerly and 2100 ft. westerly of the NE. corner of Section 1

Township 27 N, Range 52 E, Nevada Meridian, Eureka County, Nevada.  
The adjoining claims are Pete 207 on the north; - on the south;  
Pete 218 on the west; Pete 216 on the east.

The location work consisted of making & preparing maps as required in Nevada Revised Statutes 517:040. A notice of location is placed at Location Monument; Posts are placed at each corner at the center of each side line and the name of this lode and date of location, are placed on all posts.

Located this 12th day of September 1888

WITNESSES:

Peter W. Laczay,  
P. O. Box 488  
Coeur d'Alene, Id. 83814 Locators

121800

OFFICIAL RECORDS  
 EUREKA COUNTY, NEVADA  
 MIN. REGISTRAR, RECORDER  
 FILE NO. 621

RECORDED AT THE REQUEST OF  
 BOOK 190 PAGE 574  
John D. Laczay  
 88 NOV 14 PM 2:27

BOOK 190 PAGE 574

State of	County of	Side center SW. COR. X COR. NW. COR.	<b>CERTIFICATE OF LOCATION</b>
DISCUSSION		Loc. Monument 50'	
Vol. of	Request of	Side center cor.	STATE OF NEVADA
Page		SE. COR. NE. COR.	EUREKA COUNTY
County Auditor			Mineral Hill MINING DISTRICT
Deputy			
Mail to			
Fee			

This diagram explains method of description of claim.

NOTICE IS HEREBY GIVEN, That the undersigned, having complied with the requirements of Chapter Six, Title thirty-two of the Revised Statutes of the United States, and the laws of the above State, and the local customs and regulations of said district,

has located and do hereby locate 1500 linear feet in length, and 600 feet in width on the PETE 218

lode, vein, ledge or deposit (or placer ground), situated in above State, County or Mining District and further described as follows: Commencing at a post marked NE corner located about 300 feet east from the Monument of Location, thence 750 feet in Southerly direction to a post marked East Side center, thence 750 feet in Southerly direction to a corner post marked SE corner, thence 600 feet in Westerly direction to a corner post marked SW corner, thence 750 feet in Northerly direction to a post marked Westside center, thence 750 feet in Northerly direction to a corner post marked NW corner, thence 600 feet in Easterly direction to the NE corner hereby locating and intending to claim 1,450 feet in a Southerly direction from monument of location to the South end line, and 50 feet in the opposite direction from discovery to the North end line, and 300 feet on each side of the middle of

said lode or ledge, for the purpose of mining the same and claiming all surface rights, privileges and minerals, with all dips, spurs, angles and variations, and other rights granted by existing laws and customs. This claim is further described as follows: The Monument of Location of this claim is approximately 2000 ft.

southerly and 2600 ft. westerly of the NE corner of Section 1

Township 27 N, Range 52 E, Nevada Meridian, Eureka County, Nevada.

The adjoining claims are Pete 208 on the north; - on the south; Pete 219 on the west; Pete 217 on the east.

The location work consisted of making & preparing maps as required in Nevada Revised Statutes 517:040. A notice of location is placed at Location Monument; Posts are placed at each corner at the center of each side line and the name of this lode and date of location, are placed on all posts.

Located this 12th day of September, 98

WITNESSES:

Peter W. Laczay  
Peter W. Laczay,  
P. O. Box 488  
Coeur d'Alene, Id. 83814 Locators

121801

OFFICIAL RECORDS  
EUREKA COUNTY, NEVADA  
MIN. RECALCULATED RECORDS  
FILE NO. FEE \$ 2.50

RECORDED AT THE REQUEST OF  
BOOK 190 PAGE 575  
Peter Laczay  
28 NOV 14 PM 4:27

121802

Numbered \_\_\_\_\_  
 State of \_\_\_\_\_  
 County of \_\_\_\_\_  
 RECORDED \_\_\_\_\_  
 Vol. \_\_\_\_\_ of \_\_\_\_\_  
 Page \_\_\_\_\_ Request of \_\_\_\_\_  
 \_\_\_\_\_  
 \_\_\_\_\_  
 County Auditor  
 Deputy  
 Mail to \_\_\_\_\_  
 Fee \_\_\_\_\_

Side center  
 SW. cor. X cor. NW. cor.

Loc. Monument: 50'  
 Side center cor.

SE. cor. NE. cor.

This diagram explains method of description of claim.

## CERTIFICATE OF LOCATION

STATE OF NEVADA

EUREKA

COUNTY

Mineral Hill MINING DISTRICT

NOTICE IS HEREBY GIVEN, That the undersigned, having complied with the requirements of Chapter Six, Title thirty-two of the Revised Statutes of the United States, and the laws of the above State, and the local customs and regulations of said district,

has located and do hereby locate 1500 linear feet in length,

and 600 feet in width on the PETE 219

lode, vein, ledge or deposit (or placer ground), situated in above State, County or Mining District and further described as follows: Commencing at a post marked NE corner located about 300 feet east from

the Monument of Location, thence 750 feet in a Southerly

direction to a post marked East Side center, thence 750 feet in a Southerly

direction to a corner post marked SE corner, thence 600 feet in a Westerly

direction to a corner post marked SW corner, thence 750 feet in a Northerly

direction to a post marked Westside center, thence 750 feet in a Northerly

direction to a corner post marked NW corner, thence 600 feet in a Easterly

direction to the NE. corner hereby locating and intending to claim 1,450

feet in a Southerly direction from monument of location to the South

and line, and 50 feet in the opposite direction from discovery to the

North end line, and 300 feet on each side of the middle of

said lode or ledge for the purpose of mining the same and claiming all surface rights, privileges and minerals, with all dips, apures, angles and variations, and other rights granted by existing laws and customs. This claim is further described as follows: The Monument of Location of this claim is approximately 2000 ft.

southerly and 3200 ft. westerly of the NE. corner of Section 1

Township 27 N, Range 52 E. Nevada Meridian, Eureka County, Nevada.

The adjoining claims are Pete 209 on the north; - on the south;

Pete 228 on the west; Pete 218 on the east.

The location work consisted of making & preparing maps as required in Nevada Revised

Statutes 517:040. A notice of location is placed at Location Monument; Posts are

placed at each corner at the center of each side line and the name of this lode and

date of location, are placed on all posts.

Located this 21st day of September 1908

WITNESSES: \_\_\_\_\_

*Peter W. Laczay*

Peter W. Laczay,

P. O. Box 488

Coeur d' Alene, Id. 83814 Locators

121802

OFFICE RECORDS  
 EUREKA COUNTY, NEVADA  
 M. H. BUCKLEY, RECORDER  
 FILE NO. 621

RECORDED AT THE REQUEST OF  
 BOOK 190 PAGE 576  
*Peter Laczay*  
 NOV 14 1908

624 REV. 20

BOOK 190 PAGE 576

124803

Numbered state of	County of	W. cor.	W. side center	NW cor.	124803	
RECORDED	NO	50' x Loc. Monument		CERTIFICATE OF LOCATION		
Vol. of	Page	E. side center		STATE OF NEVADA		
Request of	ID	SE. cor.	NE. cor.	EUREKA COUNTY		
County Auditor	Deputy	This diagram explains method of description of claim.		Mineral Hill MINING DISTRICT		
Mail to	Fee	NOTICE IS HEREBY GIVEN, That the undersigned, having complied with the requirements of Chapter Six, Title thirty-two of the Revised Statutes of the United States, and the laws of the above State, and the local customs and regulations of said district,		has located and do hereby locate 1500 linear feet in length,		

and 600 feet in width on the PETE 227

lead, vein, ledge or deposit (or placer ground), situated in above State, County or Mining District, and further described as follows: Commencing at a post marked SE corner located about 300' east from the monument of location, thence 750 feet to Northerly direction to a Eastside center post marked, thence 750 feet to Northerly direction to a corner post marked NE corner, thence 600 feet to Westerly direction to a corner post marked NW corner, thence 750 feet to Southeasterly direction to a post marked Westside Center, thence 750 feet to Southerly direction to a corner post marked SW corner, thence 600 feet to Easterly direction to the SE. corner hereby locating and intending to claim 1450 feet in a northerly direction from monument of location to the north and line, and 50 feet in the opposite direction from discovery to the south and line, and 300 feet on each side of the middle of said line or ledge, for the purpose of mining the same and claiming all surface rights, privileges and minerals, with all dips, spurs, angles and variations, and other rights granted by existing laws and customs. This claim is further described as follows: The Monument of Location of this claim is approximately 2000 ft. southerly and 3800 ft. westerly of the NE. corner of Section 1 Township 27 N, Range 52 E, Nevada Meridian, Eureka County, Nevada.

The adjoining claims are on the north; Pete 228 on the south; Pete 229 on the west; Pete 209 on the east.

The location work consisted of making & preparing maps as required in Nevada Revised Statutes 517:040. A notice of location is placed at Location Monument; Posts are placed at each corner at the center of each side line and the name of this lode and date of location, are placed on all posts.

Located this 21st day of September, 1900.

WITNESSES:

*Peter W. Laczay*  
Peter W. Laczay,  
P. O. Box 488  
Coeur d'Alene, Id. 83814 Locators

124803

RECORDED AT THE REQUEST OF  
SECTION 190 PAGE 577  
Pete Laczay  
SEP 14 1900  
FILED

BOOK 190 PAGE 577

Unimproved  
State of  
County of  
Request of  
County Auditor  
Deputy  
Mail to  
Fee

121801  
W. cor. W. side center NW cor.  
50' x Loc. Monument  
E. side center NE cor.

# CERTIFICATE OF LOCATION

STATE OF NEVADA

Mineral Hill

MINING DISTRICT

This diagram explains method of description of claim.

NOTICE IS HEREBY GIVEN, That the undersigned, having complied with the requirements of Chapter Six, Title thirty-two of the Revised Statutes of the United States, and the laws of the above State, and the local customs and regulations of said district,

has located and do hereby locate 1500 linear feet in length, and 600 feet in width on the

PETE 228

lode, vein, ledge or deposit (or placer ground), situated in above State, County or Mining District, and further described as follows: Commencing at a post marked SE corner located about 300' east from the monument of location, thence

750 feet to Southerly  
direction to a Eastside center post marked, thence 750 feet to Southerly  
direction to a corner post marked NE corner, thence 600 feet to Westerly  
direction to a corner post marked NW corner, thence 750 feet to Northeasterly  
direction to a post marked Westside Center, thence 750 feet to Northerly  
direction to a corner post marked SW corner, thence 600 feet to Easterly

direction to the SE corner hereby locating and intending to claim 1450 feet in a Southerly direction from monument of location to the South end line, and 50 feet in the opposite direction from discovery to the North and line, and 300 feet on each side of the middle of

said lode or ledge for the purpose of mining the same and claiming all surface rights, privileges and minerals, with all dips, spurs, angles and variations, and other rights granted by existing laws and customs. This claim is further described as follows: The Monument of Location of this claim is approximately 2000 ft. southerly and 3800 ft. westerly of the NE. corner of Section 1

Township 27 N, Range 52 E, Nevada Meridian, Eureka County, Nevada.

The adjoining claims are Pete 227 on the north; Pete on the south; Pete 230 on the west; Pete 219 on the east.

The location work consisted of making & preparing maps as required in Nevada Revised Statutes 517:040. A notice of location is placed at Location Monument; Posts are placed at each corner at the center of each side line and the name of this lode and date of location, are placed on all posts.

Located this 21 th day of September 1908

WITNESSES:

*Peter W. Laczay*

Peter W. Laczay,  
P. O. Box 488  
Cosumnes, Id. 83814 Locators

OFFICIAL RECORDS  
EUREKA COUNTY, NEVADA  
RECORDS CLERK  
FILE NO. 121801  
FEE \$ 6.25

RECORDED AT THE REQUEST OF  
8004 1908 PAGE 578  
Peter Laczay  
28 NOV 14 PM 4:21

BOOK 190 PAGE 578

121805

Prepared by Name of	State of	County of	W. cor.	W. side center	NW cor.	CERTIFICATE OF LOCATION
50' x Loc. Monument						
Vol. of	Request of		E. side center	NE cor.	EUREKA	COUNTY
Page	County Auditor		SE cor.	Mineral Hill MINING DISTRICT		
to	Deputy		This diagram explains method of description of claim.			
Mail to	NOTICE IS HEREBY GIVEN, That the undersigned, having complied with the requirements of Chapter Six, Title thirty-two of the Revised Statutes of the United States, and the laws of the above State, and the local customs and regulations of said district,					
Fee	has located and do hereby locate 1500 linear feet in length,					
	and 600 feet in width on the PETE 229.					

lode, vein, ledge or deposit (or placer ground), situated in above State, County or Mining District, and further described as follows: Commencing at a post marked SE corner located about 300' east from the monument of location, thence 750 feet in a Northerly direction to a Eastside center post marked, thence 750 feet in a Northerly direction to a corner post marked NE corner, thence 600 feet in a Westerly direction to a corner post marked NW corner, thence 750 feet in a Southeasterly direction to a post marked Westside Center, thence 750 feet in a Southerly direction to a corner post marked SW corner, thence 600 feet in a Easterly direction to the SE corner hereby locating and intending to claim 1450 feet in a northerly direction from monument of location to the north and 50 feet in the opposite direction from discovery to the south and 300 feet on each side of the middle of said lode or ledge for the purpose of mining the same and claiming all surface rights, privileges and minerals, with all dips, spurs, angles and variations, and other rights granted by existing laws and customs. This claim is further described as follows:

The Monument of Location of this claim is approximately 2000 ft. southerly and 4400 ft. westerly of the NE. corner of Section 1, Township 27 N, Range 52 E, Nevada Meridian, Eureka County, Nevada. The adjoining claims are on the north; Pete 230 on the south; Pete 231 on the west; Pete 227 on the east.

The location work consisted of making & preparing maps as required in Nevada Revised Statutes 517:040. A notice of location is placed at Location Monument; Posts are placed at each corner at the center of each side line and the name of this lode and date of location, are placed on all posts.

Located this 21st day of September, 1908.

WITNESSES:

*Peter W. Laczay*  
Peter W. Laczay,  
P. O. Box 488  
Coeur d'Alene, Id. 83814 Locators

121805

OFFICIAL RECORDS  
EUREKA COUNTY, NEVADA  
MINERAL CLAIM RECORDER  
FILE NO. 621

RECORDED AT THE REQUEST OF  
88 NOV 14 P 4 27  
1908

BOOK 190 PAGE 579  
*Pete Laczay*

BOOK 190 PAGE 579

121806

Compared State of RECORDER Vol. of Page Request of is County Auditor Deputy Mail to Fee	Side center SW. cor. X cor. NW. cor. Loc. Monument: 50' Side center cor. SE. cor. NE. cor. This diagram explains method of description of claim. NOTICE IS HEREBY GIVEN, That the undersigned, having complied with the requirements of Chapter Six, Title thirty-two of the Revised Statutes of the United States, and the laws of the above State, and the local customs and regulations of said district, has located and do hereby locate 1500 linear feet in length, and 600 feet in width on the PETE 230	<b>CERTIFICATE OF LOCATION</b> STATE OF NEVADA EUREKA COUNTY Mineral Hill MINING DISTRICT
--------------------------------------------------------------------------------------------------------------------	-----------------------------------------------------------------------------------------------------------------------------------------------------------------------------------------------------------------------------------------------------------------------------------------------------------------------------------------------------------------------------------------------------------------------------------------------------------------------------------------------------------------------------------	----------------------------------------------------------------------------------------------------

lode, vein, ledge or deposit (or placer ground), situated in above State, County or Mining District, and further described as follows: Commencing at a post marked NE corner located about 300 feet east from the Monument of Location, thence 750 feet in a Southerly direction to a post marked East Side center, thence 750 feet in a Southerly direction to a corner post marked SE corner, thence 600 feet in a Westerly direction to a corner post marked SW corner, thence 750 feet in a Northerly direction to a post marked Westside center, thence 750 feet in a Northerly direction to a corner post marked NW corner, thence 600 feet in a Easterly direction to the NE. corner hereby locating and intending to claim 1,450 feet in a Southerly direction from monument of location to the South end line, and 50 feet in the opposite direction from discovery to the North and line, and 300 feet on each side of the middle of said lode or ledge, for the purpose of mining the same and claiming all surface rights, privileges and minerals, with all dips, apura, angles and variations, and other rights granted by existing laws and customs. This claim is further described as follows: The Monument of Location of this claim is approximately 2000 ft. southerly and 4400 ft. westerly of the NE. corner of Section 1

Township 27 N, Range 52 E, Nevada Meridian, Eureka County, Nevada.

The adjoining claims are Pete 229 on the north; - on the south;

Pete 232 on the west; Pete 228 on the east.

The location work consisted of making & preparing maps as required in Nevada Revised Statutes 517:040. A notice of location is placed at Location Monument; Posts are placed at each corner at the center of each side line and the name of this lode and date of location, are placed on all posts.

Located this 21st day of September, 88.

WITNESSES:

*Peter W. Laczay*  
 Peter W. Laczay,  
 P. O. Box 488

Coeur d' Alene, Id. 83814

Locators

121806

OFFICIAL RECORDS  
 EUREKA COUNTY, NEVADA  
 MINERAL, MINE, & PITCHBLIND  
 FILE NO. 25

RECORDED AT THE REQUEST OF  
 BOOK 190 PAGE 580  
 Peter Laczay  
 28 NOV 14 1988

BOOK 190 PAGE 580



121807

Compared to State of	County of	SW COR.	W. side center	NW COR.	<b>CERTIFICATE OF LOCATION</b>	
50' x Loc. Monument		E. side center		STATE OF NEVADA		
Request of		SE COR.		EUREKA COUNTY		
County Auditor		NE COR.		Mineral Hill MINING DISTRICT		
Deputy		This diagram explains method of description of claim.				
Mail to		NOTICE IS HEREBY GIVEN, That the undersigned, having complied with the requirements of Chapter Six, Title thirty-two of the Revised Statutes of the United States, and the laws of the above State, and the local customs and regulations of said district,				
Fee		has located and do hereby locate 1500 linear feet in length,				
		and 600 feet in width on the PETE 231.				

leads, vein, ledge or deposit (or placer ground), situated in above State, County or Mining District, and further described as follows: Commencing at a post marked SE corner located about 300' east from the monument of location, thence 750 feet in a Northerly direction to a Eastside center post marked, thence 750 feet in a Northerly direction to a corner post marked NE corner, thence 600 feet in a Westerly direction to a corner post marked NW corner, thence 750 feet in a Southeasterly direction to a post marked Westside Center, thence 750 feet in a Southerly direction to a corner post marked SW corner, thence 600 feet in a Easterly direction to the SE corner hereby locating and intending to claim 1450 feet in a northerly direction from monument of location to the north end line, and 50 feet in the opposite direction from discovery to the south and line, and 300 feet on each side of the middle of said lode or ledge for the purpose of mining the same and claiming all surface rights, privileges and minerals, with all dips, apura, angles and variations, and other rights granted by existing laws and customs. This claim is further described as follows:

The Monument of Location of this claim is approximately 2000 ft. southerly and 5000 ft. westerly of the NE. corner of Section 1, Township 27 N, Range 52 E, Nevada Meridian, Eureka County, Nevada. The adjoining claims are on the north; Pete 232 on the south; Pete 233 on the west; Pete 229 on the east.

The location work consisted of making & preparing maps as required in Nevada Revised Statutes 517:040. A notice of location is placed at Location Monument; Posts are placed at each corner at the center of each side line and the name of this lode and date of location, are placed on all posts.

Located this 21st day of September 1888

WITNESSES:

*Peter W. Laczay*  
Peter W. Laczay.  
P. O. Box 488  
Coeur d'Alene, Id. 83814 Locators

121807  
OFFICIAL RECORDS  
EUREKA COUNTY, NEVADA  
FILE NO. 6  
FEE \$ 6.50

RECORDED AT THE REQUEST OF  
BOOK 190 PAGE 581  
Peter W. Laczay  
88 NOV 14 1888 PA 270

BOOK 190 PAGE 581

221808

Recorded State of	County of	SW cor.	W. side center	NW cor.	CERTIFICATE OF LOCATION STATES OF NEVADA EUREKA COUNTY Mineral Hill MINING DISTRICT
RECORDED		50' x Loc. Monument	E. side center	NE cor.	
Vol. of	Request of	SE cor.	This diagram explains method of description of claim.		
Page	19	County Auditor	NOTICE IS HEREBY GIVEN, That the undersigned, having complied with the requirements of Chapter Six, Title thirty-two of the Revised Statutes of the United States, and the laws of the above State, and the local customs and regulations of said district,		
	County Auditor Deputy	has located and do hereby locate 1500 linear feet in length,			
Mail to		and 600 feet in width on the PETE 232.			
Fee					

lode, vein, ledge or deposit (or placer ground), situated in above State, County or Mining District, and further described as follows: Commencing at a post marked SE corner located about 300' east from the monument of location, thence 750 feet in a Southerly direction to a Eastside center post marked, thence 750 feet in a Southerly direction to a corner post marked NE corner, thence 600 feet in a Westerly direction to a corner post marked NW corner, thence 750 feet in a Northeasterly direction to a post marked Westside Center, thence 750 feet in a Northerly direction to a corner post marked SW corner, thence 600 feet in a Easterly direction to the SE corner hereby locating and intending to claim 1450 feet in a Southerly direction from monument of location to the South end line, and 50 feet in the opposite direction from discovery to the North and line, and 300 feet on each side of the middle of

said lode or ledge, for the purpose of mining the same and claiming all surface rights, privileges and minerals, with all dips, spurs, angles and variations, and other rights granted by existing laws and customs. This claim is further described as follows: The Monument of Location of this claim is approximately 2000 ft. southerly and 5000 ft. westerly of the NE. corner of Section 1,

Township 27 N, Range 52 E, Nevada Meridian, Eureka County, Nevada.

The adjoining claims are Pete 231 on the north; - on the south;

Pete 234 on the west; Pete 230 on the east.

The location work consisted of making & preparing maps as required in Nevada Revised Statutes 517:040. A notice of location is placed at Location Monument; Posts are placed at each corner at the center of each side line and the name of this lode and date of location, are placed on all posts.

Located this 21st day of September 1908

WITNESSES:

*Peter W. Laczay*

Peter W. Laczay,  
P. O. Box 488  
Coeur d'Alene, Id. 83814 Locators

221808

OFFICIAL RECORDS  
EUREKA COUNTY, NEVADA  
M. W. REBALSON, RECORDER  
FEE \$ 6.25

88 NOV 14 P 4 27

RECORDED AT THE REQUEST OF

BOOK 190 PAGE 582

BOOK 190 PAGE 582

121809

Recorded State of	Record County of	SW.cor.	W.side center	NW.cor.	CERTIFICATE OF LOCATION
RECORDED	00	50' x Loc. Monument		STATE OF NEVADA	
Vol.	of	SE.cor.	E.side center	NE.cor.	EUREKA
Page	Request of	Mineral Hill		COUNTY	
19		MINING DISTRICT			
County Auditor	Deputy	This diagram explains method of description of claim.			
Mail to		NOTICE IS HEREBY GIVEN, That the undersigned, having complied with the requirements of Chapter Six, Title thirty-two of the Revised Statutes of the United States, and the laws of the above State, and the local customs and regulations of said district,			
Fee		has located and do hereby locate 1500 linear feet in length,			
		and 600 feet in width on the PETE 233.			

lode, vein, ledge or deposit (or placer ground), situated in above State, County or Mining District, and further described as follows: Commencing at a post marked SE corner located about 300' east from the monument of location, thence 750 feet to Northerly direction to a Eastside center post marked, thence 750 feet to Northerly direction to a corner post marked NE corner, thence 600 feet to Westerly direction to a corner post marked NW corner, thence 750 feet to Southeasterly direction to a post marked Westside Center, thence 750 feet to Southerly direction to a corner post marked SW corner, thence 600 feet to Easterly direction to the SE corner hereby locating and including to claim 1450 feet in a northerly direction from monument of location to the north end line, and 50 feet in the opposite direction from discovery to the south and line, and 300 feet on each side of the middle of said lode or ledge for the purpose of mining the same and claiming all surface rights, privileges and minerals, with all dips, spurs, angles and variations, and other rights granted by existing laws and customs. This claim is further described as follows: The Monument of Location of this claim is approximately 2000 ft. southerly and 300 ft. westerly of the NE. corner of Section 2

Township 27 N, Range 52 E, Nevada Meridian, Eureka County, Nevada.  
The adjoining claims are on the north; Pete 234 on the south; Pete 235 on the west; Pete 231 on the east.

The location work consisted of making & preparing maps as required in Nevada Revised Statutes 517:040. A notice of location is placed at Location Monument; Posts are placed at each corner at the center of each side line and the name of this lode and date of location, are placed on all posts.

Located this 21st day of September, 1888.

WITNESSES:

*Peter W. Laczay*  
Peter W. Laczay,  
P. O. Box 488  
Coeur d'Alene, Id. 83814 Locators

121809

OFFICIAL RECORDS  
EUREKA COUNTY, NEVADA  
MIN. RECL. DIV. REC'D  
FILE NO. 121809  
FEE \$ 0.50

RECORDED AT THE REQUEST OF  
BOOK 190 PAGE 583  
Peter Laczay  
88 NOV 14 10 28 AM '88

BOOK 190 PAGE 583

RECORDED  
 Vol. \_\_\_\_\_ of \_\_\_\_\_  
 Page \_\_\_\_\_ Request of \_\_\_\_\_  
 \_\_\_\_\_  
 \_\_\_\_\_  
 County Auditor  
 Deputy \_\_\_\_\_  
 Mail to \_\_\_\_\_  
 Fee \_\_\_\_\_

Loc. Mineral Hill  
 STATE OF NEVADA  
 Side center cor. EUREKA COUNTY  
 SE. cor. NE. cor. Mineral Hill MINING DISTRICT  
 This diagram explains method of description of claim.

NOTICE IS HEREBY GIVEN, That the undersigned, having complied with the requirements of Chapter Six, Title Thirty-two of the Revised Statutes of the United States, and the laws of the above State, and the local customs and regulations of said district,

has located and do hereby locate 1500 linear feet in length, and 600 feet in width on the PETE 234

lode, vein, ledge or deposit (or placer ground), situated in above State, County or Mining District, and further described as follows: Commencing at a post marked NE corner located about 300 feet east from the Monument of Location, thence 750 feet in a Southerly direction to a post marked East Side center, thence 750 feet in a Southerly direction to a corner post marked SE corner, thence 600 feet in a Westerly direction to a corner post marked SW corner, thence 750 feet in a Northerly direction to a post marked Westside center, thence 750 feet in a Northerly direction to a corner post marked NW corner, thence 600 feet in a Easterly direction to the NE corner hereby locating and intending to claim 1,450 feet in a Southerly direction from monument of location to the South end line, and 50 feet in the opposite direction from discovery to the North end line, and 300 feet on each side of the middle of

said lode or ledge, for the purpose of mining the same and claiming all surface rights, privileges and minerals, with all dips, spurs, angles and variations, and other rights granted by existing laws and customs. This claim is further described as follows: The Monument of Location of this claim is approximately 2000 ft. southerly and 300 ft. westerly of the NE. corner of Section 2

Township 27 N, Range 52 E, Nevada Meridian, Eureka County, Nevada.  
 The adjoining claims are Pete 233 on the north; \_\_\_\_\_ on the south;  
 Pete 236 on the west; Pete 232 on the east.

The location work consisted of making & preparing maps as required in Nevada Revised Statutes 517:040. A notice of location is placed at Location Monument; Posts are placed at each corner at the center of each side line and the name of this lode and date of location, are placed on all posts.

Located this 21st day of September, 1988.

WITNESSES:

*Peter W. Laczay*  
 Peter W. Laczay,  
 P. O. Box 488  
 Coeur d'Alene, Id. 83814 Locators

121810

OFFICIAL RECORDS  
 EUREKA COUNTY, NEVADA  
 MINERAL DISTRICT RECORDER  
 FILE NO. 88

RECORDED AT THE REQUEST OF  
 BOOK 190 PAGE 584  
 Peter Laczay  
 88 NOV 14 PM 5:08

BOOK 190 PAGE 584

CERTIFICATE OF LOCATION

50' x 100' Monument  
 E. side center  
 STATE OF NEVADA  
 EUREKA COUNTY  
 Mineral Hill MINING DISTRICT  
 This diagram explains method of description of claim.  
 NOTICE IS HEREBY GIVEN, That the undersigned, having complied with the requirements of Chapter Six, Title thirty-two of the Revised Statutes of the United States, and the laws of the above State, and the local customs and regulations of said district,  
 has located and do hereby locate 1500 linear feet in length,  
 and 600 feet in width on the PETE 235

lode, vein, ledge or deposit (or placer ground), situated in above State, County or Mining District, and further described as follows: Commencing at a post marked SE corner located about 300' east from the monument of location, thence 750 feet in Northerly direction to a Eastside center post marked, thence 750 feet in Northerly direction to a corner post marked NE corner, thence 600 feet in Westerly direction to a corner post marked NW corner, thence 750 feet in Southeasterly direction to a post marked Westside Center, thence 750 feet in Southerly direction to a corner post marked SW corner, thence 600 feet in Easterly direction to the SE corner hereby locating and intending to claim 1450 feet in a northerly direction from monument of location to the north end line, and 50 feet in the opposite direction from discovery to the south and line, and 300 feet on each side of the middle of said lode or ledge for the purpose of mining the same and claiming all surface rights, privileges and minerals, with all dips, opura, angles and variations, and other rights granted by existing laws and customs. This claim is further described as follows: The Monument of Location of this claim is approximately 2000 ft. southerly and 800 ft. westerly of the NE corner of Section 2

Township 27 N, Range 52 E, Nevada Meridian, Eureka County, Nevada.  
 The adjoining claims are on the north; Pete 236 on the south; Pete 237 on the west; Pete 233 on the east.

The location work consisted of making & preparing maps as required in Nevada Revised Statutes 517:040. A notice of location is placed at Location Monument; Posts are placed at each corner at the center of each side line and the name of this lode and date of location, are placed on all posts.

Located this 21st day of September 1988

WITNESSES:

*Peter W. Laczay*  
 Peter W. Laczay  
 P. O. Box 488  
 Coeur d'Alene, Id. 83814

RECORDED AT THE REQUEST OF  
 90th 190 PAGE 585  
*Peter Laczay*  
 88 NOV 14 PA 28

121811

OFFICIAL RECORDS  
 EUREKA COUNTY, NEVADA  
 FILE NO. REC 8 625

BOOK 190 PAGE 585

121812

Completed State of NEVADA  
 County of \_\_\_\_\_  
 Vol. \_\_\_\_\_ of \_\_\_\_\_  
 Page \_\_\_\_\_ Request of \_\_\_\_\_  
 \_\_\_\_\_  
 County Auditor \_\_\_\_\_ Deputy \_\_\_\_\_  
 Mail to \_\_\_\_\_  
 Fee \_\_\_\_\_

Side center  
 SW. cor. X cor. NW. cor.  
 Loc. Monument 50'  
 Side center cor.  
 SE. cor. NE. cor.

**CERTIFICATE OF LOCATION**  
 STATE OF NEVADA  
 EUREKA COUNTY  
 Mineral Hill MINING DISTRICT

NOTICE IS HEREBY GIVEN That the undersigned, having complied with the requirements of Chapter Six, Title thirty-two of the Revised Statutes of the United States, and the laws of the above State, and the local customs and regulations of said district,

has located and do hereby locate 1500 linear feet in length,  
 and 600 feet in width on the PETE 236  
 lode, vein, ledge or deposit (or placer ground), situated in above State, County or Mining District, and further described as follows: Commencing at a post marked NE corner located about 300 foot east from  
the Monument of Location, thence 750 foot in a Southerly  
 direction to a post marked East Side center, thence 750 foot in a Southerly  
 direction to a corner post marked SE corner, thence 600 foot in a Westerly  
 direction to a corner post marked SW corner, thence 750 foot in a Northerly  
 direction to a post marked Westside center, thence 750 foot in a Northerly  
 direction to a corner post marked NW corner, thence 600 foot in a Easterly  
 direction to the NE corner hereby locating and intending to claim 1,450  
 feet in a Southerly direction from Monument of location to the South  
 end line, and 50 foot in the opposite direction from discovery to the  
North end line, and 300 feet on each side of the middle of

gold lode or ledge, for the purpose of mining the same and claiming all surface rights, privileges and minerals, with all dip, opura, angles and variations, and other rights granted by existing laws and customs. This claim is further described as follows: The Monument of Location of this claim is approximately 2000 ft. southerly and 800 ft. westerly of the NE. corner of Section 2

Township 27 N, Range 52 E. Nevada Meridian, Eureka County, Nevada.  
The adjoining claims are Pete 235 on the north;  
Pete 238 on the west; Pete 234 on the east.

The location work consisted of making & preparing maps as required in Nevada Revised Statutes 517:040. A notice of location is placed at Location Monument; Posts are placed at each corner at the center of each side line and the name of this lode and date of location, are placed on all posts.

Located this 21st day of September, 1908

WITNESSES:  
 \_\_\_\_\_  
 Peter W. Lacey,  
 P. O. Box 488  
 Cour d' Aleno, Id. 83814 Locators

RECORDED AT THE REQUEST OF  
 908 / 90 PAGE 586  
 J. L. Long  
 23 NOV 14 PM 4 28  
 OFFICIAL RECORDS  
 EUREKA COUNTY NEVADA  
 FILE NO. 121812  
 FILE #6 5

12813

State of	County of	SW cor.	W. side center	NW cor.	<b>CERTIFICATE OF LOCATION</b>
Vol. of	Page of	50' x Loc. Monument			STATE OF NEVADA
		E. side center			EUREKA
		SE cor.		NE cor.	COUNTY
		This diagram explains method of description of claim.			Mineral Hill
					MORNO DISTRICT

NOTICE IS HEREBY GIVEN, That the undersigned, having complied with the requirements of Chapter Six, Title thirty-two of the Revised Statutes of the United States, and the laws of the above State, and the local customs and regulations of said district,

has located and do hereby locate 1500 linear feet in length,

and 600 feet in width on the PETE 237

lode, vein, ledge or deposit (or placer ground), situated in above State, County or Mining District, and further described as follows: Commencing at a post marked SE corner located about 300' east from the monument of location, thence 750 feet in a Northerly direction to a Eastside center post marked, thence 750 feet in a Northerly direction to a corner post marked NE corner, thence 600 feet in a Westerly direction to a corner post marked NW corner, thence 750 feet in a Southeasterly direction to a post marked Westside Center, thence 750 feet in a Southerly direction to a corner post marked SW corner, thence 600 feet in a Easterly direction to the SE corner hereby locating and intending to claim 1450 feet in a northerly direction from monument of location to the north end line, and 50 feet in the opposite direction from discovery to the south and line, and 300 feet on each side of the middle of said lode or ledge, for the purpose of mining the same and claiming all surface rights, privileges and minerals, with all dips, spurs, angles and variations, and other rights granted by existing laws and customs. This claim is further described as follows: The Monument of Location of this claim is approximately 2000 ft. southerly and 1400 ft. westerly of the NE corner of Section 2

Township 27 N., Range 52 E. Nevada Meridian, Eureka County, Nevada.

The adjoining claims are \_\_\_\_\_ on the north; Pete 238 \_\_\_\_\_ on the south; Pete 239 \_\_\_\_\_ on the west; Pete 235 \_\_\_\_\_ on the east.

The location work consisted of making & preparing maps as required in Nevada Revised Statutes 517:040. A notice of location is placed at Location Monument; Posts are placed at each corner at the center of each side line and the name of this lode and date of location, are placed on all posts.

Located this 21st day of September, 1988.

WITNESSES:

Peter W. Laczay  
Peter W. Laczay,  
P. O. Box 488  
Coeur d'Alene, Id. 83814 Locators

12813

ORIGINAL RECORDS  
EUREKA COUNTY, NEVADA  
MINERAL DISTRICT RECORDS  
FILE NO. 621

RECORDED AT THE REQUEST OF  
BOOK 190 PAGE 587  
88 NOV 14 P 4 28  
R. W. Laczay

BOOK 190 PAGE 587

124814

Completed State of	County of	Side center	SW. cor.	X	cor.	NW. cor.
RECORDED		<b>CERTIFICATE OF LOCATION</b>				
Request of		Loc. Monument 50'				STATE OF NEVADA
County Auditor		Side center cor.				EUREKA
Deputy		SE. cor.				COUNTY
Mail to		NE. cor.				Mineral Hill
Fee		This diagram explains method of description of claim.				MINING DISTRICT

NOTICE IS HEREBY GIVEN That the undersigned, having complied with the requirements of Chapter Six, Title thirty-two of the Revised Statutes of the United States, and the laws of the above State, and the local customs and regulations of said district,

has located and do hereby locate 1500 linear feet in length,

and 600 feet in width on the PETE 238

lode, vein, ledge or deposit (or placer ground), situated in above State, County or Mining District and further described as follows: Commencing at a post marked NE corner located about 300 feet east from

the Monument of Location, thence 750 feet in a Southerly

direction to a post marked East Side center thence 750 feet in a Southerly

direction to a corner post marked SE corner thence 600 feet in a Westerly

direction to a corner post marked SW corner thence 750 feet in a Northerly

direction to a post marked Westside center thence 750 feet in a Northerly

direction to a corner post marked NW corner thence 600 feet in a Easterly

direction to the NE corner hereby locating and intending to claim 1,450

feet in a Southerly direction from monument of location to the South

and line, and 50 feet in the opposite direction from discovery to the

North and line, and 300 feet on each side of the middle of

said lode or ledge for the purpose of mining the same and claiming all surface rights, privileges and minerals, with all dips, apura, angles and variations, and other rights granted by existing laws and customs. This claim is further described as follows: The Monument of Location of this claim is approximately 2000 ft.

southerly and 1400 ft. westerly of the NE. corner of Section 2

Township 27 N, Range 52 E. Nevada Meridian, Eureka County, Nevada.

The adjoining claims are Pete 237 on the north; on the south;

Pete 240 on the west; Pete 236 on the east.

The location work consisted of making & preparing maps as required in Nevada Revised

Statutes 517:040. A notice of location is placed at Location Monument; Posts are

placed at each corner at the center of each side line and the name of this lode and

date of location, are placed on all posts.

Located this 21st day of September 1908

WITNESSES:

Peter W. Laczay,

P. O. Box 488

Coeur d'Alene, Id. 83814 Locators

RECORDED AT THE REQUEST OF  
BOOK 190 PAGE 588  
NOV 14 1908  
OFFICIAL RECORDS  
EUREKA COUNTY, NEVADA  
M. H. BARRETT, RECORDER  
FEE \$ 6.25  
124814

BOOK 190 PAGE 588



12181

Completed  
State of  
County of  
Request of  
County Auditor  
Deputy  
Mail to  
Fee

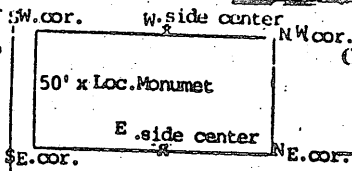

CERTIFICATE OF LOCATION

STATE OF NEVADA  
EUREKA COUNTY  
Mineral Hill MINING DISTRICT

This diagram explains method of description of claim.  
NOTICE IS HEREBY GIVEN That the undersigned, having complied with the requirements of Chapter Six, Title thirty-two of the Revised Statutes of the United States, and the laws of the above State, and the local customs and regulations of said district,

has located and do hereby locate 1500 linear feet in length, and 600 feet in width on the PETE 239

lode, vein, ledge or deposit (or placer ground), situated in above State, County or Mining District, and further described as follows: Commencing at a post marked SE corner located about 300' east from the monument of location, thence 750 feet in a Northerly direction to a Eastside center post marked, thence 750 feet in a Northerly direction to a corner post marked NE corner, thence 600 feet in a Westerly direction to a corner post marked NW corner, thence 750 feet in a Southeasterly direction to a post marked Westside Center, thence 750 feet in a Southerly direction to a corner post marked SW corner, thence 600 feet in a Easterly direction to the SE. corner hereby locating and intending to claim 1450 feet in a northerly direction from monument of location to the north end line, and 50 feet in the opposite direction from discovery to the south end line, and 300 feet on each side of the middle of said lode or ledge, for the purpose of mining the same and claiming all surface rights, privileges and minerals, with all dips, spurs, angles and variations, and other rights granted by existing laws and customs. This claim is further described as follows: The Monument of Location of this claim is approximately 2000 ft. southerly and 2000 ft. westerly of the NE. corner of Section 2

Township 27 N, Range 52 E. Nevada Meridian, Eureka County, Nevada.  
The adjoining claims are on the north; Pete 240 on the south; Pete 241 on the west; Pete 237 on the east.

The location work consisted of making & preparing maps as required in Nevada Revised Statutes 517:040. A notice of location is placed at Location Monument; Posts are placed at each corner at the center of each side line and the name of this lode and date of location, are placed on all posts.

Located this 21st day of September 1908  
WITNESSED:  
Peter W. Laczay,  
P. O. Box 488  
Coeur d'Alene, Id. 83814 Locators

12181  
RECORDED AT THE REQUEST OF  
BOOK 190 PAGE 589  
88 NOV 14 P 4 28  
OFFICIAL RECORDS  
EUREKA COUNTY NEVADA  
MINERAL RIGHTS REGISTER  
FILE NO. FEE \$ 6.25

121916

Side center cor. X NW.cor.

SE.cor. NE.cor.

### CERTIFICATE OF LOCATION

STATE OF NEVADA

EUREKA COUNTY

Mineral Hill MINING DISTRICT

Loc. Monument 50'

Side center cor.

This diagram explains method of description of claim.

NOTICE IS HEREBY GIVEN, That the undersigned, having complied with the requirements of Chapter Six, Title thirty-two of the Revised Statutes of the United States, and the laws of the above State, and the local customs and regulations of said district,

has located and do hereby locate 1500 linear feet in length,

and 600 feet in width on the PETE 240

lode, vein, ledge or deposit (or placer ground), situated in above State, County or Mining District and further described as follows: Commencing at a post marked NE corner located about 300 feet east from the Monument of Location, thence 750 feet in a Southerly direction to a post marked East Side center, thence 750 feet in a Southerly direction to a corner post marked SE corner, thence 600 feet in a Westerly direction to a corner post marked SW corner, thence 750 feet in a Northerly direction to a post marked Westside center, thence 750 feet in a Northerly direction to a corner post marked NW corner, thence 600 feet in a Easterly direction to the NE corner hereby locating and intending to claim 1,450 feet in a Southerly direction from monument of location to the South end line, and 50 feet in the opposite direction from discovery to the North end line, and 300 feet on each side of the middle of said lode or ledge for the purpose of mining the same and claiming all surface rights, privileges and minerals, with all dips, spurs, angles and variations, and other rights granted by existing laws and customs. This claim is further described as follows: The Monument of location of this claim is approximately 2000 ft. southerly and 2000 ft. westerly of the NE. corner of Section 2 Township 27 N, Range 52 E, Nevada Meridian, Eureka County, Nevada.

The adjoining claims are Pete 239 on the north; on the south; Pete 242 on the west; Pete 238 on the east.

The location work consisted of making & preparing maps as required in Nevada Revised Statutes 517:040. A notice of location is placed at Location Monument; Posts are placed at each corner at the center of each side line and the name of this lode and date of location, are placed on all posts.

Located this 21st day of September 1988

WITNESSES:

*Peter W. Laczay*

Peter W. Laczay,  
P. O. Box 488  
Coeur d' Alene, Id. 83814 Locators

OFFICIAL RETURNS  
 EUREKA COUNTY, NEVADA  
 M. M. REBAL EXL. RECORDER  
 FILE NO. 121916  
 121916  
 RECORDED AT THE REQUEST OF  
 BOOK 190 PAGE 590  
 Peter Laczay  
 NOV 14 P 4 28

121817

Compared State of \_\_\_\_\_ County of \_\_\_\_\_ W. cor. W. side center NW cor.

RECORDED as \_\_\_\_\_

Vol. \_\_\_\_\_ of \_\_\_\_\_

Page \_\_\_\_\_ Request of \_\_\_\_\_

19 \_\_\_\_\_

County Auditor \_\_\_\_\_ Deputy \_\_\_\_\_

Mail to \_\_\_\_\_

Fee \_\_\_\_\_

**CERTIFICATE OF LOCATION**  
STATE OF NEVADA  
EUREKA COUNTY

50' x Loc. Monument  
E. side center

Mineral Hill MINING DISTRICT

This diagram explains method of description of claim.

NOTICE IS HEREBY GIVEN, That the undersigned, having complied with the requirements of Chapter Six, Title thirty-two of the Revised Statutes of the United States, and the laws of the above State, and the local customs and regulations of said district,

has located and do hereby locate 1500 linear feet in length, and 600 feet in width on the PETE 241.

lode, vein, ledge or deposit (or placer ground), situated in above State, County or Mining District, and further described as follows: Commencing at a post marked SE corner located about 300' east from the monument of location, thence 750 feet to Northerly direction to a Eastside center post marked, thence 750 feet to Northerly direction to a corner post marked NE corner, thence 600 feet to Westerly direction to a corner post marked NW corner, thence 750 feet to Southeasterly direction to a post marked Westside Center, thence 750 feet to Southerly direction to a corner post marked SW corner, thence 600 feet to Easterly direction to the SE corner hereby locating and intending to claim 1450 feet in a northerly direction from monument of location to the north and line, and 50 feet in the opposite direction from discovery to the south and line, and 300 feet on each side of the middle of

said lode or ledge for the purpose of mining the same and claiming all surface rights, privileges and minerals, with all dips, spurs, angles and variations, and other rights created by existing laws and customs. This claim is further described as follows: The Monument of Location of this claim is approximately 2000 ft. southerly and 2600 ft. westerly of the NE. corner of Section 2

Township 27 N, Range 52 E, Nevada Meridian, Eureka County, Nevada.

The adjoining claims are \_\_\_\_\_ on the north; Pete 242 on the south; Pete 243 on the west; Pete 239 on the east.

The location work consisted of making & preparing maps as required in Nevada Revised Statutes 517:040. A notice of location is placed at Location Monument; Posts are placed at each corner at the center of each side line and the name of this lode and date of location, are placed on all posts.

Located this 21st day of September, 1988.

WITNESSES:

*Peter W. Laczay*  
Peter W. Laczay  
P. O. Box 488  
Coeur d'Alene, Id. 83814 Locators

RECORDED AT THE REQUEST OF  
BOOK 190 PAGE 591  
*Pete Laczay*  
88 NOV 14 P428  
OFFICIAL RECORDS  
EUREKA COUNTY, NEVADA  
M. N. REBAL  
FILE NO. 121817  
FILE 3 C 21

12:1818

Completed  
State of \_\_\_\_\_  
County of \_\_\_\_\_  
RECORDED  
Vol. \_\_\_\_\_ of \_\_\_\_\_  
Page \_\_\_\_\_ Request of \_\_\_\_\_  
No. \_\_\_\_\_  
County Auditor \_\_\_\_\_  
Deputy \_\_\_\_\_  
Mail to \_\_\_\_\_  
Fee \_\_\_\_\_

Side center  
SW. cor. \_\_\_\_\_ X \_\_\_\_\_ NW. cor.  
Loc. Monument 50'  
Side center cor.  
SE. cor. \_\_\_\_\_ NE. cor. \_\_\_\_\_

## CERTIFICATE OF LOCATION

STATE OF NEVADA

EUREKA

COUNTY

Mineral Hill

MINING DISTRICT

This diagram explains method of description of claim.

NOTICE IS HEREBY GIVEN, That the undersigned, having complied with the requirements of Chapter Six, Title thirty-two of the Revised Statutes of the United States, and the laws of the above State, and the local customs and regulations of said district,

has located and do hereby locate 1500 linear feet in length, and 600 feet in width on the PETE 242

lode, vein, ledge or deposit (or placer ground), situated in above State, County or Mining District and further described as follows: Commencing at a post marked NE corner located about 300 feet east from the Monument of Location, thence 750 feet in a Southerly direction to a post marked East Side center, thence 750 feet in a Southerly direction to a corner post marked SE corner, thence 600 feet in a Westerly direction to a corner post marked SW corner, thence 750 feet in a Northerly direction to a post marked Westside center, thence 750 feet in a Northerly direction to a corner post marked NW corner, thence 600 feet in a Easterly direction to the NE. corner hereby locating and intending to claim 1,450 feet in a Southerly direction from monument of location to the South end line, and 50 feet in the opposite direction from discovery to the North end line, and 300 feet on each side of the middle of said lode or ledge for the purpose of mining the same and claiming all surface rights, privileges and minerals, with all dips, spurs, angles and variations, and other rights granted by existing laws and customs. This claim is further described as follows: The Monument of Location of this claim is approximately 2000 ft. southerly and 2600 ft. westerly of the NE. corner of Section Township 27 N, Range 52 E. Nevada Meridian, Eureka County, Nevada.

The adjoining claims are Pete 241 on the north; \_\_\_\_\_ on the south; Pete 244 on the west; Pete 240 on the east.

The location work consisted of making & preparing maps as required in Nevada Revised Statutes 517:040. A notice of location is placed at Location Monument; Posts are placed at each corner at the center of each side line and the name of this lode and date of location, are placed on all posts.

Located this 21st day of September 1988

WITNESSES:

*Peter W. Laczay*  
Peter W. Laczay,  
P. O. Box 488  
Coeur d'Alene, Id. 83814 Locators

12:1818

OFFICIAL RECORDS  
EUREKA COUNTY, NEVADA  
MINERAL RIGHTS RECORDER  
FILE NO. 625

RECORDED AT THE REQUEST OF  
BOOK 190 PAGE 592  
Peter Laczay  
88 NOV 14 PM 4:28

BOOK 190 PAGE 592

524 RW 23

121819

Prepared by \_\_\_\_\_  
 State of \_\_\_\_\_  
 County of \_\_\_\_\_  
 RECORDED as \_\_\_\_\_  
 Vol. \_\_\_\_\_ of \_\_\_\_\_  
 Page \_\_\_\_\_ Request of \_\_\_\_\_  
 in \_\_\_\_\_  
 County Auditor \_\_\_\_\_ Deputy  
 Mail to \_\_\_\_\_  
 Fee \_\_\_\_\_

W. cor. W. side center NW cor.  
**CERTIFICATE OF LOCATION**  
 STATE OF NEVADA  
 E. side center EUREKA COUNTY  
 Mineral Hill MINING DISTRICT  
 This diagram explains method of description of claim.

NOTICE IS HEREBY GIVEN, That the undersigned, having complied with the requirements of Chapter Six, Title thirty-two of the Revised Statutes of the United States, and the laws of the above State, and the local customs and regulations of said district,

has located and do hereby locate 1500 linear feet in length, and 600 feet in width on the PETE 243

lode, vein, ledge or deposit (or placer ground), situated in above State, County or Mining District, and further described as follows: Commencing at a post marked SE corner located about 300' east from the monument of location, thence 750 feet in Northerly direction to a Eastside center post marked, thence 750 feet in Northerly direction to a corner post marked NE corner, thence 600 feet in Westerly direction to a corner post marked NW corner, thence 750 feet in Southeasterly direction to a post marked Westside Center, thence 750 feet in Southerly direction to a corner post marked SW corner, thence 600 feet in Easterly direction to the SE corner hereby locating and intending to claim 1450 feet in a northerly direction from monument of location to the north end line, and 50 feet in the opposite direction from discovery to the south and line, and 300 feet on each side of the middle of said lode or ledge, for the purpose of mining the same and claiming all surface rights, privileges and minerals, with all dips, apures, angles and variations, and other rights granted by existing laws and customs. This claim is further described as follows:

The Monument of Location of this claim is approximately 2000 ft. southerly and 3100 ft. westerly of the NE. corner of Section 2, Township 27 N, Range 52 E, Nevada Meridian, Eureka County, Nevada.  
 The adjoining claims are \_\_\_\_\_ on the north; Pete 244 on the south; \_\_\_\_\_ on the west; Pete 241 on the east.

The location work consisted of making & preparing maps as required in Nevada Revised Statutes 517:040. A notice of location is placed at Location Monument; Posts are placed at each corner at the center of each side line and the name of this lode and date of location, are placed on all posts.

Located this 21st day of September, 88.  
 WITNESSES:  
 \_\_\_\_\_  
 \_\_\_\_\_  
 Peter W. Laczay,  
 P. O. Box 488,  
 Coeur d'Alene, Id. 83814 Locators

RECORDED AT THE REQUEST OF  
 Book 190 PAGE 523  
 Peter W. Laczay  
 NOV 14 4 28  
 OFFICIAL RECORDS  
 EUREKA COUNTY, NEVADA  
 MIN. REVENUE RECORDER  
 FILE NO. 6  
 121819

BOOK 190 PAGE 593

12-820

Prepared by \_\_\_\_\_  
 State of \_\_\_\_\_  
 County of \_\_\_\_\_  
 RECORDED  
 Vol. \_\_\_\_\_ of \_\_\_\_\_  
 Page \_\_\_\_\_ Request of \_\_\_\_\_  
 \_\_\_\_\_  
 \_\_\_\_\_  
 County Auditor  
 County Deputy  
 Mail to \_\_\_\_\_  
 \_\_\_\_\_  
 Fee \_\_\_\_\_

Side center  
SW. COR. X COR. NW. COR.

**CERTIFICATE OF LOCATION**

Loc. Monument 50'

Side center cor.

SE. COR. NE. COR.

STATE OF NEVADA  
EUREKA COUNTY

Mineral Hill MINING DISTRICT

This diagram explains method of description of claim.

NOTICE IS HEREBY GIVEN, That the undersigned, having complied with the requirements of Chapter Six, Title thirty-two of the Revised Statutes of the United States, and the laws of the above State, and the local customs and regulations of said district, have located and do hereby locate 1500 linear feet in length, and 600 feet in width on the PETE 244.

lode, vein, ledge or deposit (or placer ground), situated in above State, County or Mining District and further described as follows: Commencing at a post marked NE corner located about 300 feet east from the Monument of Location, thence 750 feet in a Southerly direction to a post marked East Side center, thence 750 feet in a Southerly direction to a corner post marked SE corner, thence 600 feet in a Westerly direction to a corner post marked SW corner, thence 750 feet in a Northerly direction to a post marked Westside center, thence 750 feet in a Northerly direction to a corner post marked NW corner, thence 600 feet in a Easterly direction to the NE. corner hereby locating and intending to claim 1,350 feet in a Southerly direction from monument of location to the South end line, and 150 feet in the opposite direction from discovery to the North and line, and 300 feet on each side of the middle of said lode or ledge for the purpose of mining the same and claiming all surface rights, privileges and minerals, with all dips, spurs, angles and variations, and other rights granted by existing laws and customs. This claim is further described as follows: The Monument of Location of this claim is approximately 2000 ft. southerly and 3100 ft. westerly of the NE. corner of Section 2

Township 27 N, Range 52 E. Nevada Meridian, Eureka County, Nevada.

The adjoining claims are Pete 243 on the north; - on the south; - on the west; Pete 242 on the east.

The location work consisted of making & preparing maps as required in Nevada Revised Statutes 517:040. A notice of location is placed at Location Monument; Posts are placed at each corner at the center of each side line and the name of this lode and date of location, are placed on all posts.

Located this 21st day of September 1988.

WITNESSES:

*Peter W. Laczay*  
 Peter W. Laczay,  
 P. O. Box 488  
 Coeur d'Alene, Id. 83814 Locators

12-820

OFFICIAL RECORDS  
 EUREKA COUNTY, NEVADA  
 RECORDER  
 FILE NO. 625

RECORDED AT THE REQUEST OF  
 BOOK 190 PAGE 594  
*Peter Laczay*  
 28 NOV 14 PM 4:28

BOOK 190 PAGE 594