

23 September 1988

T36N, R49E

Field Date  
20 September 1988

124976

CERTIFIED LAND CORNER RECORDATION

DESCRIPTION OF CORNER EVIDENCE FOUND, AND ORIGINAL RECORD (if known)

Record:-- 1872 - N89°-55'W, on a true line between Sections 24 and 25.  
40.08 Set a charred post in mound with pits as per instructions for 1/4 Sec. Cor.

Found:-- Nothing of original monument. Monument falls in area of extensive filling of waste mining materials. A 5/8" steel reinforcing rod with yellow plastic cap inscribed

see below

DESCRIPTION OF MONUMENT AND ACCESSORIES ESTABLISHED TO PERPETUATE THE ORIGINAL LOCATION OF THIS CORNER:

Set:-- Nothing as it is area of storage of waste mining material and junk yard for mines.

SKETCH, WITH COURSE AND DISTANCE TO ADJACENT CORNER IF DETERMINED IN THIS SURVEY. (May Sketch or Paste Reproduction on Reverse Side.)

Reference:-- Book NV2, page 38.

Found:--  
Continued "SUMMIT ENG. RLS 5072" from which a green steel fence post marked in marking ink "N 1/4 Cor. Sec. 25 S 1/4 Cor. Sec. 24".

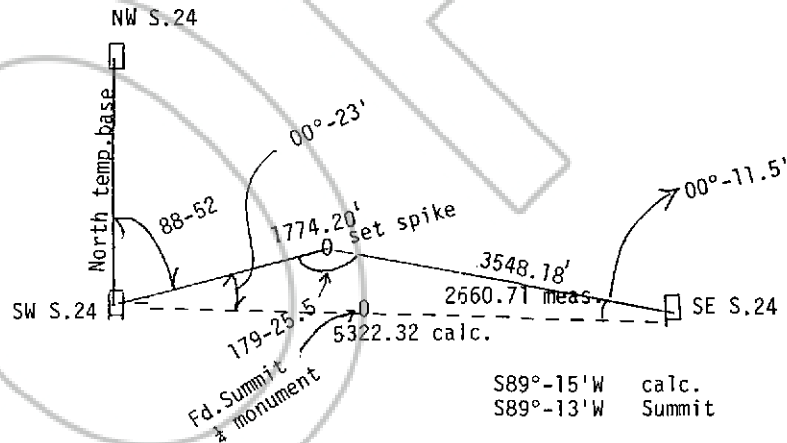

I, Paul N. Scherbel certify that I have carefully examined and reviewed the work done on the diagrammed corner as reported on this recordation form and approve the same.

Signature of Surveyor: Paul N. Scherbel Registration No. 6805

STATE OF WYOMING, NEVADA

County of EUREKA

This "corner record" was filed for record on the 28<sup>th</sup> day of Nov, 1988, was noted on the cross-index plat and is assigned page No. R-23, in book No. 36-49

cc: BLM  
Hull  
Terry  
Summit

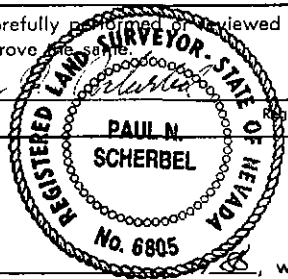

M. J. Reblantz  
County Official

Cross Index No.	_____	T.	_____	R.	_____	Mer.
	_____	T.	_____	R.	_____	Mer.
	_____	T.	_____	R.	_____	Mer.
	_____	T.	_____	R.	_____	Mer.
	_____	T.	_____	R.	_____	Mer.
	_____	T.	_____	R.	_____	Mer.
	_____	T.	_____	R.	_____	Mer.

124976