

THE MAP OF THE
POT 1-14
LODE CLAIM GROUP

SECTIONS: 21, 28 T.24N/R.48E
EUREKA COUNTY NEVADA
LOCATED: 26, JAN. 1989
BY: WILD ROSE MANAGEMENT INC.
316 BRIDGER ST. SUITE 147
LAS VEGAS, NEVADA
89101

SCALE: ONE INCH = 500 FEET

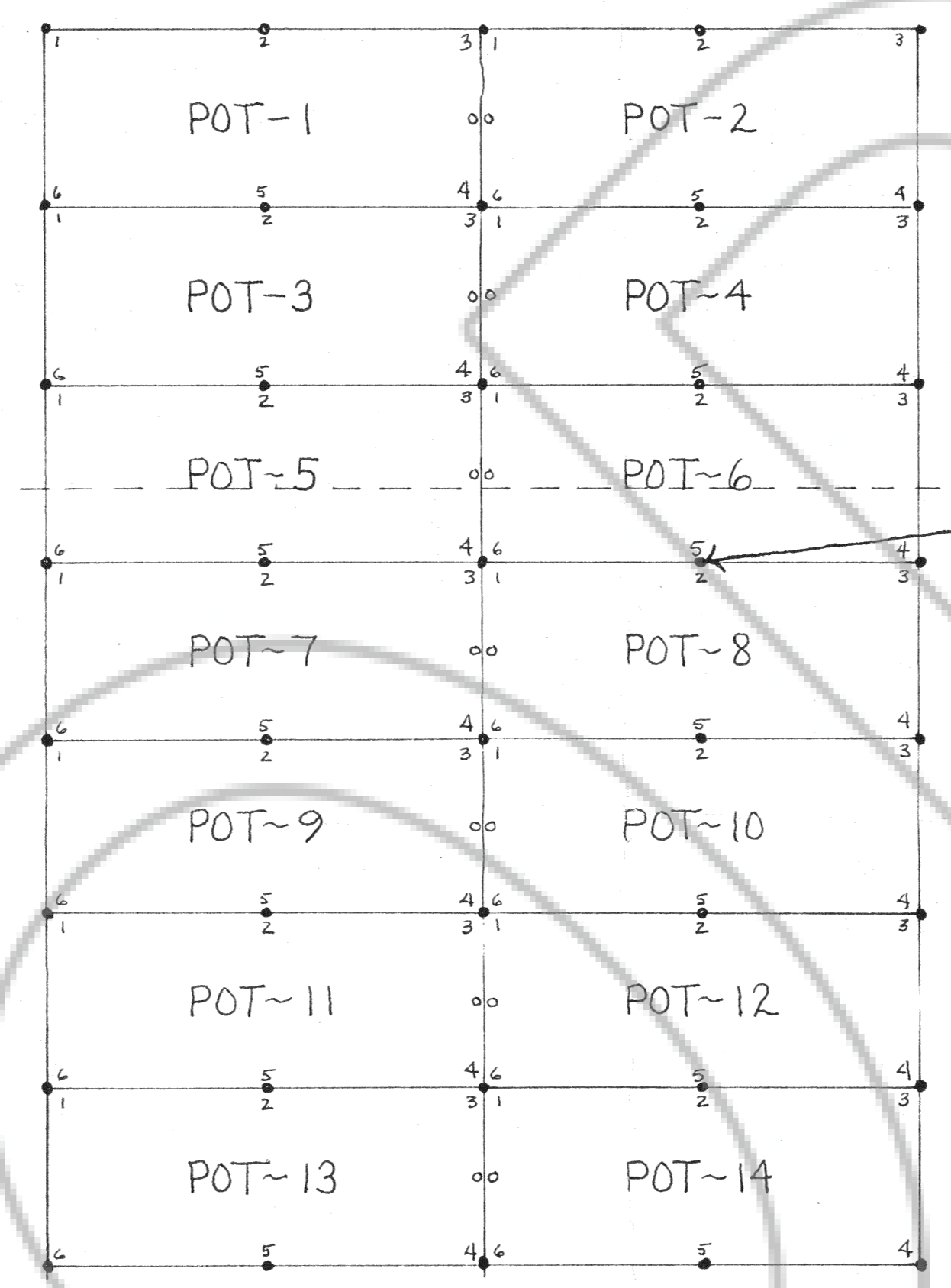
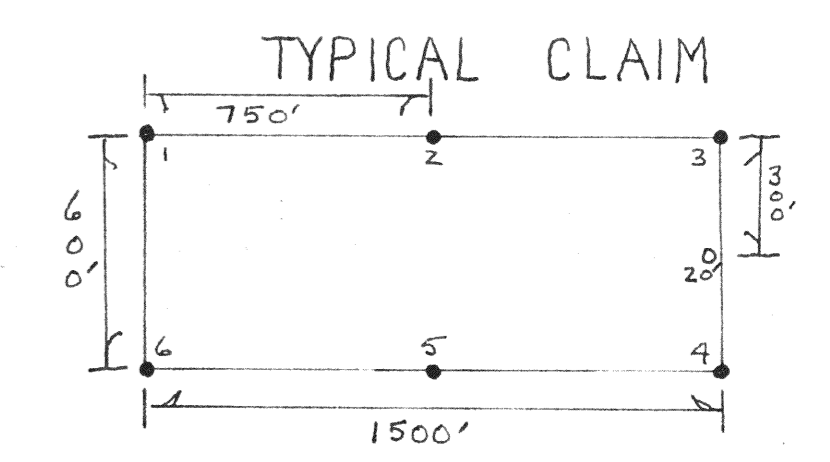
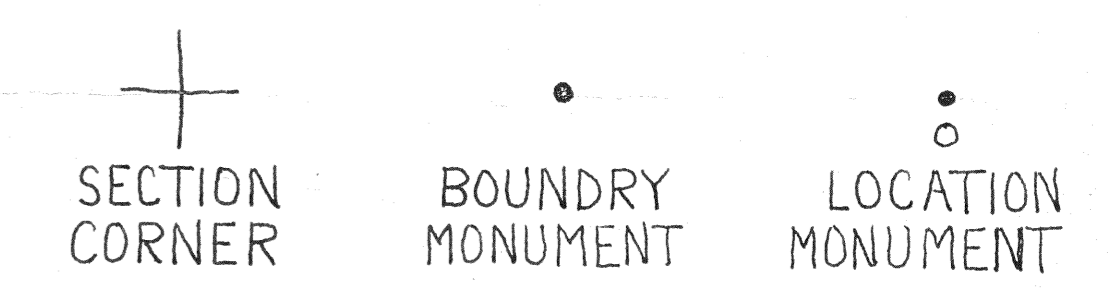

21 22
28 27
SOUTH CENTER POT 6 IS
2083.8' AT 83° 5' W

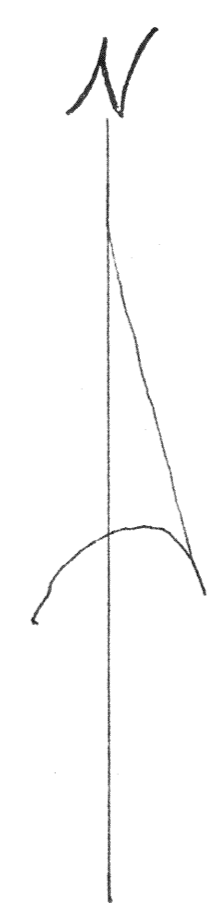

MADE AT THE REQUEST OF Wild Rose Management Inc
on March 1 19 89, at 1 mins, past 42 M.
RECORDS OF EUREKA COUNTY, NEVADA M. N. REBALEATI, Recorder
File No. 126510 Fee \$ 210.00