

127351

Compared State of _____
Filed County of _____
RECORDED as
Vol. _____ of _____
Page _____ Request of _____
_____ 19 _____
County Auditor _____ Deputy _____
Mail to _____
Fee _____

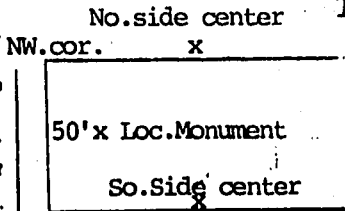

CERTIFICATE OF LOCATION

STATE OF NEVADA

EUREKA

COUNTY

Mineral Hill

MINING DISTRICT

This diagram explains method of description of claim.

NOTICE IS HEREBY GIVEN, That the undersigned, having complied with the requirements of Chapter Six, Title thirty-two of the Revised Statutes of the United States, and the laws of the above State, and the local customs and regulations of said district,

In ^s located and do hereby locate 1500 linear feet in length, and 600 feet in width on the PETE 252

lode, vein, ledge or deposit (or placer ground), situated in above State, County or Mining District, and further described as follows: Commencing at a post marked SW corner located about 300' South from the monument of location thence 750 feet in a N 70° East direction to a post marked south side center, thence 750 feet in a N 70° East direction to a corner post marked SE cor., thence 600 feet in a Northerly S 70° West direction to a corner post marked NE Cor., thence 750 feet in a S 70° West direction to a post marked Northside center, thence 750 feet in a Southerly direction to a corner post marked NW Cor., thence 600 feet in a 1450 direction to the SW corner hereby locating and intending to claim Easterly Monument of location to the East feet in a 50 direction from West end line, and 300 feet in the opposite direction from discovery to the

end line, and 300 feet on each side of the middle of said lode or ledge for the purpose of mining the same and claiming all surface rights, privileges and minerals, with all dips, spurs, angles and variations, and other rights granted by existing laws and customs. This claim is further described as follows: The Monument of Location of this claim is approximately 4500 ft. southerly and 4900 ft. westerly of the NE corner of Section 36 Township 28 N, Range 52 E, Nevada Meridian, Eureka County, Nevada. The adjoining claims are Pete 253 on the north; Pete 308, 306, 310 on the south; on the west; Pete 271 on the east.

The location work consisted of making & preparing maps as required in Nevada Revised Statutes 517:040. A notice of location is placed at Location Monument; Posts are placed at each corner at the center of each side line and the name of this lode and date of location, are placed on all posts.

Located this 31st day of March 19 89

WITNESSES:

Peter W. Laczay

Peter W. Laczay
P. O. Box 488
Coeur d' Alene, Idaho 83814 Locators

127351

OFFICIAL RECORDS
EUREKA COUNTY NEVADA
M.N. REB. AL. B. REC. ORDER
FILE NO. 625

RECORDED AT THE REQUEST OF
BOOK 197 PAGE 280
89 JUN 12 AM 12:22
Adora Silver Mine, Inc

127352

Compared State of Nevada
Recorded as
Vol. of
Page of Request of
19
County Auditor
Deputy
Mail to
Fee

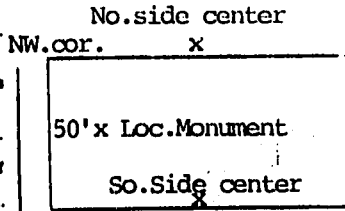

No. side center
NW.cor. X
NE.cor.
SE.cor.
CERTIFICATE OF LOCATION
STATE OF NEVADA
EUREKA COUNTY

This diagram explains method of description of claim.
Mineral Hill MINING DISTRICT

NOTICE IS HEREBY GIVEN, That the undersigned, having complied with the requirements of Chapter Six, Title thirty-two of the Revised Statutes of the United States, and the laws of the above State, and the local customs and regulations of said district,

in ^s located and do hereby locate 1500 linear feet in length, and 600 feet in width on the PETE 253

lode, vein, ledge or deposit (or placer ground), situated in above State, County or Mining District, and further described as follows: Commencing at a post marked SW corner located about 300' South from the monument of location thence 750 feet in a N 70° East direction to a post marked south side center, thence 750 feet in a N 70° East direction to a corner post marked SE cor., thence 600 feet in a Northerly direction to a corner post marked NE Cor., thence 750 feet in a S 70° West direction to a post marked Northside center, thence 750 feet in a S 70° West direction to a corner post marked NW Cor., thence 600 feet in a Southerly direction to the SW corner hereby locating and intending to claim 1450 feet in a Easterly direction from Monument of location to the East end line, and 50 feet in the opposite direction from discovery to the West end line, and 300 feet on each side of the middle of said lode or ledge for the purpose of mining the same and claiming all surface rights, privileges and minerals, with all dips, spurs, angles and variations, and other rights granted by existing laws and customs. This claim is further described as follows: The Monument of Location of this claim is approximately 4500 ft. southerly and 5100 ft. westerly of the NE. corner of Section 36 Township 28 N, Range 52 E, Nevada Meridian, Eureka County, Nevada.

The adjoining claims are Pete 254 on the north; Pete 252 on the south; on the west; Pete 271 on the east.

The location work consisted of making & preparing maps as required in Nevada Revised Statutes 517:040. A notice of location is placed at Location Monument; Posts are placed at each corner at the center of each side line and the name of this lode and date of location, are placed on all posts.

Located this 31st day of March 19 89

WITNESSES:
Peter W. Laczay
P. O. Box 488
Coeur d' Alene, Idaho 83814 Locators

RECORDED AT THE REQUEST OF
BOOK 197 PAGE 281
89 JUN 12 AM 11:22
OFFICIAL RECORDS
EUREKA COUNTY NEVADA
M.N. REBALLENTO, CLERK
FILE NO. 127352
Please Leave Name One

Compared..... Filed.....
 State of..... County of.....
 RECORDED #
 Vol. of
 Page..... Request of
 19.....
 County Auditor
 Deputy
 Mail to.....
 Fee

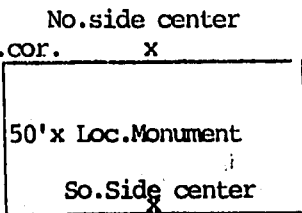

CERTIFICATE OF LOCATION

STATE OF NEVADA

EUREKA

COUNTY

Mineral Hill

MINING DISTRICT

This diagram explains method of description of claim.

NOTICE IS HEREBY GIVEN, That the undersigned, having complied with the requirements of Chapter Six, Title thirty-two of the Revised Statutes of the United States, and the laws of the above State, and the local customs and regulations of said district,

has located and do hereby locate 1500 linear feet in length, and 600 feet in width on the PETE 254

lode, vein, ledge or deposit (or placer ground), situated in above State, County or Mining District, and further described as follows: Commencing at a post marked SW corner located about 300' South from the monument of location thence 750 feet in a N 70° East direction to a post marked south side center, thence 750 feet in a N 70° East direction to a corner post marked SE cor., thence 600 feet in a Northerly direction to a corner post marked NE Cor., thence 750 feet in a S 70° West direction to a post marked Northside center, thence 750 feet in a S 70° West direction to a corner post marked NW Cor., thence 600 feet in a Southerly direction to the SW corner hereby locating and intending to claim 1450 feet in a Easterly direction from Monument of location to the East end line, and 50 feet in the opposite direction from discovery to the West end line, and 300 feet on each side of the middle of said lode or ledge for the purpose of mining the same and claiming all surface rights, privileges and minerals, with all dips, spurs, angles and variations, and other rights granted by existing laws and customs. This claim is further described as follows:

The Monument of Location of this claim is approximately 3900 ft. southerly and 5100 ft. westerly of the NE. corner of Section 36 Township 28 N, Range 52 E. Nevada Meridian, Eureka County, Nevada.
 The adjoining claims are on the north; Pete 253 on the south; on the west; Pete 269 on the east.

The location work consisted of making & preparing maps as required in Nevada Revised Statutes 517:040. A notice of location is placed at Location Monument; Posts are placed at each corner at the center of each side line and the name of this lode and date of location, are placed on all posts.

Located this 31st day of March 19 89

WITNESSES:

Peter W. Laczay

Peter W. Laczay
P. O. Box 488
Coeur d' Alene, Idaho 83814 Locators

127353

OFFICIAL RECORDS
EUREKA COUNTY, NEVADA
M. N. ROBERTS, CLERK
FILE NO. 625

RECORDED AT THE REQUEST OF
BOOK 197 PAGE 282
Jdoro & Alene News. Inc.
89 JAN 12 AM 12:23

CERTIFICATE OF LOCATION

STATE OF NEVADA

EUREKA COUNTY

Mineral Hill MINING DISTRICT

Compared... State of... Located... County of... Vol... of... Page... Request of... 19... County Auditor... Deputy... Mail to... Fee...

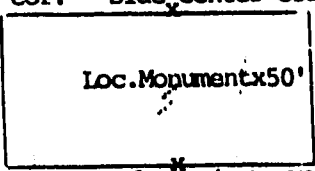

SW. cor. Side center cor. SE. cor.

This diagram explains method of description of claim.

NOTICE IS HEREBY GIVEN, That the undersigned, having complied with the requirements of Chapter Six, Title thirty-two of the Revised Statutes of the United States, and the laws of the above State, and the local customs and regulations of said district,

has located and do hereby locate 1500 linear feet in length, and 600 feet in width on the PETE 255

lode, vein, ledge or deposit (or placer ground), situated in above State, County or Mining District, and further described as follows: Commencing at a post marked SE corner located about 300' southerly from the monument of Location, thence 750 feet in a Westerly direction to a Southside center post marked, thence 750 feet in a Westerly direction to a corner post marked SW corner, thence 600 feet in a Northerly direction to a corner post marked NW corner, thence 750 feet in a Easterly direction to a post marked Northside center, thence 750 feet in a Easterly direction to a corner post marked NE corner, thence 300 feet in a Southerly direction to the SE. corner hereby locating and intending to claim 1, feet in a Westerly direction from monument of location to the West end line, and 50 feet in the opposite direction from discovery to the East end line, and 300 feet on each side of the middle of

said lode or ledge, for the purpose of mining the same and claiming all surface rights, privileges and minerals, with all dips, spurs, angles and variations, and other rights granted by existing laws and customs. This claim is further described as follows: The Monument of Location of this claim is approximately 4500 ft.

southerly and 2400 ft. westerly of the NE. corner of Section 25 Township 28 N, Range 52 E. Nevada Meridian, Eureka County, Nevada.

The adjoining claims are on the north; Pete 257 on the south; on the west; Pete 258 on the east.

The location work consisted of making & preparing maps as required in Nevada Revised Statutes 517:040. A notice of location is placed at Location Monument; Posts are placed at each corner at the center of each side line and the name of this lode and date of location, are placed on all posts.

Located this 18th day of APRIL, 19 89

WITNESSES: Peter W. Laczay P. O. Box 488 Coeur d'Alene, Id. 83814 Locators

RECORDED AT THE REQUEST OF DEAN S. IVER MINING Co. 89 JAN 12 AM 123 OFFICIAL RECORDS EUREKA COUNTY NEVADA M.N. REBEKAH RECORDER FILE NO 127354 FEE \$ 6.25

127355

CERTIFICATE OF LOCATION

STATE OF NEVADA

EUREKA COUNTY

Mineral Hill MINING DISTRICT

Loc. Monument x 50'

Recorded information fields: State of, County of, Vol. of, Page, Request of, County Auditor, Deputy, Mail to, Fee

NW. cor. Side center cor. NE. cor. SW. cor. side center cor. SE. cor.

This diagram explains method of description of claim.

NOTICE IS HEREBY GIVEN, That the undersigned, having complied with the requirements of Chapter Six, Title thirty-two of the Revised Statutes of the United States, and the laws of the above State, and the local customs and regulations of said district,

has located and do hereby locate 1500 linear feet in length, and 600 feet in width on the PETE 257

lode, vein, ledge or deposit (or placer ground), situated in above State, County or Mining District, and further described as follows: Commencing at a post marked SE corner located about 300' southerly from the monument of Location, thence 750 feet in a Westerly direction to a Southside center post marked, thence 750 feet in a Westerly direction to a corner post marked SW corner, thence 600 feet in a Northerly direction to a corner post marked NW corner, thence 750 feet in a Easterly direction to a post marked Northside center, thence 750 feet in a Easterly direction to a corner post marked NE corner, thence 300 feet in a Southerly direction to the SE. corner hereby locating and intending to claim 1, feet in a Westerly direction from monument of location to the West end line, and 50 feet in the opposite direction from discovery to the East end line, and 300 feet on each side of the middle of said lode or ledge, for the purpose of mining the same and claiming all surface rights, privileges and minerals, with all dips, spurs, angles and variations, and other rights granted by existing laws and customs. This claim is further described as follows:

The Monument of Location of this claim is approximately 5100 ft. southerly and 2400 ft. westerly of the NE. corner of Section 25, Township 28 N, Range 52 E. Nevada Meridian, Eureka County, Nevada.

The adjoining claims are Pete 255 on the north; Pete 259 on the south; on the west; Pete 260 on the east.

The location work consisted of making & preparing maps as required in Nevada Revised Statutes 517:040. A notice of location is placed at Location Monument; Posts are placed at each corner at the center of each side line and the name of this lode and date of location, are placed on all posts.

Located this 18th day of April 19 89

WITNESSES:

[Signature]

Peter W. Laczay P. O. Box 488 Coeur d' Alene, Id. 83814 Locators

OFFICIAL RECORDS EUREKA COUNTY, NEVADA M.N. RECORDS FILE # 127355 FILE # 625

RECORDED AT THE REQUEST OF BOOK 197 PAGE 284 89 JUN 12 AM 123 Also filed in mine, etc.

127356

Completed state of Nevada
County of Esmeralda
Request of
County Auditor
Deputy
Mail to
Fee

No. side center
NW. cor. X

50'x Loc. Monument
So. Side center

CERTIFICATE OF LOCATION
STATE OF NEVADA
EUREKA COUNTY

This diagram explains method of description of claim.

Mineral Hill MINING DISTRICT

NOTICE IS HEREBY GIVEN, That the undersigned, having complied with the requirements of Chapter Six, Title thirty-two of the Revised Statutes of the United States, and the laws of the above State, and the local customs and regulations of said district,

has located and do hereby locate 1500 linear feet in length, and 600 feet in width on the PETE 258

lode, vein, ledge or deposit (or placer ground), situated in above State, County or Mining District, and further described as follows: Commencing at a post marked SW corner located about 300' South from the monument of location thence 750 feet in a N 75° East direction to a post marked south side center, thence 750 feet in a N 85° East direction to a corner post marked SE cor., thence 600 feet in a Northerly direction to a corner post marked NE Cor., thence 750 feet in a S 85° West direction to a post marked Northside center, thence 750 feet in a S 85° west direction to a corner post marked NW Cor., thence 600 feet in a Southerly direction to the SW corner hereby locating and intending to claim 1450 feet in a Easterly direction from Monument of location to the East end line, and 50 feet in the opposite direction from discovery to the West end line, and 300 feet on each side of the middle of said lode or ledge for the purpose of mining the same and claiming all surface rights, privileges and minerals, with all dips, spurs, angles and variations, and other rights granted by existing laws and customs. This claim is further described as follows:

The Monument of Location of this claim is approximately 4500 ft southerly and 2300 ft. westerly of the NE. corner of Section 25 Township 28 N, Range 52 E. Nevada Meridian, Eureka County, Nevada.

The adjoining claims are - on the north; Pete 260 on the south; Pete 255 on the west; Pete 276 on the east.

The location work consisted of making & preparing maps as required in Nevada Revised Statutes 517:040. A notice of location is placed at Location Monument; Posts are placed at each corner at the center of each side line and the name of this lode and date of location, are placed on all posts.

Located this 18th day of APRIL 19 89

WITNESSES:

Peter W. Laczay

Peter W. Laczay
P. O. Box 488
Coeur d'Alene, Idaho 83814 Locators

127356

OFFICIAL RECORDS
EUREKA COUNTY, NEVADA
M.N. REBAL FILE NO. 625

RECORDED AT THE REQUEST OF
BOOK 197 PAGE 285
89 JUN 12 AM 12:23
Jana Miller

127357

CERTIFICATE OF LOCATION

Completed State of ... Labeled County of ... RECORDED ... Vol. ... of ... Page ... Request of ... 18 ... County Auditor ... Deputy ... Mail to ... Fee

NW. cor. Side center cor. NE. cor.

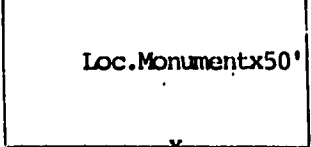

STATE OF NEVADA
EUREKA COUNTY
Mineral Hill MINING DISTRICT

SW. cor. side center cor. SE. cor.

This diagram explains method of description of claim.

NOTICE IS HEREBY GIVEN, That the undersigned, having complied with the requirements of Chapter Six, Title thirty-two of the Revised Statutes of the United States, and the laws of the above State, and the local customs and regulations of said district, has located and do hereby locate 1500 linear feet in length, and 600 feet in width on the PETE 259

lode, vein, ledge or deposit (or placer ground), situated in above State, County or Mining District, and further described as follows: Commencing at a post marked SE corner located about 300' southerly from the monument of Location, thence 750 feet in a Westerly direction to a Southside center post marked, thence 750 feet in a Westerly direction to a corner post marked SW corner, thence 600 feet in a Northerly direction to a corner post marked NW corner, thence 750 feet in a Easterly direction to a post marked Northside center, thence 750 feet in a Easterly direction to a corner post marked NE corner, thence 300 feet in a Southerly direction to the SE. corner hereby locating and intending to claim 1/2 section in a Westerly direction from monument of location to the West end line, and 50 feet in the opposite direction from discovery to the East end line, and 300 feet on each side of the middle of said lode or ledge, for the purpose of mining the same and claiming all surface rights, privileges and minerals, with all dips, spurs, angles and variations, and other rights granted by existing laws and customs. This claim is further described as follows: The Monument of Location of this claim is approximately 400 ft. southerly and 2400 ft. westerly of the NE. corner of Section 36, Township 28 N, Range 52 E. Nevada Meridian, Eureka County, Nevada. The adjoining claims are Pete 257 on the north; Pete 261 on the south; Pete 262 on the east; and Pete 259 on the west.

The location work consisted of making & preparing maps as required in Nevada Revised Statutes 517:040. A notice of location is placed at Location Monument; Posts are placed at each corner at the center of each side line and the name of this lode and date of location, are placed on all posts.

Located this 18th day of April 19 89

WITNESSES:

Peter W. Laczay

Peter W. Laczay
P. O. Box 488
Coeur d' Alene, Id. 83814 Locators

RECORDED AT THE REQUEST OF
BOOK 197 PAGE 286
89 JUN 12 AM 12:33
EUREKA COUNTY NEVADA
M.N. REBECCAH L. RECORDER
FILE NO 127357
FEE \$ 6.25

127358

Compared... State of
 RECORDED
 Vol. of
 Page..... Request of
 18.....
 County Auditor
 Deputy
 Mail to.....
 Fee

Nw. cor. Side center cor. NE. cor.

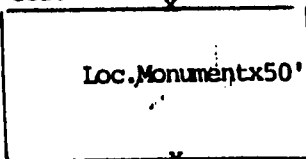

CERTIFICATE OF LOCATIO

STATE OF NEVADA

EUREKA

COUNTY

SW. cor. Side center cor. SE. cor.

Mineral Hill

MINING DISTRICT

This diagram explains method of description of claim.

NOTICE IS HEREBY GIVEN, That the undersigned, having complied with the requirements of Chapter Six, Title thirty-two of the Revised Statutes of the United States, and the laws of the above State, and the local customs and regulations of said district,

has located and do hereby locate 1500 linear feet in length, and 600 feet in width on the PETE 260

lode, vein, ledge or deposit (or placer ground), situated in above State, County or Mining District, and further described as follows: Commencing at a post marked SE corner located about 300' southerly from the monument of Location, thence 750 feet in S 85° West

direction to a Southside center post marked, thence 750 feet in S 85° West

direction to a corner post marked SW corner, thence 600 feet in Northerly

direction to a corner post marked NW corner, thence 750 feet in N 85° East

direction to a post marked Northside center, thence 750 feet in N 85° East.

direction to a corner post marked NE corner, thence 300 feet in Southerly

direction to the SE corner hereby locating and intending to claim 1,450

feet in a Westerly direction from monument of location to the West

end line, and 50 feet in the opposite direction from discovery to the

East and line, and 300 feet on each side of the middle of said lode or ledge, for the purpose of mining the same and claiming all surface rights, privileges and minerals, with all dips, spurs, angles and variations, and other rights granted by existing laws and customs. This claim is further described as follows:

The Monument of Location of this claim is approximately 5000 ft.

southerly and 800 ft. westerly of the NE. corner of Section 25,

Township 28 N, Range 52 E. Nevada Meridian, Eureka County, Nevada.

The adjoining claims are Pete 258 on the north; Pete 262 on the south;

Pete 257 on the west; Pete 277 on the east.

The location work consisted of making & preparing maps as required in Nevada Revised Statutes 517:040. A notice of location is placed at Location Monument; Posts are

placed at each corner at the center of each side line and the name of this lode and date of location, are placed on all posts.

Located this 1st day of April 19 89.

WITNESSES:

[Signature]
 Peter W. Laczay
 P. O. Box 488
 Coeur d'Alene, Id. 83814 Locators

RECORDED AT THE REQUEST OF
 BOOK 157 PAGE 287
 89 JUN 12 AM 12:23
 Idaho Silver Mines, Inc.
 OFFICIAL RECORDS
 EUREKA COUNTY NEVADA
 M. M. REBALLI COUNTY CLERK
 FILE NO. 127358
 FEE \$ 6.25

127359

Compared State of _____
 Filed County of _____
 RECORDED
 Vol. _____ of _____
 Page _____ Request of _____
 is _____
 County Auditor _____
 Deputy _____
 Mail to _____
 Fee _____

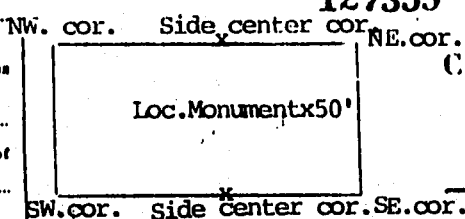

CERTIFICATE OF LOCATION

STATE OF NEVADA
 EUREKA COUNTY
 Mineral Hill MINING DISTRICT

This diagram explains method of description of claim.

NOTICE IS HEREBY GIVEN, That the undersigned, having complied with the requirements of Chapter Six, Title thirty-two of the Revised Statutes of the United States, and the laws of the above State, and the local customs and regulations of said district,

has located and do hereby locate 1500 linear feet in length,
 and 600 feet in width on the PETE 261

lode, vein, ledge or deposit (or placer ground), situated in above State, County or Mining District, and further described as follows: Commencing at a post marked SE corner located about 300' southerly from the monument of Location, thence 750 feet in a Westerly direction to a Southside center post marked, thence 750 feet in a Westerly direction to a corner post marked SW corner, thence 600 feet in a Northerly direction to a corner post marked NW corner, thence 750 feet in a Easterly direction to a post marked Northside center, thence 750 feet in a Easterly direction to a corner post marked NE corner, thence 300 feet in a Southerly direction to the SE corner hereby locating and intending to claim, 1, feet in a Westerly direction from monument of location to the West end line, and 50 feet in the opposite direction from discovery to the

East end line, and 300 feet on each side of the middle of said lode or ledge, for the purpose of mining the same and claiming all surface rights, privileges and minerals, with all dips, spurs, angles and variations, and other rights granted by existing laws and customs. This claim is further described as follows: The Monument of Location of this claim is approximately 1000 ft.

southerly and 2400 ft. westerly of the NE. corner of Section 36, Township 28 N, Range 52 E. Nevada Meridian, Eureka County, Nevada.

The adjoining claims are Pete 259 on the north; Pete 263 on the south; on the west; Pete 264 on the east.

The location work consisted of making & preparing maps as required in Nevada Revised Statutes 517:040. A notice of location is placed at Location Monument; Posts are placed at each corner at the center of each side line and the name of this lode and date of location, are placed on all posts.

Located this 18th day of April, 1989

WITNESSES:

Peter W. Laczay

Peter W. Laczay
 P. O. Box 488
 Coeur d'Alene, Id. 83814 Locators

OFFICIAL RECORDS
 EUREKA COUNTY, NEVADA
 MINERAL CLAIM REGISTER
 FILE NO. 127359 FILE # 6-21

RECORDED AT THE REQUEST OF
 BOOK 197 PAGE 288
 89 JUN 12 AM 12:23
John Allen Moore, Jr

127360

Completed State of _____
 Filed County of _____
 RECORDED
 Vol. _____ of _____
 Page _____ Request of _____
 19_____
 County Auditor _____ Deputy _____
 Mail to _____
 Fee _____

Nw. cor. Side center cor. NE. cor.

CERTIFICATE OF LOCATION

STATE OF NEVADA

EUREKA COUNTY

Mineral Hill MINING DISTRICT

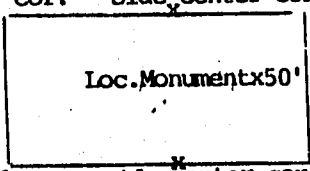

This diagram explains method of description of claim.

SW. cor. Side center cor. SE. cor.

NOTICE IS HEREBY GIVEN, That the undersigned, having complied with the requirements of Chapter Six, Title thirty-two of the Revised Statutes of the United States, and the laws of the above State, and the local customs and regulations of said district, has located and do hereby locate 1500 linear feet in length, and 600 feet in width on the PETE 262

lode, vein, ledge or deposit (or placer ground), situated in above State, County or Mining District, and further described as follows: Commencing at a post marked SE corner located about 300' southerly from the monument of Location, thence 750 feet in a S 85° West
direction to a Southside center post marked, thence 750 feet in a S 85° West
direction to a corner post marked SW corner, thence 600 feet in a Northerly
direction to a corner post marked NW corner, thence 750 feet in a N 85° East
direction to a post marked Northside center, thence 750 feet in a N 85° East
direction to a corner post marked NE corner, thence 300 feet in a Southerly
direction to the SE. corner hereby locating and intending to claim 1,450
feet in a Westerly direction from monument of location to the West
end line, and 50 feet in the opposite direction from discovery to the
East end line, and 300 feet on each side of the middle of
said lode or ledge, for the purpose of mining the same and claiming all surface rights, privileges and minerals, with
all dips, spurs, angles and variations, and other rights granted by existing laws and customs. This claim is further de-
scribed as follows: The Monument of Location of this claim is approximately 200 ft.
southerly and 800 ft. westerly of the NE. corner of Section 36,
Township 28 N, Range 52 E. Nevada Meridian, Eureka County, Nevada.
The adjoining claims are Pete 260 on the north; Pete 264 on the south;
Pete 259 on the west; Pete 278 on the east.

The location work consisted of making & preparing maps as required in Nevada Revised Statutes 517:040. A notice of location is placed at Location Monument; Posts are placed at each corner at the center of each side line and the name of this lode and date of location, are placed on all posts.

Located this 1st day of April, 1989

WITNESSES:

[Signature]

Peter W. Laczay
 P. O. Box 488
 Coeur d'Alene, Id. 83814 Locature

127360

OFFICIAL RECORDS
 EUREKA COUNTY, NEVADA
 M. N. RE BAILEY, CLERK
 FILE NO. 127360

RECORDED AT THE REQUEST OF
 BOOK 197 PAGE 289
 J. Alan S. Ives, Mgr.
 89 JUN 12 AM 12:23

BOOK 197 PAGE 289

127361

Completed State of _____
 Entered County of _____
 RECORDED as _____
 Vol. _____ of _____
 Page _____ Request of _____
 _____ 19____

 County Auditor _____
 Deputy _____
 Mail to _____

 Fee _____

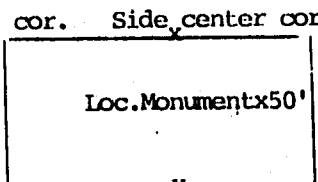

CERTIFICATE OF LOCATION

STATE OF NEVADA

EUREKA COUNTY

Mineral Hill MINING DISTRICT

SW. cor. Side center cor. SE. cor.
 This diagram explains method of description of claim.

NOTICE IS HEREBY GIVEN, That the undersigned, having complied with the requirements of Chapter Six, Title thirty-two of the Revised Statutes of the United States, and the laws of the above State, and the local customs and regulations of said district,

has located and do hereby locate 1500 linear feet in length, and 600 feet in width on the PETE 263

lode, vein, ledge or deposit (or placer ground), situated in above State, County or Mining District, and further described as follows: Commencing at a post marked SE corner located about 300' southerly from the monument of Location, thence 750 feet in a Westerly direction to a Southside center post marked, thence 750 feet in a Westerly direction to a corner post marked SW corner, thence 600 feet in a Northerly direction to a corner post marked NW corner, thence 750 feet in a Easterly direction to a post marked Northside center, thence 750 feet in a Easterly direction to a corner post marked NE corner, thence 300 feet in a Southerly direction to the SE. corner hereby locating and intending to claim 1, feet in a Westerly direction from monument of location to the West end line, and 50 feet in the opposite direction from discovery to the East end line, and 300 feet on each side of the middle of

said lode or ledge, for the purpose of mining the same and claiming all surface rights, privileges and minerals, with all dips, spurs, angles and variations, and other rights granted by existing laws and customs. This claim is further described as follows: The Monument of Location of this claim is approximately 1600 ft.

southerly and 2400 ft. westerly of the NW. corner of Section 36, Township 28 N, Range 52 E, Nevada Meridian, Eureka County, Nevada. The adjoining claims are Pete 261 on the north; Pete 265 on the south; on the west; Pete 266 on the east.

The location work consisted of making & preparing maps as required in Nevada Revised Statutes 517:040. A notice of location is placed at Location Monument; Posts are placed at each corner at the center of each side line and the name of this lode and date of location, are placed on all posts.

Located this 1st day of April 19 89

WITNESSES:

Peter W. Laczay

Peter W. Laczay
 P. O. Box 488
 Coeur d' Alene, Id. 83814 Locators

OFFICIAL RECORDS
 EUREKA COUNTY, NEVADA
 MINERAL LODE RECORDS
 FILE NO. 127361
 FILE \$ 7

RECORDED AT THE REQUEST OF
 BOOK 197 PAGE 290
 Adeno Silver Mine
 89 JUN 12 AM 12:23

Compared... Filed...
 State of... County of...
 RECORDED
 Vol. ... of ...
 Page ... Request of ...
 19...
 County Auditor
 Deputy
 Mail to...
 Fee ...

NW. cor. Side center cor. NE. cor.

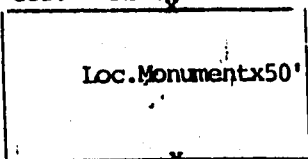

CERTIFICATE OF LOCATION

STATE OF NEVADA
 EUREKA COUNTY
 Mineral Hill MINING DISTRICT

SW. cor. Side center cor. SE. cor.

This diagram explains method of description of claim.

NOTICE IS HEREBY GIVEN, That the undersigned, having complied with the requirements of Chapter Six, Title thirty-two of the Revised Statutes of the United States, and the laws of the above State, and the local customs and regulations of said district, has located and do hereby locate 1500 linear feet in length, and 600 feet in width on the PETE 264

lode, vein, ledge or deposit (or placer ground), situated in above State, County or Mining District, and further described as follows: Commencing at a post marked SE corner located about 300' southerly from the monument of Location, thence 750 feet in S 85° West direction to a Southside center post marked, thence 750 feet in S 85° West direction to a corner post marked SW corner, thence 600 feet in Northerly direction to a corner post marked NW corner, thence 750 feet in N 85° East direction to a post marked Northside center, thence 750 feet in N 85° East direction to a corner post marked NE corner, thence 300 feet in Southerly direction to the SE. corner hereby locating and intending to claim 1,450 feet in Westerly direction from monument of location to the West end line, and 50 feet in the opposite direction from discovery to the East end line, and 300 feet on each side of the middle of

said lode or ledge, for the purpose of mining the same and claiming all surface rights, privileges and minerals, with all dips, spurs, angles and variations, and other rights granted by existing laws and customs. This claim is further described as follows: The Monument of Location of this claim is approximately 800 ft.

southerly and 800 ft. westerly of the NE. corner of Section 36, Township 28 N, Range 52 E. Nevada Meridian, Eureka County, Nevada.

The adjoining claims are Pete 262 on the north; Pete 266 on the south; Pete 261 on the west; Pete 279 on the east.

The location work consisted of making & preparing maps as required in Nevada Revised Statutes 517:040. A notice of location is placed at Location Monument; Posts are placed at each corner at the center of each side line and the name of this lode and date of location, are placed on all posts.

Located this 1st day of APRIL 19 89

WITNESSES:

Peter W. Laczay

Peter W. Laczay
 P. O. Box 488
 Coeur d' Alene, Id. 83814 Locators

127362

OPTIONAL RECORDS
 EUREKA COUNTY NEVADA
 M.N. REBALL AFTER ORDER
 FILE NO. FEB 5

RECORDED AT THE REQUEST OF
 BOOK 197 PAGE 291
 89 JUN 12 AM 123
John Allen Plummer

127363

Compared State of Nevada
Filed County of Eureka
Request of
County Auditor
Deputy
Mail to
Fee

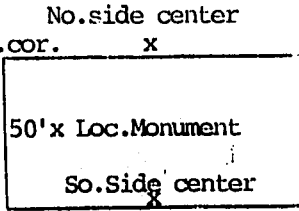

CERTIFICATE OF LOCATION

STATE OF NEVADA

EUREKA

COUNTY

Mineral Hill

MINING DISTRICT

This diagram explains method of description of claim.

NOTICE IS HEREBY GIVEN, That the undersigned, having complied with the requirements of Chapter Six, Title thirty-two of the Revised Statutes of the United States, and the laws of the above State, and the local customs and regulations of said district,

has located and do hereby locate 1500 linear feet in length, and 600 feet in width on the PETE 265

lode, vein, ledge or deposit (or placer ground), situated in above State, County or Mining District, and further described as follows: Commencing at a post marked SW corner located about 300' South from the monument of location thence 750 feet in a Easterly direction to a post marked south side center, thence 750 feet in a Easterly direction to a corner post marked SE cor., thence 600 feet in a Northerly direction to a corner post marked NE Cor., thence 750 feet in a Westerly direction to a post marked Northside center, thence 750 feet in a Westerly direction to a corner post marked NW Cor., thence 600 feet in a Southerly direction to the SW corner hereby locating and intending to claim 1450 feet in a Easterly direction from Monument of location to the East end line, and 50 feet in the opposite direction from discovery to the West end line, and 300 feet on each side of the middle of said lode or ledge for the purpose of mining the same and claiming all surface rights, privileges and minerals, with all dips, spurs, angles and variations, and other rights granted by existing laws and customs. This claim is further described as follows:

The Monument of Location of this claim is approximately 2200 ft. southerly and 2400 ft. westerly of the NE. corner of Section 36 Township 28 N, Range 52 E, Nevada Meridian, Eureka County, Nevada. The adjoining claims are Pete 263 on the north; Pete 267 on the south; on the west; Pete 268 on the east.

The location work consisted of making & preparing maps as required in Nevada Revised Statutes 517:040. A notice of location is placed at Location Monument; Posts are placed at each corner at the center of each side line and the name of this lode and date of location, are placed on all posts.

Located this 31st day of March 19 89

WITNESSES:

Peter W. Laczay

Peter W. Laczay
P. O. Box 488
Coeur d' Alene, Idaho 83814 Locators

127363

OFFICE RECORDS
EUREKA COUNTY, NEVADA
MINING DISTRICT
FILE NO. FILE 3

RECORDED AT THE REQUEST OF
BOOK 197 PAGE 292
Adena Adena Miner - One
89 JUN 12 AM 23

Compared State of _____
 Filed County of _____
 RECORDED
 Vol. _____ of _____
 Page _____ Request of _____
 19 _____
 County Auditor _____
 Deputy _____
 Mail to _____
 Fee _____

NW. cor. Side center cor. NE. cor.

CERTIFICATE OF LOCATION

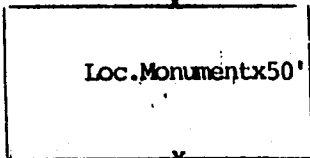

STATE OF NEVADA

EUREKA COUNTY

SW. cor. Side center cor. SE. cor.

Mineral Hill MINING DISTRICT

This diagram explains method of description of claim.

NOTICE IS HEREBY GIVEN, That the undersigned, having complied with the requirements of Chapter Six, Title thirty-two of the Revised Statutes of the United States, and the laws of the above State, and the local customs and regulations of said district,

has located and do hereby locate 1500 linear feet in length, and 600 feet in width on the PETE 266

lode, vein, ledge or deposit (or placer ground), situated in above State, County or Mining District, and further described as follows: Commencing at a post marked SE corner located about 300' southerly from the monument of Location, thence 750 feet in S 85° West direction to a Southside center post marked, thence 750 feet in S 85° West direction to a corner post marked SW corner, thence 600 feet in Northerly direction to a corner post marked NW corner, thence 750 feet in N 85° East direction to a post marked Northside center, thence 750 feet in N 85° East direction to a corner post marked NE corner, thence 300 feet in Southerly direction to the SE corner hereby locating and intending to claim 1,450 feet in Westerly direction from monument of location to the West end line, and 50 feet in the opposite direction from discovery to the East end line, and 300 feet on each side of the middle of said lode or ledge, for the purpose of mining the same and claiming all surface rights, privileges and minerals, with all dips, spurs, angles and variations, and other rights granted by existing laws and customs. This claim is further described as follows:

The Monument of Location of this claim is approximately 1400 ft. southerly and 800 ft. westerly of the NE. corner of Section 36, Township 28 N, Range 52 E. Nevada Meridian, Eureka County, Nevada.

The adjoining claims are Pete 264 on the north; Pete 268 on the south; Pete 263 on the west; Pete 281 on the east.

The location work consisted of making & preparing maps as required in Nevada Revised Statutes 517:040. A notice of location is placed at Location Monument; Posts are placed at each corner at the center of each side line and the name of this lode and date of location, are placed on all posts.

Located this 1st day of April 1989

WITNESSES: _____ *Peter W. Laczay*

Peter W. Laczay
 P. O. Box 488
 Coeur d'Alene, Id. 83814 Locators

RECORDED AT THE REQUEST OF
 BOOK 197 PAGE 293
Steve Wilson Miner, Inc.
 89 JUN 12 AM 12:33
 OFFICIAL RECORDER
 EUREKA COUNTY, NEVADA
 H.M. REBALSATI, RECORDER
 FILE NO. 127364
 FEE \$ 6.25

Computed State of Nevada, Filed County of Eureka, No. side center 127365, X, NE. cor., 50' x Loc. Monument, So. Side center, SW. cor., This diagram explains method of description of claim, County Auditor, Deputy, Mail to, Fee

CERTIFICATE OF LOCATION, STATE OF NEVADA, EUREKA COUNTY, Mineral Hill MINING DISTRICT

NOTICE IS HEREBY GIVEN, That the undersigned, having complied with the requirements of Chapter Six, Title thirty-two of the Revised Statutes of the United States, and the laws of the above State, and the local customs and regulations of said district,

has located and do hereby locate 1500 linear feet in length, and 600 feet in width on the PETE 267

lode, vein, ledge or deposit (or placer ground), situated in above State, County or Mining District, and further described as follows: Commencing at a post marked SW corner located about 300' South from the monument of location thence 750 feet in a Easterly direction to a post marked south side center, thence 750 feet in a Easterly direction to a corner post marked SE cor., thence 600 feet in a Northerly direction to a corner post marked NE Cor., thence 750 feet in a Westerly direction to a post marked Northside center, thence 750 feet in a Westerly direction to a corner post marked NW Cor., thence 600 feet in a Southerly direction to the SW corner hereby locating and intending to claim 1450 feet in a Easterly direction from Monument of location to the East end line, and 50 feet in the opposite direction from discovery to the West end line, and 300 feet on each side of the middle of said lode or ledge for the purpose of mining the same and claiming all surface rights, privileges and minerals, with all dips, spurs, angles and variations, and other rights granted by existing laws and customs. This claim is further described as follows: The Monument of Location of this claim is approximately 2800 ft. southerly and 300 ft. westerly of the NE. corner of Section 36 Township 28 N, Range 52 E, Nevada Meridian, Eureka County, Nevada. The adjoining claims are Pete 265 on the north; Pete 269 on the south; on the west; Pete 270 on the east.

The location work consisted of making & preparing maps as required in Nevada Revised Statutes 517:040. A notice of location is placed at Location Monument; Posts are placed at each corner at the center of each side line and the name of this lode and date of location, are placed on all posts.

Located this 3rd day of April 19 89

WITNESSES: Peter W. Laczay, P. O. Box 488, Coeur d'Alene, Idaho 83814 Locators

RECORDED AT THE REQUEST OF, BOOK 197 PAGE 294, Adora Helen Munn, Inc, 89 JUN 12 AM 12:3, OFFICIAL RECORDS, EUREKA COUNTY, NEVADA, M.N. RECORDS AND RECORDER, FILE NO 127365, FILE 25

Completed
State of _____
County of _____
Recorded as
Vol. _____ of _____
Page _____ Request of _____
19 _____
County Auditor _____
Deputy _____
Mail to _____
Fee _____

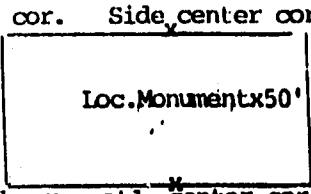

CERTIFICATE OF LOCATION

STATE OF NEVADA

EUREKA

COUNTY

Minoral Hill

MINING DISTRICT

This diagram explains method of description of claim.

NOTICE IS HEREBY GIVEN, That the undersigned, having complied with the requirements of Chapter Six, Title thirty-two of the Revised Statutes of the United States, and the laws of the above State, and the local customs and regulations of said district,

has located and do hereby locate 1500 linear feet in length, and 600 feet in width on the PETE 268

lode, vein, ledge or deposit (or placer ground), situated in above State, County or Mining District, and further described as follows: Commencing at a post marked SE corner located about 300' southerly from the monument of Location, thence 750 feet in S 85° West direction to a Southside center post marked, thence 750 feet in S 85° West direction to a corner post marked SW corner, thence 600 feet in Northerly direction to a corner post marked NW corner, thence 750 feet in N 85° East direction to a post marked Northside center, thence 750 feet in N 85° East direction to a corner post marked NE corner, thence 300 feet in Southerly direction to the SE corner hereby locating and intending to claim 1,450 feet in Westerly direction from monument of location to the West end line, and 50 feet in the opposite direction from discovery to the East end line, and 300 feet on each side of the middle of

said lode or ledge, for the purpose of mining the same and claiming all surface rights, privileges and minerals, with all dips, spurs, angles and variations, and other rights granted by existing laws and customs. This claim is further described as follows: The Monument of Location of this claim is approximately 2000 ft.

southerly and 800 ft. westerly of the NE. corner of Section 36 Township 28 N, Range 52 E. Nevada Meridian, Eureka County, Nevada.

The adjoining claims are Pete 266 on the north; Pete 270 on the south; Pete 265 on the west; Pete 282 on the east.

The location work consisted of making & preparing maps as required in Nevada Revised Statutes 517:040. A notice of location is placed at Location Monument; Posts are placed at each corner at the center of each side line and the name of this lode and date of location, are placed on all posts.

Located this 1st day of April 19 89

WITNESSES:

Peter W. Laczay

Peter W. Laczay
P. O. Box 488
Coeur d' Alene, Id. 83814 Locators

127366

OFFICIAL RECORDS
EUREKA COUNTY, NEVADA
M.N. REBALANCE RECORDS
FILE NO. _____
FEE \$ _____

RECORDED AT THE REQUEST OF
BOOK 197 PAGE 295
Done Peter W. Laczay
89 JUN 12 AM 12:23

Computed State of _____
 Filed County of _____
 RECORDED
 Vol. _____ of _____
 Page _____ Request of _____
 19. _____
 County Auditor _____
 Deputy _____
 Mail to _____
 Fee _____

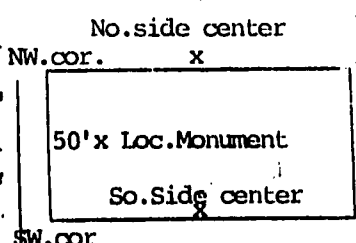

No. side center **127367**
 NW. cor. X NE. cor. **CERTIFICATE OF LOCATION**

STATE OF NEVADA
 EUREKA COUNTY

SW. cor. This diagram explains method of description of claim.
 SE. cor. Mineral Hill MINING DISTRICT

NOTICE IS HEREBY GIVEN, That the undersigned, having complied with the requirements of Chapter Six, Title thirty-two of the Revised Statutes of the United States, and the laws of the above State, and the local customs and regulations of said district;

has located and do hereby locate 1500 linear feet in length,
 and 600 feet in width on the PETE 269

lode, vein, ledge or deposit (or placer ground), situated in above State, County or Mining District, and further described as follows: Commencing at a post marked SW corner located about 300' South from the monument of location thence 750 feet in a Easterly direction to a post marked south side center, thence 750 feet in a Easterly direction to a corner post marked SE cor., thence 600 feet in a Northerly direction to a corner post marked NE Cor., thence 750 feet in a Westerly direction to a post marked Northside center, thence 750 feet in a Westerly direction to a corner post marked NW Cor., thence 600 feet in a Southerly direction to the SW corner hereby locating and intending to claim 1450 feet in a Easterly direction from Monument of location to the East end line, and 50 feet in the opposite direction from discovery to the West end line, and 300 feet on each side of the middle of said lode or ledge for the purpose of mining the same and claiming all surface rights, privileges and minerals, with all dips, spurs, angles and variations, and other rights granted by existing laws and customs. This claim is further described as follows:

The Monument of Location of this claim is approximately 3400 ft. southerly and 3000 ft. westerly of the NE. corner of Section 36 Township 28 N, Range 52 E, Nevada Meridian, Eureka County, Nevada.
 The adjoining claims are Pete 267 on the north; Pete 271 on the south; Pete 254 on the west; Pete 272 on the east.

The location work consisted of making & preparing maps as required in Nevada Revised Statutes 517:040. A notice of location is placed at Location Monument; Posts are placed at each corner at the center of each side line and the name of this lode and date of location, are placed on all posts.

Located this 3rd day of April, 19. 89

WITNESSES: _____

 Peter W. Laczay
 P. O. Box 488
 Coeur d' Alene, Idaho 83814 Locators

RECORDED AT THE REQUEST OF
 BOOK 197 PAGE 269
 Eureka County Nevada
 JUN 12 AM 12 24
 OFFICIAL RECORDS
 EUREKA COUNTY, NEVADA
 FILE NO. 127367
 FILE \$ 2.00
 I have taken Memo. Rec

127368

Completed State of ... Filed County of ... as RECORDED ... Vol. of ... Page ... Request of ... 19... County Auditor ... Deputy ... Mail to ... Fee ...

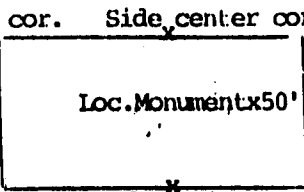

CERTIFICATE OF LOCATION

STATE OF NEVADA

EUREKA

COUNTY

Mineral Hill

MINING DISTRICT

This diagram explains method of description of claim.

NOTICE IS HEREBY GIVEN, That the undersigned, having complied with the requirements of Chapter Six, Title thirty-two of the Revised Statutes of the United States, and the laws of the above State, and the local customs and regulations of said district,

1500

has located and do hereby locate linear feet in length,

600

PETE 270

lode, vein, ledge or deposit (or placer ground), situated in above State, County or Mining District, and further described as follows: Commencing at a post marked SE corner located about 300' southerly from the monument of Location, thence 750 feet in a S 85° West

direction to a Southside center post marked, thence 750 feet in a S 85° West

direction to a corner post marked SW corner, thence 600 feet in a Northerly

direction to a corner post marked NW corner, thence 750 feet in a N 85° East

direction to a post marked Northside center, thence 750 feet in a N 85° East

direction to a corner post marked NE corner, thence 300 feet in a Southerly

direction to the SE corner hereby locating and intending to claim 1,450

feet in a Westerly direction from monument of location to the West

end line, and 50 feet in the opposite direction from discovery to the East

end line, and 300 feet on each side of the middle of said lode or ledge, for the purpose of mining the same and claiming all surface rights, privileges and minerals, with all dips, spurs, angles and variations, and other rights granted by existing laws and customs. This claim is further described as follows:

The Monument of Location of this claim is approximately 2000 ft. southerly and 800 ft. westerly of the NE corner of Section 36

Township 28 N, Range 52 E. Nevada Meridian, Eureka County, Nevada.

The adjoining claims are Pete 268 on the north; Pete 272 on the south;

Pete 267 on the west; Pete 283 on the east.

The location work consisted of making & preparing maps as required in Nevada Revised Statutes 517:040. A notice of location is placed at Location Monument; Posts are placed at each corner at the center of each side line and the name of this lode and date of location, are placed on all posts.

Located this 1st day of April 19 89

WITNESSES:

[Signature]

Peter W. Laczay

P. O. Box 488

Coeur d'Alene, Id. 83814

Locature

127368

OFFICIAL RECORDS EUREKA COUNTY NEVADA M.N. REB. JUN 12 1989 FILE NO. 625

RECORDED AT THE REQUEST OF BOOK 197 PAGE 297 Idea Silver Mine, Inc JUN 12 1989

127369

Completed... Filed... State of... County of... RECORDED... Vol... of... Page... Request of... 19... County Auditor... Deputy... Mail to... Fee...

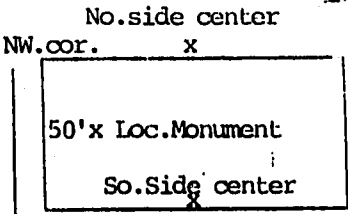

CERTIFICATE OF LOCATION

STATE OF NEVADA EUREKA COUNTY

SW. cor. This diagram explains method of description of claim.

Mineral Hill MINING DISTRICT

NOTICE IS HEREBY GIVEN, That the undersigned, having complied with the requirements of Chapter Six, Title thirty-two of the Revised Statutes of the United States, and the laws of the above State, and the local customs and regulations of said district,

located and do hereby locate 1500 linear feet in length, and 600 feet in width on the PETE 271

lode, vein, ledge or deposit (or placer ground), situated in above State, County or Mining District, and further described as follows: Commencing at a post marked SW corner located about 300' South from the monument of location thence 750 feet in a Easterly direction to a post marked south side center, thence 750 feet in a Easterly direction to a corner post marked SE cor., thence 600 feet in a Northerly direction to a corner post marked NE Cor., thence 750 feet in a Westerly direction to a post marked Northside center, thence 750 feet in a Westerly direction to a corner post marked NW Cor., thence 600 feet in a Southerly direction to the SW corner hereby locating and intending to claim 1450 feet in a Easterly direction from Monument of location to the East end line, and 50 feet in the opposite direction from discovery to the West end line, and 300 feet on each side of the middle of said lode or ledge for the purpose of mining the same and claiming all surface rights, privileges and minerals, with all dips, spurs, angles and variations, and other rights granted by existing laws and customs. This claim is further described as follows:

The Monument of Location of this claim is approximately 4000 ft. southerly and 3800 ft. westerly of the NE. corner of Section 36 Township 28 N, Range 52 E. Nevada Meridian, Eureka County, Nevada.

The adjoining claims are Pete 269 on the north; Pete 273 on the south; Pete 253 on the west; Pete 274 on the east.

The location work consisted of making & preparing maps as required in Nevada Revised Statutes 517:040. A notice of location is placed at Location Monument; Posts are placed at each corner at the center of each side line and the name of this lode and date of location, are placed on all posts.

Located this 3rd day of April 19 89

WITNESSES: Peter W. Laczay P. O. Box 488 Coeur d' Alene, Idaho 83814 Locators

RECORDED AT THE REQUEST OF BOOK 197 PAGE 298 89 JUN 12 AM 12:24 Jena Silverman, Inc. OFFICIAL RECORDS EUREKA COUNTY NEVADA MIN. REDEVELOPMENT ORDER FILE NO. 127369

CERTIFICATE OF LOCATION

Completed State of Nevada... Vol. of ... Page... Request of ... County Auditor Deputy ... Mail to ... Fee ...

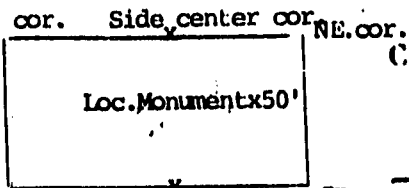

STATE OF NEVADA

EUREKA

COUNTY

Mineral Hill

MINING DISTRICT

SW.cor. Side center cor. SE.cor. This diagram explains method of description of claim.

NOTICE IS HEREBY GIVEN, That the undersigned, having complied with the requirements of Chapter Six, Title thirty-two of the Revised Statutes of the United States, and the laws of the above State, and the local customs and regulations of said district,

1500

located and do hereby locate linear feet in length.

and 600 feet in width on the PETE 272

lode, vein, ledge or deposit (or placer ground), situated in above State, County or Mining District, and further described as follows: Commencing at a post marked SE corner located about 300' southerly from the monument of Location, thence 750 feet in S 85° West direction to a Southside center post marked, thence 750 feet in S 85° West direction to a corner post marked SW corner, thence 600 feet in Northerly direction to a corner post marked NW corner, thence 750 feet in N 85° East. direction to a post marked Northside center, thence 750 feet in N 85° East direction to a corner post marked NE corner, thence 300 feet in Southerly direction to the SE. corner hereby locating and intending to claim 1,450 feet in Westerly direction from monument of location to the West end line, and 50 feet in the opposite direction from discovery to the East end line, and 300 feet on each side of the middle of said lode or ledge. for the purpose of mining the same and claiming all surface rights, privileges and minerals, with all dips, spurs, angles and variations, and other rights granted by existing laws and customs. This claim is further described as follows: southerly and 800 ft. westerly of the NE. corner of Section 36 Township 28 N, Range 52 E, Nevada Meridian, Eureka County, Nevada.

The Monument of Location of this claim is approximately 3200 ft.

The adjoining claims are Pete 270 on the north; Pete 274 on the south; Pete 269 on the west; Pete 284 on the east.

The location work consisted of making & preparing maps as required in Nevada Revised Statutes 517:040. A notice of location is placed at Location Monument; Posts are placed at each corner at the center of each side line and the name of this lode and date of location, are placed on all posts.

Located this 1st day of April 18 89

WITNESSES:

[Handwritten signature]

Peter W. Laczay P. O. Box 488

Coeur d' Alene, Id. 83814 Locature

OFFICIAL RECORDS EUREKA COUNTY NEVADA FILE NO. 127370

RECORDED AT THE REQUEST OF BOOK 197 PAGE 295 JUN 12 AM 124

Blanca Wilbur Brown - One

Completed State of _____
Filed County of _____
RECORDED
Vol. _____ of _____
Page _____ Request of _____
19_____
County Auditor _____
Deputy _____
Mail to _____
Fee _____

127371
NW. cor. Side center cor. NE. cor.

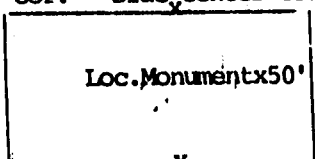

CERTIFICATE OF LOCATION

STATE OF NEVADA

EUREKA COUNTY

Mineral Hill MINING DISTRICT

This diagram explains method of description of claim.

NOTICE IS HEREBY GIVEN, That the undersigned, having complied with the requirements of Chapter Six, Title thirty-two of the Revised Statutes of the United States, and the laws of the above State, and the local customs and regulations of said district,

has located and do hereby locate 1500 linear feet in length, and 600 feet in width on the PETE 274

lode, vein, ledge or deposit (or placer ground), situated in above State, County or Mining District, and further described as follows: Commencing at a post marked SE corner located about 300' southerly from the monument of Location, thence 750 feet in S 85° West direction to a Southside center post marked, thence 750 feet in S 85° West direction to a corner post marked SW corner, thence 600 feet in Northerly direction to a corner post marked NW corner, thence 750 feet in N 85° East direction to a post marked Northside center, thence 750 feet in N 85° East direction to a corner post marked NE corner, thence 300 feet in Southerly direction to the SE corner hereby locating and intending to claim 1,450 feet in Westerly direction from monument of location to the West end line, and 50 feet in the opposite direction from discovery to the East end line, and 300 feet on each side of the middle of said lode or ledge, for the purpose of mining the same and claiming all surface rights, privileges and minerals, with all dips, apura, angles and variations, and other rights granted by existing laws and customs. This claim is further described as follows: The Monument of Location of this claim is approximately 300 ft. southerly and 300 ft. westerly of the NE. corner of Section 36, Township 28 N, Range 52 E. Nevada Meridian, Eureka County, Nevada.

The adjoining claims are Pete 272 on the north; Pete 292, 291, 293 on the south; Pete 271 on the west; Pete 285 on the east.

The location work consisted of making & preparing maps as required in Nevada Revised Statutes 517:040. A notice of location is placed at Location Monument; Posts are placed at each corner at the center of each side line and the name of this lode and date of location, are placed on all posts.

Located this 1st day of April, 1989

WITNESSES:

Peter W. Laczay

Peter W. Laczay
P. O. Box 488
Coeur d'Alene, Id. 83814 Locators

OPTIONAL RECORDS
EUREKA COUNTY, NEVADA
MINERAL RIGHTS RECORDER
FILE NO. 625
127371
RECORDED AT THE REQUEST OF
BOOK 197 PAGE 300
Jana Silbermann
89 JAN 12 AM 12:24

Compared..... Filed.....
 State of..... County of.....
 RECORDED
 Vol..... of.....
 Page..... Request of.....
 19.....
 County Auditor
 Deputy
 Mail to.....
 Fee.....

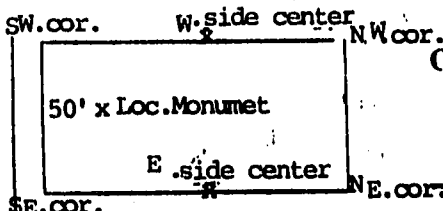

CERTIFICATE OF LOCATION

STATE OF NEVADA
 EUREKA COUNTY

This diagram explains method of description of claim.

Mineral Hill MINING DISTRICT

NOTICE IS HEREBY GIVEN, That the undersigned, having complied with the requirements of Chapter Six, Title thirty-two of the Revised Statutes of the United States, and the laws of the above State, and the local customs and regulations of said district,

has located and do hereby locate 1500 linear feet in length,
 and 600 feet in width on the PETE 276

lode, vein, ledge or deposit (or placer ground), situated in above State, County or Mining District, and further described as follows: Commencing at a post marked SE corner located about 300' east from the monument of location, thence 750 feet in a North erly direction to a Eastside center post marked, thence 750 feet in a Northerly direction to a corner post marked NE corner, thence 600 feet in a Westerly direction to a corner post marked NW corner, thence 750 feet in a Southerly direction to a post marked Westside Center, thence 750 feet in a Southerly direction to a corner post marked SW corner, thence 600 feet in a Easterly direction to the SE corner hereby locating and intending to claim 1360 feet in a northerly direction from monument of location to the north end line, and 140 feet in the opposite direction from discovery to the south end line, and 300 feet on each side of the middle of said lode or ledge, for the purpose of mining the same and claiming all surface rights, privileges and minerals, with all dips, apura, angles and variations, and other rights granted by existing laws and customs. This claim is further described as follows: The Monument of Location of this claim is approximatley 4600 ft. southerly and 500 ft. westerly of the NE corner of Section 25, Township 28 N, Range 52 E. Nevada Meridian, County, Nevada.

The adjoining claims are - on the north; Pete 277 on the south; Pete 258 on the west; Five-O #21 & 299 on the east.

The location work consisted of making & preparing maps as required in Nevada Revised Statutes 517:040. A notice of location is placed at Location Monument; Posts are placed at each corner at the center of each side line and the name of this lode and date of location, are placed on all posts.

Located this 1st day of APRIL 19 89

WITNESSES:

Peter W. Laczay

Peter W. Laczay,
 P. O. Box 488
 Coeur d' Alene, Id. 83814 Locators

RECORDED AT THE REQUEST OF
 BOOK 197 PAGE 301
 State Silver Minerals
 89 JUN 12 AM 12:24
 OFFICIAL RECORDS
 EUREKA COUNTY, NEVADA
 MINERAL EDITION RECORDED
 FILE NO. 127372
 FILE 5 6

Computed... Filed...
 State of... County of...
 RECORDED
 Vol. of
 Page... Request of
 19...
 County Auditor
 Deputy
 Mail to
 Fee

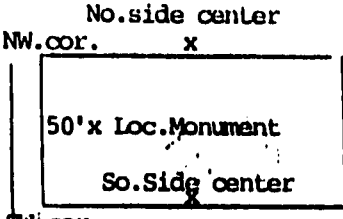

CERTIFICATE OF LOCATION
 STATE OF NEVADA
 EUREKA COUNTY
 Mineral Hill MINING DISTRICT

This diagram explains method of description of claim.

NOTICE IS HEREBY GIVEN, That the undersigned, having complied with the requirements of Chapter Six, Title thirty-two of the Revised Statutes of the United States, and the laws of the above State, and the local customs and regulations of said district,

has located and do hereby locate 1500 linear feet in length, and 600 feet in width on the PETE 277

lode, vein, ledge or deposit (or placer ground), situated in above State, County or Mining District, and further described as follows: Commencing at a post marked SW corner located about 300' South from the monument of location thence 700 feet in a Easterly direction to a post marked south side center, thence 700 feet in a Easterly direction to a corner post marked SE cor., thence 600 feet in a Northerly direction to a corner post marked NE Cor., thence 700 feet in a Westerly direction to a post marked Northside center, thence 700 feet in a Westerly direction to a corner post marked NW Cor., thence 600 feet in a Southerly direction to the SW corner hereby locating and intending to claim 1350 feet in a Easterly direction from Monument of location to the East end line, and 50 feet in the opposite direction from discovery to the West end line, and 300 feet on each side of the middle of said lode or ledge for the purpose of mining the same and claiming all surface rights, privileges and minerals, with all dips, spurs, angles and variations, and other rights granted by existing laws and customs. This claim is further described as follows:

The Monument of Location of this claim is approximately 5000 ft. southerly and 750 ft. westerly of the NE. corner of Section 25 Township 28 N, Range 52 E. Nevada Meridian, Eureka County, Nevada.

The adjoining claims are Pete 276 on the north; Pete 278 on the south; Pete 260 on the west; O-Five #9 on the east.

The location work consisted of making & preparing maps as required in Nevada Revised Statutes 517:040. A notice of location is placed at Location Monument; Posts are placed at each corner at the center of each side line and the name of this lode and date of location, are placed on all posts.

Located this 1st day of APRIL 19 89

WITNESSES:

Peter W. Laczay
 Peter W. Laczay
 P. O. Box 488
 Coeur d' Alene, Idaho 83814 Locators

127373

OFFICIAL RECORDS
 EUREKA COUNTY NEVADA
 M. N. RECORDS
 FILE NO. 6-25

RECORDED AT THE REQUEST OF
 BOOK 197 PAGE 302
 89 JUN 12 AM 12:24
Adora Helen Prince, Sec.

127374

Computed State of _____
 Located County of _____
 RECORDED as _____
 Vol. _____ of _____
 Page _____ Request of _____
 No. _____
 County Auditor _____
 Deputy _____
 Mail to _____
 Fee _____

No. side center
 NW. cor. X
 50' x Loc. Monument
 So. Side center
 SW. cor.

CERTIFICATE OF LOCATION
 STATE OF NEVADA
 EUREKA COUNTY
 Mineral Hill MINING DISTRICT

This diagram explains method of description of claim.

NOTICE IS HEREBY GIVEN, That the undersigned, having complied with the requirements of Chapter Six, Title thirty-two of the Revised Statutes of the United States, and the laws of the above State, and the local customs and regulations of said district,

in ^s located and do hereby locate 1500 linear feet in length, and 600 feet in width on the PETE 278

lode, vein, ledge or deposit (or placer ground), situated in above State, County or Mining District, and further described as follows: Commencing at a post marked SW corner located about 300' South from the monument of location thence 700 feet in a Easterly direction to a post marked south side center, thence 700 feet in a Easterly direction to a corner post marked SE cor., thence 600 feet in a Northerly direction to a corner post marked NE Cor., thence 700 feet in a Westerly direction to a post marked Northside center, thence 700 feet in a Westerly direction to a corner post marked NW Cor., thence 600 feet in a Southerly direction to the SW. corner hereby locating and intending to claim 1350 feet in a Easterly direction from Monument of location to the East end line, and 50 feet in the opposite direction from discovery to the West end line, and 300 feet on each side of the middle of

said lode or ledge for the purpose of mining the same and claiming all surface rights, privileges and minerals, with all dips, spurs, angles and variations, and other rights granted by existing laws and customs. This claim is further described as follows: The Monument of Location of this claim is approximately 200 ft. southerly and 750 ft. westerly of the NE. corner of Section 36 Township 28 N, Range 52 E. Nevada Meridian, Eureka County, Nevada.

The adjoining claims are Pete 277 on the north; Pete 279 on the south; Pete 262 on the west; O-Five #9 on the east.

The location work consisted of making & preparing maps as required in Nevada Revised Statutes 517:040. A notice of location is placed at Location Monument; Posts are placed at each corner at the center of each side line and the name of this lode and date of location, are placed on all posts.

Located this 1st day of APRIL 19 89
 WITNESSES: _____

Peter W. Laczay
 P. O. Box 488
 Coeur d' Alene, Idaho 83814 Locators

RECORDED AT THE REQUEST OF
 BOOK 197 PAGE 303
 89 JUN 12 AM 12:24
 J. Allen Wilson Miner, etc.
 OFFICIAL RECORDS
 EUREKA COUNTY NEVADA
 M.M. REBALLER, RECORDER
 FILE NO. 625
 127374
 BOOK 197 PAGE 303

127375

No. side center

Completed
State of _____
County of _____
RECORDED as
Vol. _____ of _____
Page _____ Request of _____
_____ 19 _____
County Auditor
Deputy
Mail to _____
Fee _____

NW. cor. X
50' x Loc. Monument
So. Side center

CERTIFICATE OF LOCATION

STATE OF NEVADA

EUREKA

COUNTY

Mineral Hill MINING DISTRICT

This diagram explains method of description of claim.

NOTICE IS HEREBY GIVEN, That the undersigned, having complied with the requirements of Chapter Six, Title thirty-two of the Revised Statutes of the United States, and the laws of the above State, and the local customs and regulations of said district,

located and do hereby locate 1500 linear feet in length, and 600 feet in width on the PETE 279

lode, vein, ledge or deposit (or placer ground), situated in above State, County or Mining District, and further described as follows: Commencing at a post marked SW corner located about 300' South from the monument of location thence 700 feet in a Easterly direction to a post marked south side center, thence 700 feet in a Easterly direction to a corner post marked SE cor., thence 600 feet in a Northerly direction to a corner post marked NE Cor., thence 700 feet in a Westerly direction to a post marked Northside center, thence 700 feet in a Westerly direction to a corner post marked NW Cor., thence 600 feet in a Southerly direction to the SW corner hereby locating and intending to claim 1350 feet in a Easterly direction from Monument of location to the East end line, and 50 feet in the opposite direction from discovery to the West end line, and 300 feet on each side of the middle of said lode or ledge for the purpose of mining the same and claiming all surface rights, privileges and minerals, with all dips, spurs, angles and variations, and other rights granted by existing laws and customs. This claim is further described as follows: The Monument of Location of this claim is approximately 800 ft. southerly and 750 ft. westerly of the NE. corner of Section 36 Township 28 N, Range 52 E. Nevada Meridian, Eureka County, Nevada.

The adjoining claims are Pete 278 on the north; Pete 281 on the south; Pete 264 on the west; O-Five #12 on the east.

The location work consisted of making & preparing maps as required in Nevada Revised Statutes 517:040. A notice of location is placed at Location Monument; Posts are placed at each corner at the center of each side line and the name of this lode and date of location, are placed on all posts.

Located this 1st day of APRIL 19 89

WITNESSES:

Peter W. Laczay

Peter W. Laczay
P. O. Box 488
Coeur d' Alene, Idaho 83814 Locators

127375

OFFICIAL RECORDS
EUREKA COUNTY NEVADA
MIN. REBALANCE REGISTER
FILE NO. 625

RECORDED AT THE REQUEST OF
BOOK 197 PAGE 304
89 JUN 12 AM 12:24
Adena Silver Mines, Inc

BOOK 197 PAGE 304

127376

Completed... State of... Filed... County of... RECORDED... Vol. of... Page... Request of... 19... County Auditor... Deputy... Mail to... Fee

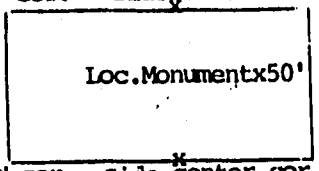

CERTIFICATE OF LOCATION

STATE OF NEVADA

EUREKA

COUNTY

NW. cor. Side center cor. NE. cor. SW. cor. Side center cor. SE. cor.

Mineral Hill

MINING DISTRICT

This diagram explains method of description of claim.

NOTICE IS HEREBY GIVEN, That the undersigned, having complied with the requirements of Chapter Six, Title thirty-two of the Revised Statutes of the United States, and the laws of the above State, and the local customs and regulations of said district,

has located and do hereby locate 1500 linear feet in length, and 600 feet in width on the PETE 296

lode, vein, ledge or deposit (or placer ground), situated in above State, County or Mining District, and further described as follows: Commencing at a post marked SE corner located about 300' southerly from the monument of Location, thence 750 feet in a Westerly

direction to a Southside center post marked, thence 750 feet in a Westerly

direction to a corner post marked SW corner, thence 600 feet in a Northerly

direction to a corner post marked NW corner, thence 750 feet in a Easterly

direction to a post marked Northside center, thence 750 feet in a Easterly

direction to a corner post marked NE corner, thence 300 feet in a Southerly

direction to the SE. corner hereby locating and intending to claim 1,

feet in a Westerly direction from monument of location to the West

end line, and 50 feet in the opposite direction from discovery to the

East end line, and 300 feet on each side of the middle of

said lode or ledge, for the purpose of mining the same and claiming all surface rights, privileges and minerals, with all dips, spurs, angles and variations, and other rights granted by existing laws and customs. This claim is further described as follows:

The Monument of Location of this claim is approximately 900 ft. southerly and 1600 ft. easterly of the NW corner of Section 6,

Township 27 N, Range 53 E, Nevada Meridian, Eureka County, Nevada.

The adjoining claims are Pete 289, 288, 287 on the north; Pete 203, 202, 201 on the south;

Pete 297 on the west; Pete 286 on the east.

The location work consisted of making & preparing maps as required in Nevada Revised Statutes 517:040. A notice of location is placed at Location Monument; Posts are placed at each corner at the center of each side line and the name of this lode and date of location, are placed on all posts.

Located this 17th day of April 19 89

WITNESSES:

[Signature]

Peter W. Iaczay

P. O. Box 488

Coeur d'Alene, Id. 83814

Locators

127376

OFFICIAL RECORDS EUREKA COUNTY NEVADA M. J. REBELETTI, RECORDER FILE NO. 127376

RECORDED AT THE REQUEST OF BOOK 197 PAGE 305 89 JUN 12 AM 12:24

Glenn S. Ivers Blaine, Ore

127378

State of _____
 County of _____
 Vol. _____ of _____
 Page _____ Request of _____
 No. _____
 County Auditor _____
 Deputy _____
 Mail to _____
 Fee _____

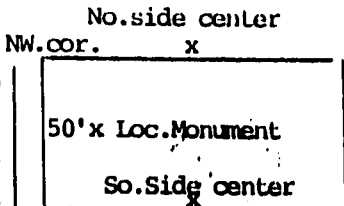

CERTIFICATE OF LOCATION

STATE OF NEVADA

EUREKA

COUNTY

NE. cor.

SW. cor.

Mineral Hill

MINING DISTRICT

NOTICE IS HEREBY GIVEN, That the undersigned, having complied with the requirements of Chapter Six, Title thirty-two of the Revised Statutes of the United States, and the laws of the above State, and the local customs and regulations of said district,

has located and do hereby locate 1500 linear feet in length,
 and 600 feet in width on the PETE 282

lode, vein, ledge or deposit (or placer ground), situated in above State, County or Mining District, and further described as follows: Commencing at a post marked SW corner located about 300' South from the monument of location thence 700 feet in a Easterly direction to a post marked south side center, thence 700 feet in a Easterly direction to a corner post marked SE cor., thence 600 feet in a Northerly direction to a corner post marked NE Cor., thence 700 feet in a Westerly direction to a post marked Northside center, thence 700 feet in a Westerly direction to a corner post marked NW Cor., thence 600 feet in a Southerly direction to the SW corner hereby locating and intending to claim 1250 feet in a Easterly direction from Monument of location to the East end line, and 150 feet in the opposite direction from discovery to the West end line, and 300 feet on each side of the middle of

said lode or ledge for the purpose of mining the same and claiming all surface rights, privileges and minerals, with all dips, spurs, angles and variations, and other rights granted by existing laws and customs. This claim is further described as follows:

The Monument of Location of this claim is approximately 2000 ft. southerly and 750 ft. westerly of the NE corner of Section 36 Township 28 N, Range 52 E. Nevada Meridian, Eureka County, Nevada.

The adjoining claims are Pete 281 on the north; Pete 283 on the south; Pete 268 on the west; O-Five #12 on the east.

The location work consisted of making & preparing maps as required in Nevada Revised Statutes 517:040. A notice of location is placed at Location Monument; Posts are placed at each corner at the center of each side line and the name of this lode and date of location, are placed on all posts.

Located this 1st day of April, 1989

WITNESSES:

Peter W. Laczay

Peter W. Laczay
 P. O. Box 488
 Coeur d' Alene, Idaho 83814 Locators

OFFICIAL RECORDS
 EUREKA COUNTY, NEVADA
 MINERAL RIGHTS RECORDER
 FILE NO. 127378 FEB 25

RECORDED AT THE REQUEST OF
 BOOK 197 PAGE 307
Jana Allen Moore, Inc.
 89 JUN 12 AM 124

BOOK 197 PAGE 307

127379

Computed State of Nevada as RECORDED Vol. of Page Request of County Auditor Deputy Mail to Fee

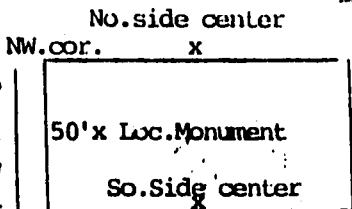

CERTIFICATE OF LOCATION

STATE OF NEVADA

EUREKA

COUNTY

Mineral Hill

MINING DISTRICT

This diagram explains method of description of claim.

NOTICE IS HEREBY GIVEN, That the undersigned, having complied with the requirements of Chapter Six, Title thirty-two of the Revised Statutes of the United States, and the laws of the above State, and the local customs and regulations of said district,

has located and do hereby locate 1500 linear feet in length, and 600 feet in width on the PETE 283

lode, vein, ledge or deposit (or placer ground), situated in above State, County or Mining District, and further described as follows: Commencing at a post marked SW corner located about 300' South from the monument of location thence 700 feet in a Easterly direction to a post marked south side center, thence 700 feet in a Easterly direction to a corner post marked SE cor., thence 600 feet in a Northerly direction to a corner post marked NE Cor., thence 700 feet in a Westerly direction to a post marked Northside center, thence 700 feet in a Westerly direction to a corner post marked NW Cor., thence 600 feet in a Southerly direction to the SW corner hereby locating and intending to claim 1350 feet in a Easterly direction from Monument of location to the East end line, and 50 feet in the opposite direction from discovery to the West end line, and 300 feet on each side of the middle of said lode or ledge for the purpose of mining the same and claiming all surface rights, privileges and minerals, with all dips, spurs, angles and variations, and other rights granted by existing laws and customs. This claim is further described as follows:

The Monument of Location of this claim is approximately 2600 ft. southerly and 750 ft. westerly of the NE. corner of Section 36 Township 28 N, Range 52 E. Nevada Meridian, Eureka County, Nevada.

The adjoining claims are Pete 282 on the north; Pete 284 on the south; Pete 270 on the west; O-Five #13 on the east.

The location work consisted of making & preparing maps as required in Nevada Revised Statutes 517:040. A notice of location is placed at Location Monument; Posts are placed at each corner at the center of each side line and the name of this lode and date of location, are placed on all posts.

Located this 1st day of April 19 89

WITNESSES:

Peter W. Laczay P. O. Box 488 Coeur d' Alene, Idaho 83814 Locators

OFFICIAL RECORDS EUREKA COUNTY, NEVADA M.N. RECORDS & FILE NO. 127379

RECORDED AT THE REQUEST OF BOOK 197 PAGE 308 89 JAN 12 AM 12:24

BOOK 197 PAGE 308

No. side center

Completed State of _____
 County of _____
 RECORDED
 Vol. _____ of _____
 Page _____ Request of _____
 No. _____
 County Auditor _____
 Deputy _____
 Mail to _____
 Fee _____

NW. cor. X
 50' x Loc. Monument
 So. Sidg center

CERTIFICATE OF LOCATION

STATE OF NEVADA

EUREKA

COUNTY

Mineral Hill

MINING DISTRICT

This diagram explains method of description of claim.

NOTICE IS HEREBY GIVEN, That the undersigned, having complied with the requirements of Chapter Six, Title thirty-two of the Revised Statutes of the United States, and the laws of the above State, and the local customs and regulations of said district,

in ^s located and do hereby locate 1500 linear feet in length,
 and 600 feet in width on the PETE 284

lode, vein, ledge or deposit (or placer ground), situated in above State, County or Mining District, and further described as follows: Commencing at a post marked SW corner located about 300' South from the monument of location thence

700 feet in a Easterly
 direction to a post marked south side center, thence 700 feet in a Easterly
 direction to a corner post marked SE cor., thence 600 feet in a Northerly
 direction to a corner post marked NE Cor., thence 700 feet in a Westerly
 direction to a post marked Northside center, thence 700 feet in a Westerly
 direction to a corner post marked NW Cor., thence 600 feet in a Southerly

direction to the SW corner hereby locating and intending to claim 1350
 feet in a Easterly direction from Monument of location to the East
 end line, and 50 feet in the opposite direction from discovery to the
 West end line, and 300 feet on each side of the middle of

said lode or ledge for the purpose of mining the same and claiming all surface rights, privileges and minerals, with all dips, upurs, angles and variations, and other rights granted by existing laws and customs. This claim is further described as follows: The Monument of Location of this claim is approximately 3200 ft.

southerly and 800 ft. westerly of the NE. corner of Section 36
 Township 28 N., Range 52 E. Nevada Meridian, Eureka County, Nevada.

The adjoining claims are Pete 283 on the north; Pete 285 on the south;
 Pete 272 on the west; O-Five #13 on the east.

The location work consisted of making & preparing maps as required in Nevada Revised Statutes 517:040. A notice of location is placed at Location Monument; Posts are placed at each corner at the center of each side line and the name of this lode and date of location, are placed on all posts.

Located this 1st day of APRIL 19 89

WITNESSES:

Peter W. Laczay

Peter W. Laczay
 P. O. Box 488
 Coeur d' Alene, Idaho 83814 Locators

OFFICIAL RECORDS
 EUREKA COUNTY, NEVADA
 MIN. REBALANCE REGISTER
 FILE NO. 127380

RECORDED AT THE REQUEST OF
 BOOK P7 PAGE 309
 89 JUN 12 AM 12A
Blaine Nelson Miner, One

No. side center

Recorded
 State of _____
 County of _____
 RECORDED
 Vol. _____ of _____
 Page _____ Request of _____
 19 _____
 County Auditor
 Deputy
 Mail to _____
 Fee _____

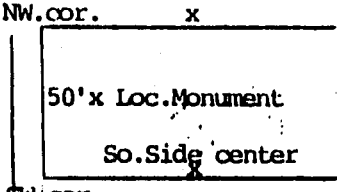

CERTIFICATE OF LOCATION

STATE OF NEVADA

EUREKA

COUNTY

Mineral Hill

MINING DISTRICT

This diagram explains method of description of claim.

NOTICE IS HEREBY GIVEN, That the undersigned, having complied with the requirements of Chapter Six, Title thirty-two of the Revised Statutes of the United States, and the laws of the above State, and the local customs and regulations of said district,

has located and do hereby locate 1500 linear feet in length, and 600 feet in width on the PETE 285

lode, vein, ledge or deposit (or placer ground), situated in above State, County or Mining District, and further described as follows: Commencing at a post marked SW corner located about 300' South from the monument of location thence 700 feet in a S 85° East direction to a post marked south side center, thence 700 feet in a S 85° East direction to a corner post marked SE cor., thence 600 feet in a Northerly direction to a corner post marked NE Cor., thence 700 feet in a N 85° West direction to a post marked Northside center, thence 700 feet in a N. 85° West direction to a corner post marked NW Cor., thence 600 feet in a Southerly direction to the SW corner hereby locating and intending to claim 1350 feet in a Easterly direction from Monument of location to the East end line, and 50 feet in the opposite direction from discovery to the West end line, and 300 feet on each side of the middle of said lode or ledge for the purpose of mining the same and claiming all surface rights, privileges and minerals, with all dips, spurs, angles and variations, and other rights granted by existing laws and customs. This claim is further described as follows:

The Monument of Location of this claim is approximately 3800 ft. southerly and 600 ft. westerly of the NE. corner of Section 36 Township 28 N, Range 52 E. Nevada Meridian, Eureka County, Nevada.
 The adjoining claims are Pete 284 on the north; Pete 289, 288, 290 on the south; Pete 274 on the west; Pete 298 on the east.

The location work consisted of making & preparing maps as required in Nevada Revised Statutes 517:040. A notice of location is placed at Location Monument; Posts are placed at each corner at the center of each side line and the name of this lode and date of location, are placed on all posts.

Located this 1st day of April, 1989

WITNESSES:

Peter W. Laczay

Peter W. Laczay
P. O. Box 488
Coeur d' Alene, Idaho 83814 Locators

RECORDED AT THE REQUEST OF
 BOOK 197 PAGE 310
 JUNE 12 AM 12:24
 DEPT. OF MINES & GEOL. ENG.
 EUREKA COUNTY, NEVADA
 MIN. RECORDS & RECORDS
 FILE NO. 625
 127381

127382

Compared State of _____ Filed _____ County of _____
 RECORDED # _____
 Vol. _____ of _____
 Page _____ Request of _____
 _____ 19 _____
 _____ County Auditor
 _____ Deputy
 Mail to _____

 Fee _____

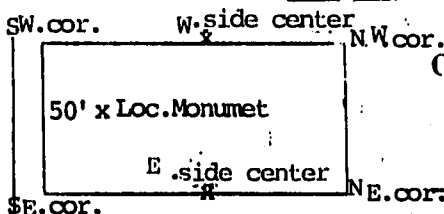

CERTIFICATE OF LOCATION

STATE OF NEVADA

EUREKA

COUNTY

Mineral Hill

MINING DISTRICT

This diagram explains method of description of claim.

NOTICE IS HEREBY GIVEN, That the undersigned, having complied with the requirements of Chapter Six, Title thirty-two of the Revised Statutes of the United States, and the laws of the above State, and the local customs and regulations of said district,

has located and do hereby locate 1500 linear feet in length,
 and 600 feet in width on the PETE 286

lode, vein, ledge or deposit (or placer ground), situated in above State, County or Mining District, and further described as follows: Commencing at a post marked SE corner located about 300' east from the monument of location, thence 750 feet in a Northerly direction to a Eastside center post marked, thence 750 feet in a Northerly direction to a corner post marked NE corner, thence 600 feet in a Westerly direction to a corner post marked NW corner, thence 750 feet in a Southerly direction to a post marked Westside Center, thence 750 feet in a Southerly direction to a corner post marked SW corner, thence 600 feet in a Easterly direction to the SE corner hereby locating and intending to claim 1450 feet in a northerly direction from monument of location to the north end line, and 50 feet in the opposite direction from discovery to the south end line, and 300 feet on each side of the middle of

said lode or ledge, for the purpose of mining the same and claiming all surface rights, privileges and minerals, with all dips, spurs, angles and variations, and other rights granted by existing laws and customs. This claim is further described as follows:

The Monument of Location of this claim is approximately 1100 ft. southerly and 2000 ft. easterly of the NW corner of Section 6,

Township 27 N, Range 53 E, Nevada Meridian, Eureka County, Nevada.

The adjoining claims are O-Five #8 on the north; Pete 200 on the south;

Pete 287 & 296 on the west; PN #34 on the east.

The location work consisted of making & preparing maps as required in Nevada Revised Statutes 517:040. A notice of location is placed at Location Monument; Posts are placed at each corner at the center of each side line and the name of this lode and date of location, are placed on all posts.

Located this 17th day of APRIL, 1989.

WITNESSES:

Peter W. Laczay

Peter W. Laczay
 P. O. Box 488
 Coeur d'Alene, Id. 83814 Locators

127382

OFFICIAL RECORDS
 EUREKA COUNTY, NEVADA
 MIN. REBAL. FILE RECORDER
 FILE NO. _____
 SEE PAGE 25

RECORDED AT THE REQUEST OF
 BOOK 197 PAGE 311
 Please Refer to Memo
 '89 JUN 12 AM 124

Compared..... Filed.....
 State of..... County of.....
 RECORDED as
 Vol. of
 Page..... Request of
 19.....
 County Auditor
 Deputy
 Mail to.....
 Fee

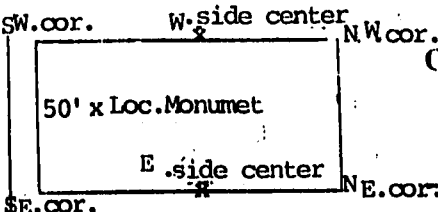

CERTIFICATE OF LOCATION

STATE OF NEVADA

EUREKA

COUNTY

Mineral Hill

MINING DISTRICT

This diagram explains method of description of claim.

NOTICE IS HEREBY GIVEN, That the undersigned, having complied with the requirements of Chapter Six, Title thirty-two of the Revised Statutes of the United States, and the laws of the above State, and the local customs and regulations of said district,

has located and do hereby locate 1500 linear feet in length, and 600 feet in width on the PETE 287

lode, vein, ledge or deposit (or placer ground), situated in above State, County or Mining District, and further described as follows: Commencing at a post marked SE corner located about 300' east from the monument of location, thence 750 feet in a Northerly direction to a Eastside center post marked, thence 750 feet in a Northerly direction to a corner post marked NE corner, thence 600 feet in a Westerly direction to a corner post marked NW corner, thence 750 feet in a Southerly direction to a post marked Westside Center, thence 750 feet in a Southerly direction to a corner post marked SW corner, thence 600 feet in a Easterly direction to the SE corner hereby locating and intending to claim 1450 feet in a northerly direction from monument of location to the north end line, and 50 feet in the opposite direction from discovery to the south end line, and 300 feet on each side of the middle of said lode or ledge, for the purpose of mining the same and claiming all surface rights, privileges and minerals, with all dips, spurs, angles and variations, and other rights granted by existing laws and customs. This claim is further described as follows: The Monument of Location of this claim is approximately 500 ft. southerly and 1400 ft. easterly of the NW corner of Section 6, Township 27 N, Range 53 E. Nevada Meridian, Eureka County, Nevada.

The adjoining claims are Pete 298 on the north; Pete 296 on the south; Pete 288 on the west; O-Five #8 on the east.

The location work consisted of making & preparing maps as required in Nevada Revised Statutes 517:040. A notice of location is placed at Location Monument; Posts are placed at each corner at the center of each side line and the name of this lode and date of location, are placed on all posts.

Located this 31st day of March, 1989

WITNESSES:

Peter W. Laczay

Peter W. Laczay,
 P. O. Box 488
 Coeur d'Alene, Id. 83814 Locators

127383

OFFICIAL RECORDS
 EUREKA COUNTY, NEVADA
 M. N. REBER, COUNTY CLERK
 FILE NO. 621

RECORDED AT THE REQUEST OF
 BOOK 197 PAGE 312
 89 JUN 12 AM 12:24
Idene Helen M. Lane, Sec

127384

Compared State of _____ Dated County of _____
RECORDED as _____
Vol. _____ of _____
Page _____ Request of _____
_____ 19 _____
County Auditor _____ Deputy _____
Mail to _____
Fee _____

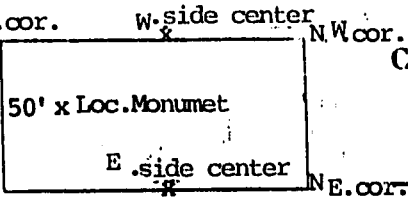

CERTIFICATE OF LOCATION

STATE OF NEVADA

EUREKA

COUNTY

Mineral Hill

MINING DISTRICT

This diagram explains method of description of claim.

NOTICE IS HEREBY GIVEN, That the undersigned, having complied with the requirements of Chapter Six, Title thirty-two of the Revised Statutes of the United States, and the laws of the above State, and the local customs and regulations of said district,

has located and do hereby locate 1500 linear feet in length, and 600 feet in width on the PETE 288

lode, vein, ledge or deposit (or placer ground), situated in above State, County or Mining District, and further described as follows: Commencing at a post marked SE corner located about 300' east from the monument of location, thence 750 feet in a Northerly direction to a Eastside center post marked, thence 750 feet in a Northerly direction to a corner post marked NE corner, thence 600 feet in a Westerly direction to a corner post marked NW corner, thence 750 feet in a Southerly direction to a post marked Westside Center, thence 750 feet in a Southerly direction to a corner post marked SW corner, thence 600 feet in a Easterly direction to the SE corner hereby locating and intending to claim 1450 feet in a northerly direction from monument of location to the north end line, and 50 feet in the opposite direction from discovery to the south end line, and 300 feet on each side of the middle of said lode or ledge, for the purpose of mining the same and claiming all surface rights, privileges and minerals, with all dips, spurs, angles and variations, and other rights granted by existing laws and customs. This claim is further described as follows:

The Monument of Location of this claim is approximately 500 ft. southerly and 800 ft. easterly of the NW corner of Section 6, Township 27 N, Range 53 E. Nevada Meridian, Eureka County, Nevada. The adjoining claims are Pete 285, 298 on the north; Pete 296 on the south; Pete 289 on the west; Pete 287 on the east.

The location work consisted of making & preparing maps as required in Nevada Revised Statutes 517:040. A notice of location is placed at Location Monument; Posts are placed at each corner at the center of each side line and the name of this lode and date of location, are placed on all posts.

Located this 31st day of March 19 89

WITNESSES:

Peter W. Laczay

Peter W. Laczay
P. O. Box 488
Coeur d' Alene, Id. 83814 Locators

OFFICIAL RECORDS
EUREKA COUNTY, NEVADA
M.N. REBUILT BY RECORDER
FILE NO. 127384
FEB 5 1989

RECORDED AT THE REQUEST OF
BOOK 197 PAGE 5/3
Jana Wilson
89 JUN 12 AM 24

Compared..... Filed.....
 State of..... County of.....
 RECORDED
 Vol..... of.....
 Page..... Request of.....
 19.....
 County Auditor
 Deputy
 Mail to.....
 Fee.....

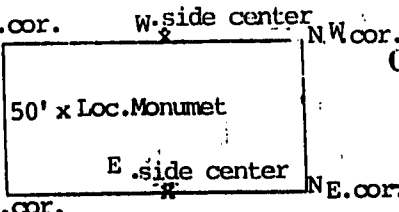

CERTIFICATE OF LOCATION

STATE OF NEVADA
 EUREKA COUNTY
 Mineral Hill MINING DISTRICT

This diagram explains method of description of claim.

NOTICE IS HEREBY GIVEN, That the undersigned, having complied with the requirements of Chapter Six, Title thirty-two of the Revised Statutes of the United States, and the laws of the above State, and the local customs and regulations of said district,

has located and do hereby locate 1500 linear feet in length,
 and 600 feet in width on the PETE 289

lode, vein, ledge or deposit (or placer ground), situated in above State, County or Mining District, and further described as follows: Commencing at a post marked SE corner located about 300' east from the monument of location, thence 750 feet in Northerly direction to a Eastside center post marked, thence 750 feet in Northerly direction to a corner post marked NE corner, thence 600 feet in Westerly direction to a corner post marked NW corner, thence 750 feet in Southerly direction to a post marked Westside Center, thence 750 feet in Southerly direction to a corner post marked SW corner, thence 600 feet in Easterly direction to the SE corner hereby locating and intending to claim 1450 feet in a northerly direction from monument of location to the north end line, and 50 feet in the opposite direction from discovery to the south 300 feet on each side of the middle of

said lode or ledge, for the purpose of mining the same and claiming all surface rights, privileges and minerals, with all dips, spurs, angles and variations, and other rights granted by existing laws and customs. This claim is further described as follows: The Monument of Location of this claim is approximately 500 ft. southerly and 150 ft. easterly of the NE. corner of Section 6, Township 27 N, Range 53 E. Nevada Meridian, Eureka County, Nevada. The adjoining claims are Pete 285 on the north; Pete 297, 296 on the south; Pete 290 on the west; Pete 288 on the east.

The location work consisted of making & preparing maps as required in Nevada Revised Statutes 517:040. A notice of location is placed at Location Monument; Posts are placed at each corner at the center of each side line and the name of this lode and date of location, are placed on all posts.

Located this 31st day of MARCH 19 89

WITNESSES:

 Peter W. Laczay
 P. O. Box 488
 Coeur d' Alene, Id. 83814 Locators

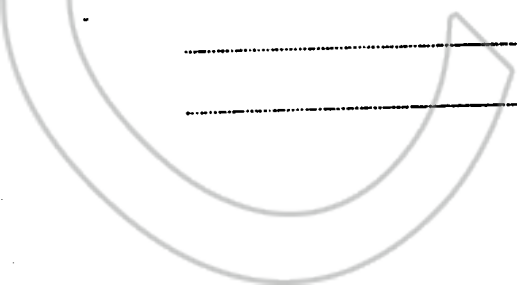

RECORDED AT THE REQUEST OF
 BOOK 197 PAGE 314
 Also Alene Miner,
 89 JUN 12 AM 24
 OFFICIAL RECORDS
 EUREKA COUNTY, NEVADA
 H.M. REBECCAH, RECORDER
 FILE NO. 127385
 PET 289

Compared State of _____ Filed County of _____
 RECORDED # _____
 Vol. _____ of _____
 Page _____ Request of _____
 _____ 19 _____
 County Auditor _____ Deputy _____
 Mail to _____
 Fee _____

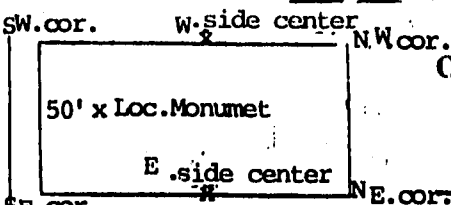

CERTIFICATE OF LOCATION

STATE OF NEVADA

EUREKA

COUNTY

Mineral Hill

MINING DISTRICT

This diagram explains method of description of claim.

NOTICE IS HEREBY GIVEN, That the undersigned, having complied with the requirements of Chapter Six, Title thirty-two of the Revised Statutes of the United States, and the laws of the above State, and the local customs and regulations of said district,

has located and do hereby locate 1500 linear feet in length, and 600 feet in width on the PETE 290

lode, vein, ledge or deposit (or placer ground), situated in above State, County or Mining District, and further described as follows: Commencing at a post marked SE corner located about 300' east from the monument of location, thence 750 feet in a North erly direction to a Eastside center post marked, thence 750 feet in a Northerly direction to a corner post marked NE corner, thence 600 feet in a Westerly direction to a corner post marked NW corner, thence 750 feet in a Southerly direction to a post marked Westside Center, thence 750 feet in a Southerly direction to a corner post marked SW corner, thence 600 feet in a Easterly direction to the SE corner hereby locating and intending to claim 1450 feet in a northerly direction from monument of location to the north end line, and 50 feet in the opposite direction from discovery to the south end line, and 300 feet on each side of the middle of said lode or ledge, for the purpose of mining the same and claiming all surface rights, privileges and minerals, with all dips, spurs, angles and variations, and other rights granted by existing laws and customs. This claim is further described as follows:

The Monument of Location of this claim is approximately 500 ft. southerly and 400 ft. westerly of the NE corner of Section 1, Township 27 N, Range 52 E. Nevada Meridian, Eureka County, Nevada.

The adjoining claims are Pete 285 on the north; Pete 297 on the south; Pete 291 on the west; Pete 289 on the east.

The location work consisted of making & preparing maps as required in Nevada Revised Statutes 517:040. A notice of location is placed at Location Monument; Posts are placed at each corner at the center of each side line and the name of this lode and date of location, are placed on all posts.

Located this 31st day of MARCH 1989

WITNESSES:

Peter W. Laczay

Peter W. Laczay,
 P. O. Box 488
 Coeur d' Alene, Id. 83814 Locators

127386

OFFICIAL RECORDS
 EUREKA COUNTY, NEVADA
 M. H. REBALLEA, RECORDER
 FILE NO. 225

RECORDED AT THE REQUEST OF
 BOOK 197 PAGE 315
 J. Dora Silver Mine Inc.
 89 JUN 12 AM 12:24

Compared..... Page.....
 State of..... County of.....
 RECORDED ..
 Vol. of ..
 Page..... Request of ..
 19.....
 County Auditor ..
 Deputy ..
 Mail to.....
 Fee ..

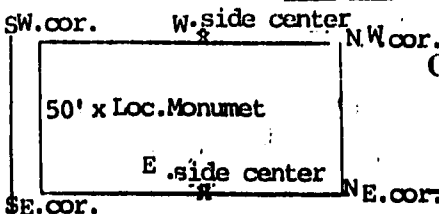

CERTIFICATE OF LOCATION

STATE OF NEVADA

EUREKA

COUNTY

Mineral Hill

MINING DISTRICT

This diagram explains method of description of claim.

NOTICE IS HEREBY GIVEN, That the undersigned, having complied with the requirements of Chapter Six, Title thirty-two of the Revised Statutes of the United States, and the laws of the above State, and the local customs and regulations of said district,

has located and do hereby locate 1500 linear feet in length, and 600 feet in width on the PETE 291

lode, vein, ledge or deposit (or placer ground), situated in above State, County or Mining District, and further described as follows: Commencing at a post marked SE corner located about 300' east from the monument of location, thence 750 feet in North erly direction to a Eastside center post marked, thence 750 feet in Northerly direction to a corner post marked NE corner, thence 600 feet in S 85° West. direction to a corner post marked NW corner, thence 750 feet in Southerly direction to a post marked Westside Center, thence 750 feet in Southerly direction to a corner post marked SW corner, thence 600 feet in N 85° East direction to the SE. corner hereby locating and intending to claim 1450 feet in a northerly direction from monument of location to the north end line, and 50 feet in the opposite direction from discovery to the south end line, and 300 feet on each side of the middle of said lode or ledge, for the purpose of mining the same and claiming all surface rights, privileges and minerals, with all dips, spurs, angles and variations, and other rights granted by existing laws and customs. This claim is further described as follows: The Monument of Location of this claim is approximately 500 ft. southerly and 1000 ft. westerly of the NE. corner of Section 1, Township 27 N, Range 52 E. Nevada Meridian, Eureka County, Nevada.

The adjoining claims are Pete 274 on the north; Pete 297 on the south; Pete 292 on the west; Pete 290 on the east.

The location work consisted of making & preparing maps as required in Nevada Revised Statutes 517:040. A notice of location is placed at Location Monument; Posts are placed at each corner at the center of each side line and the name of this lode and date of location, are placed on all posts.

Located this 31st day of MARCH 18 89

WITNESSES:

Peter W. Laczay

Peter W. Laczay, P. O. Box 488, Coeur d' Alene, Id. 83814 Locators

127387

OFFICIAL RECORDS EUREKA COUNTY NEVADA M. M. PLEASANT, REGISTERER FILE NO. 625

RECORDED AT THE REQUEST OF BOOK 197 PAGE 316 89 JUN 12 AM 24

Oliver Nelson Moore, Inc.

Compared State of ... Filed County of ... RECORDED ... Vol. of ... Page ... Request of ... 19 ... County Auditor ... Deputy ... Mail to ... Fee ...

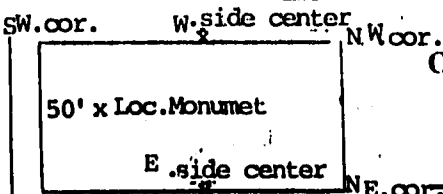

CERTIFICATE OF LOCATION

STATE OF NEVADA

EUREKA

COUNTY

Mineral Hill

MINING DISTRICT

This diagram explains method of description of claim.

NOTICE IS HEREBY GIVEN, That the undersigned, having complied with the requirements of Chapter Six, Title thirty-two of the Revised Statutes of the United States, and the laws of the above State, and the local customs and regulations of said district,

has located and do hereby locate 1500 linear feet in length, and 600 feet in width on the PETE 292

lode, vein, ledge or deposit (or placer ground), situated in above State, County or Mining District, and further described as follows: Commencing at a post marked SE corner located about 300' east from the monument of location, thence 750 feet in North erly direction to a Eastside center post marked, thence 750 feet in Northerly direction to a corner post marked NE corner, thence 600 feet in S 85° West direction to a corner post marked NW corner, thence 750 feet in Southerly direction to a post marked Westside Center, thence 750 feet in Southerly direction to a corner post marked SW corner, thence 600 feet in N 85° East direction to the SE corner hereby locating and intending to claim 1450 feet in a northerly direction from monument of location to the north end line, and 50 feet in the opposite direction from discovery to the south end line, and 300 feet on each side of the middle of said lode or ledge, for the purpose of mining the same and claiming all surface rights, privileges and minerals, with all dips, spurs, angles and variations, and other rights granted by existing laws and customs. This claim is further described as follows: The Monument of Location of this claim is approximately 500 ft. southerly and 1600 ft. westerly of the NE. corner of Section 1, Township 27 N, Range 52 E. Nevada Meridian, Eureka County, Nevada.

The adjoining claims are Pete 274 on the north; Pete 206 on the south; Pete 293 on the west; Pete 291 on the east.

The location work consisted of making & preparing maps as required in Nevada Revised Statutes 517:040. A notice of location is placed at Location Monument; Posts are placed at each corner at the center of each side line and the name of this lode and date of location, are placed on all posts.

Located this 31st day of MARCH 19 89

WITNESSES:

Peter W. Laczay

Peter W. Laczay, P. O. Box 488 Coeur d' Alene, Id. 83814 Locators

127388

OFFICIAL RECORDS EUREKA COUNTY NEVADA M.M. RECORDED & INDEXED FILE NO. 425

RECORDED AT THE REQUEST OF BOB 197 PAGE 317 Alana Allen Munoz, Inc 789 JUN 12 AM 25

127389

Compared... Filed...
 State of... County of...
 RECORDED
 Vol. ... of ...
 Page ... of ... Request of ...
 19...
 County Auditor
 Deputy
 Mail to...
 Fee ...

SW.cor. W.side center NW.cor.
CERTIFICATE OF LOCATION
 STATE OF NEVADA
 EUREKA COUNTY

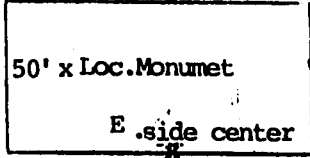

This diagram explains method of description of claim. Mineral Hill MINING DISTRICT

NOTICE IS HEREBY GIVEN, That the undersigned, having complied with the requirements of Chapter Six, Title thirty-two of the Revised Statutes of the United States, and the laws of the above State, and the local customs and regulations of said district,

has located and do hereby locate 1500 linear feet in length, and 600 feet in width on the PETE 293.

lode, vein, ledge or deposit (or placer ground), situated in above State, County or Mining District, and further described as follows: Commencing at a post marked SE corner located about 300' east from the monument of location, thence 750 feet in a North erly direction to a Eastside center post marked, thence 750 feet in a Northerly direction to a corner post marked NE corner, thence 600 feet in a S 85° West direction to a corner post marked NW corner, thence 750 feet in a Southerly direction to a post marked Westside Center, thence 750 feet in a Southerly direction to a corner post marked SW corner, thence 600 feet in a N 85° East direction to the SE corner hereby locating and intending to claim 1450 feet in a northerly direction from monument of location to the north end line, and 50 feet in the opposite direction from discovery to the south end line, and 300 feet on each side of the middle of said lode or ledge, for the purpose of mining the same and claiming all surface rights, privileges and minerals, with all dips, spurs, angles and variations, and other rights granted by existing laws and customs. This claim is further described as follows:

The Monument of Location of this claim is approximatley 600 ft. southerly and 1200 ft. westerly of the NE. corner of Section 1, Township 27 N, Range 52 E. Nevada Meridian, Eureka County, Nevada. The adjoining claims are Pete 273 on the north; Pete 207 on the south; Pete 294 on the west; Pete 292 on the east.

The location work consisted of making & preparing maps as required in Nevada Revised Statutes 517:040. A notice of location is placed at Location Monument; Posts are placed at each corner at the center of each side line and the name of this lode and date of location, are placed on all posts.

Located this 31st day of MARCH 19 89
 WITNESSES:
 Peter W. Laczay,
 P. O. Box 488
 Coeur d' Alene, Id. 83814 Locators

OFFICIAL RECORDS
 EUREKA COUNTY, NEVADA
 M. N. HERRINGTON, RECORDER
 FILE NO. 127389
 'EE 5/25
 RECORDED AT THE REQUEST OF
 BOOK 197 PAGE 318
 Adora Helen Mayo, Inc.
 89 JUN 12 AM 12:25

Compared..... Filed.....
 State of..... County of.....
 RECORDED
 Vol. of
 Page..... Request of
 19.....
 County Auditor
 Deputy
 Mail to.....
 Fee

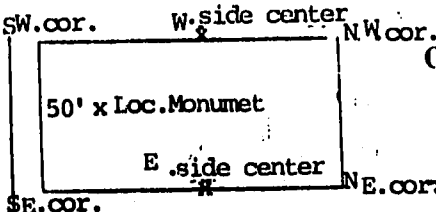

CERTIFICATE OF LOCATION

STATE OF NEVADA
 EUREKA COUNTY

This diagram explains method of description of claim.

Mineral Hill MINING DISTRICT

NOTICE IS HEREBY GIVEN, That the undersigned, having complied with the requirements of Chapter Six, Title thirty-two of the Revised Statutes of the United States, and the laws of the above State, and the local customs and regulations of said district,

has located and do hereby locate 1500 linear feet in length, and 600 feet in width on the PETE 294.

lode, vein, ledge or deposit (or placer ground), situated in above State, County or Mining District, and further described as follows: Commencing at a post marked SE corner located about 300' east from the monument of location, thence 750 feet in a Northerly direction to a Eastside center post marked, thence 750 feet in a Northerly direction to a corner post marked NE corner, thence 600 feet in a S 85° West direction to a corner post marked NW corner, thence 750 feet in a Southerly direction to a post marked Westside Center, thence 750 feet in a Southerly direction to a corner post marked SW corner, thence 600 feet in a N 85° East direction to the SE corner hereby locating and intending to claim 1450 feet in a northerly direction from monument of location to the north end line, and 50 feet in the opposite direction from discovery to the south end line, and 300 feet on each side of the middle of said lode or ledge, for the purpose of mining the same and claiming all surface rights, privileges and minerals, with all dips, spurs, angles and variations, and other rights granted by existing laws and customs. This claim is further described as follows:

The Monument of Location of this claim is approximately 700 ft. southerly and 1800 ft. westerly of the NE. corner of Section 1, Township 27 N, Range 52 E. Nevada Meridian, Eureka County, Nevada.
 The adjoining claims are Pete 273 on the north; Pete 208 on the south; Pete 295 on the west; Pete 293 on the east.

The location work consisted of making & preparing maps as required in Nevada Revised Statutes 517:040. A notice of location is placed at Location Monument; Posts are placed at each corner at the center of each side line and the name of this lode and date of location, are placed on all posts.

Located this 31st day of MARCH 1909

WITNESSES:

Peter W. Laczay

Peter W. Laczay
 P. O. Box 488
 Coeur d' Alene, Id. 83814 Locature

127390

OFFICIAL RECORDS
 EUREKA COUNTY NEVADA
 M. N. BEAL, CLERK
 FILE NO. 25

RECORDED AT THE REQUEST OF
 BOOK 197 PAGE 319
 J. J. Wilson
 JUN 12 AM 11:25 '09

Compared..... Filed.....
 State of..... County of.....
 RECORDED as
 Vol..... of.....
 Page..... Request of
 19.....
 County Auditor
 Deputy
 Mail to.....
 Fee

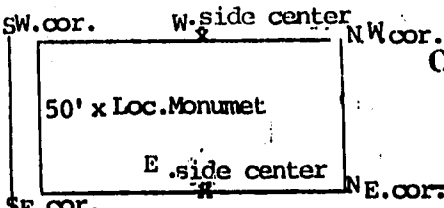

CERTIFICATE OF LOCATION

STATE OF NEVADA

EUREKA

COUNTY

Mineral Hill

MINING DISTRICT

This diagram explains method of description of claim.

NOTICE IS HEREBY GIVEN, That the undersigned, having complied with the requirements of Chapter Six, Title thirty-two of the Revised Statutes of the United States, and the laws of the above State, and the local customs and regulations of said district,

has located and do hereby locate 1500 linear feet in length, and 600 feet in width on the PETE 295

lode, vein, ledge or deposit (or placer ground), situated in above State, County or Mining District, and further described as follows: Commencing at a post marked SE corner located about 300' east from the monument of location, thence 750 feet in a North erly direction to a Eastside center post marked, thence 750 feet in a Northerly direction to a corner post marked NE corner, thence 600 feet in a S 85° West direction to a corner post marked NW corner, thence 750 feet in a Southerly direction to a post marked Westside Center, thence 750 feet in a Southerly direction to a corner post marked SW corner, thence 600 feet in a N 85° East direction to the SE corner hereby locating and intending to claim 1450 feet in a northerly direction from monument of location to the north end line, and 50 feet in the opposite direction from discovery to the south end line, and 300 feet on each side of the middle of said lode or ledge, for the purpose of mining the same and claiming all surface rights, privileges and minerals, with all dips, spurs, angles and variations, and other rights granted by existing laws and customs. This claim is further described as follows: The Monument of Location of this claim is approximatley 700 ft. southerly and 3400 ft. westerly of the NE. corner of Section 1 Township 27 N, Range 52 E. Nevada Meridian, County, Nevada.

The adjoining claims are Pete 252, 273 on the north; Pete 209 on the south; Pete 306 on the west; Pete 294 on the east.

The location work consisted of making & preparing maps as required in Nevada Revised Statutes 517:040. A notice of location is placed at Location Monument; Posts are placed at each corner at the center of each side line and the name of this lode and date of location, are placed on all posts.

Located this 31st day of MARCH 19 89

WITNESSES:

Peter W. Laczay
 Peter W. Laczay
 P. O. Box 488
 Coeur d' Alene, Id. 83814 Locators

127391

OFFICIAL RECORDS
 EUREKA COUNTY, NEVADA
 M. N. REBELETTA, RECORDER
 FILE NO. 6-25

RECORDED AT THE REQUEST OF
 BOOK 197 PAGE 320
 89 JUN 12 AM 12:25
 Dana Helen Munro, Inc.

Computed State of _____ Filed _____
 County of _____ NW. cor. Side center cor. NE. cor.
 RECORDED as _____
 Vol. _____ of _____
 Page _____ Request of _____
 19 _____
 County Auditor _____
 Deputy _____
 Mail to _____
 Fee _____

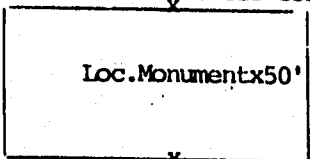

CERTIFICATE OF LOCATION

STATE OF NEVADA

EUREKA

COUNTY

SW. cor. Side center cor. SE. cor.

Mineral Hill

MINING DISTRICT

This diagram explains method of description of claim.

NOTICE IS HEREBY GIVEN, That the undersigned, having complied with the requirements of Chapter Six, Title thirty-two of the Revised Statutes of the United States, and the laws of the above State, and the local customs and regulations of said district,

has located and do hereby locate 1500 linear feet in length, and 600 feet in width on the PETE 297

lode, vein, ledge or deposit (or placer ground), situated in above State, County or Mining District, and further described as follows: Commencing at a post marked SE corner located about 300' southerly from the monument of Location, thence

750 feet in a Westerly

direction to a Southside center post marked, thence 750 feet in a Westerly

direction to a corner post marked SW corner, thence 600 feet in a Northerly

direction to a corner post marked NW corner, thence 750 feet in a Easterly

direction to a post marked Northside center, thence 750 feet in a Easterly

direction to a corner post marked NE corner, thence 300 feet in a Southerly

direction to the SE. corner hereby locating and intending to claim 1,450

feet in a Westerly direction from monument of location to the West

end line, and 50 feet in the opposite direction from discovery to the

East end line, and 300 feet on each side of the middle of

said lode or ledge, for the purpose of mining the same and claiming all surface rights, privileges and minerals, with all dips, spurs, angles and variations, and other rights granted by existing laws and customs. This claim is further described as follows:

The Monument of Location of this claim is approximately 900 ft.

southerly and 100 ft. Easterly of the NW corner of Section 6,

Township 27 N, Range 53 E, Nevada Meridian, Eureka County, Nevada.

The adjoining claims are Pete 291, 290, 289 on the north; Pete 205, 204, 203 on the south;

Pete 292 on the west; Pete 296 on the east.

The location work consisted of making & preparing maps as required in Nevada Revised Statutes 517:040. A notice of location is placed at Location Monument; Posts are placed at each corner at the center of each side line and the name of this lode and date of location, are placed on all posts.

Located this 17th day of April, 19 89

WITNESSES:

Peter W. Laczay
 P. O. Box 488
 Coeur d' Alene, Id. 83814 Locators

RECORDED AT THE REQUEST OF
 BOOK 197 PAGE 321
 89 JUN 12 AM 12:25
 Adena Ellen Miner, Inc
 OFFICIAL RECORDS
 EUREKA COUNTY, NEVADA
 MINERAL RIGHTS RECORDER
 FILE NO. 127392
 JUN 25 1989

Compared... Filed...
 State of _____ County of _____
 RECORDED as
 Vol. _____ of _____
 Page _____ Request of _____
 19 _____
 County Auditor _____
 Deputy _____
 Mail to _____
 Fee _____

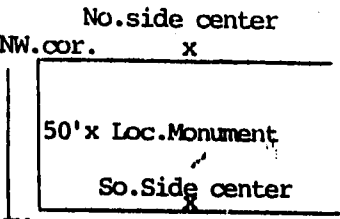

NE. cor. **CERTIFICATE OF LOCATION**

STATE OF NEVADA
 EUREKA COUNTY
 Mineral Hill MINING DISTRICT

This diagram explains method of description of claim.

NOTICE IS HEREBY GIVEN, That the undersigned, having complied with the requirements of Chapter Six, Title thirty-two of the Revised Statutes of the United States, and the laws of the above State, and the local customs and regulations of said district,

in ^s located and do hereby locate 1500 linear feet in length,
 and 600 feet in width on the PETE 298

lode, vein, ledge or deposit (or placer ground), situated in above State, County or Mining District, and further described as follows: Commencing at a post marked SW corner located about 300' South from the monument of location thence 650 feet in a Easterly direction to a post marked south side center, thence 650 feet in a Easterly direction to a corner post marked SE cor., thence 600 feet in a Northerly direction to a corner post marked NE Cor., thence 650 feet in a Westerly direction to a post marked Northside center, thence 650 feet in a Westerly direction to a corner post marked NW Cor., thence 600 feet in a Southerly direction to the SW corner hereby locating and intending to claim 1300 feet in a Easterly direction from Monument of location to the East end line, and 50 feet in the opposite direction from discovery to the West end line, and 300 feet on each side of the middle of said lode or ledge for the purpose of mining the same and claiming all surface rights, privileges and minerals, with all dips, apura, angles and variations, and other rights granted by existing laws and customs. This claim is further described as follows:

The Monument of Location of this claim is approximately 3850 ft. southerly and 600 ft. easterly of the NW corner of Section 31 Township 28 N, Range 53 E. Nevada Meridian, Eureka County, Nevada.
 The adjoining claims are O-Five #14 on the north; Pete 288, 287 on the south; Pete 285 on the west; O-Five 8 on the east.

The location work consisted of making & preparing maps as required in Nevada Revised Statutes 517:040. A notice of location is placed at Location Monument; Posts are placed at each corner at the center of each side line and the name of this lode and date of location, are placed on all posts.

Located this 28th day of MAY 19 89

WITNESSES:

 Peter W. Laczay
 P. O. Box 488
 Coeur d' Alene, Idaho 83814 Locators

RECORDED AT THE REQUEST OF
 BOOK 197 PAGE 322
 Sherris Mining, Inc.
 JUN 12 AM 11:25 '89
 OFFICIAL RECORDS
 EUREKA COUNTY, NEVADA
 M. N. REBEAU, CLERK
 FILE NO. 127393
 FEE \$ 6.25

CERTIFICATE OF LOCATION

Compared State of _____ Page _____ of _____
 RECORDED as _____
 Vol. _____ of _____
 Page _____ of _____ Request of _____
 _____ 19_____
 _____ County Auditor _____ Deputy
 Mail to _____

 Fee _____

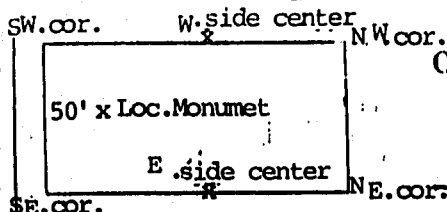

STATE OF NEVADA

EUREKA

COUNTY

Mineral Hill

MINING DISTRICT

This diagram explains method of description of claim.

NOTICE IS HEREBY GIVEN, That the undersigned, having complied with the requirements of Chapter Six, Title thirty-two of the Revised Statutes of the United States, and the laws of the above State, and the local customs and regulations of said district,

has located and do hereby locate 1500 linear feet in length, and 600 feet in width on the PETE 299

lode, vein, ledge or deposit (or placer ground), situated in above State, County or Mining District, and further described as follows: Commencing at a post marked SE corner located about 300' east from the monument of location, thence 750 feet in a Northerly direction to a Eastside center post marked, thence 750 feet in a Northerly direction to a corner post marked NE corner, thence 500 feet in a Westerly direction to a corner post marked NW corner, thence 750 feet in a Southerly direction to a post marked Westside Center, thence 750 feet in a Southerly direction to a corner post marked SW corner, thence 500 feet in a Easterly direction to the SE corner hereby locating and intending to claim 1450 feet in a northerly direction from monument of location to the north end line, and 50 feet in the opposite direction from discovery to the south end line, and 300 feet on each side of the middle of said lode or ledge, for the purpose of mining the same and claiming all surface rights, privileges and minerals, with all dips, spurs, angles and variations, and other rights granted by existing laws and customs. This claim is further described as follows: The Monument of Location of this claim is approximately 4000 ft. southerly and 100 ft. Easterly of the NW corner of Section 30, Township 28 N, Range 53 E. Nevada Meridian, Eureka County, Nevada.

The adjoining claims are _____ on the north; Five-O #21 on the south; Pete 276 on the west; Five-O #16 on the east.

The location work consisted of making & preparing maps as required in Nevada Revised Statutes 517:040. A notice of location is placed at Location Monument; Posts are placed at each corner at the center of each side line and the name of this lode and date of location, are placed on all posts.

Located this 2nd day of JUNE 19 89

WITNESSES:

Peter W. Laczay

Peter W. Laczay.
 P. O. Box 488
 Coeur d'Alene, Id. 83814 Locators

RECORDED AT THE REQUEST OF
 BOOK 197 PAGE 323
 JUNE 12 AM 12:25
 EUREKA COUNTY NEVADA
 M. N. RECORDS DEPARTMENT
 FILE NO. 127394
 FILED 6/25

Compared..... Filed.....
 State of..... County of.....
 RECORDED as
 Vol. of
 Page..... Request of
 19.....
 County Auditor
 Deputy
 Mail to.....
 Fee

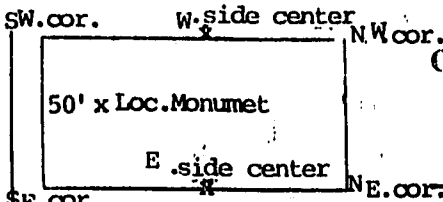

CERTIFICATE OF LOCATION

STATE OF NEVADA
EUREKA

COUNTY

Mineral Hill MINING DISTRICT

This diagram explains method of description of claim.

NOTICE IS HEREBY GIVEN, That the undersigned, having complied with the requirements of Chapter Six, Title thirty-two of the Revised Statutes of the United States, and the laws of the above State, and the local customs and regulations of said district,

has located and do hereby locate 1500 linear feet in length, and 600 feet in width on the PETE 306.

lode, vein, ledge or deposit (or placer ground), situated in above State, County or Mining District, and further described as follows: Commencing at a post marked SE corner located about 300' east from the monument of location, thence 750 feet in a North erly direction to a Eastside center post marked, thence 750 feet in a Northerly direction to a corner post marked NE corner, thence 600 feet in a S 85° West: direction to a corner post marked NW corner, thence 750 feet in a Southerly direction to a post marked Westside Center, thence 750 feet in a South erly direction to a corner post marked SW corner, thence 600 feet in a N 85° East: direction to the SE corner hereby locating and intending to claim 1450 feet in a northerly direction from monument of location to the north end line, and 50 feet in the opposite direction from discovery to the south end line, and 300 feet on each side of the middle of said lode or ledge, for the purpose of mining the same and claiming all surface rights, privileges and minerals, with all dips, spurs, angles and variations, and other rights granted by existing laws and customs. This claim is further described as follows: The Monument of Location of this claim is approximately 800 ft. southerly and 4000 ft. westerly of the NE. corner of Section 1, Township 27 N, Range 52 E. Nevada Meridian, Eureka County, Nevada.

The adjoining claims are Pete 252 on the north; Pete 227 on the south; Pete 308 on the west; Pete 295 on the east.

The location work consisted of making & preparing maps as required in Nevada Revised Statutes 517:040. A notice of location is placed at Location Monument; Posts are placed at each corner at the center of each side line and the name of this lode and date of location, are placed on all posts.

Located this 31st day of MARCH 1989

WITNESSES:

Peter W. Laczay
 Peter W. Laczay
 P. O. Box 488
 Coeur d' Alene, Id. 83814 Locators

127395

OFFICIAL RECORDS
 EUREKA COUNTY, NEVADA
 M.N. REBALANCE ORDER
 FILE NO. 625

RECORDED AT THE REQUEST OF
 BOOK 197 PAGE 324
 Alana Silven Mines, Inc.
 89 JUN 12 AM 12:25

127396

Compared..... Filed.....
 State of..... County of.....
 RECORDED as.....
 Vol..... of.....
 Page..... Request of.....
 19.....
 County Auditor.....
 Deputy.....
 Mail to.....
 Fee.....

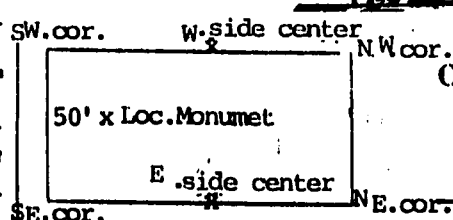

CERTIFICATE OF LOCATION

STATE OF NEVADA
EUREKA

COUNTY

Mineral Hill MINING DISTRICT

This diagram explains method of description of claim.

NOTICE IS HEREBY GIVEN, That the undersigned, having complied with the requirements of Chapter Six, Title thirty-two of the Revised Statutes of the United States, and the laws of the above State, and the local customs and regulations of said district,

has located and do hereby locate 1500 linear feet in length, and 600 feet in width on the PETE 308.

lode, vein, ledge or deposit (or placer ground), situated in above State, County or Mining District, and further described as follows: Commencing at a post marked SE corner located about 300' east from the monument of location, thence 750 feet in a North erly direction to a Eastside center post marked, thence 750 feet in a Northerly direction to a corner post marked NE corner, thence 600 feet in a S 85° West; direction to a corner post marked NW corner, thence 750 feet in a Southerly direction to a post marked Westside Center, thence 750 feet in a Southerly direction to a corner post marked SW corner, thence 600 feet in a N 85° East; direction to the SE corner hereby locating and intending to claim 1450 feet in a northerly direction from monument of location to the north end line, and 50 feet in the opposite direction from discovery to the south end line, and 300 feet on each side of the middle of said lode or ledge, for the purpose of mining the same and claiming all surface rights, privileges and minerals, with all dips, spurs, angles and variations, and other rights granted by existing laws and customs. This claim is further described as follows: The Monument of Location of this claim is approximately 800 ft. southerly and 4000 ft. westerly of the NE. corner of Section 1, Township 27 N, Range 52 E. Nevada Meridian, Eureka County, Nevada.

The adjoining claims are Pete 252 on the north; Pete 229 on the south; Pete 310 on the west; Pete 306 on the east.

The location work consisted of making & preparing maps as required in Nevada Revised Statutes 517:040. A notice of location is placed at Location Monument; Posts are placed at each corner at the center of each side line and the name of this lode and date of location, are placed on all posts.

Located this 31st day of MARCH 19 89

WITNESSES:

Peter W. Laczay
 Peter W. Laczay,
 P. O. Box 488
 Coeur d' Alene, Id. 83814 Locators

RECORDED AT THE REQUEST OF
 BOOK 197 PAGE 325
 Idora S. Luss Mines Inc -
 89 JUN 12 AM 12:25
 DEPT. OF RECORDS
 EUREKA COUNTY, NEVADA
 MIN. REBALANCE RECORDER
 FILE NO. 625
 127396

Compared..... Filed.....
 State of..... County of.....
 RECORDED as
 Vol..... of.....
 Page..... Request of.....
 19.....
 County Auditor
 Deputy
 Mail to.....
 Fee.....

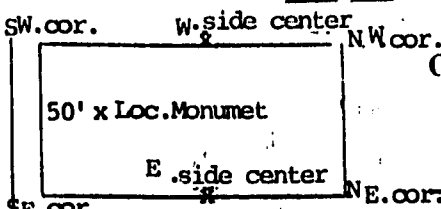

CERTIFICATE OF LOCATION

STATE OF NEVADA

EUREKA

COUNTY

Mineral Hill

MINING DISTRICT

This diagram explains method of description of claim.

NOTICE IS HEREBY GIVEN, That the undersigned, having complied with the requirements of Chapter Six, Title thirty-two of the Revised Statutes of the United States, and the laws of the above State, and the local customs and regulations of said district,

has located and do hereby locate 1500 linear feet in length, and 600 feet in width on the PETE 310.

lode, vein, ledge or deposit (or placer ground), situated in above State, County or Mining District, and further described as follows: Commencing at a post marked SE corner located about 300' east from the

- monument of location, thence 750 feet in a North erly direction to a Eastside center post marked, thence 750 feet in a Northerly direction to a corner post marked NE corner, thence 600 feet in a S 85° West direction to a corner post marked NW corner, thence 750 feet in a Southerly direction to a post marked Westside Center, thence 750 feet in a Southerly direction to a corner post marked SW corner, thence 600 feet in a N 85° East direction to the SE corner hereby locating and intending to claim 1450 feet in a northerly direction from monument of location to the north

end line, and 50 feet in the opposite direction from discovery to the south end line, and 300 feet on each side of the middle of said lode or ledge, for the purpose of mining the same and claiming all surface rights, privileges and minerals, with all dips, apura, angles and variations, and other rights granted by existing laws and customs. This claim is further described as follows: The Monument of Location of this claim is approximatley 900 ft. southerly and 5200 ft. westerly of the NE. corner of Section 1, Township 27 N, Range 52 E. Nevada Meridian, County, Nevada.

The adjoining claims are - on the north; Pete 231 on the south; Pete 312 on the west; Pete 308 on the east.

The location work consisted of making & preparing maps as required in Nevada Revised Statutes 517:040. A notice of location is placed at Location Monument; Posts are placed at each corner at the center of each side line and the name of this lode and date of location, are placed on all posts.

Located this 31st day of MARCH 1989

WITNESSES:

Peter W. Laczay

Peter W. Laczay
P. O. Box 488
Coeur d' Alene, Id. 83814 Locators

127397

OF STATE RECORDS
EUREKA COUNTY, NEVADA
M. M. BECKWITH, CLERK
FILE NO. 625

RECORDED AT THE REQUEST OF
BOOK 197 PAGE 326
Idora Silver Mines, Inc.
89 JUN 12 AM 25

Compared..... Filed.....
 State of..... County of.....
 RECORDED as.....
 Vol. of
 Page..... Request of.....
 19.....
 County Auditor.....
 Deputy.....
 Mail to.....
 Fee.....

SW.cor. W. side center NW.cor.
 50' x Loc.Monumet
 E. side center NE.cor.
 SE.cor. EUREKA COUNTY

CERTIFICATE OF LOCATION

STATE OF NEVADA

EUREKA

Mineral Hill

MINING DISTRICT

This diagram explains method of description of claim.

NOTICE IS HEREBY GIVEN, That the undersigned, having complied with the requirements of Chapter Six, Title thirty-two of the Revised Statutes of the United States, and the laws of the above State, and the local customs and regulations of said district,

has located and do hereby locate 1500 linear feet in length, and 600 feet in width on the PETE 312

lode, vein, ledge or deposit (or placer ground), situated in above State, County or Mining District, and further described as follows: Commencing at a post marked SE corner located about 300' east from the monument of location, thence 750 feet in North erly direction to a Eastside center post marked, thence 750 feet in Northerly direction to a corner post marked NE corner, thence 600 feet in S 85° West. direction to a corner post marked NW corner, thence 750 feet in Southerly direction to a post marked Westside Center, thence 750 feet in Southerly direction to a corner post marked SW corner, thence 600 feet in N 85° East. direction to the SE corner hereby locating and intending to claim. 1450 feet in a northerly direction from monument of location to the north end line, and 50 feet in the opposite direction from discovery to the south end line, and 300 feet in the opposite direction from discovery to the south end line, and 300 feet on each side of the middle of said lode or ledge, for the purpose of mining the same and claiming all surface rights, privileges and minerals, with all dips, apura, angles and variations, and other rights granted by existing laws and customs. This claim is further described as follows: The Monument of Location of this claim is approximatley 1000 ft. southerly and 600 ft. westerly of the NE. corner of Section 2 , Township 27 N, Range 52 E. Nevada Meridian, Eureka County, Nevada.

The adjoining claims are - on the north; Pete 233 on the south; - on the west; Pete 310 on the east.

The location work consisted of making & preparing maps as required in Nevada Revised Statutes 517:040. A notice of location is placed at Location Monument; Posts are placed at each corner at the center of each side line and the name of this lode and date of location, are placed on all posts.

Located this 31st day of MARCH 19 89
 WITNESSES:
 Peter W. Laczay.
 P. O. Box 488
 Coeur d' Alene, Id. 83814 Locators

127398

OFFICE OF RECORDS
 EUREKA COUNTY, NEVADA
 MINERAL RIGHTS SECTION
 FILE NO 625

RECORDED AT THE REQUEST OF
 BOOK 197 PAGE 327
 Idora Silver Mines Co.
 '89 JAN 12 AM 25