

BRR 427 and 429 were located on June 13, 1989.
BRR 430-3 were located on June 25, 1989.

The BRR 427 and 429-433 claims are tied to
BRR Nos. 182 and 192, which in turn are tied
to the SW cor. of Sec. 31, T21N, R51E, MDB&M

LOCATOR

BMR Resources, Inc.
P.O. Box 796
Battle Mountain, Nevada 89820

TYPICAL CLAIM
(showing post numbers)

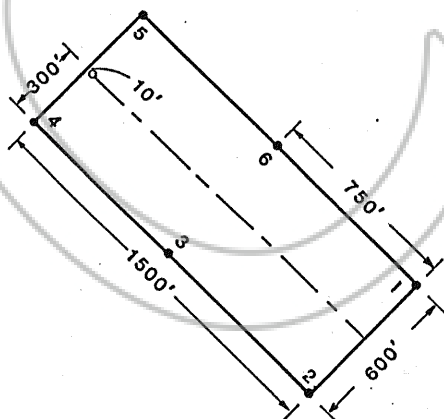

EXPLANATION

- Location monument: all location monuments are 10' from end line, except as otherwise noted.
 - Corner or side center
- Note: all monuments are 3" or 4" PVC plastic. Posts are at least 4 1/2' long.
- ◆ Found section corner

128953

FILED AT THE REQUEST OF BRR Resources
on Aug 18 19 89, at 44 mins, past 4 p.m.
RECORDS OF EUREKA COUNTY, NEVADA M. N. REBALEATI, Recorder
File No. 128953 Fee \$ 60

BRR Resources

MAP of BRR Nos. 427 and 429-433 GROUP of LODE MINING CLAIMS

WITHIN SECTIONS 8 and 17, T20N,
R51E, Mt. DIABLO BASE and MERIDIAN

Lone Mountain Mining District,
Eureka County, Nevada

DATE: AUGUST 7, 1989

SCALE: 1 in. = 500 ft.