

129367

AFFIDAVIT OF ANNUAL ASSESSMENT WORK

STATE OF COLORADO )  
                          ) ss.  
COUNTY OF MESA     )

TO WHOM IT MAY CONCERN:

THE UNDERSIGNED, W. L. Wilson, as a Partner of Windfall Venture, certifies that there was expended more than ONE HUNDRED DOLLARS (\$100.00) per claim for development, labor, and improvements as the annual assessment work for the assessment year ending September 1, 1989, for each and every one of the following 71 contiguous unpatented lode mining claims:

Owner:     Windfall Venture  
           P. O. Box 2183  
           Grand Junction, CO 815502

The following claims located in the Eureka Mining District, Eureka County, Nevada, within Sections 1, 2, 11, 12, 13, and 14, Township 18 North, Range 53 East, MDB&M:

Claim Name	BLM Serial No.	Recordation Data	
		Book	Page
H 7	NMC 80982	71 O. R.	404
H 8	NMC 209743	118 O. R.	133
H 9	NMC 209744	118 O. R.	134
H 10	NMC 209745	118 O. R.	135
H 11	NMC 209746	118 O. R.	136
H 12	NMC 209747	118 O. R.	137
H 13	NMC 209748	118 O. R.	138
H 14	NMC 209749	118 O. R.	139
H 15	NMC 209750	118 O. R.	140
H 16	NMC 209751	118 O. R.	141
H 17	NMC 209752	118 O. R.	142
H 18	NMC 317654	128 O. R.	035
H 19	NMC 317655	128 O. R.	036
H 20	NMC 317656	128 O. R.	037
H 21	NMC 317657	128 O. R.	038
H 22	NMC 317658	128 O. R.	039
H 23	NMC 317659	128 O. R.	040
H 24	NMC 317660	128 O. R.	041
H 25	NMC 317661	128 O. R.	042
H 26	NMC 317662	128 O. R.	043
H 27	NMC 317663	128 O. R.	044

Page 1 of 3

BOOK 20 | PAGE 571

Claim Name	BLM Serial No.	Recordation Data	
		Book	Page
H 28	NMC 317664	128 O. R.	045
H 29	NMC 317665	128 O. R.	046
H 30	NMC 317666	128 O. R.	047
H 31	NMC 317667	128 O. R.	048
H 32	NMC 317668	128 O. R.	049
H 33	NMC 317669	128 O. R.	050
H 35	NMC 317670	128 O. R.	051
H 37	NMC 317671	128 O. R.	052
H 39	NMC 317672	128 O. R.	053
H 40	NMC 317673	128 O. R.	054
H 41	NMC 317674	128 O. R.	055
H 42	NMC 317675	128 O. R.	056
H 43	NMC 317676	128 O. R.	057
H 44	NMC 317677	128 O. R.	058
H 45	NMC 317678	128 O. R.	059
H 46	NMC 317679	128 O. R.	060
H 47	NMC 317680	128 O. R.	061
H 48	NMC 317681	128 O. R.	062
H 49	NMC 317682	128 O. R.	063
H 50	NMC 317683	128 O. R.	064
H 51	NMC 317684	128 O. R.	065
H 52	NMC 317685	128 O. R.	066
H 53	NMC 317686	128 O. R.	067
H 54	NMC 317687	128 O. R.	068
H 55	NMC 317688	128 O. R.	069
H 56	NMC 317689	128 O. R.	070
H 57	NMC 317690	128 O. R.	071
H 58	NMC 317691	128 O. R.	072
H 59	NMC 317692	128 O. R.	073
H 60	NMC 317693	128 O. R.	074
H 61	NMC 317694	128 O. R.	075
H 62	NMC 317695	128 O. R.	076
H 63	NMC 317696	128 O. R.	077
H 75	NMC 373762	147 O. R.	350
H 76	NMC 373763	147 O. R.	351
H 77	NMC 373764	147 O. R.	352
H 78	NMC 373765	147 O. R.	353
H 79	NMC 373766	147 O. R.	354
H 80	NMC 373767	147 O. R.	355
H 81	NMC 373768	147 O. R.	356
H 82	NMC 373769	147 O. R.	357
W 21	NMC 123136	33 O. R.	106
W 22	NMC 123137	33 O. R.	107
W 23	NMC 123138	33 O. R.	108

Claim Name	BLM Serial No.	Recordation Data	
		Book	Page
W 24	NMC 123139	33 O. R.	109
W 25	NMC 123140	33 O. R.	110
W 26	NMC 123141	33 O. R.	111
W 27	NMC 123142	33 O. R.	112
W102	NMC 169095	88 O. R.	150
W104	NMC 169097	88 O. R.	152

The work, development and improvements were performed or made by Brent Wilson of Eureka, Nevada, Randy McDaniel of Eureka Nevada, and Geochemical Services, Inc. of Sparks, NV, at the direction of and under the supervision of W. L. Wilson, P. O. Box 2183, Grand Junction, CO 81502.

The work and improvements were performed between September 1, 1988, and August 31, 1989, and consisted of a geochemical survey of a portion of the claims which survey was nonrepetitive of any previous survey of the claims. *SEE BASIC FINDINGS ATTACHED AS EXHIBITS A & B HERETO.*

Such work cost, and is valued at, in excess of \$7,200.00.

All of the aforesaid 71 unpatented lode mining claims are contiguous and work on any one claim or group of claims tends to develop all the claims. The work was performed for the purpose of developing the mineral potential of the claims, and to maintain and hold such claims.

DATED THIS 25<sup>th</sup> day of August, 1989.

WINDFALL VENTURE

By W L Wilson

Title Managing Partner

STATE OF COLORADO )  
 ) ss.  
COUNTY OF MESA )

Subscribed and sworn to before me this 25<sup>th</sup> day of August, 1989.

My Commission expires: My Commission expires 6-21-92

Carol Graves Hill  
Notary Public

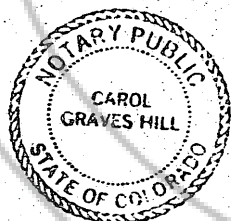

Page 3 of 3

BOOK 201 PAGE 573

DETAILED REPORT OF GEOCHEMICAL SURVEY

This detailed report is filed in compliance with the requirements of 30 U.S.C. Sec. 28-1 and 43 C.F.R. Sec. 3851.2 for the mining claims listed on the attached Affidavit of Annual Assessment Work, comprising a contiguous group of 71 individual claims located in Sections 1, 2, 11, 12, 13 and 14 of T18N, R53E, MDB&M in the Eureka Mining District, County of Eureka, State of Nevada. This survey was performed as annual assessment work for the assessment work year ending at noon on September 1, 1989, for the benefit of all of the claims described on the attached Affidavit, by independent contractors employed by Windfall Venture, the owner of the said mining claims. These surveys are not repetitive of any previous survey, and such surveys have not been applied as annual labor on these claims for more than two consecutive years, or for more than a total of five years on any of the subject claims.

A geochemical sampling program was carried out on the subject claims between June 15, 1989, and August 20, 1989. Soil samples were taken at locations on the subject claims at 100' intervals along lines 200' apart, in the stipled area shown on Exhibit B, with a total of 311 samples collected. A portion of the samples collected were analyzed by GSI of Sparks, Nevada, for 15 different elements, including silver, gold, arsenic, bismuth, cadmium, magnesium, antimony, selenium, tellurium, copper, molybdenum, lead, zinc, gallium. The total cost for this geochemical survey was in excess of \$7,100.00.

BOOK 20 | PAGE 574

The basic findings of this geochemical survey are attached as Exhibit A. To summarize, there are anomalous amounts of gold, silver, and accessory minerals on the claims.

The qualifications of the personnel who performed the geochemical survey are as follows:

Brent Wilson                      Consulting Geologist  
Education: B.S., Geology 1982  
Professional Experience: 7 years

The location of this work's performance with respect to the point of discovery and boundaries of each of the subject claims is shown on attached Figure 2 map having a scale of 1" = 2000'.

The results of the geochemical sampling identified various mineral targets, both primary and secondary, which will be utilized to select other areas on the claims which geochemical sampling might benefit, and to select drill targets in subsequent years. Additionally, the geochemical sampling program will provide a data base for comparison with other areas on the subject claims which will be surveyed in future years.

Respectfully submitted this 22<sup>nd</sup> day of August, 1989.

  
W. Brent Wilson

BOOK 20 | PAGE 575

EXHIBIT B

Map of the H and W claims  
 showing the portions affected by the  
 Geochemical Survey performed for  
 1988-89 annual labor  
 1"=2000'

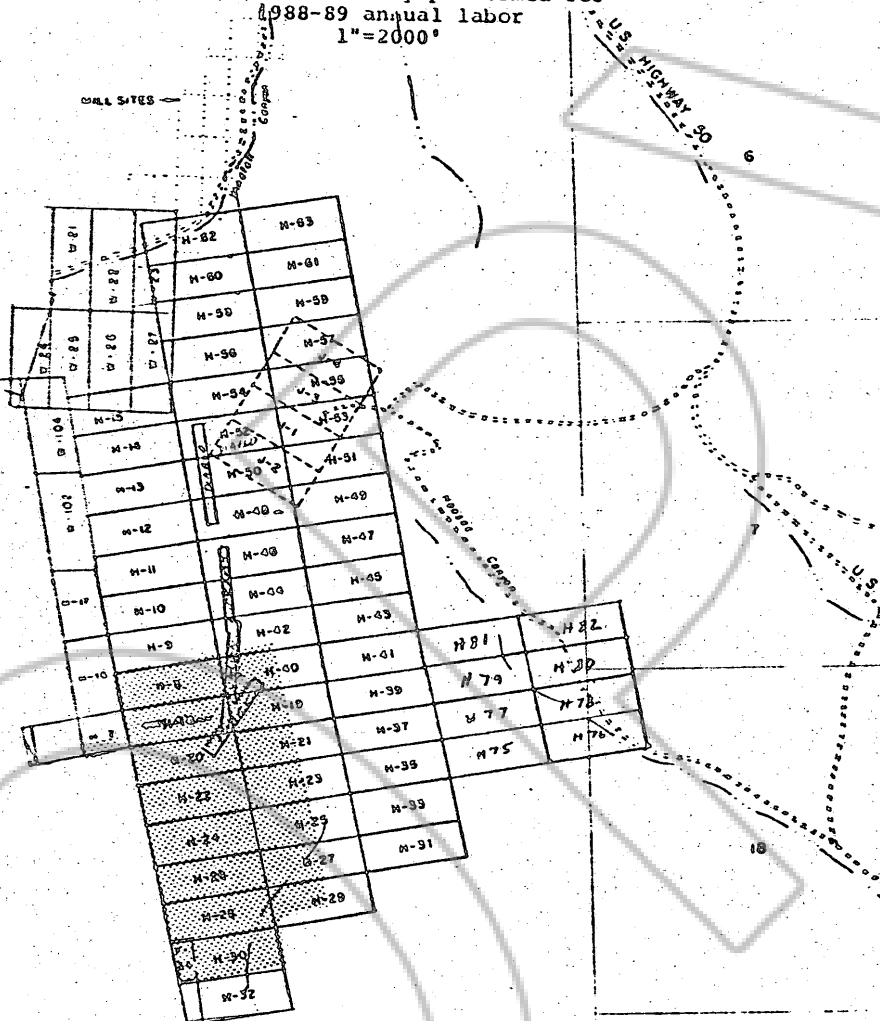

BOOK 201 PAGE 576



# GEOCHEMICAL ANALYSIS REPORT

JOB #: VLA-967166

PAGE 1

SAMPLE ID	#	Ag	Au	As	Bi	Cd	Hg	Sb	Se	To	Cu	Ho	Pb	Zn	Co	Pt
248 *00	1	3715	32.7	76.5	.183	.680	.102	29.6	<.25	<.05	23.0	1.79	356.	87.8	1.26	1.63
248 *1A	2	4533	50.0	75.4	.189	.905	.444	31.8	<.25	<.05	25.0	1.90	491.	106.	1.90	1.78
248 *2B	3	3502	25.6	121.	.170	.869	.101	43.6	<.267	<.069	27.0	3.23	90.1	130.	2.19	2.79
248 *3A	4	4889	36.1	108.	.191	1.28	.173	44.7	<.266	<.069	30.2	3.08	116.	166.	1.67	2.86
248 *4A	5	3300	48.0	143.	.184	.976	.232	57.6	<.269	<.05	30.6	3.28	95.1	179.	1.93	2.86
248 *5A	6	4207	<.198	111.	.150	1.53	.162	40.9	<.268	<.05	43.3	1.99	46.2	287.	.933	1.90
248 *6A	7	2065	16.0	226.	.066	1.67	1.19	67.4	<.25	<.05	52.0	11.7	>265	135.	1.57	6.06
248 *7A	8	21.9K	151.	516.	<.069	3.96	.297	34.0.	<.267	<.069	37.3	8.67	188.	66.8	2.60	5.48
248 *8A	9	6526	132.	500.	.067	.951	.362	236.	<.266	<.069	32.3	9.56	133.	54.8	3.26	42.2
248 *9A	10	3532	191.	326.	<.048	.336	6.82	216.	<.262	<.048	20.0	1.70	379.	66.4	<.1	<.699
248 *10A	11	2656	19.2	35.4	.09	.277	.068	6.22	<.269	<.05	12.0	.649	54.2	60.0	<.1	<.698
248 *11A	12	381.	11.8	21.6	.126	.119	<.02	.856	<.268	<.05	2.89	.453	11.0	102.	.267	<.695
248 *12A	13	64.8	6.38	16.6	<.05	.826	.042	3.39	<.266	<.069	20.0	1.30	20.7	89.9	1.38	.769
248 *13A	14	122.	6.62	33.4	.192	.026	.022	4.26	<.265	<.069	33.7	1.70	23.5	111.	.755	.660
248 *14A	15	169.	2.69	30.9	.190	1.18	<.019	6.35	<.266	<.069	38.9	1.68	22.6	104.	.576	.729
248 *15A	16	166.	7.63	34.5	.192	1.18	.053	5.70	<.263	<.069	25.2	2.12	24.3	107.	.389	.635
248 *16A	17	143.	2.82	32.6	.267	2.04	.023	6.60	<.266	<.069	38.7	2.12	24.3	107.	.389	.635
248 *17A	18	170.	4.23	30.5	.205	1.84	.05	4.26	<.25	<.05	38.9	2.12	29.3	113.	1.66	4.5
248 *18A	19	126.	5.71	22.0	.223	1.40	.07	6.46	<.262	<.068	32.1	1.75	19.5	95.6	1.00	.585
248 *19A	20	190.	7.16	22.4	.262	2.06	.169	6.94	<.265	<.069	51.0	2.00	32.9	146.	.662	<.488
248 *20A	21	239.	6.81	25.7	.262	1.94	.06	6.37	<.267	<.069	47.6	1.90	37.7	136.	.651	.529
248 *21A	22	115.	7.19	27.6	.192	2.15	.034	6.99	<.265	<.069	52.3	2.30	20.3	165.	.734	.607
248 *22A	23	165.	12.1	47.4	.190	1.30	.057	8.38	<.268	<.05	45.8	2.45	25.8	137.	.895	1.16
278 *00	24	839.	16.5	75.9	.163	.526	.056	23.2	<.269	<.05	30.3	2.58	48.6	103.	1.32	1.12
278 *1A	25	2886	28.1	109.	.135	.904	.08	40.3	<.262	<.068	33.9	3.63	116.	136.	2.58	1.81
278 *2A	26	6289	117.	291.	.126	.601	.290	135.	<.268	<.05	25.4	8.86	302.	122.	2.43	3.12
278 *3A	27	4940	96.9	240.	.158	.176	.96.0	96.0	<.266	<.069	27.5	6.98	236.	101.	2.98	3.49
278 *4A	28	5264	63.8	166.	.158	.518	.262	67.0	<.269	<.05	26.2	3.02	107.	93.6	1.96	4.22
278 *5A	29	11.9K	69.6	185.	.157	.553	.296	106.	<.267	<.069	26.0	6.00	359.	90.3	1.96	4.22
278 *6A	30	5491	68.8	317.	.107	1.15	.297	135.	<.265	<.069	36.3	12.6	226.	180.	2.39	5.70

3808 Atherton Road o Rocklin, California 95677 e 916/824-8000 V/800/827-4GSI FAX: 916/824-8988  
1488 Kieppe Lane o Sparks, Nevada 89431 e 702/359-6600 FAX: 702/359-6603

BOOK 201 PAGE 577



# GEOCHEMICAL ANALYSIS REPORT

JOB #: WIA-984766

PAGE 2

SAMPLE ID	Ag	Au	As	Bi	Cd	Hg	Sb	Se	Te	Cu	Hr	Pb	Zn	Co	Tl
278 *7B	2968	<.107	155.	.129	1.31	.096	62.7	<.247	<.049	36.1	7.27	122.	217.	2.77	3.97
278 *8A	10.4K	.262	579.	<.049	1.64	1.06	160.	<.246	<.049	23.9	12.6	274.	366.	1.15	6.13
278 *9A	5080	66.9	309.	.06	.270	.299	598.	<.247	<.049	16.6	11.6	257.	67.1	1.69	3.65
278 *10A	10.3K	186.	408.	.096	.296	.184	108.	.266	<.049	18.5	10.5	335.	67.9	2.02	4.27
278 *11A	5392	89.4	226.	.153	.699	.120	78.0	<.245	<.049	20.9	10.7	467.	87.6	2.99	6.56
278 *12A	1054	6.65	133.	.183	.215	.024	31.0	<.245	<.049	14.2	3.33	167.	87.0	3.03	1.42
278 *13A	6235	66.0	566.	.171	.481	.265	78.8	<.246	<.049	13.6	3.83	985.	76.7	1.60	6.37
278 *14A	67.4	2.69	13.5	.173	.241	<.02	2.31	<.246	<.049	1.92	.553	10.9	35.6	<.098	<.692
278 *15A	129.	11.9	23.1	.199	.668	<.019	1.76	<.246	<.049	16.5	1.02	12.6	41.9	.768	<.693
278 *16A	149.	2.92	19.8	.239	.606	<.019	2.56	<.246	<.049	19.3	1.16	14.6	65.6	.567	<.693
278 *17A	373.	8.57	29.6	.226	.666	<.019	5.71	<.245	<.049	36.6	2.06	33.6	111.	1.63	.561
278 *18A	304.	9.26	68.6	.216	.973	.032	8.06	<.246	<.049	31.1	2.00	60.6	107.	.962	1.05
278 *19A	390.	6.55	76.3	.234	1.71	.108	16.6	<.247	<.049	28.6	2.55	61.5	136.	1.60	1.25
278 *20A	495.	7.60	45.0	.173	1.05	.047	22.3	<.245	<.049	20.7	2.36	52.9	85.6	2.26	1.45
278 *21A	442.	5.99	50.3	.182	.583	.031	16.5	<.246	<.049	18.6	1.75	108.	71.8	2.01	1.97
278 *22A	347.	6.90	106.	.180	.209	.025	8.43	<.243	<.049	22.0	1.45	28.1	72.1	1.46	.568
308 *00	347.	6.90	32.5	.180	.209	.025	8.43	<.243	<.049	24.1	1.27	16.9	73.8	.822	<.491
308 *1A	136.	2.38	18.5	.169	.308	.153	2.41	<.247	<.049	28.5	.886	11.6	69.9	<.099	<.696
308 *2A	61.7	8.42	28.2	.147	.204	.153	2.41	<.247	<.049	28.5	.886	11.6	69.9	<.099	<.696
308 *3A	273.	19.7	52.1	.216	.422	.076	8.19	<.249	<.05	31.7	1.39	28.7	102.	<.099	.566
308 *4A	598.	22.9	90.9	.197	.543	.055	19.7	<.246	<.049	37.6	1.77	37.8	169.	.880	1.66
308 *5A	593.	36.3	130.	.180	.484	.088	26.1	<.248	<.05	36.9	1.79	33.7	191.	1.26	2.76
308 *6A	1045	28.6	146.	.192	.481	.075	41.1	<.248	<.05	25.1	2.67	40.0	114.	.176	2.76
308 *7A	1863	17.1	112.	.117	.783	.261	75.0	<.246	<.049	28.5	2.16	63.1	146.	.222	.980
308 *8A	568	14.0	96.3	.189	.378	.061	26.2	<.249	<.05	37.6	2.57	21.7	182.	<.099	.577
308 *9A	1688	31.8	165.	.155	.326	.067	40.7	<.246	<.049	18.0	3.56	68.9	71.0	2.04	2.98
308 *10A	2686	28.1	155.	.168	.342	.04	30.1	<.243	<.049	24.5	3.08	86.4	107.	2.62	2.55
308 *11A	430.	3.73	125.	1.42	.07	<.02	23.3	<.247	<.049	7.23	3.60	25.2	11.6	1.08	1.76
308 *12A	5760	60.6	188.	.176	.397	.06	45.1	<.247	<.049	22.1	3.91	172.	86.3	3.03	3.79
308 *13A	5872	25.6	158.	.146	.773	.077	49.5	<.247	<.049	19.7	5.54	198.	138.	1.53	4.26

3805 Alhambra Road • Roseville, California 95977 • 916/824-6000 • 1/800/837-4GMI FAX: 916/824-8888  
1488 Kleppel Lane • Sparks, Nevada 89431 • 702/359-6600 FAX: 702/359-6605

806520 | PAGE 578





# GEOCHEMICAL ANALYSIS REPORT

JOB #: WJL-944766

PAGE 3

SAMPLE ID	#	Ag	Au	As	Bi	Cd	Hg	Sb	Se	Te	Cu	Mo	Pb	Zn	Co	Tl
303 *14U	61	1172	19.8	75.6	.228	.735	.065	56.7	<.243	<.049	21.5	1.93	97.1	87.2	2.48	1.59
303 *15U	62	139.	3.26	32.3	.236	1.15	<.02	3.90	<.248	<.05	28.5	1.30	22.6	86.6	.392	.626
303 *16U	63	353.	4.60	71.3	.226	1.90	<.02	10.9	<.245	<.049	31.8	2.77	46.0	143.	1.01	1.63
303 *17U	64	755.	10.8	108.	.225	1.70	<.02	26.0	<.25	<.05	28.0	2.49	48.6	156.	2.98	2.53
303 *18U	65	346.	9.61	71.9	.202	.662	.02	29.8	<.244	<.049	20.6	2.35	66.1	116.	3.90	3.63
303 *19U	66	378.	10.0	99.0	.175	1.32	.042	27.8	<.245	<.049	20.2	2.38	95.2	129.	3.10	2.91
303 *20U	67	1006	43.7	105.	.156	3.03	.253	64.8	<.245	<.049	23.0	2.83	186.	300.	1.43	3.65
303 *21U	68	180.	62.8	120.	.066	.502	.282	38.7	<.245	<.049	10.5	2.19	28.0	72.5	<.098	3.29
303 *22U	69	275.	30.9	139.	.113	.938	.184	46.9	<.246	<.049	15.3	2.27	37.1	101.	.405	3.61
303 *1U	70	220.	2.73	26.6	.169	.348	<.02	7.95	<.247	<.049	19.8	1.49	19.2	83.6	1.73	516
303 *2U	71	909.	11.3	60.3	.192	.437	.032	19.9	<.248	<.05	28.5	1.82	27.9	106.	2.35	.838
303 *3U	72	691.	7.18	39.8	.128	.238	.039	9.19	<.246	<.049	17.0	1.51	19.1	91.2	3.67	.529
303 *4U	73	839.	11.3	56.8	.177	.518	.046	20.1	<.243	<.049	27.6	2.16	31.6	100.	2.18	.790
303 *5U	74	599.	16.1	56.9	.200	.569	.038	17.5	<.245	<.049	21.8	2.67	33.5	79.7	.903	.880
303 *6U	75	204.	1.89	21.1	.068	.210	.077	5.59	<.245	<.049	8.56	3.25	16.2	130.	1.09	<.693
303 *7U	76	196.	3.55	22.7	<.049	.158	.182	4.51	<.247	<.049	11.6	1.99	16.6	92.6	1.16	<.659
303 *8U	77	960.	19.2	86.3	.190	.328	.063	19.2	<.249	<.05	18.6	2.48	36.0	80.6	1.59	1.02
303 *9U	78	703.	18.6	78.8	.245	.348	.046	19.1	<.247	<.049	19.2	2.70	29.9	69.6	.975	.976
303 *10U	79	636.	11.1	42.5	.190	.302	.076	13.7	<.249	<.05	20.5	2.45	20.3	58.6	.781	.737
303 *11U	80	490.	11.3	78.5	.171	.235	.045	16.6	<.242	<.048	23.7	2.19	22.1	56.6	1.01	1.08
303 *12U	81	816.	17.5	108.	.145	.082	.539	17.5	.293	<.05	18.3	2.81	17.0	16.6	<.1	1.00
303 *13U	82	928.	15.7	99.7	.140	.147	.041	28.1	<.243	<.049	22.3	4.37	28.6	38.2	1.18	1.28
303 *14U	83	5028	20.5	200.	.118	.593	.086	65.5	<.247	<.049	15.5	7.80	67.3	60.6	2.18	2.29
303 *15U	84	3916	43.5	181.	.356	.419	.05	86.7	<.242	<.048	17.2	5.77	81.1	71.6	3.06	1.86
303 *16U	85	16.7K	102.	275.	.283	.385	.582	156.	<.245	<.049	18.6	16.6	100.	43.9	2.39	3.71
303 *17U	86	708.	6.73	96.0	.079	.229	.032	21.1	<.245	<.049	10.7	2.15	16.8	36.6	.821	.666
303 *18U	87	193.	3.46	44.8	.119	.327	<.019	8.51	<.244	<.049	16.6	1.62	22.3	93.1	.632	.679
303 *19U	88	433.	6.21	64.6	.110	.323	.028	11.2	<.247	<.049	10.6	1.85	28.7	73.2	.726	.766
303 *20U	89	269.	10.4	62.8	.127	.426	.038	13.2	<.249	<.05	16.6	1.91	29.8	106.	1.22	1.29
303 *21U	90	330.	20.1	86.2	.202	.803	.093	29.9	<.246	<.049	23.0	1.82	47.0	138.	2.81	2.52

3805 Alhambra Road • Rocklin, California 95677 • 916/634-8000 • 1/800/827-4CSI FAX: 916/634-8888  
1488 Kleppe Lane • Sparks, Nevada 89431 • 703/358-8600 FAX: 702/358-6605

000120 | 266579



# GEOCHEMICAL ANALYSIS REPORT

JOB #: W/A-706766

Page 6

SAMPLE ID	#	Ag	Au	As	Bi	Cd	Hg	Sb	Se	Te	Cu	Mo	Pb	Zn	Co	Tl
398 *224	91	242.	14.8	90.4	.195	.632	.08	23.3	<.249	<.05	19.2	1.48	42.1	116.	2.32	2.66
398 *234	92	164.	5.12	68.0	.221	.382	<.02	11.6	<.248	<.05	21.5	.900	18.7	92.0	6.94	1.07
398 *244	93	625.	5.89	129.	.180	.290	.566	16.7	<.25	<.05	19.6	.973	17.5	126.	1.73	1.88
365 *00	94	74.9	1.17	10.3	.198	.195	<.02	2.01	<.245	<.049	8.25	2.09	17.3	35.3	<.098	<.69
365 *10	95	79.0	11.9	91.27	.118	.121	.026	1.75	<.246	<.049	5.03	1.49	18.2	35.6	.255	<.692
365 *20	96	153.	5.32	23.0	.181	.348	<.02	4.99	<.245	<.049	18.1	1.34	23.0	77.7	2.10	<.69
365 *30	97	653.	19.1	86.5	.203	.584	.056	19.5	<.248	<.05	31.8	2.09	35.8	103.	1.23	1.10
365 *40	98	1007	26.3	66.2	.211	.429	.058	20.6	<.248	<.05	30.3	2.16	27.5	71.3	.471	.719
365 *50	99	689.	24.9	72.2	.283	.313	.075	10.8	<.245	<.049	25.6	2.56	29.6	96.5	1.42	.904
365 *60	100	945.	27.9	85.6	.208	.320	.052	13.6	<.246	<.049	32.7	2.56	29.8	90.8	.539	.917
365 *70	101	1064	16.3	75.5	.199	.657	.033	17.1	<.248	<.05	27.8	1.80	37.6	106.	3.38	1.06
365 *80	102	1145	29.0	100.	.176	.495	.043	21.0	<.247	<.049	24.8	3.21	34.6	67.5	.632	1.09
365 *90	103	697.	16.6	73.6	.170	.583	.047	17.4	<.243	<.049	23.7	2.48	34.0	78.3	.854	.864
365 *104	104	741.	28.2	81.1	.198	.460	.058	19.5	<.246	<.05	23.7	2.96	31.9	71.8	.927	.797
365 *110	105	1087	40.7	77.7	.198	.754	.089	16.3	<.249	<.05	21.5	3.02	31.3	76.8	.933	.819
365 *120	106	1128	53.9	76.7	.235	.687	.07	17.8	<.265	<.049	24.1	3.08	31.9	79.1	1.13	1.10
365 *130	107	2129	38.6	87.4	.207	.615	.071	31.0	<.243	<.049	21.2	3.71	33.5	73.1	1.83	1.21
365 *140	108	1776	30.3	162.	.177	.389	.177	23.2	<.249	<.05	16.2	3.90	50.2	62.7	1.61	1.36
365 *150	109	2098	26.3	89.2	.216	.321	.088	34.3	<.248	<.05	12.5	2.70	32.6	49.0	.937	1.01
365 *16.50	110	207.	3.77	48.4	.142	.407	<.02	8.39	<.248	<.05	16.2	1.44	19.2	81.5	1.47	<.697
365 *170	111	317.	5.53	54.0	.137	.401	<.02	7.16	<.246	<.049	15.6	1.56	27.9	85.2	.883	.761
365 *180	112	283.	10.1	60.1	.132	.438	<.02	9.63	<.248	<.05	15.1	1.42	29.7	96.1	1.32	.856
365 *190	113	403.	84.9	135.	.122	.476	.144	25.4	<.248	<.05	11.6	2.42	33.1	123.	.845	2.47
365 *200	114	256.	23.1	83.1	.186	.542	.071	21.8	<.245	<.049	18.6	1.32	36.7	111.	2.42	1.73
365 *210	115	491.	73.4	130.	.193	.712	.134	30.3	<.244	<.049	19.9	1.84	59.8	129.	2.45	2.16
365 *220	116	272.	35.4	149.	.193	.512	.193	24.5	<.244	<.049	17.3	1.49	31.3	102.	1.75	2.35
365 *230	117	533.	35.4	169.	.165	.366	.253	35.6	<.246	<.049	15.5	1.75	47.7	87.6	1.85	2.97
365 *240	118	463.	29.2	161.	.188	.393	.142	23.1	<.244	<.049	17.9	1.40	31.8	101.	2.18	2.30
365 *250	119	122.	7.64	99.3	.180	.425	.067	18.1	<.246	<.049	17.0	1.58	19.8	77.7	1.49	3.29
365 *260	120	185.	4.18	112.	.158	.418	.064	18.1	<.249	<.05	17.9	1.94	19.8	98.8	2.28	3.46

3805 Alherton Road e Rocklin, California 95677 e 916/824-6000 1/800/827-4GSI FAX: 916/824-9888  
1498 Kleppe Lane e Sparks, Nevada 89431 e 702/358-8800 FAX: 702/358-8800

BOOK 20 - PAGE 80





# GEOCHEMICAL ANALYSIS REPORT

JOB 01 WIA-964766

RECORDED AT THE REQUEST OF

BOOK 201 PAGE 571

PAGE 6 *Wendell Weber*

AUG 29, 1985

OFFICIAL RECORDS  
PLUMBLA COUNTY, NEVADA  
FILE NO. 129367  
FILE 8/24/85

BOOK 201 PAGE 571

SAMPLE ID	#	Ag	Al	As	Bi	Cd	Hg	Sb	Se	Te	Cu	Mo	Pb	Zn	Cd	TI
149-000	151	999.	21.5	89.5	.246	.008	.154	12.1	.322	<.049	23.4	1.25	69.3	99.7	6.04	4.87
0-200	152	1254.	66.7	83.8	.923	2.86	.213	10.5	.334	<.05	23.2	9.59	409.	128.	1.55	4.88
338-000	153	115.	.662	18.8	.187	.163	.024	6.21	<.248	<.05	10.8	2.03	17.7	50.1	3.39	4.89
338-10	154	130.	1.41	16.9	.151	.219	.043	3.23	<.246	<.049	16.6	1.65	26.5	53.0	3.48	4.892
338-20	155	192.	2.08	23.9	.178	.332	.036	6.49	<.244	<.049	19.8	1.27	31.1	71.1	6.04	4.89
338-30	156	264.	6.42	99.4	.306	.497	.139	12.6	.296	<.05	31.1	1.90	30.2	85.0	2.19	1.11
338-40	157	564.	15.9	69.0	.190	.497	.098	28.0	<.249	<.05	30.5	2.52	39.1	127.	2.49	1.37
338-50	158	1769.	27.0	118.	.188	.636	.062	28.0	<.249	<.05	33.6	2.89	44.6	117.	3.01	1.80
338-60	159	1031.	18.8	135.	.178	.711	.108	31.2	<.249	<.05	32.7	2.89	44.6	117.	2.49	1.37
338-70	160	809.	31.5	118.	.167	.519	.141	73.6	.313	<.05	35.5	2.73	34.1	105.	2.86	1.08
338-80	161	1784.	17.7	148.	.164	.997	.098	28.2	.347	<.049	27.4	3.68	55.0	135.	3.23	2.07
338-90	162	2631.	37.9	173.	.156	.679	.209	26.8	.260	<.048	26.2	3.81	56.0	154.	3.57	2.90
338-100	163	2217.	17.3	127.	.157	.353	.076	50.3	.260	<.05	18.3	4.56	61.9	68.4	3.65	2.02
338-110	164	1909.	14.2	101.	.177	.416	.089	37.8	.305	<.05	15.6	4.35	53.9	60.9	4.97	1.42
338-120	165	5395.	13.4	179.	.062	.241	.09	64.4	.461	<.049	15.6	15.4	117.	48.5	4.30	13.9
338-130	166	1236.	17.2	101.	.203	.416	.07	26.7	<.246	<.049	20.5	2.44	64.2	119.	3.90	.932
338-140	167	673.	17.6	102.	.064	.356	.106	13.1	.274	<.049	10.8	3.06	24.2	71.0	3.88	.554
338-150	168	596.	11.0	80.9	.151	.478	.037	11.3	<.246	<.049	15.6	2.12	41.7	90.2	2.89	.996
338-160	169	314.	5.1	71.5	.098	.242	.027	8.87	<.242	<.048	9.59	2.19	23.5	104.	3.16	.998
338-170	170	335.	11.5	111.	.169	.969	.061	19.6	<.245	<.049	23.1	2.14	32.9	104.	4.28	1.45
338-180	171	525.	56.3	165.	.208	1.40	.196	39.2	<.249	<.05	19.8	2.75	72.2	147.	3.39	3.60
338-190	172	560.	42.6	143.	.142	1.05	.459	54.2	<.249	<.05	17.6	3.19	81.5	138.	2.38	3.86
338-200	173	536.	27.2	112.	.171	1.12	.135	38.8	<.246	<.049	19.8	2.05	76.8	129.	3.39	2.64
338-210	174	443.	32.6	162.	.127	.628	.204	51.5	<.242	<.048	17.1	1.96	36.8	79.0	3.37	3.15
338-220	175	969.	17.4	143.	.144	1.07	.160	47.5	<.247	<.049	22.3	2.19	50.6	145.	3.64	3.52

3808 Alhambra Road e Rocklin, California 95777 e 916/824-8000 1/800/821-4GSI FAX: 016/824-8888  
1488 Kieppo Lane e Sparks, Nevada 89431 e 702/359-8600 FAX: 702/359-8608