

129610

AFFIDAVIT OR STATEMENT OF ANNUAL ASSESSMENT WORK

(PROOF OF LABOUR)

To Whom it May Concern:

The undersigned hereby certifies that there has been more than fifty three hundred dollars (\$5300.00) spent on labour and improvements as the annual assessment work for the year ending September 1, 1989, on the contiguous lode claims listed on the attached sheets for the purpose of holding said claims.

The claim names, locations, BLM N MC numbers and the County recordation locations are also listed on the attached sheets. All of the claims are located in the Gibellini mining district, Eureka County, State of Nevada. Exhibit "A" lists the claims owned by Mary and Geneve Bisoni and Exhibit "B" lists the claims owned by Louie Gibellini.

The labour was performed and the improvements made by Davis Brothers Drilling Contractors of P.O. Box 449 - Polson, Montana 59860, between the dates June 14 and June 22, 1989, and consisted of drilling 2,538 feet in eleven holes. A map showing the outline of the claims and where the drilling took place is included. This work was done at the expense of Inter-Globe Resources Ltd., optionee's of the claims.

DATED and SIGNED this 19th day of September

*Bruce Cray*  
Bruce Cray

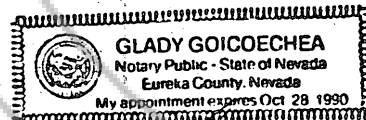

*Gladys Goicoechea*

BOOK 202 PAGE 534

Exhibit "A"

Claim owners: Mary Bisoni and Geneve Bisoni  
P.O. Box 152 2475-7 Sycamore Glen  
Eureka, Nevada Sparks, Nevada  
89316 89316

NAME OF CLAIM	LOCATION			BLM N MC No.	COUNTY Book	RECORDATION Page
	SEC.	TWN	RGE.			
Van 1	3	15N	52E	96037	0	468
Van 2	3	15N	52E	96038	0	468
Van 3	3	15N	52E	96039	0	468
Van 4	3	15N	52E	96040	0	469
Van 5	243	15N	52E	96041	0	475
Van 6	243	15N	52E	96042	0	4
Van 7	243	15N	52E	96043	0	5
Van 8	243	15N	52E	96044	0	5
Van 12	10	15N	52E	96045	0	8
Van 13	10	15N	52E	96046	0	9
Nav 6	2	15N	52E	96047	32	448
Nav 7	35	16N	52E	96048	32	449
Nav 8	2	15N	52E	96049	32	450
Sand 1	3	15N	52E	96050	32	451
Sand 2	3	15N	52E	96051	32	452
Sand 3	3	15N	52E	96052	K	21

BOOK 202 PAGE 535

Exhibit "B"

Claim owner: Louis Gibellini  
P.O. Box 27  
Eureka, Nevada  
89316

NAME OF CLAIM	LOCATION SEC. TWN. RGE.	BLM N MC NO.	COUNTY RECORDATION Book Page
Black Hill #1		82892	I 258
Black Hill #2		82893	I 352
Black Hill #3		82894	K 12
Black Hill #4		82895	I 270
Black Hill #7		82896	I 271
Black Hill #8		82897	K 4
Black Hill #9		82898	J 272
Black Hill #10		82899	K 10
Black Iron #1		82900	I 252
Black Iron #3		82901	I 252
Black Iron #4		82902	I 269
Black Iron #5		82903	I 270
Black Iron #6		82904	K 34
Flat # 1		82905	I 259
Flat # 2		82906	I 259
Flat # 5		82907	J 272
Flat #10		82908	K 13
Flat #11		82909	K 13
Flat #12		82910	K 14
Flat #13		82911	K 14
Manganese #3		82912	I 253
Rattler #1		82913	J 270
Rattler #2		82914	J 271
Rattler #3		82915	J 271
Rattler #4		82916	J 272
Rift #1		82917	J 269
Rift #2		82918	J 270
Rift #3		82919	K 183
Rift #4		82920	K 184
Clyde #1		82921	K 165
Clyde #2		82922	K 166
Clyde #3		82923	K 166
Clyde #4		82924	K 167
Clyde #5		82925	K 167
Clyde #6		82926	K 168
Clyde #7		82927	K 168
Clyde #8		82928	K 169

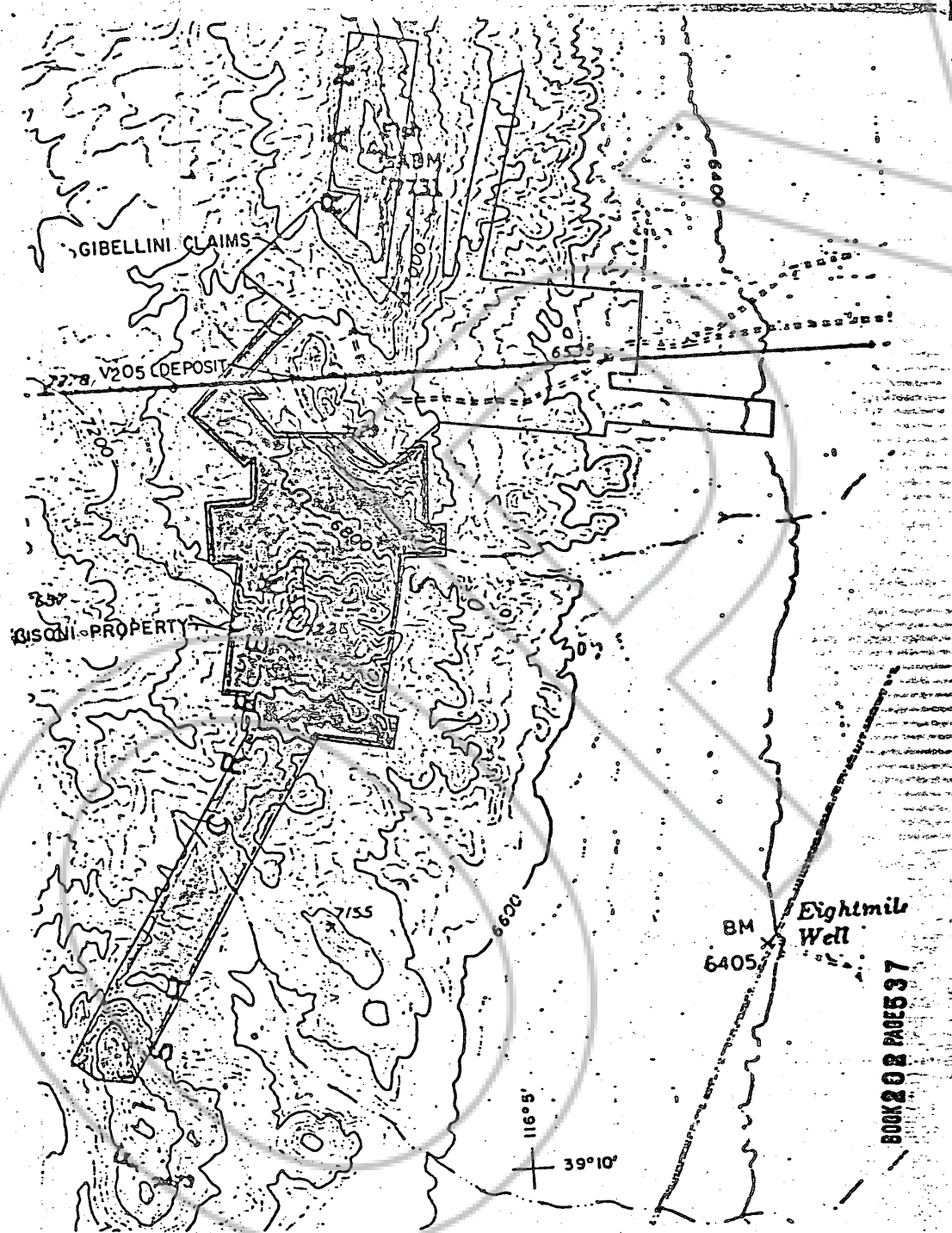

BOOK 202 PAGE 537



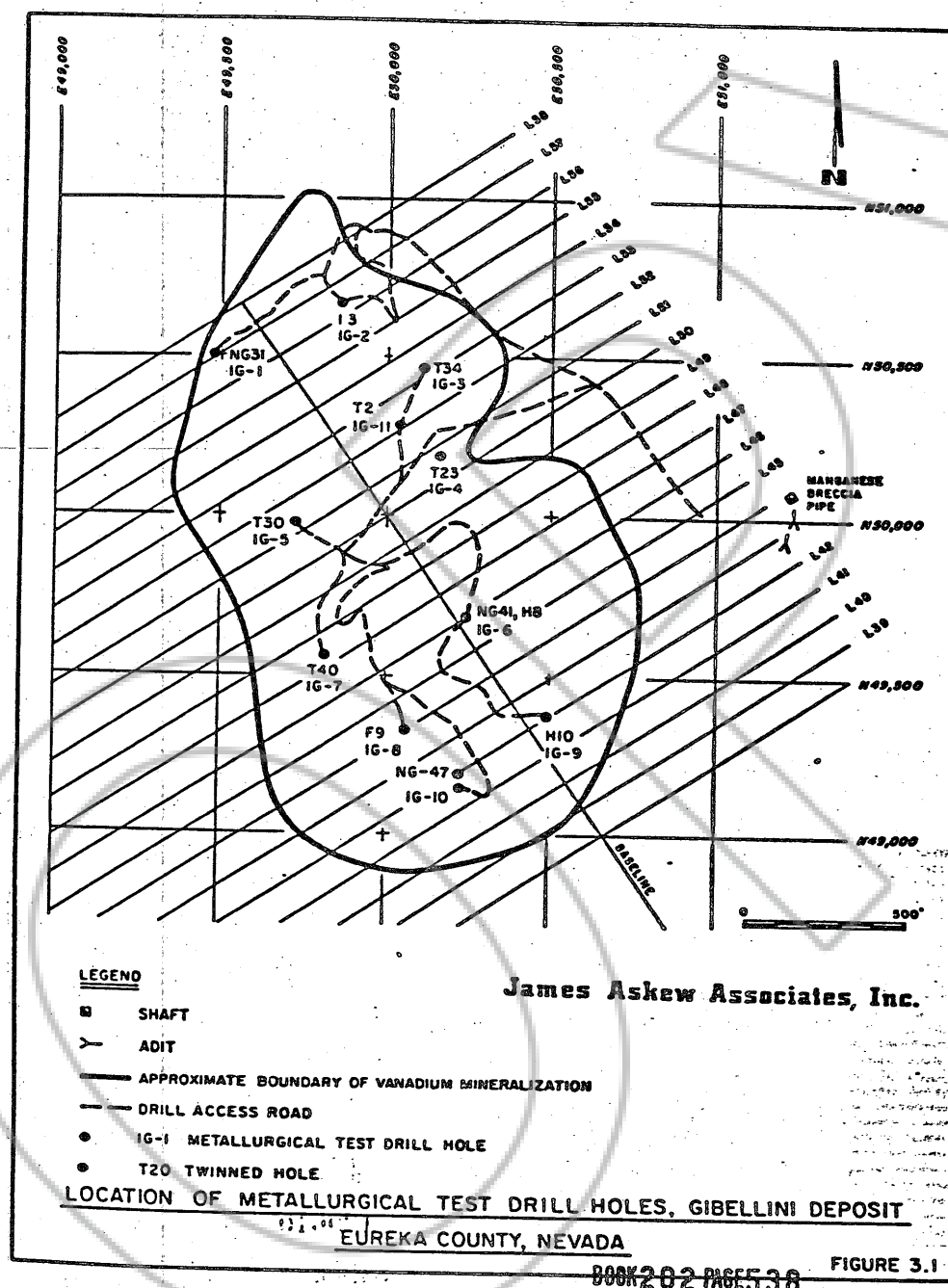

BOOK 202 PAGE 538

RECORDED AT THE REQUEST OF -

BOOK 202 PAGE 523

*Inter - Globe Resources Ltd*

SEP 19 1957

OFFICIAL RECORDS  
EUREKA COUNTY, NEVADA  
M.N. REBALEATI, RECORDER

FILE NO. 129610 FEE \$ 92.75

BOOK 202 PAGE 539