

A C. S. N. M. # 3

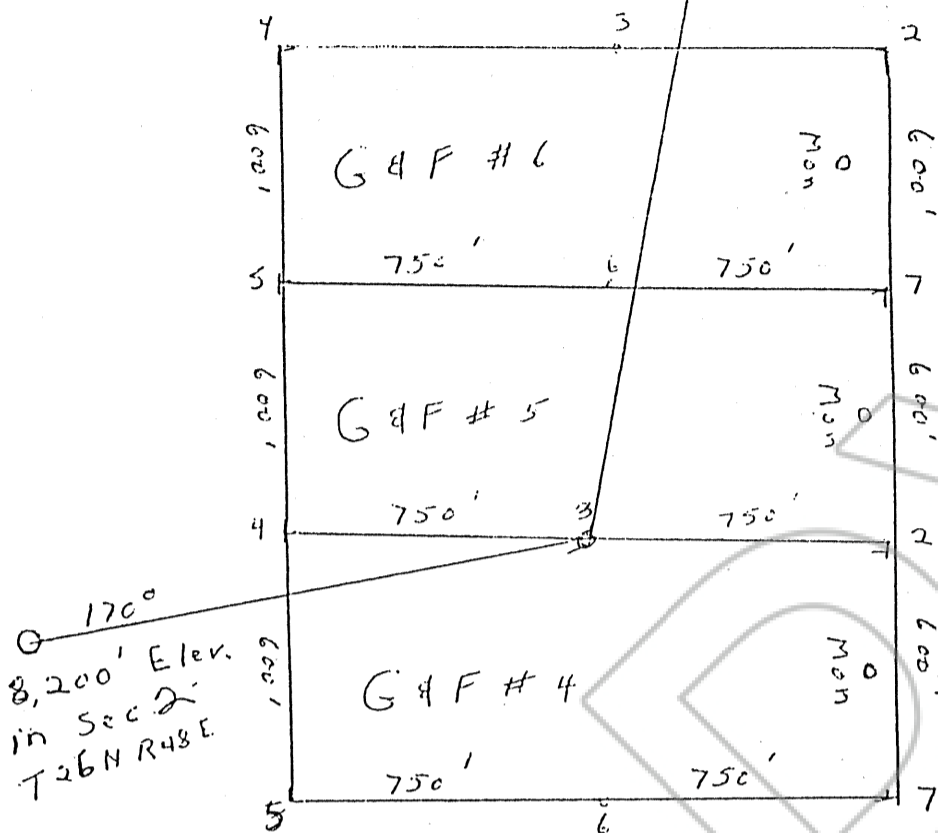

True North  
 Scale 1" = 500'

FILED AT THE REQUEST OF Gil States  
 on Sept 19 19 89, at 17 mins, past 4 P.M.  
 RECORDS OF EUREKA COUNTY, NEVADA M. N. REBALEATI, Recorder  
 File No. 129621 Fee \$ 4500

Describe here the position of the Claim Location Monument, if one is used.  
 Monument market is 20" from the northern side of each claim and 300' from each side, of the east-west sides.

Map of the G & F # 4, G & F # 5, G & F # 6 Mining Claim Group,

in Section 35 Township 27N Range 48E  
 in ref. to the Cortez Quad N 400 - W 11630/15, 1938  
 in the Cortez Mining District,  
 (unsurveyed) Eureka County, Nevada.

Located on the 17 day of September, 19 89, by  
Fil, Gil, Paul, R. C. States, W.F. Holloway  
 Locator name and address (please print)

1237 Highland Drive,  
Elko, Nevada 89801

RECORDER'S STAMP