

THE MAP OF THE
 HASH 1-43
 LODE CLAIM GROUP
 SECTIONS: 29, 30, 31, 32
 T. 21N / R. 53E
 EUREKA COUNTY NEVADA

LOCATED: JAN. 11, 1990
 BY: WILD ROSE MGMT. INC.
 316 BRIDGER ST.
 SUITE 147
 LAS VEGAS, NV.
 89101

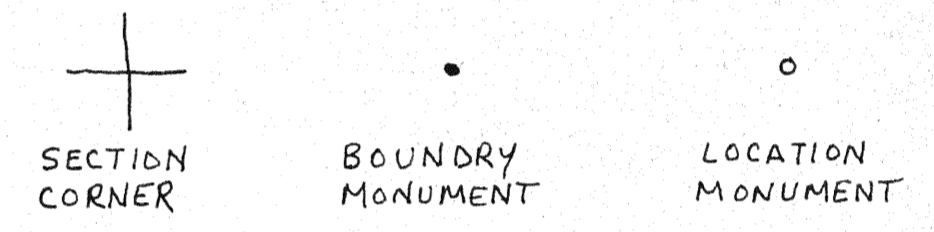

SCALE: ONE INCH = 500 FEET

TYPICAL CLAIM

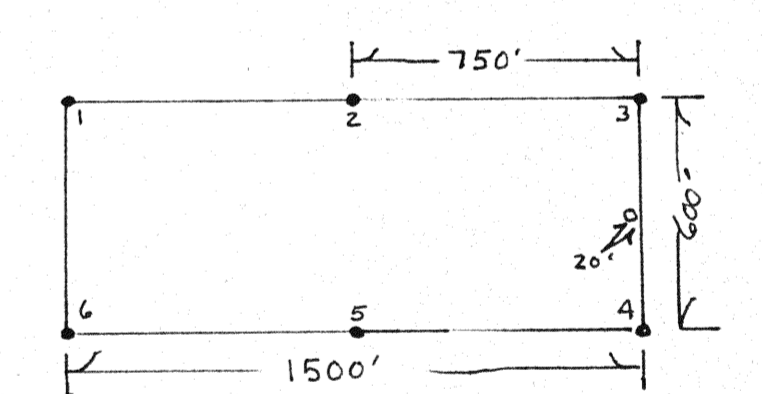

FILED AT THE REQUEST OF Wild Rose Mgmt. Inc.
 on Jan 30 19 90, at 7 min. past 12 P.M.
 RECORDS OF EUREKA COUNTY, NEVADA M. N. REBALEATI, Recorder
 File No. 131360 Fee \$ 645.00

