

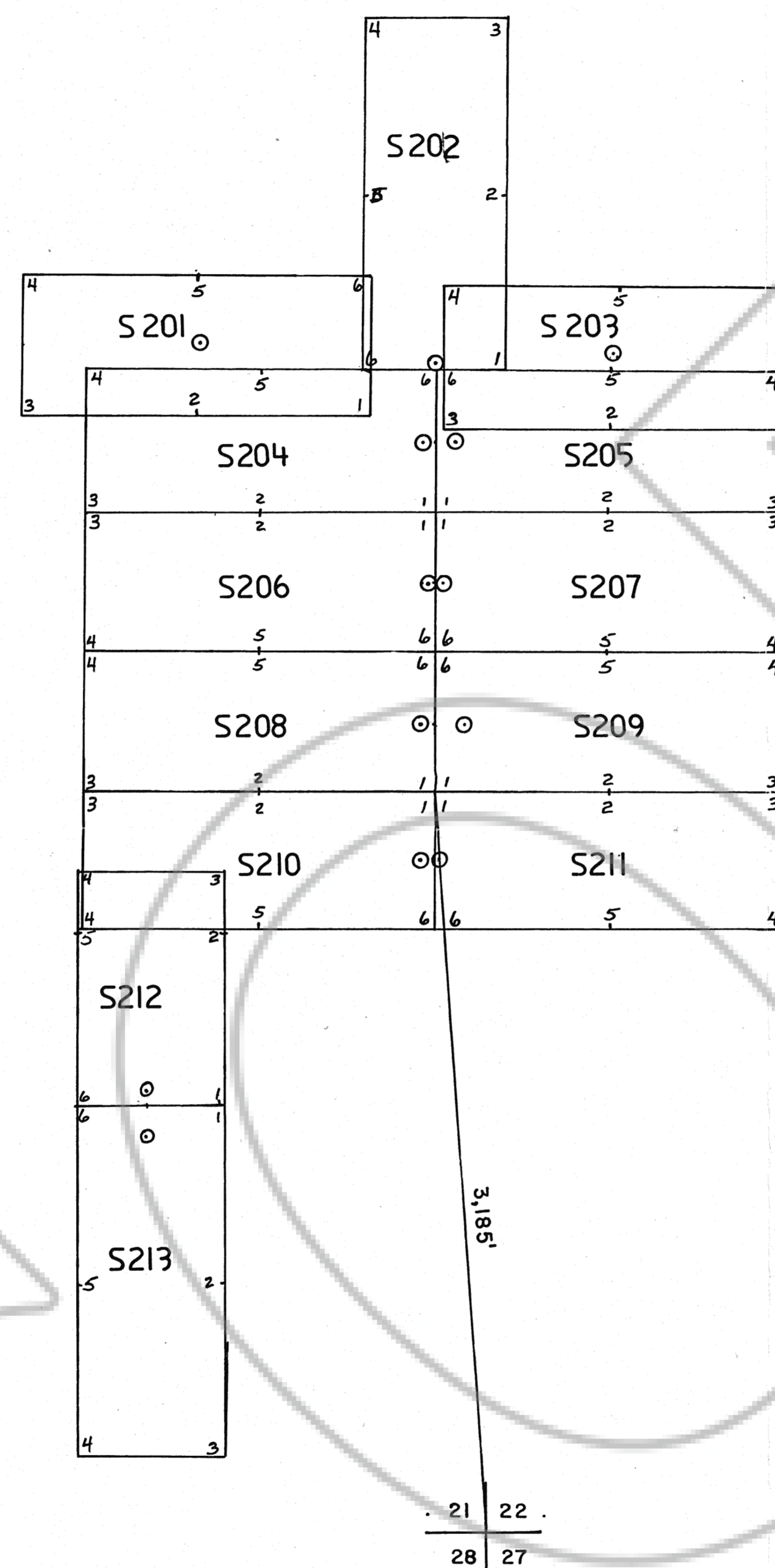

Scale 1:6,000



**SKIP-LODE MINING CLAIMS-201-213**  
 LOCATED IN- Sections 15,16,21,22, T24N, R49E, MDB & M

LOCATION DATES: 1/10/90 - SKIP 201  
 1/11/90 - SKIP 202 - 211  
 1/12/90 - SKIP 212, 213

NOTES: ALL POSTS- Native timber or wood 4" X 4" X 5'  
 O LOCATION MONUMENTS- Native 4" X 4" X 5' timber and are plotted to scale on map.

TIE: Corner no. 1 of SKIP 208 is approx. 3,185', and bearing about 356° from the SE corner of section 21, T24N, R49E, MDB & M.

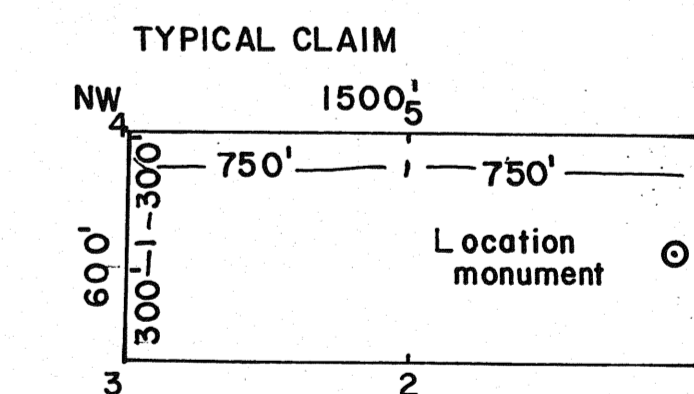

MADE AT THE REQUEST OF: *Lyle F. Campbell*  
 on *Feb 23* 19*90* at *42* mins, east *112* N.  
 RECORDS OF ELIABA COUNTY, NEVADA M. H. REDALEAVI, REGISTRAR  
 File No. **131536** Fee \$ *125.00*

<b>SKIP-CLAIMS #'S 201-213</b>		
SCALE: 1" = 500'	APPROVED BY:	DRAWN BY R. M. Hall
DATE: 1/10,11,12/90		REVISED
LOCATOR - LYLE F. CAMPBELL		P. O. BOX 7377
AGENTS - BRENT WILSON, ROGER M. HALL		RENO, NEVADA 89510
		DRAWING NUMBER S 90 / 1

131536