

VEK / ANDRUS ASSOCIATES
V E K ASSOCIATES
GEOLOGICAL EXPLORATION
836 EAST YORK WAY
SPARKS, NEVADA 89431

Please return to 

(702) 358-0210

132425

XXXXXXXXXXXXXXXX
XXXXXX

AFFIDAVIT OF LABOR

For year ending ~~September~~ 1, 1990

To Whom It May Concern:

VEK/Andrus Associates, owner of the following Lode Mining Claims:

WELS 1 thru 36 NMC 291960-291995

Sec. 8, T 35 N, R 51 E MDM

Located September 26-29, 1983

Recorded Eureka County Records, Book 118, Pages 12-47,

has had 5.7 miles of ground magnetics done on these 36 contiguous claims as shown on the attached sketch. Fifty-foot spaced readings were taken with a GeoMetrics Model G 816 portable proton magnetometer having an accuracy of ± 1 gamma. This work, having a value of over \$4000, was done by Victor E. Kral, with over 50 years mineral exploration experience, and Robert M Hatch, with over 10 years mineral exploration experience, during April 1990.

Plotted cross-sections and interpretation are available at the above address.

Dated this 30th day of May 1990.

By: 
Victor E. Kral

Subscribed and sworn to before me this 30th day of May 1990.

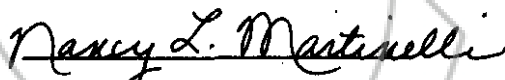
NOTARY PUBLIC

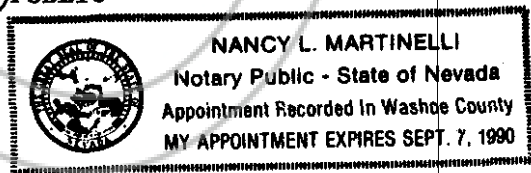

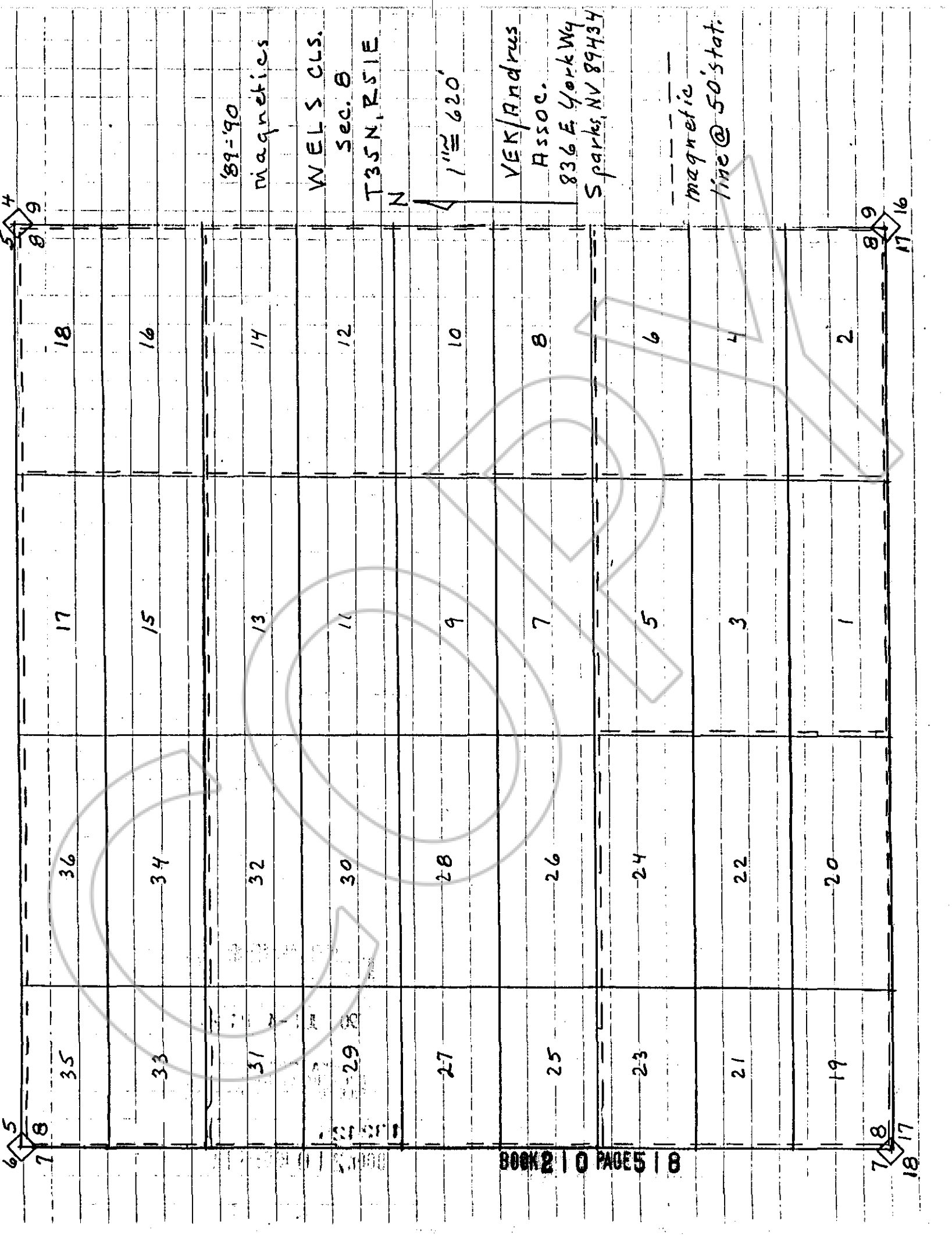

5
4
8
9

18

16

89-90

Magnetics

WELLS CLS.

Sec. 8

T35N, R51E

N

1" = 620'

VEK/Andrus
Assoc.
836 E. York Wy
Sparks, NV 89434

magnetic
line @ 50' stat.

8
9
17
16

17

15

13

11

9

7

5

3

1

36

34

32

30

28

26

24

22

20

35

33

31

29

27

25

23

21

19

6
5
7
8

7
8
18
17

COPY

OFFICIAL RECORDS
RECORDED AT THE REQUEST OF
BOOK 210 PAGE 517

Victor Kral
'90 JUN -4 P1:47

EUREKA COUNTY, NEVADA
M.N. REBALEATI, RECORDER
FILE NO. FEE \$63⁰⁰-

132425

BOOK 2 | 0 PAGE 5 | 9