

AFFIDAVIT OF ANNUAL ASSESSMENT WORK

STATE OF COLORADO)
) ss.)
COUNTY OF MESA)

TO WHOM IT MAY CONCERN:

THE UNDERSIGNED, W. L. Wilson, as President of Wilson Mineral Properties, Inc., certifies that there was expended more than ONE HUNDRED DOLLARS (\$100.00) per claim for development, labor and improvements as the annual assessment work for the assessment year ending September 1, 1990, for each and every one of the following sixty (60) contiguous unpatented lode mining claims which are situate in the Tonkin Springs Mining District, Eureka County, Nevada:

CLAIM NAME	BOOK	PAGE	BLM NO.
D-1 through D-60	192	513-572	537620-537679

The work, development and improvements were performed or made by SRD Computing Assoc., of Eureka, Nevada, Brent Wilson of Reno, Nevada, Geochemical Services Inc., of Rocklin, California, and W. L. Wilson of Grand Junction, Colorado at the instance and expense of Wilson Mineral Properties, Inc., owner of the claims, under the supervision of W. L. Wilson, P. O. Box 2183, Grand Junction, CO 81502.

The work and improvements were performed between September 1, 1989, and August 29, 1990, and consisted of a geochemical survey of the claims. The basic findings of such survey is attached as Exhibit A hereto. Such survey is non-repetitive of any previous survey of the claims. The work was performed for the purpose of developing the mineral potential of the claims and to maintain and hold such claims.

Such work cost, and is valued at, in excess of \$6,000.00. Dated this 29th day of August, 1990.

WILSON MINERAL PROPERTIES

BY

W. L. Wilson

President

STATE OF COLORADO)
) ss.)
COUNTY OF MESA)

Subscribed and sworn to before me this 29th day of August,

Commission expires:

May 31, 1992

Charles F. Quette

Notary Public

Address: Box 4090, Grand Junction CO 81502



EXHIBIT A

DETAILED REPORT OF GEOCHEMICAL SURVEYS

This detailed report is filed in compliance with the requirements of 30 U.S.C. Sec. 28-1 and 43 C.F.R. Sec. 3851.2 for the mining claims D-1 through D-60 (NMC 537620-537679) inclusive, comprising a contiguous group of 60 individual claims located in Sections 25 of T24N R49E and Sections 28, 29, 30 and 32 of T24N R50E MDB&M in the Tonkin Springs Mining District, County of Eureka, State of Nevada. These surveys were performed as annual assessment work for the assessment work year ending at noon on September 1, 1990, for the benefit of all of the claims described, by independent contractors employed by Wilson Mineral Properties Inc., the owner of the said mining claims. These surveys are not repetitive of any previous survey, and such surveys have not been applied as assessment labor on these claims previously.

A geochemical sampling program was carried out on the subject claims between September 1, 1989, and August 29, 1990. Soil samples were taken at locations on the subject claims at all claim corners, side centers, and discovery monuments as shown on Exhibit B, with a total of 178 samples collected. The samples collected were analyzed by GSI of Sparks, Nevada, and Rocklin, CA for 15 different elements, including silver, gold, arsenic, bismuth, cadmium, magnesium, antimony, selenium, tellurium, copper, molybdenum, lead, zinc, gallium. Contour maps were made for Gold, Silver, Mercury, and Arsenic and are attached as Exhibits C1, C2, C3 and C4 which show the basic findings of the

survey. The total cost for this geochemical survey was in excess of \$ 6,000.00.

The qualifications of the personnel who directed the geochemical survey are as follows:

W. L. Wilson
Mining Consultant

B.S. Oregon State University
10 years Exploration Manager, Idaho Mining Corp.
8 years President, Idaho Mining Corp.
12 years Mineral Exploration Consultant

The location of this work's performance with respect to the point of discovery and boundaries of each of the subject claims is shown on attached Exhibit B.

The results of the geochemical sampling identified various mineral targets, which will be utilized to select other areas on the claims which geochemical sampling might benefit.

Additionally, the geochemical sampling program will provide a data base for comparison with other areas on the subject claims. Respectfully submitted this 29th day of August, 1990.

W. L. Wilson

W. L. Wilson

BOOK 2 | 3 PAGE 302

EXHIBIT B

20 21 22

19 20 21

24 25 26

18	20	32	39	46	59	74	89	112	133	142	157	168	175	182
12	11	31	38	45	57	73	86	116	132	147	154	166	172	181
11	18	24	37	44	55	72	87	114	131	146	153	163	173	180
10	17	27	34	43	53	71	84	112	130	145	152	162	172	179
9	16	25	35	42	51	70	85	110	129	144	151	160	171	178
8	15	23	34	41	49	69	84	109	128	143	150	159	170	177
7	14	21	33	40	47	68	83	106	127	142	149	156	169	176
6	13	19	28	36	44	64	81	107	126	141	148	155	168	175
5	12	17	26	34	42	62	79	105	125	140	147	154	167	174
4	11	15	24	32	40	60	77	103	124	139	146	153	166	173
3	10	13	22	30	38	58	75	101	123	138	145	152	165	172
2	9	11	20	28	36	56	73	99	122	137	144	151	164	171
1	8	9	18	26	34	54	71	97	121	136	143	150	163	170
	7	8	16	24	32	52	69	95	120	135	142	149	162	169
	6	7	14	22	30	50	67	93	119	134	141	148	161	168
	5	6	12	20	28	48	65	91	118	133	140	147	160	167
	4	5	10	18	26	46	63	89	117	132	139	146	159	166
	3	4	8	16	24	44	61	87	116	131	138	145	158	165
	2	3	6	14	22	42	59	85	115	130	137	144	157	164
	1	2	4	12	20	40	57	83	114	129	136	143	156	163

CLAIM LOCATION MAP FOR THE D GROUP
 LOCATED BY WILSON MINERAL PROPERTIES, INC.
 P. O. BOX 2189, GRAND JUNCTION, CO 81502
 IN THE ROBERTS MOUNTAIN (UNORGANIZED)
 DISTRICT, EUREKA COUNTY, NEVADA
 MAP PREPARED DECEMBER 17, 1988

DATES OF LOCATION:

OCTOBER 6, 1988...D-1 THRU D-24, D-47 THRU D-50, D-59, D-60
 OCTOBER 15, 1988...D-25 THRU D-46
 OCTOBER 16, 1988...D-51 THRU D-58

GEOCHEMICAL SAMPLE
 LOCALITY MAP - AUGUST, 1980
 NUMBER OF LOCATIONS
 TIME CHANGE
 DISTANCE

R49E
 R50E

T24 N
 T23 N

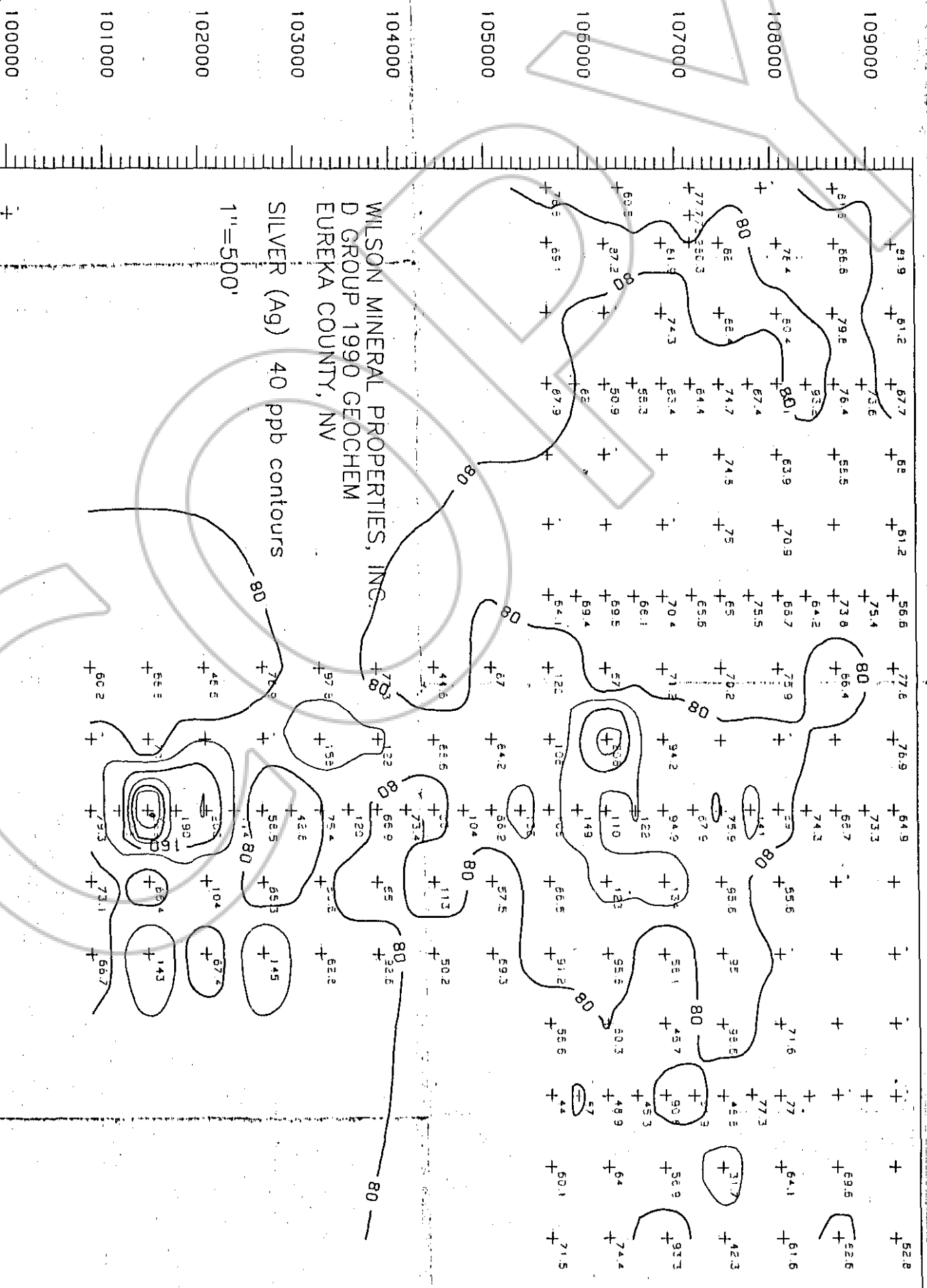

WILSON MINERAL PROPERTIES, INC.
 D GROUP 1990 GEOCHEM
 EUREKA COUNTY, NV

SILVER (Ag) 40 ppb contours
 1"=500'

BOOK 2 | 3 PAGE 305

100000 101000 102000 103000 104000 105000 106000 107000 108000 109000 110000 111000

100000

101000

102000

103000

104000

105000

106000

107000

108000

109000

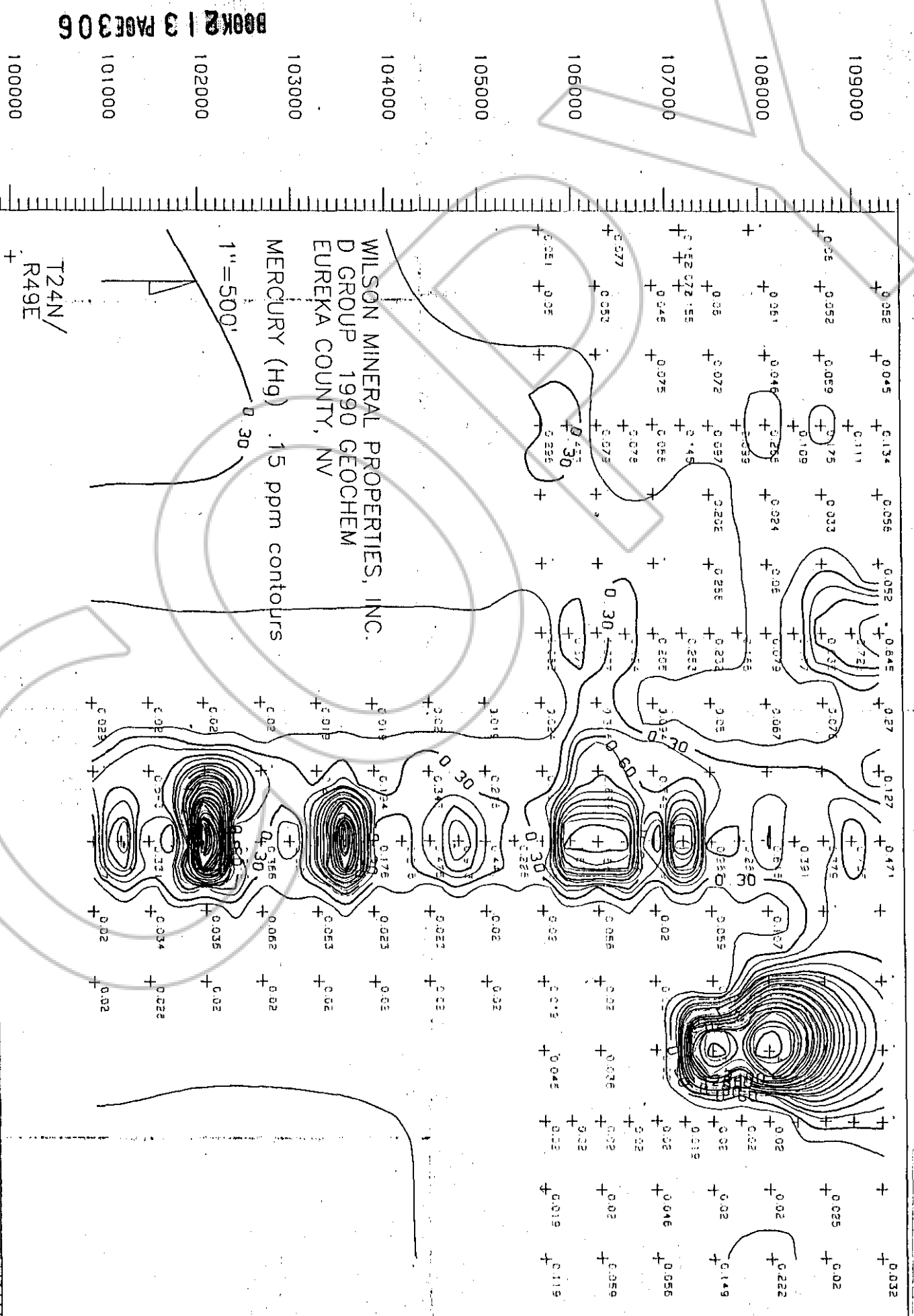

BOOK 2 | 3 PAGE 306

109000
108000
107000
106000
105000
104000
103000
102000
101000
100000

100000 101000 102000 103000 104000 105000 106000 107000 108000 109000 110000 111000

T24N/
R49E

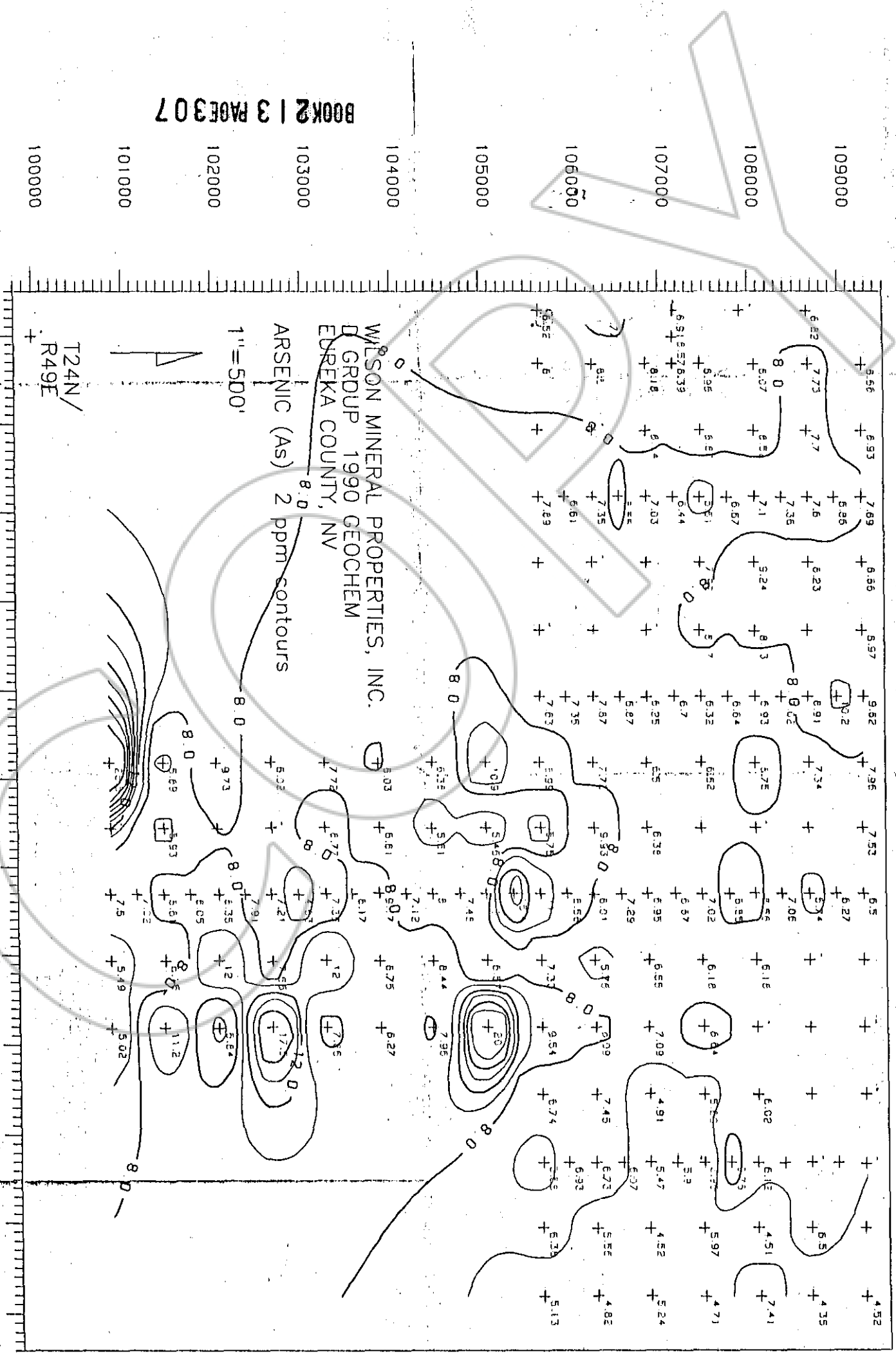

BOOK 2 | 3 PAGE 307

COPY

BOOK 2 | 3 PAGE 308

133362

OFFICIAL RECORDS
RECORDED AT THE REQUEST OF
BOOK 213 PAGE 300
William Murray
90 AUG 30 P1 55
Proprietor
EUREKA COUNTY, NEVADA
M.H. REBALEATI, RECORDER
FILE NO.
FEE \$ 105 -