

24 | 19
25 | 30

30 | 29

S 177° 51' 27" E
S 64° 11' 41" E
FROM SECTION CORNER
TO W/2 CENT WHIST 17

R-51E
R-52E

25 | 30
36 | 31

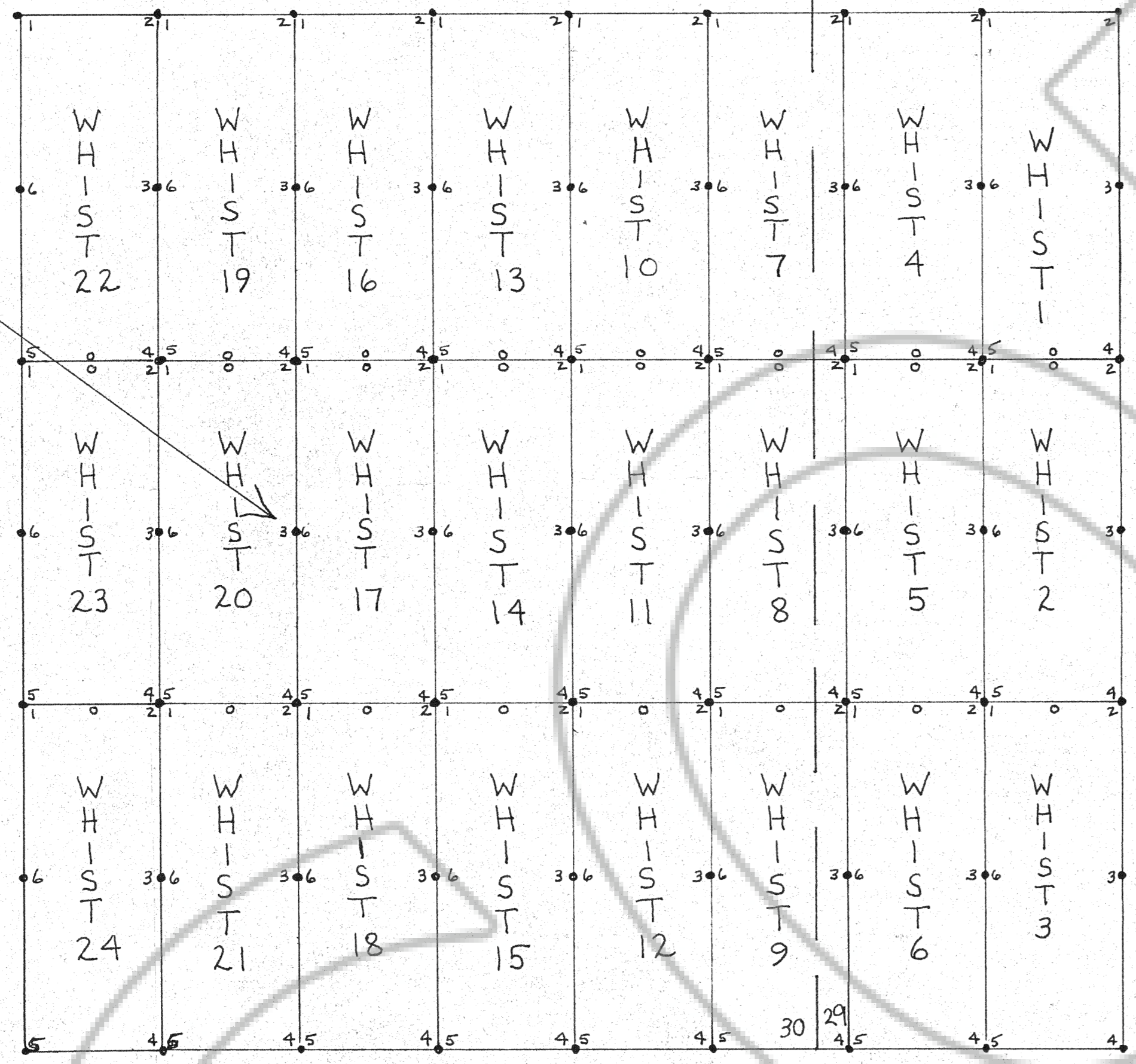

THE MAP OF THE
WHIST 1-24
LODE CLAIM GROUP
SECTION 30 & 29 / R-52E
EUREKA COUNTY NEVADA
LOCATED SEPT. 25, 1990
BY: WILD ROSE MGMT. INC.
316 BRIDGER ST.
SUITE 147
LAS VEGAS, NV.
89101

SCALE: ONE INCH = 500 FEET

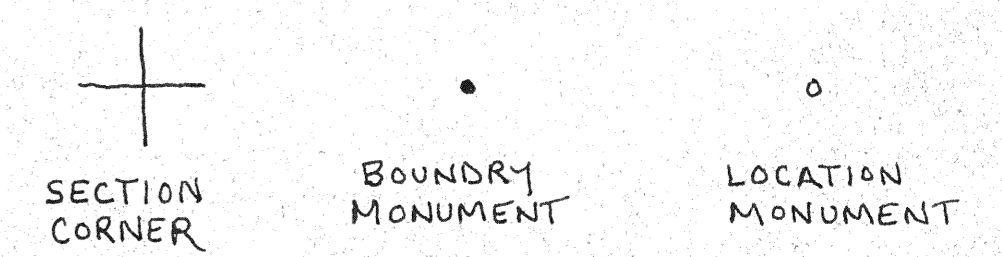

TYPICAL CLAIM

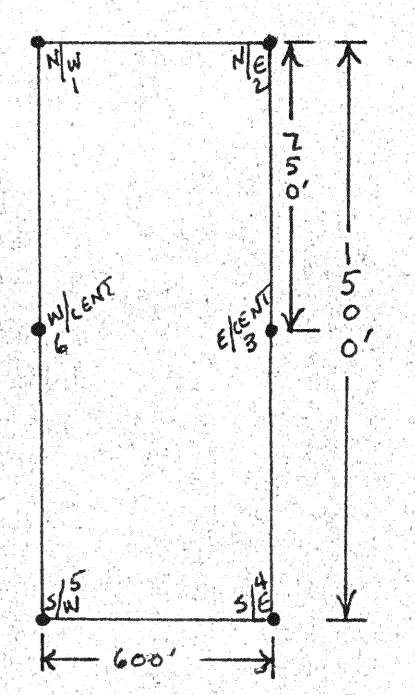

FILED AT THE REQUEST OF *Wild Rose Mgmt*
ON *Oct 11 1990*, at *46* mins, past *12* M.
RECORDS OF EUREKA COUNTY, NEVADA M. H. REBALEATI, Recorder
File No. *134129* Fee \$ *360*