

137821

AFFIDAVIT OF PERFORMANCE OF LABOR

STATE OF UTAH)
) ss:
COUNTY OF SALT LAKE)

Before me, the subscribed, personally appeared Ronald Willden, whose address is 8750 Kings Hill Drive, Salt Lake City, Utah 84121, who being duly sworn, stated that at least TWO THOUSAND NINE HUNDRED DOLLARS (\$2,900.00) worth of geophysical surveying work was performed upon or for the benefit of all of the following described group of 29 contiguous lode mining claims situated in Sections 18, and 19, Township 27 N., Range 53 E., MDB&N, in the Union mining district, Eureka County, State of Nevada, to wit:

BR Numbers 134, 136, 138, 140, 143 through 150, 169 through 176, 259 through 266 and 268, more particularly described in Exhibit A, attached hereto and made a part hereof.

He further stated that such expenditure was made by John L. Carroll, owner of record of said claims, for the purpose of holding said claims for the assessment year that ends at noon on September 1, 1991; that the foregoing work was done during the period August 12 to 19, 1991, by the geophysical contractor, E. Posey and a crew of technicians under his supervision and under the direct supervision of the undersigned; that he is the duly authorized representative of John L. Carroll, whose address is 515 Madison Ave., 32nd Floor, New York, N. Y. 10022; and that attached to this Affidavit is a copy of the Report of such work, as required by Title 30, United States Code, Section 28-1.

Signature of affiant Ronald Willden
Ronald Willden

Subscribed and sworn to before me this 30th day of August, 1991.

Carroll S. Simpson
Notary Public

My commission expires 4-23-92



Exhibit A

The following described unpatented lode mining claims are situated in sections 18 and 19, Township 27 N., Range 53 E., MDB&M, in Eureka County, State of Nevada, and the Certificates of Location are filed in the Recorder's Office of said county and with the Nevada State Office of the U. S. Bureau of Land Management.

<u>Name and number</u>	<u>County recordation</u>	<u>U.S. BLM Serial No.</u>
BR # 134	Bk 121 pg 26	N MC 296289
BR # 136	121 28	296291
BR # 138	121 30	296293
BR # 140	121 32	296295
BR # 143	121 33	296296
BR # 144	121 34	296297
BR # 145	121 35	296298
BR # 146	121 36	296299
BR # 147	121 37	296300
BR # 148	121 38	296301
BR # 149	121 39	296302
BR # 150	121 40	296303
BR # 169	121 59	296322
BR # 170	121 60	296323
BR # 171	121 61	296324
BR # 172	121 62	296325
BR # 173	121 63	296326
BR # 174	121 64	296327
BR # 175	121 65	296328
BR # 176	121 66	296329
BR # 259	121 67	296330
BR # 260	121 68	296331
BR # 261	121 69	296332
BR # 262	121 70	296333
BR # 263	121 71	296334
BR # 264	121 72	296335
BR # 265	121 73	296336
BR # 266	121 74	296337
BR # 268	121 76	296339

SUMMARY REPORT

August 30, 1991

This detailed report is filed in compliance with the requirements of Title 30, United States Code, Section 28-1, for a group of 29 contiguous lode mining claims known as the BR group and more particularly described in Exhibit A attached to the Affidavit to which this Report is also attached, and shown on the Plan Map attached hereto and made a part hereof.

The assessment work consisted of a rather detailed geophysical survey of a portion of the claim block where soil geochemical anomalies previously had been identified, and which suggested that mineral deposits might be found at depth in favorable rock units. Drilling these anomalies had failed to find ore although mineralized rock was cut in the drill holes. After consultation with E. F. Posey, geophysical consultant of Salt Lake City, Utah, it was determined that the mineralization encountered in the drill holes could be mapped with a gradient array Induced Polarization survey. Such a survey was then contracted to Mr. Posey and this survey was performed under the supervision of the undersigned who is qualified to conduct such surveys by virtue of BS and Ms degrees in mineralogy and a PhD degree in geology and more than 39 years experience in such surveying work and the supervision of such work. The cost of this surveying was in excess of TWO THOUSAND NINE HUNDRED DOLLARS (\$2,900.00).

The geophysical surveying consisted of an Induced Polarization survey using a gradient array configuration of current and detector electrodes. The survey detailed the area of most intense drilling where arsenic had been found to be concentrated in the soils. Traverse lines spaced 100 feet apart were surveyed in an east-west direction with stations at 100 and 200 foot intervals on these lines. High chargeability zones were seen on all of the lines with very high values in some rather large zones. The strong chargeability anomalies, which are interpreted to be due to sulfide enriched zones in the rocks, have not been penetrated by any of the holes drilled in this area. The strong chargeability anomalies are in areas underlain by the Webb Formation, which appears to have been thrust over the Nevada Dolomite in the project area. The chargeability anomalies may be due to sulfide deposition in the Webb Formation by solutions circulating in the fractured rocks close to the thrust fault. Such zones may also have been favorable sites for gold deposition.

Detailed maps and other technical data incorporating the results of this surveying are in the possession of the undersigned, who maintains offices at 8750 Kings Hill Drive, Salt Lake City, Utah 84121.

Respectfully submitted,

Ronald Willden
Ronald Willden
Exploration Geologist

BOOK 225 PAGE 484

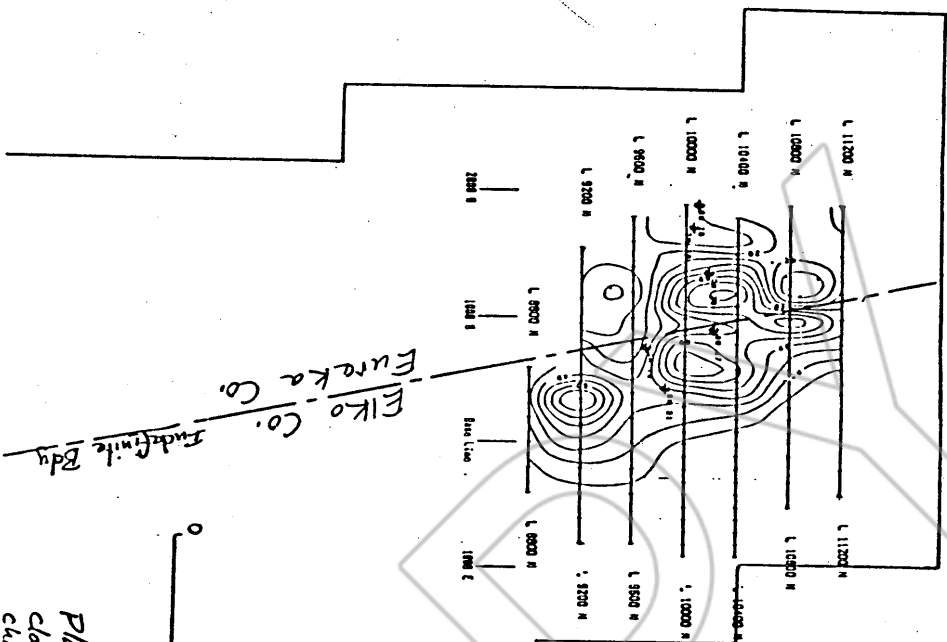

Plan Map showing position of BR-CT claim block, IP survey lines and chargeability anomalies, and existing drill holes.

Eureka Co.
Indefinite Bdy

Approx. boundary of BR claims - total 94 in two counties.

BOOK 225 PAGE 482
OFFICIAL RECORDS
RECORDED AT THE REQUEST OF
Donald Willden
91 SEP 20 P1-23

EUREKA COUNTY, NEVADA
M.N. REDEALTY RECORDER
FILE NO. FEE \$ 50⁰⁰

137921

BOOK 225 PAGE 485