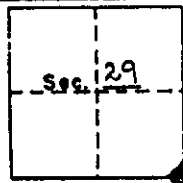

CORNER RECORD

Filed as required by Statutes of Nevada, 1969, Chapter 366.

Sheet 2 of 2 sheets.Sec. 29 Twp. 34N Range 52E, Mt. Diablo PM.County of ELKO AND EUREKA, State of Nevada.

SYMBOLS

- Official corner found.
 Corner found, authenticity doubtful.
 Corner searched for and not found.

DESCRIPTION OF CORNER MONUMENT

FOUND THE REMAINS OF THE ORIG.
WOODEN POST. SET 2" dia. x 24"
long GALV. I.P. WITH A 3/4" dia. AL.
CAP 0.2 FT AB. GRD.

STAMPED

PLS 6196
T34N R52E
S29 S28
S32 S33
1992

DESCRIPTION OF BEARING TREES, MOUND OF STONE, ETC.

SET A FULL STEEL FENCE POST, WITH THE
REMAINS OF THE ORIGINAL WOODEN POST.
WIRED TO IT, 0.2 FT NORTH OF MONUMENT.

DESCRIPTION OF LOCATION TO ENABLE RECOVERY BY OTHERS.

MONUMENT FALLS IN A WIDE SOUTHERLY DRAIN-
AGE WITH GRASSY VEGETATION AND FEW
SAGE BRUSH.

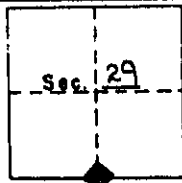

SYMBOLS

- Official corner found.
 Corner found, authenticity doubtful.
 Corner searched for and not found.

DESCRIPTION OF CORNER MONUMENT

FOUND THE ORIGINAL WOODEN
POST. SET A 2" dia. x 24" long
GALV. I.P. WITH 3/4" dia. AL. CAP
0.3 FT AB. GRD.

STAMPED

PLS 6196
T34N R52E
1/4 S29
1/4 S32
1992

DESCRIPTION OF BEARING TREES, MOUND OF STONE, ETC.

SET A FULL STEEL FENCE POST, WITH THE
ORIGINAL WOODEN POST WIRED TO IT, 0.4
FT. NORTH OF MONUMENT.

DESCRIPTION OF LOCATION TO ENABLE RECOVERY BY OTHERS.

MONUMENT SETS ON A SLIGHTLY SLOPING
FLAT RIDGE COVERED WITH 1 to 2 FT HIGH
SAGE BRUSH.

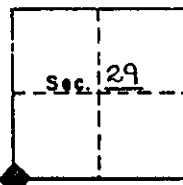

SYMBOLS

- Official corner found.
 Corner found, authenticity doubtful.
 Corner searched for and not found.

DESCRIPTION OF CORNER MONUMENT

FOUND THE ORIGINAL WOODEN
POST. SET 2" dia. x 24" long
GALV. I.P. WITH A 3/4" dia. AL.
CAP 0.4 FT. AB. GRD.

STAMPED

PLS 6196
T34N R52E
S30 S29
S31 S32
1992

DESCRIPTION OF BEARING TREES, MOUND OF STONE, ETC.

A FULL STEEL FENCE POST HAS BEEN
SET, WITH THE ORIGINAL WOODEN POST
WIRED TO IT, 0.5 FT NORTH-EAST OF
MONUMENT.

DESCRIPTION OF LOCATION TO ENABLE RECOVERY BY OTHERS.

Monument sets on relatively flat
ground covered with 1 to 3 FT. HIGH
SAGE BRUSH.

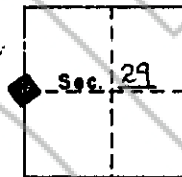

SYMBOLS

- Official corner found.
 Corner found, authenticity doubtful.
 Corner searched for and not found.

DESCRIPTION OF CORNER MONUMENT

FOUND ORIGINAL WOODEN
POST. SET 2" dia. x 24" long
GALV. I.P. WITH A 3/4" dia.
AL. CAP 0.3 FT. AB. GRD.

STAMPED

PLS 6169
T34N R52E
1/4
S30 S29
1992

DESCRIPTION OF BEARING TREES, MOUND OF STONE, ETC.

A FULL STEEL FENCE POST HAS
BEEN SET, WITH THE ORIGINAL
WOODEN POST WIRED TO IT, 0.5 FT
NORTH-EAST OF MONUMENT.

DESCRIPTION OF LOCATION TO ENABLE RECOVERY BY OTHERS.

MON. LIES WEST OF A TALL HILL AND EAST OF A
LOW RIDGE, A SOUTHERLY BE IS 1/2-1.75 FT. EAST
OF THE MONUMENT. THE GROUND IS BARE.

SURVEYOR'S CERTIFICATE.

I, MARK C. BOGERegistered Land Surveyor No. 6196 in

the State of Nevada do hereby certify that the foregoing is a true, complete and accurate representation of the monument, or monuments, recovered, rehabilitated, restored, re-established or otherwise effected and mentioned in the foregoing Corner Record.

Date survey was completed

JULY 1, 1992

Date Corner Record filed

Mark C. Boge
Registered Land Surveyor.9-8-92

Accepted for filing on this 9th day of Sept., 1992
in the office of the County Recorder Eureka County,
State of Nevada.

142194

M. M. Reblenti
County RecorderT N, R E, Sec.

BOOK 238 PAGE 348

By Debbie Etcheberry - Deputy