

EXHIBIT "A"

The following unpatented mining claims located in Eureka County, Nevada are owned by Newmont Exploration Limited, P.O. Box 669, Carlin, Nevada 89822:

*****RECORDING DATA*****

NAME OF CLAIM/ AMENDED CLAIM NAME	COUNTY	ORIGINAL		AMENDED		BUREAU OF LAND MANAGEMENT SERIAL NUMBER	****LOCATION DESCRIPTION****			
		BOOK PAGE OR DOCUMENT #	BOOK PAGE OR DOCUMENT #	BOOK PAGE OR DOCUMENT #	BOOK PAGE OR DOCUMENT #		TNSP	RANGE	SEC	QTR
RAIN #156	ELKO	365	307			NMC 212581	31N	53E	08	SE
							31N	53E	09	SW
							31N	53E	16	NW
							31N	53E	17	NE
RAIN #157	ELKO	365	308			NMC 212582	31N	53E	08	SE
							31N	53E	09	SW
							31N	53E	16	NW
							31N	53E	17	NE
RAIN #158	ELKO	365	309			NMC 212583	31N	53E	08	SE SW
RAIN #159	ELKO	365	310			NMC 212584	31N	53E	08	SE
							31N	53E	09	SW
RAIN #160	ELKO	365	311			NMC 212585	31N	53E	08	SE SW
RAIN #161	ELKO	365	312			NMC 212586	31N	53E	08	SE
							31N	53E	09	SW
RAIN #162	ELKO	365	313			NMC 212587	31N	53E	08	SE SW
RAIN #163	ELKO	365	314			NMC 212588	31N	53E	08	SE
							31N	53E	09	SW
RAIN #164	ELKO	365	315			NMC 212589	31N	53E	08	NW NE SE SW
RAIN #165	ELKO	365	316			NMC 212590	31N	53E	08	NE SE
							31N	53E	09	NW SW
RAIN #166	ELKO	365	317			NMC 212591	31N	53E	08	NW NE
RAIN #167	ELKO	365	318			NMC 212592	31N	53E	08	NE
							31N	53E	09	NW
RAIN #168	ELKO	365	319			NMC 212593	31N	53E	08	NW NE
RAIN #169	ELKO	365	320			NMC 212594	31N	53E	08	NE
							31N	53E	09	NW
RAIN #170	ELKO	365	321			NMC 212595	31N	53E	08	NW NE
RAIN #171	ELKO	365	322			NMC 212596	31N	53E	08	NE
							31N	53E	09	NW

16

*****RECORDING DATA*****

NAME OF CLAIM/ AMENDED CLAIM NAME	COUNTY	ORIGINAL		AMENDED		BUREAU OF LAND MANAGEMENT SERIAL NUMBER	****LOCATION DESCRIPTION****			
		BOOK	PAGE	BOOK	PAGE		TNSP	RANGE	SEC	QTR
RAIN #172	ELKO	365	323			NMC 212587	31N	53E	05	SE SW
							31N	53E	08	NW NE
RAIN #173	ELKO	365	324			NMC 212588	31N	53E	04	SW
							31N	53E	05	SE
							31N	53E	08	NE
							31N	53E	09	NW

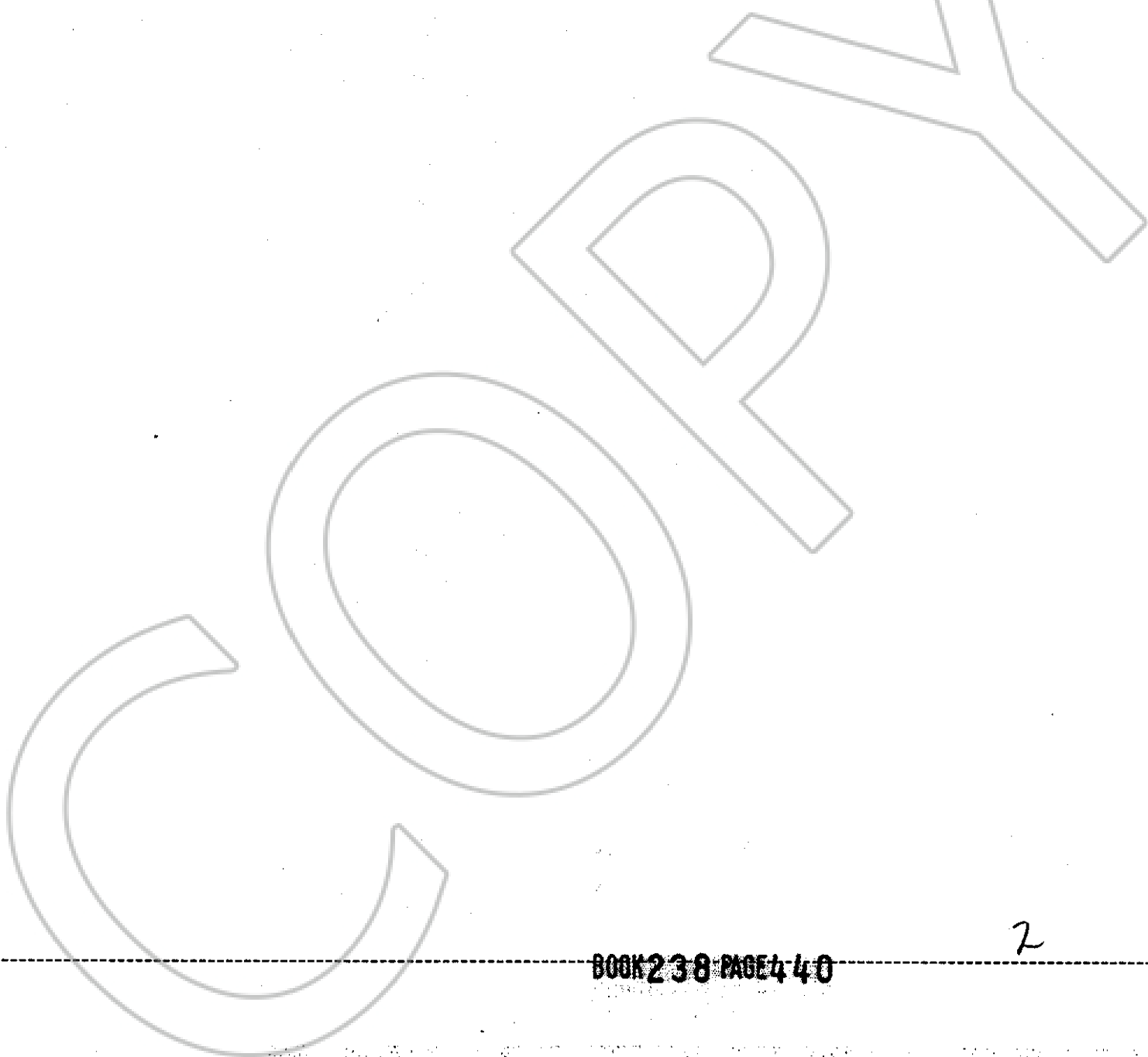

BOOK 238 PAGE 440

2

**TECHNICAL REPORT FOR 1991-1992 ASSESSMENT WORK IN SECTION 8,
T.31N., R,53E., ELKO COUNTY, NEVADA.**

This detailed report is filed in compliance with the requirement of Title 30, United States Code, section 28-1 for the Rain 156-173 contiguous unpatented claims, situated in Elko County, State of Nevada.

The assessment work consisted of a geochemical soil and rock chip survey to evaluate the potential of the claims for discovery of valuable mineral deposits thereon and to assist in planning further exploration, development, and extraction of minerals. The work was performed under the supervision of John C. Jory, Elko, Nevada, a professional geologist employed by Newmont Exploration Limited, P. O. Box 669, Carlin, Nevada 89822. The work was completed by the following individuals who are geologists employed by Newmont Exploration Limited during the work period.

Mr. John C. Jory has a Masters of Science Degree in Mineral Exploration from the Royal School of Mines, London, England, and a Bachelor of Science Degree in Geology from the University of Southampton, Southampton, England.

Mr. David B. Egerton has a Bachelor of Science Degree in Geology from the University of Wisconsin at Oshkosh.

Mr. Steven D. Farr has a Bachelor of Science Degree in Geology from Fort Hays University, Kansas.

The geochemical work consisted of 161 soil samples on a 300 X 300-foot grid and 5 rock chip samples, assayed by Chemex Labs in Sparks, Nevada, for gold, silver, arsenic, antimony and mercury.

The analytical cost of the work totals \$2,783.56 and was paid for by Newmont Exploration Limited. Labor costs are not included.

Soil assays range as follows:

gold	< 1 to 16 ppb
silver	< 0.2 ppm
arsenic	8 to 100 ppm
mercury	20 to 160 ppm
antimony	0.8 to 16 ppm

Rock chip assays range as follows:

gold	< 0.005 ppb
silver	< 0.2 ppm
arsenic	8 to 54 ppm
mercury	150 to 700 ppm
antimony	1.4 to 2.2 ppm

All technical work and results are in the possession of Newmont Exploration Limited, the owner of the subject claims.

SOIL SURVEY:

- 3008 = SOIL SAMPLES WITH PREFIX "NGSB"
- 5812 = ROCK CHIP SAMPLES WITH PREFIX "NGRA"
- ⊙ = SURVEYED LOCATION (DRILL HOLE, SECTION CORNER)

COORDINATES:

SEC CORNER (NW SEC 9): N 94654.1545 E 94847.6105
T 31 N, R 53 E.

R 311 : N 91066.35 E 95832.26

R 309 : N 90200.92 E 95236.16

*NGSB SAMPLE NUMBERS ARE CONTINUOUS FROM 1E (East Side of Survey) TO 9E (West Side of Survey)

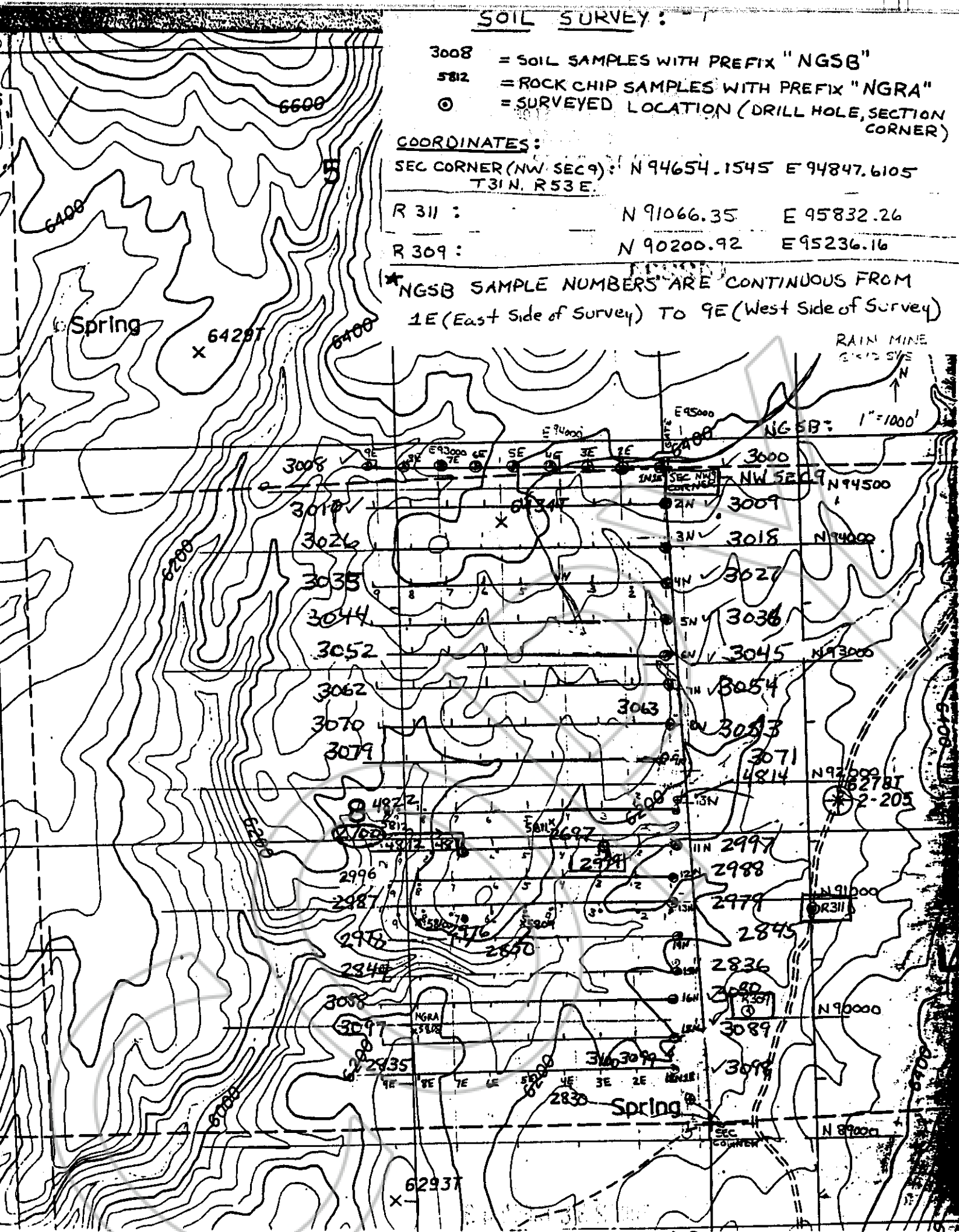

BOOK 238 PAGE 438
OFFICIAL RECORDS
RECORDED AT THE REQUEST OF
Neumont Gold
'92 SEP 16 P4 53

EUREKA COUNTY, NEVADA
M.N. REBALEATI, RECORDER
FILE NO. FEE \$ 36⁵⁰
142234

COPY

BOOK 238 PAGE 443