

BOOK 242 PAGE 440
OFFICIAL RECORDS
RECORDED AT THE REQUEST OF

Peter W. Laczay
'92 DEC -2 P3:40

EUREKA COUNTY, NEVADA
M.N. REBAL. RECORDER
FILE NO. 25

143314

Coeur d'Alene, Idaho 83816

P. O. Box 2196

LUCKY FRIDAY EXTENSION MINING CO.

By Peter W. Laczay, Agent for:

[Signature]

LUCKY FRIDAY EXTENSION MINING CO.

DATED this 29th day of September, 1992

Within 60 days after posting notice on the ground, the locator defined the boundaries of the claim as required by law and established monuments consisting of 3.5" x 3.5" wooden posts, native timber, at least 3 inch diameter PVC pipe or rock monuments. Each monument is marked with the name of the claim and a diagram or statement indicating its location. Location work consisted of making the maps in accordance with NRS 517.040, which are recorded herewith.

westerly from the NE corner of Section 35, T. 27 N., Range 52 E. E.

The monument of location is 2100 feet southerly and 1850 feet

permanent monuments so as to identify said claim, to wit:

That the following reference is hereby made to natural objects and

Thence due North	1475	feet to the North end center;
Thence due East	300	feet to the Northeast corner;
Thence due South	750	feet to the East side center;
Thence due South	750	feet to the Southeast corner;
Thence due West	600	feet to the Southwest corner;
Thence due North	750	feet to the West side center;
Thence due North	750	feet to the Northwest corner;
Thence due East	300	feet to the North end center.

Beginning at the Discovery:

This claim is described by metes and bounds as follows:

Mt. Diablo Baseline and Meridian

NE 1/4 Section 35, Township 27 N., Range 52 E.
1/4 Section _____, Township _____, Range _____

That the claim is situated all or in part in the following quarter section (s):

claim is North-South

and 25 feet in South direction from the location monument and 300 feet on each side of said lode or vein, The general course of this

The locator hereby claims 1475 feet in a North direction

EUREKA County, Nevada.

That on the 3rd day of September, 1992, the above lode mining claim was duly located in the Mineral Hill Mining District,

under and by virtue of the laws of the state of Idaho.

Agent of LUCKY FRIDAY EXTENSION MINING CO., a corporation organized & existing

Coeur d'Alene, Idaho 83814 and that I am the duly authorized Special

I, Peter W. Laczay, of lawful age, do hereby certify and declare as follows:

Of the JD 2 lode mining claim.

CERTIFICATE OF LOCATION
LODE MINING CLAIM

143314

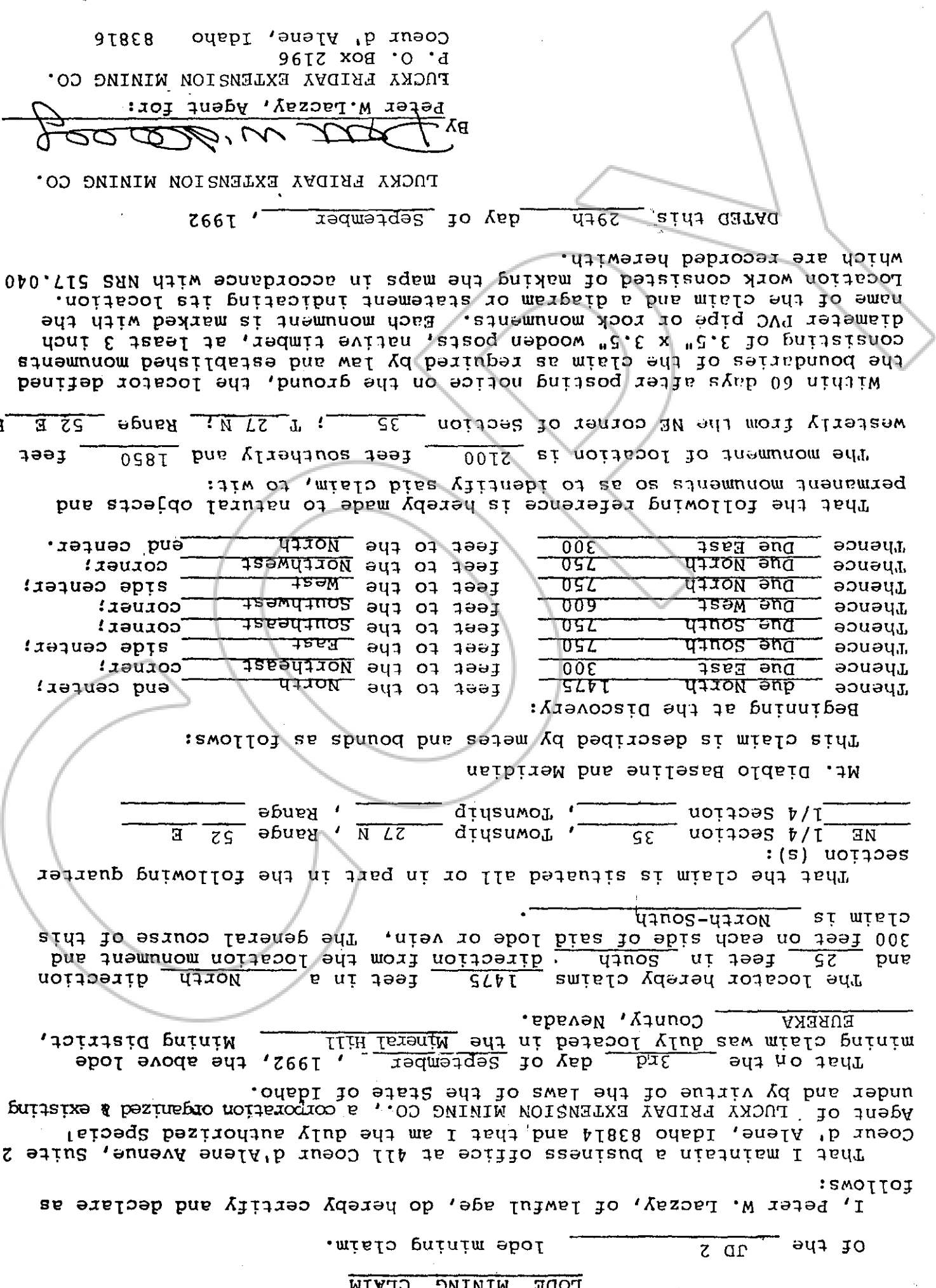

BOOK 242 PAGE 441
OFFICIAL RECORDS
RECORDED AT THE REQUEST OF

Peter Laczay
'92 DEC -2 P 340

EUREKA COUNTY, NEVADA
M.N. REBALEATI, RECORDER
FILE NO.

143315

Coeur d'Alene, Idaho 83816
P. O. Box 2196

LUCKY FRIDAY EXTENSION MINING CO.

Peter W. Laczay, Agent for:

LUCKY FRIDAY EXTENSION MINING CO.

DATED this 29th day of September, 1992

Within 60 days after posting notice on the ground, the locator defined the boundaries of the claim as required by law and established monuments consisting of 3.5" x 3.5" wooden posts, native timber, at least 3 inch diameter PVC pipe or rock monuments. Each monument is marked with the name of the claim and a diagram or statement indicating its location. Location work consisted of making the maps in accordance with NRS 517.040, which are recorded herewith.

The monument of location is 2100 feet southerly and 1250 feet westerly from the NE corner of Section 35, T 27 N, Range 52 E.

That the following reference is hereby made to natural objects and permanent monuments so as to identify said claim, to wit:

1475	feet to the North	end center;
300	feet to the Northeast	corner;
750	feet to the East	side center;
750	feet to the Southeast	corner;
600	feet to the Southwest	corner;
750	feet to the West	side center;
750	feet to the Northwest	corner;
300	feet to the North	end center.

Beginning at the Discovery:

This claim is described by metes and bounds as follows:

Mt. Diablo Baseline and Meridian

NE 1/4 Section 35, Township 27 N, Range 52 E
1/4 Section, Township, Range

section (s): That the claim is situated all or in part in the following quarter

The locator hereby claims 1475 feet in a North direction and 25 feet in South direction from the location monument and 300 feet on each side of said lode or vein, The general course of this claim is North-South.

EUREKA County, Nevada.
That on the 3rd day of September, 1992, the above lode mining claim was duly located in the Mineral Hill Mining District,

Coeur d'Alene, Idaho 83814 and that I am the duly authorized special Agent of LUCKY FRIDAY EXTENSION MINING CO., a corporation organized & existing under and by virtue of the laws of the State of Idaho.

I, Peter W. Laczay, of lawful age, do hereby certify and declare as follows:

Of the JD 3 lode mining claim.

CERTIFICATE OF LOCATION
LODE MINING CLAIM

143315

CERTIFICATE OF LOCATION
LODE MINING CLAIM

143316

Of the JD 4 lode mining claim.

follows:

That I maintain a business office at 411 Coeur d'Alene Avenue, Suite 2, Coeur d'Alene, Idaho 83814 and that I am the duly authorized Special Agent of LUCKY FRIDAY EXTENSION MINING CO., a corporation organized & existing under and by virtue of the laws of the State of Idaho.

That on the 3rd day of September, 1992, the above lode mining claim was duly located in the Mineral Hill Mining District, EUREKA County, Nevada.

The locator hereby claims 1475 feet in a North direction and 25 feet in South direction from the location monument and 300 feet on each side of said lode or vein, The general course of this claim is North-South.

That the claim is situated all or in part in the following quarter section (s):
E₂ NE 1/4 Section 35, Township 27 N, Range 52 E
1/4 Section _____, Township _____, Range _____
Mt. Diablo Baseline and Meridian

This claim is described by metes and bounds as follows:

Beginning at the Discovery:

feet to the North	1475	Thence due North	300
feet to the Northeast	300	Thence due East	750
feet to the East	750	Thence due South	750
feet to the Southeast	750	Thence due West	600
feet to the Southwest	600	Thence due North	750
feet to the West	750	Thence due North	750
feet to the Northwest	750	Thence due East	300
feet to the North	300	Thence due East	300

end center; corner; side center; East corner; Southeast corner; Southwest corner; West side center; Northwest corner; end center.

That the following reference is hereby made to natural objects and permanent monuments so as to identify said claim, to wit:

The monument of location is 2100 feet southerly and 650 feet westerly from the NE corner of Section 35, T 27 N, Range 52 E.

Within 60 days after posting notice on the ground, the locator defined the boundaries of the claim as required by law and established monuments consisting of 3.5" x 3.5" wooden posts, native timber, at least 3 inch diameter PVC pipe or rock monuments. Each monument is marked with the name of the claim and a diagram or statement indicating its location. Location work consisted of making the maps in accordance with NRS 517.040, which are recorded herewith.

DATED this 29th day of September, 1992

LUCKY FRIDAY EXTENSION MINING CO.

BY Peter W. Laczay
Peter W. Laczay, Agent for:

LUCKY FRIDAY EXTENSION MINING CO.
P. O. Box 2196
Coeur d'Alene, Idaho 83816

143316

EUREKA COUNTY, NEVADA
M.N. RE-ALERTI. RECORDER
FILE NO. _____
FEE \$/25 6-

'92 DEC -2 P 340

BOOK 242 PAGE 442
OFFICIAL RECORDS
RECORDED AT THE REQUEST OF
Peter Laczay

BOOK 242 PAGE 42

**CERTIFICATE OF LOCATION
LODE MINING CLAIM**

143317

Of the JD 5 lode mining claim.

I, Peter W. Laczay, of lawful age, do hereby certify and declare as follows:

That I maintain a business office at 411 Coeur d'Alene Avenue, Suite 2, Coeur d'Alene, Idaho, 83814 and that I am the duly authorized special Agent of LUCKY FRIDAY EXTENSION MINING CO., a corporation organized & existing under and by virtue of the laws of the State of Idaho.

That on the 3rd day of September, 1992, the above lode mining claim was duly located in the Mineral Hill Mining District, EUREKA County, Nevada.

The locator hereby claims 1475 feet in a North direction and 25 feet in South direction from the location monument and 300 feet on each side of said lode or vein, The general course of this claim is North-South.

That the claim is situated all or in part in the following quarter section (s):
E₂ NE 1/4 Section 35, Township 27 N, Range 52 E
W₂ NW 1/4 Section 36, Township 27 N, Range 52 E

Mt. Diablo Baseline and Meridian

This claim is described by metes and bounds as follows:

Beginning at the Discovery:

Thence due North	1475	feet to the North	end center;
Thence due East	300	feet to the Northeast	corner;
Thence due South	750	feet to the East	side center;
Thence due South	750	feet to the Southeast	corner;
Thence due West	600	feet to the Southwest	corner;
Thence due North	750	feet to the West	side center;
Thence due North	750	feet to the Northwest	corner;
Thence due East	300	feet to the North	end center.

That the following reference is hereby made to natural objects and permanent monuments so as to identify said claim, to wit:

The monument of location is 2100 feet southerly and 50 feet westerly from the NE corner of Section 35, T 27 N, Range 52 E.

Within 60 days after posting notice on the ground, the locator defined the boundaries of the claim as required by law and established monuments consisting of 3.5" x 3.5" wooden posts, native timber, at least 3 inch diameter PVC pipe or rock monuments. Each monument is marked with the name of the claim and a diagram or statement indicating its location. Location work consisted of making the maps in accordance with NRS 517.040, which are recorded herewith.

DATED this 29th day of September, 1992

LUCKY FRIDAY EXTENSION MINING CO.

By Peter W. Laczay, Agent for:

LUCKY FRIDAY EXTENSION MINING CO.
P. O. Box 2196
Coeur d'Alene, Idaho 83816

BOOK 242 PAGE 443
OFFICIAL RECORDS
RECORDED AT THE REQUEST OF

Peter Laczay
92 DEC -2 P 3:40

EUREKA COUNTY, NEVADA
M.N. REBALEATI, RECORDER
FILE NO.

143317

BOOK 242 PAGE 443

CERTIFICATE OF LOCATION

LODE MINING CLAIM

143318

Of the JD 7 lode mining claim.

I, Peter W. Laczay, of lawful age, do hereby certify and declare as follows:

That I maintain a business office at 411 Coeur d'Alene Avenue, Suite 2, Coeur d'Alene, Idaho 83814 and that I am the duly authorized special Agent of LUCKY FRIDAY EXTENSION MINING CO., a corporation organized & existing under and by virtue of the laws of the State of Idaho.

That on the 3rd day of September, 1992, the above lode mining claim was duly located in the Mineral Hill Mining District, EUREKA County, Nevada.

The locator hereby claims 1475 feet in a North direction and 25 feet in South direction from the location monument and 300 feet on each side of said lode or vein, The general course of this claim is North-South.

That the claim is situated all or in part in the following quarter section (s):

E ₂ E ₂	Section 35	Township 27 N	Range 52 E
W ₂ W ₂	Section 36	Township 27 N	Range 52 E

Mt. Diablo Baseline and Meridian

This claim is described by metes and bounds as follows:

Beginning at the Discovery:

Thence due North	1475	feet to the North	end center;
Thence due East	300	feet to the Northeast	corner;
Thence due South	750	feet to the East	side center;
Thence due South	750	feet to the Southeast	corner;
Thence due West	600	feet to the Southwest	corner;
Thence due North	750	feet to the West	side center;
Thence due North	750	feet to the Northwest	corner;
Thence due East	300	feet to the North	end center.

That the following reference is hereby made to natural objects and permanent monuments so as to identify said claim, to wit:

The monument of location is 3650 feet southerly and 50 feet

westerly from the NE corner of Section 35; T 27 N, Range 52 E. E.

Within 60 days after posting notice on the ground, the locator defined the boundaries of the claim as required by law and established monuments consisting of 3.5" x 3.5" wooden posts, native timber, at least 3 inch diameter PVC pipe or rock monuments. Each monument is marked with the name of the claim and a diagram or statement indicating its location. Location work consisted of making the maps in accordance with NRS 517.040, which are recorded herewith.

DATED this 29th day of September, 1992

LUCKY FRIDAY EXTENSION MINING CO.

By Peter W. Laczay Agent for:

LUCKY FRIDAY EXTENSION MINING CO.
P. O. Box 2196
Coeur d'Alene, Idaho 83816

143318

EUREKA COUNTY, NEVADA
M.N. REBALEATI, RECORDER
FILE NO. 25

'92 DEC -2 P340

BOOK 242 PAGE 444
OFFICIAL RECORDS
RECORDED AT THE REQUEST OF

Peter Laczay

BOOK 242 PAGE 444

BOOK 242 PAGE 445
OFFICIAL RECORDS
RECORDED AT THE REQUEST OF

Peter Laczay
'92 DEC -2 P3140

EUREKA COUNTY, NEVADA
M.M. REBALEATI, RECORDER
FILE NO. *6/25*

143319

CERTIFICATE OF LOCATION
LODE MINING CLAIM

JD 8 Of the

_____ lode mining claim.

143319

I, Peter W. Laczay, of lawful age, do hereby certify and declare as follows:

That I maintain a business office at 411 Coeur d'Alene Avenue, Suite 2, Coeur d'Alene, Idaho 83814 and that I am the duly authorized special Agent of LUCKY FRIDAY EXTENSION MINING CO., a corporation organized & existing under and by virtue of the laws of the State of Idaho.

That on the 5th day of September, 1992, the above lode mining claim was duly located in the Mineral Hill Mining District, EUREKA County, Nevada.

The locator hereby claims 1475 feet in a southerly direction and 25 feet in North-NW direction from the location monument and 300 feet on each side of said lode or vein, the general course of this claim is North-South.

That the claim is situated all or in part in the following quarter section (s):
SE 1/4 Section 26, Township 27 N, Range 52 E
NE 1/4 Section 35, Township 27 N, Range 52 E

Mt. Diablo Baseline and Meridian

This claim is described by metes and bounds as follows:

Beginning at the Discovery:

feet to the South	1475	feet to the South	end center;
feet to the Southeast	300	feet to the Southeast	corner;
feet to the East	750	feet to the East	side center;
feet to the Northeast	750	feet to the Northeast	corner;
feet to the Northwest	600	feet to the Northwest	corner;
feet to the West	750	feet to the West	side center;
feet to the Southwest	750	feet to the Southwest	corner;
feet to the North	300	feet to the North	end center.

That the following reference is hereby made to natural objects and permanent monuments so as to identify said claim, to wit:

The monument of location is 3500 feet southerly and 2150 feet westerly from the NE corner of Section 26; T. 27 N.; Range 52 E.

Within 60 days after posting notice on the ground, the locator defined the boundaries of the claim as required by law and established monuments consisting of 3.5" x 3.5" wooden posts, native timber, at least 3 inch diameter PVC pipe or rock monuments. Each monument is marked with the name of the claim and a diagram or statement indicating its location. Location work consisted of making the maps in accordance with NRS 517.040, which are recorded herewith.

DATED this 29th day of September, 1992

LUCKY FRIDAY EXTENSION MINING CO.

By *Peter W. Laczay*
Peter W. Laczay, Agent for:
LUCKY FRIDAY EXTENSION MINING CO.
P. O. Box 2196
Coeur d'Alene, Idaho 83816

**CERTIFICATE OF LOCATION
LODE MINING CLAIM**

143320

I, Peter W. Laczay, of lawful age, do hereby certify and declare as follows:

That I maintain a business office at 411 Coeur d'Alene Avenue, Suite 2, Coeur d'Alene, Idaho 83814 and that I am the duly authorized Special Agent of LUCKY FRIDAY EXTENSION MINING CO., a corporation organized & existing under and by virtue of the laws of the State of Idaho.

That on the 3rd day of September, 1992, the above lode mining claim was duly located in the Mineral Hill Mining District, EUREKA County, Nevada.

The locator hereby claims 1475 feet in a North direction and 25 feet in South direction from the location monument and 300 feet on each side of said lode or vein. The general course of this claim is North-South.

That the claim is situated all or in part in the following quarter section (s):
 S $\frac{1}{2}$ NE 1/4 Section 35, Township 27 N, Range 52 E
 N $\frac{1}{2}$ SE 1/4 Section 35, Township 27 N, Range 52 E

Mt. Diablo Baseline and Meridian

This claim is described by metes and bounds as follows:

Beginning at the Discovery:

Thence due North	1475	feet to the North end center;
Thence due East	300	feet to the Northeast corner;
Thence due South	750	feet to the East side center;
Thence due South	750	feet to the Southeast corner;
Thence due West	600	feet to the Southwest corner;
Thence due North	750	feet to the West side center;
Thence due North	750	feet to the Northwest corner;
Thence due East	300	feet to the North end center.

That the following reference is hereby made to natural objects and permanent monuments so as to identify said claim, to wit:

The monument of location is 3650 feet southerly and 1250 feet westerly from the NE corner of Section 35, T. 27 N., Range 52 E.

Within 60 days after posting notice on the ground, the locator defined the boundaries of the claim as required by law and established monuments consisting of 3.5" x 3.5" wooden posts, native timber, at least 3 inch diameter PVC pipe or rock monuments. Each monument is marked with the name of the claim and a diagram or statement indicating its location. Location work consisted of making the maps in accordance with NRS 517.040, which are recorded herewith.

DATED this 29th day of September, 1992

LUCKY FRIDAY EXTENSION MINING CO.

By Peter W. Laczay
 Peter W. Laczay, Agent for:

LUCKY FRIDAY EXTENSION MINING CO.
 P. O. Box 2196
 Coeur d'Alene, Idaho 83816

BOOK 242 PAGE 446
 OFFICIAL RECORDS
 RECORDED AT THE REQUEST OF
 Peter Laczay
 '92 DEC -2 11:40
 EUREKA COUNTY, NEVADA
 M.N. REBALEATI, RECORDER
 FILE NO. FEE \$ 25
143320

BOOK 242 PAGE 446

**CERTIFICATE OF LOCATION
LODE MINING CLAIM**

143321

Of the PEPE 82 lode mining claim.

I, Peter W. Laczay, of lawful age, do hereby certify and declare as follows:

That I maintain a business office at 411 Coeur d'Alene Avenue, Suite 2, Coeur d'Alene, Idaho 83814 and that I am the duly authorized Special Agent of LUCKY FRIDAY EXTENSION MINING CO., A corporation organized & existing under and by virtue of the laws of the State of Idaho.

That on the 3rd day of September, 1992, the above lode mining claim was duly located in the Mineral Hill Mining District, EUREKA County, Nevada.

The locator hereby claims 1475 feet in a southerly direction and 25 feet in northerly direction from the location monument and 300 feet on each side of said lode or vein, the general course of this claim is North-South.

That the claim is situated all or in part in the following quarter section (s):
SE 1/4 Section 35, Township 27 N., Range 52 E
NW 1/4 Section 35, Township 27 N., Range 52 E

MT. Diablo Baseline and Meridian

This claim is described by metes and bounds as follows:

Beginning at the Discovery:

Thence due South	1475	feet to the South	end center;
Thence due east	300	feet to the Southeast	corner;
Thence due north	750	feet to the East	side center;
Thence due north	750	feet to the Northeast	corner;
Thence due west	600	feet to the Northwest	corner;
Thence due south	750	feet to the West	side center;
Thence due south	750	feet to the Southwest	corner;
Thence due east	300	feet to the North	end center.

That the following reference is hereby made to natural objects and permanent monuments so as to identify said claim, to wit:

The monument of location is 3700 feet southerly and 1250 feet

westerly from the NE corner of Section 35; T. 27 N.; Range 52 E.

Within 60 days after posting notice on the ground, the locator defined the boundaries of the claim as required by law and established monuments consisting of 3.5" x 3.5" wooden posts, native timber, at least 3 inch diameter PVC pipe or rock monuments. Each monument is marked with the name of the claim and a diagram or statement indicating its location. Location work consisted of making the maps in accordance with NRS 517.040, which are recorded herewith.

DATED this 29th day of September, 1992

LUCKY FRIDAY EXTENSION MINING CO.

By Peter W. Laczay
Peter W. Laczay, Agent for:

LUCKY FRIDAY EXTENSION MINING CO.

P. O. Box 2196
Coeur d'Alene, Idaho 83816

BOOK 242 PAGE 47

BOOK 242 PAGE 477
OFFICIAL RECORDS
RECORDED AT THE REQUEST OF

Peter Laczay
'92 DEC -2 PG 40

EUREKA COUNTY, NEVADA
M.N. REBALEATI, RECORDER
FILE NO.

143321

BOOK 242 PAGE 448
OFFICIAL RECORDS
RECORDED AT THE REQUEST OF

Peter Laczay
'92 DEC -2 P 5140

EUREKA COUNTY, NEVADA
M.N. REBAL EATL. RECORDER
FILE NO.

143322

CERTIFICATE OF LOCATION
LODE MINING CLAIM

Of the PETE 83 lode mining claim.

143322

I, Peter W. Laczay, of lawful age, do hereby certify and declare as follows:

That I maintain a business office at 411 Coeur d'Alene Avenue, Suite 2, Coeur d'Alene, Idaho 83814 and that I am the duly authorized Special Agent of LUCKY FRIDAY EXTENSION MINING CO., a corporation organized & existing under and by virtue of the laws of the state of Idaho.

That on the 3rd day of September, 1992, the above lode mining claim was duly located in the Mineral Hill Mining District, EUREKA County, Nevada.

The locator hereby claims 1475 feet in a North direction and 25 feet in South direction from the location monument and 300 feet on each side of said lode or vein, The general course of this claim is North-South.

That the claim is situated all or in part in the following quarter section (s):
S $\frac{1}{2}$ NE 1/4 Section 35, Township 27 N, Range 52 E
N $\frac{1}{2}$ SE 1/4 Section 35, Township 27 N, Range 52 E

Mt. Diablo Baseline and Meridian

This claim is described by metes and bounds as follows:

Beginning at the Discovery:

Thence due North	1475	feet to the North	end center;
Thence due East	300	feet to the Northeast	corner;
Thence due South	750	feet to the East	side center;
Thence due South	750	feet to the Southeast	corner;
Thence due West	600	feet to the Southwest	corner;
Thence due North	750	feet to the West	side center;
Thence due North	750	feet to the Northwest	corner;
Thence due East	300	feet to the North	end center.

That the following reference is hereby made to natural objects and permanent monuments so as to identify said claim, to wit:

The monument of location is 3650 feet southerly and 650 feet

westerly from the NE corner of Section 35, T. 27 N., Range 52 E. E.

Within 60 days after posting notice on the ground, the locator defined the boundaries of the claim as required by law and established monuments consisting of 3.5" x 3.5" wooden posts, native timber, at least 3 inch diameter PVC pipe or rock monuments. Each monument is marked with the name of the claim and a diagram or statement indicating its location. Location work consisted of making the maps in accordance with NRS 517.040, which are recorded herewith.

DATED this 29th day of September, 1992

LUCKY FRIDAY EXTENSION MINING CO.

By Peter W. Laczay
Peter W. Laczay, Agent for:

LUCKY FRIDAY EXTENSION MINING CO.

P. O. Box 2196

Coeur d'Alene, Idaho 83816

CERTIFICATE OF LOCATION
LODE MINING CLAIM

Of the PETE 84 lode mining claim.

143323

I, Peter W. Laczay, of lawful age, do hereby certify and declare as follows:

That I maintain a business office at 411 Coeur d'Alene Avenue, Suite 2, Coeur d'Alene, Idaho 83814 and that I am the duly authorized Special Agent of LUCKY FRIDAY EXTENSION MINING CO., A corporation organized & existing under and by virtue of the laws of the State of Idaho.

That on the 3rd day of September, 1992, the above lode mining claim was duly located in the Mineral Hill Mining District, EUREKA County, Nevada.

The locator hereby claims 1475 feet in a southerly direction and 25 feet in northerly direction from the location monument and 300 feet on each side of said lode or vein, the general course of this claim is North-South.

That the claim is situated all or in part in the following quarter section (s):

SE 1/4 Section 35, Township 27 N, Range 52 E
NW 1/4 Section _____, Township _____, Range _____

Mt. Diablo Baseline and Meridian

This claim is described by metes and bounds as follows:

Beginning at the Discovery:

Thence due south	1475	feet to the South	end center;
Thence due east	300	feet to the Southeast	corner;
Thence due north	750	feet to the East	side center;
Thence due north	750	feet to the Southeast	corner;
Thence due west	600	feet to the Northeast	corner;
Thence due south	750	feet to the Northwest	corner;
Thence due south	750	feet to the West	side center;
Thence due south	750	feet to the Southwest	corner;
Thence due east	300	feet to the North	end center.

That the following reference is hereby made to natural objects and permanent monuments so as to identify said claim, to wit:

The monument of location is 3650 feet southerly and 650 feet

westerly from the NE corner of Section 35, T. 27 N., Range 52 E.

Within 60 days after posting notice on the ground, the locator defined the boundaries of the claim as required by law and established monuments consisting of 3.5" x 3.5" wooden posts, native timber, at least 3 inch diameter PVC pipe or rock monuments. Each monument is marked with the name of the claim and a diagram or statement indicating its location. Location work consisted of making the maps in accordance with NRS 517.040, which are recorded herewith.

DATED this 29th day of September, 1992

LUCKY FRIDAY EXTENSION MINING CO.

By Peter W. Laczay
Peter W. Laczay, Agent for:

LUCKY FRIDAY EXTENSION MINING CO.

P. O. Box 2196

Coeur d'Alene, Idaho 83816

BOOK 242 PAGE 449
OFFICIAL RECORDS
RECORDED AT THE REQUEST OF

Peter Laczay
'92 DEC -2 P3:40

EUREKA COUNTY, NEVADA
M.N. REBALEATI, RECORDER
FILE NO. _____

143323

BOOK 242 PAGE 449