

R. 50 E. —
R. 51 E. —

T. 36 N.
T. 35 N.

R. 50 E. —
R. 51 E. —

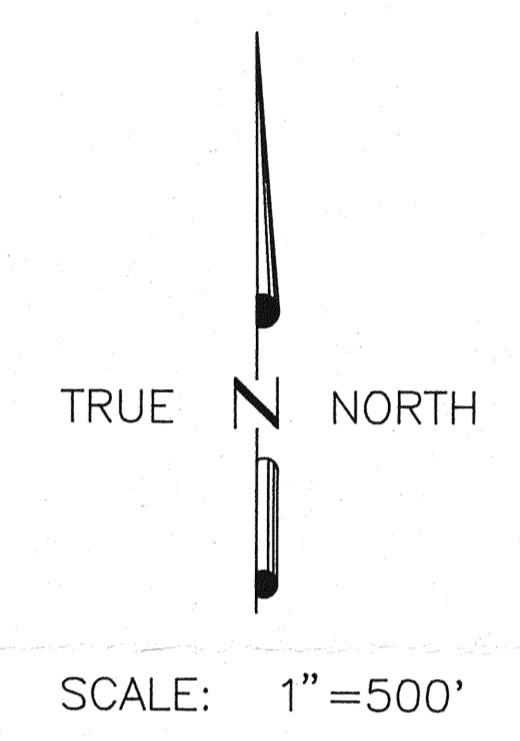

LEGEND

- ⊠ 3 1/2" x 3 1/2" x 4" WOOD POST LOCATION MONUMENT
- 3 1/2" x 3 1/2" x 4" WOOD POST MONUMENT
- ○ INDICATES SECTION CORNER

LOCATION DATES

OCTOBER 23, 1992 1-38

NOTES

- 1.) ALL CLAIMS ARE 600' X 1500' UNLESS OTHERWISE SHOWN
- 2.) LOCATION MONUMENTS ARE 10' FROM END LINE OF CLAIM UNLESS OTHERWISE SHOWN.

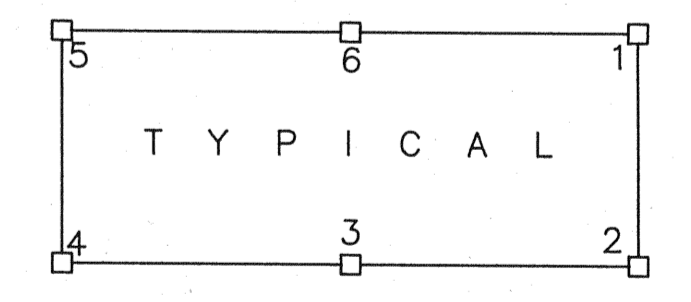
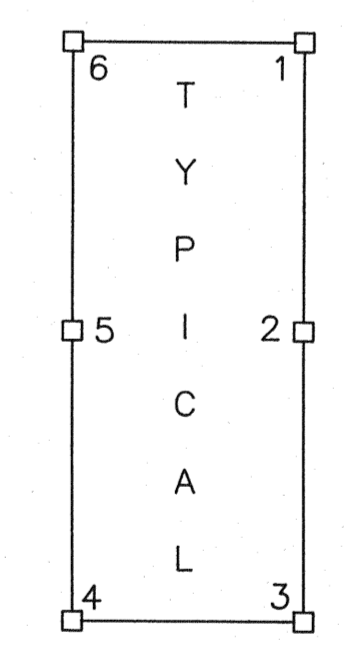

ON THE REQUEST OF *Newmont Exploration*
 Jan 11 1993, at 5 mins, past 112 W.
 RECORDS OF EUREKA COUNTY, NEVADA M. N. REBALEATI, Recorder
 File No. 143508 Fee \$ 570

MAP OF THE
ROVR LODGE MINING CLAIMS
 Eureka County, Nevada

SECTIONS 5, 6, 7 & 8, T. 35 N., R. 51 E.;
 SECTIONS 31 & 32, T. 36 N., R. 51 E.;
 SECTION 1, T. 35 N., R. 50 E.;
 SECTION 34, T. 36 N., R. 50 E.; M.D.P.M.
 Located by Robert W. Schlichting
 AGENT FOR

NEWMONT EXPLORATION LIMITED

P.O. Box 669
 Carlin, Nevada 89822
 October 26, 1992