

Return to:

Newmont Exploration Limited  
P. O. Box 669  
Carlin, Nevada 89822

143587

CERTIFICATE OF LOCATION  
LODE MINING CLAIM

TO ALL WHOM IT MAY CONCERN:

The undersigned hereby certifies that he has caused to be located the MANX 4 Lode Mining Claim on the 26th day of October, 1992.

The name and address of the locator is:

Newmont Exploration Limited  
P. O. Box 669  
Carlin, Nevada 89822

Said claim is located in the following quarter section(s):

- NE 1/4 of Section \_\_\_\_\_ Township 34 N., Range 50 E.
  - NW 1/4 of Section 28, Township 34 N., Range 50 E.
  - SE 1/4 of Section \_\_\_\_\_ Township 34 N., Range 50 E.
  - SW 1/4 of Section \_\_\_\_\_ Township 34 N., Range 50 E.
- Mount Diablo Base Line and Meridian, Eureka County, Nevada.

To tie this claim to the public survey, begin at the NE corner of Section 28, T. 34 N., R. 50 E., MDB&M, and travel:

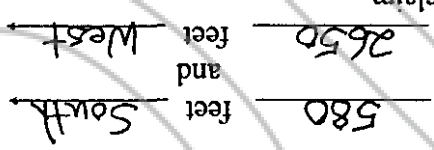

to the northeast corner of the claim.  
The claim is 1400 feet long and 600 feet wide, such that 1380 feet is claimed in an East direction and 20 feet is claimed in a West direction from the location monument, together with 300 feet on each side of the monument of location and center line of the claim. The general course of the claim is East to West.

The boundaries of this claim are monumented with 4 inch by 4 inch by 4 1/2 foot long wooden posts. Each monument is marked with a scribed metal tag, which states the claim name and number, and the location of the monument with respect to the claim.

To locate the monuments, begin at the northeast corner of the claim and travel:

- 600 feet South to the southeast corner, thence
- 700 feet West to the south side-center, thence
- 700 feet West to the southwest corner, thence
- 600 feet North to the northwest corner, thence
- 700 feet East to the north side-center, thence
- 700 feet East to the northeast corner of the claim.

The location work included the making of a claim map as provided in NRS 517.040, a copy of which is filed with the county recorder.

Dated this 30th day of November, 1992.

*Matthew B. Powell*

Matthew B. Powell, agent for:  
Newmont Exploration Limited  
P. O. Box 669  
Carlin, Nevada 89822

EUREKA COUNTY, NEVADA  
M.N. REBALEATI, RECORDER  
FILE NO. 143587  
FEE \$ 6.25

'93 JAN 13 P1:49

BOOK 243 PAGE 285  
OFFICIAL RECORDS  
RECORDED AT THE REQUEST OF  
*Newmont Exploration*