

BOOK 243 PAGE 428
OFFICIAL RECORDS
RECORDED AT THE REQUEST OF
Newmont Exploration

'93 JAN 14 P 3:09

EUREKA COUNTY, NEVADA
M.N. REBATEATI. RECORDER
FILE NO. 143719

BOOK 243 PAGE 428

Carlin, Nevada 89822
P.O. Box 669
Newmont Exploration Limited

Matthew B. Powell, agent for:
Matthew B. Powell

Dated this 30th day of November, 1992.

The location work included the making of a claim map as provided in NRS 517.040, a copy of which is filed with the county recorder.

600 feet South to the southeast corner, thence
725 feet West to the south side-center, thence
725 feet West to the southwest corner, thence
600 feet North to the northwest corner, thence
725 feet East to the north side-center, thence
725 feet East to the northeast corner of the claim.

To locate the monuments, begin at the northeast corner of the claim and travel:

The boundaries of this claim are monumented with 4 inch by 4 inch by 4 1/2 foot long wooden posts. Each monument is marked with a scribed metal tag, which states the claim name and number, and the location of the monument with respect to the claim.

The claim is 1450 feet long and 600 feet wide, such that 1430 feet is claimed in an East direction and 20 feet is claimed in a West direction from the location monument, together with 300 feet on each side of the monument of location and center line of the claim. The general course of the claim is East to West.

to the northeast corner of the claim.

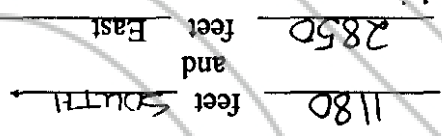

R. 50 E., MDB&M, and travel:

To tie this claim to the public survey, begin at the NW corner of Section 26, T. 34 N.,

Mount Diablo Base Line and Meridian, Eureka County, Nevada.

- NE 1/4 of Section 26, Township 34 N., Range 50 E.
- NW 1/4 of Section 26, Township 34 N., Range 50 E.
- SE 1/4 of Section 34 N., Range 50 E.
- SW 1/4 of Section 34 N., Range 50 E.

Said claim is located in the following quarter section(s):

Newmont Exploration Limited
P.O. Box 669
Carlin, Nevada 89822

The name and address of the locator is:

Mining Claim on the 27th day of October, 1992.

The undersigned hereby certifies that he has caused to be located the ABBY 6 Lode

TO ALL WHOM IT MAY CONCERN:

CERTIFICATE OF LOCATION
LODE MINING CLAIM

143719

Newmont Exploration Limited
P.O. Box 669
Carlin, Nevada 89822

Return to: