

R 50 E

THE POINT:  
The NE corner of BURM 2 is located 20' North of  
the North 1/4 corner of Section 34 T34N, R50E.

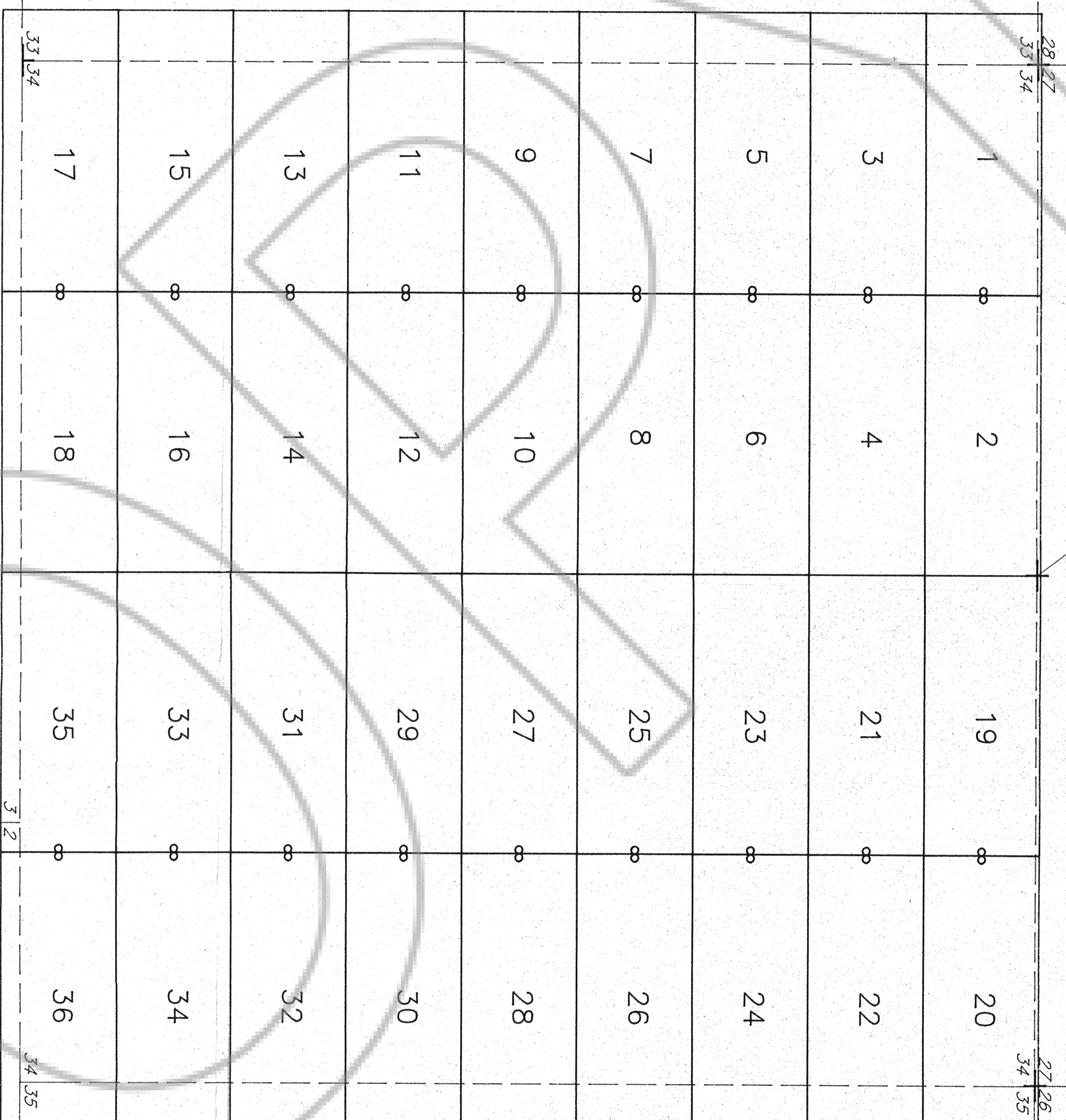

LOCATOR:  
NEWMONT EXPLORATION LIMITED  
P.O. Box 669  
Carlin, Nevada 89822

LOCATION:  
Section 34 T34N, R50E  
Mount Diablo Base Line and Meridian  
Eureka County, Nevada

THE POINT:  
The NE corner of BURM 2 is located 20' North of  
the North 1/4 corner of Section 34 T34N, R50E.

TYPICAL CLAIMS

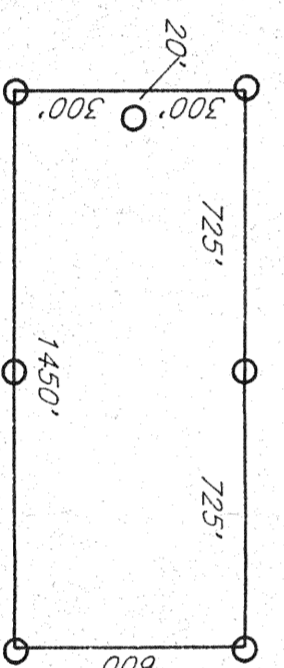

Magnetic Declination 16.5°E

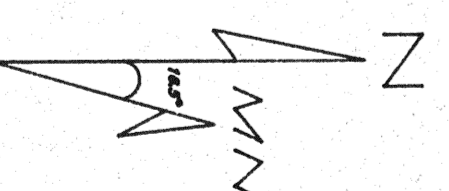

FILED AT THE REQUEST OF  
*Neumont Exploration*  
JAN 14 1993  
OFFICE OF EUREKA COUNTY, NEVADA, MINING RECLAMATION DIVISION  
FILE NO. 143780 Fee \$ 550

500 0 500 1000 FEET

**BIG CREEK  
EXPLORATION SERVICES**

**BURM 1-36 LODE MINING CLAIMS**

December 1, 1992 Located: 10/27-10/29/92 Drawn By: GH  
Completed: 11/19/92 Revised:  
5130 Slope Drive, Sun Valley, Nevada 89433 • (702) 674-2708

+ Found Section Corner

All posts are 4"x4"x4' wooden posts.  
All claims are 1450' x 600'.  
Location Monuments are 20' in from end center.