

Return to:

Newmont Exploration Limited
P.O. Box 669
Carlin, Nevada 89822

143790

CERTIFICATE OF LOCATION
LODE MINING CLAIM

TO ALL WHOM IT MAY CONCERN:

The undersigned hereby certifies that he has caused to be located the HIMI / Lode Mining Claim on the 25th day of October, 1992.

The name and address of the locator is:

Newmont Exploration Limited
P.O. Box 669
Carlin, Nevada 89822

Said claim is located in the following quarter section(s):

NE 1/4 of Section 21, Township 34 N., Range 50 E.
NW 1/4 of Section 22, Township 34 N., Range 50 E.
SE 1/4 of Section 16, Township 34 N., Range 50 E.
SW 1/4 of Section 15, Township 34 N., Range 50 E.
Mount Diablo Base Line and Meridian, Eureka County, Nevada.

To tie this claim to the public survey, begin at the SW corner of Section 22, T. 34' N., R. 50 E., MDB&M, and travel:

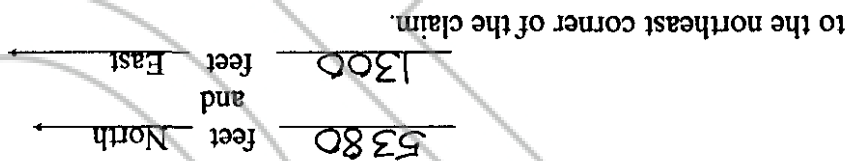

The claim is 1450 feet long and 600 feet wide, such that 20 feet is claimed in an East direction and 1430 feet is claimed in a West direction from the location monument, together with 300 feet on each side of the monument of location and center line of the claim. The general course of the claim is East to West.

The boundaries of this claim are monumented with 4 inch by 4 inch by 4 1/2 foot long wooden posts. Each monument is marked with a scribed metal tag, which states the claim name and number, and the location of the monument with respect to the claim.

To locate the monuments, begin at the northeast corner of the claim and travel:

600 feet South to the southeast corner, thence
725 feet West to the south side-center, thence
725 feet West to the southwest corner, thence
600 feet North to the northwest corner, thence
725 feet East to the north side-center, thence
725 feet East to the northeast corner of the claim.

The location work included the making of a claim map as provided in NRS 517.040, a copy of which is filed with the county recorder.

Dated this 30th day of November, 1992.

Matthew B. Powell
Matthew B. Powell, agent for:

Newmont Exploration Limited
P.O. Box 669
Carlin, Nevada 89822

BOOK 243 PAGE 503

BOOK 243 PAGE 503
OFFICIAL RECORDS
RECORDED AT THE REQUEST OF

Newmont Exploration
93 JAN 14 P5:00

EUREKA COUNTY, NEVADA
M.N. REBALEATI, RECORDER
FILE NO. 143790
FEE \$ 6.25

BOOK 243 PAGE 504
 OFFICIAL RECORDS
 RECORDED AT THE REQUEST OF
Newmont Exploration
 '93 JAN 14 P5:00

EUREKA COUNTY, NEVADA
 M.N. REBALEATI, RECORDER
 FILE NO. 625

143791

BOOK 243 PAGE 504

Mathew B. Powell, agent for:
 Newmont Exploration Limited
 P.O. Box 669
 Carlin, Nevada 89822

Mathew B. Powell

Dated this 30th day of November, 1992.

The location work included the making of a claim map as provided in NRS 517.040, a copy of which is filed with the county recorder.

600 feet South to the southeast corner, thence
 725 feet West to the south side-center, thence
 725 feet West to the southwest corner, thence
 600 feet North to the northwest corner, thence
 725 feet East to the north side-center, thence
 725 feet East to the northeast corner of the claim.

To locate the monuments, begin at the northeast corner of the claim and travel:

The boundaries of this claim are monumented with 4 inch by 4 inch by 4 1/2 foot long wooden posts. Each monument is marked with a scribed metal tag, which states the claim name and number, and the location of the monument with respect to the claim.

The claim is 1450 feet long and 600 feet wide, such that 1430 feet is claimed in an East direction and 20 feet is claimed in a West direction from the location monument, together with 300 feet on each side of the monument of location and center line of the claim. The general course of the claim is East to West.

to the northeast corner of the claim.

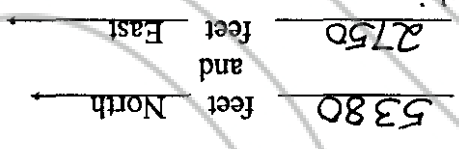

To tie this claim to the public survey, begin at the SW corner of Section 22, T. 34 N., R. 50 E., MDB&M, and travel:

Mount Diablo Base Line and Meridian, Eureka County, Nevada.
 NE 1/4 of Section 22, Township 34 N., Range 50 E.
 NW 1/4 of Section 22, Township 34 N., Range 50 E.
 SE 1/4 of Section 15, Township 34 N., Range 50 E.
 SW 1/4 of Section 15, Township 34 N., Range 50 E.

Said claim is located in the following quarter section(s):

Newmont Exploration Limited
 P.O. Box 669
 Carlin, Nevada 89822

The name and address of the locator is:

The undersigned hereby certifies that he has caused to be located the HMM 2 Lode Mining Claim on the 25th day of October, 1992.

TO ALL WHOM IT MAY CONCERN:

CERTIFICATE OF LOCATION
 LODGE MINING CLAIM

Newmont Exploration Limited
 P.O. Box 669
 Carlin, Nevada 89822

143791

Return to:

Return to:

Newmont Exploration Limited
P. O. Box 669
Carlin, Nevada 89822

CERTIFICATE OF LOCATION
LODE MINING CLAIM

143792

TO ALL WHOM IT MAY CONCERN:

The undersigned hereby certifies that he has caused to be located the H.M.L. 3 Lode Mining Claim on the 25th day of October, 1992.

The name and address of the locator is:

Newmont Exploration Limited
P. O. Box 669
Carlin, Nevada 89822

Said claim is located in the following quarter section(s):

NE 1/4 of Section 21, Township 34 N., Range 50 E.
NW 1/4 of Section 22, Township 34 N., Range 50 E.
SE 1/4 of Section _____, Township 34 N., Range 50 E.
SW 1/4 of Section _____, Township 34 N., Range 50 E.
Mount Diablo Base Line and Meridian, Eureka County, Nevada.

To tie this claim to the public survey, begin at the SW corner of Section 22, T 34 N. R. 50 E., MDB&M, and travel:

4780 feet North
and
1300 feet East

to the northeast corner of the claim.

The claim is 1450 feet long and 600 feet wide, such that 20 feet is claimed in an East direction and 1430 feet is claimed in a West direction from the location monument, together with 300 feet on each side of the monument of location and center line of the claim. The general course of the claim is East to West.

The boundaries of this claim are monumented with 4 inch by 4 inch by 4 1/2 foot long wooden posts. Each monument is marked with a scribed metal tag, which states the claim name and number, and the location of the monument with respect to the claim.

To locate the monuments, begin at the northeast corner of the claim and travel:

600 feet South to the southeast corner, thence
725 feet West to the south side-center, thence
725 feet West to the southwest corner, thence
600 feet North to the northwest corner, thence
725 feet East to the north side-center, thence
725 feet East to the northeast corner of the claim.

The location work included the making of a claim map as provided in NRS 517.040, a copy of which is filed with the county recorder.

Dated this 30th day of November, 1992.

Matthew B. Powell

Matthew B. Powell, agent for:
Newmont Exploration Limited
P. O. Box 669
Carlin, Nevada 89822

BOOK 243 PAGE 505

BOOK 243 PAGE 505
OFFICIAL RECORDS
RECORDED AT THE REQUEST OF
Newmont Exploration
'93 JAN 14 P 5:00

EUREKA COUNTY, NEVADA
M.N. REBALEATI, RECORDER
FILE NO. 625
143792

Return to:

Newmont Exploration Limited
P.O. Box 669
Carlin, Nevada 89822

143793

**CERTIFICATE OF LOCATION
LODE MINING CLAIM**

TO ALL WHOM IT MAY CONCERN:

The undersigned hereby certifies that he has caused to be located the HIMI 4 Lode Mining Claim on the 25th day of October, 1992.

The name and address of the locator is:

Newmont Exploration Limited
P.O. Box 669
Carlin, Nevada 89822

Said claim is located in the following quarter section(s):

NE 1/4 of Section 34 N., Range 50 E.
NW 1/4 of Section 34 N., Range 50 E.
SE 1/4 of Section 34 N., Range 50 E.
SW 1/4 of Section 34 N., Range 50 E.

Mount Diablo Base Line and Meridian, Eureka County, Nevada.

To tie this claim to the public survey, begin at the SW corner of Section 22, T. 34 N., R. 50 E., MDB&M, and travel:

4780 feet North
and
2750 feet East

to the northeast corner of the claim.

The claim is 1450 feet long and 600 feet wide, such that 1430 feet is claimed in an East direction and 20 feet is claimed in a West direction from the location monument, together with 300 feet on each side of the monument of location and center line of the claim. The general course of the claim is East to West.

The boundaries of this claim are monumented with 4 inch by 4 inch by 4 1/2 foot long wooden posts. Each monument is marked with a scribed metal tag, which states the claim name and number, and the location of the monument with respect to the claim.

To locate the monuments, begin at the northeast corner of the claim and travel:

600 feet South to the southeast corner, thence
725 feet West to the south side-center, thence
725 feet West to the southwest corner, thence
600 feet North to the northwest corner, thence
725 feet East to the north side-center, thence
725 feet East to the northeast corner of the claim.

The location work included the making of a claim map as provided in NRS 517.040 as copy of which is filed with the county recorder.

Dated this 30th day of November, 1992.

Matthew B. Powell

Matthew B. Powell, agent for:
Newmont Exploration Limited
P.O. Box 669
Carlin, Nevada 89822

143793

EUREKA COUNTY, NEVADA
M.N. REBALEATI, RECORDER
FILE NO. 25
517.040

'93 JAN 14 P5:00

BOOK 243 PAGE 506
OFFICIAL RECORDS
RECORDED AT THE REQUEST OF
Newmont Exploration

BOOK 243 PAGE 506

Return to:

Newmont Exploration Limited
P.O. Box 669
Carlin, Nevada 89822

143794

**CERTIFICATE OF LOCATION
LODE MINING CLAIM**

TO ALL WHOM IT MAY CONCERN:

The undersigned hereby certifies that he has caused to be located the HIMM 5 Lode Mining Claim on the 25th day of October, 1992.

The name and address of the locator is:

Newmont Exploration Limited
P.O. Box 669
Carlin, Nevada 89822

Said claim is located in the following quarter section(s):

NE 1/4 of Section 21, Township 34 N., Range 50 E.
NW 1/4 of Section 22, Township 34 N., Range 50 E.
SE 1/4 of Section _____, Township 34 N., Range 50 E.
SW 1/4 of Section _____, Township 34 N., Range 50 E.
Mount Diablo Base Line and Meridian, Eureka County, Nevada.

To tie this claim to the public survey, begin at the SW corner of Section 22, T 34 N., R. 50 E., MDB&M, and travel:

4180 feet North
and
1300 feet East

to the northeast corner of the claim.

The claim is 1450 feet long and 600 feet wide, such that 20 feet is claimed in an East direction and 1430 feet is claimed in a West direction from the location monument, together with 300 feet on each side of the monument of location and center line of the claim. The general course of the claim is East to West.

The boundaries of this claim are monumented with 4 inch by 4 inch by 4 1/2 foot long wooden posts. Each monument is marked with a scribed metal tag, which states the claim name and number, and the location of the monument with respect to the claim.

To locate the monuments, begin at the northeast corner of the claim and travel:

600 feet South to the southeast corner, thence
725 feet West to the south side-center, thence
725 feet West to the southwest corner, thence
600 feet North to the northwest corner, thence
725 feet East to the north side-center, thence
725 feet East to the northeast corner of the claim.

The location work included the making of a claim map as provided in NRS 517.040, a copy of which is filed with the county recorder.

Dated this 30th day of November, 1992.

Matthew B. Powell

Matthew B. Powell, agent for:
Newmont Exploration Limited
P.O. Box 669
Carlin, Nevada 89822

BOOK 243 PAGE 507

BOOK 243 PAGE 507
OFFICIAL RECORDS
RECORDED AT THE REQUEST OF
Newmont Exploration
'93 JAN 14 P5:00

EUREKA COUNTY, NEVADA
M.N. REBAL EATI. RECORDER
FILE NO. 6-25

143794

Return to:

Newmont Exploration Limited
P.O. Box 669
Carlin, Nevada 89822

143795

CERTIFICATE OF LOCATION
LODE MINING CLAIM

TO ALL WHOM IT MAY CONCERN:

The undersigned hereby certifies that he has caused to be located the HILL & Lode Mining Claim on the 25th day of October, 1992.

The name and address of the locator is:

Newmont Exploration Limited
P.O. Box 669
Carlin, Nevada 89822

Said claim is located in the following quarter section(s):

NE 1/4 of Section	34 N., Range	50 E.
NW 1/4 of Section	34 N., Range	50 E.
SE 1/4 of Section	34 N., Range	50 E.
SW 1/4 of Section	34 N., Range	50 E.

Mount Diablo Base Line and Meridian, Eureka County, Nevada.

To tie this claim to the public survey, begin at the SW corner of Section 22, T 34 N., R. 50 E., MDB&M, and travel:

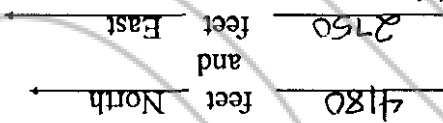

The claim is 1450 feet long and 600 feet wide, such that 1430 feet is claimed in an East direction and 20 feet is claimed in a West direction from the location monument, together with 300 feet on each side of the monument of location and center line of the claim. The general course of the claim is East to West.

The boundaries of this claim are monumented with 4 inch by 4 inch by 1/2 foot long wooden posts. Each monument is marked with a scribed metal tag, which states the claim name and number, and the location of the monument with respect to the claim.

To locate the monuments, begin at the northeast corner of the claim and travel:

600 feet South to the southeast corner, thence
 725 feet West to the south side-center, thence
 725 feet West to the southwest corner, thence
 600 feet North to the northwest corner, thence
 725 feet East to the north side-center, thence
 725 feet East to the northeast corner of the claim.

The location work included the making of a claim map as provided in NRS 517.040, a copy of which is filed with the county recorder.

Dated this 30th day of November, 1992.

Matthew B. Powell

Matthew B. Powell, agent for:
Newmont Exploration Limited
P.O. Box 669
Carlin, Nevada 89822

BOOK 243 PAGE 508

BOOK 243 PAGE 508
OFFICIAL RECORDS
RECORDED AT THE REQUEST OF
Newmont Exploration
'93 JAN 14 P5:00

EUREKA COUNTY, NEVADA
M.N. REBALEATI, RECORDER
FILE NO. 625

143795

BOOK 243 PAGE 507
OFFICIAL RECORDS
RECORDED AT THE REQUEST OF

Newmont Exploration

'93 JAN 14 P5:00

EUREKA COUNTY, NEVADA
M.N. REBALEATI, RECORDER
FILE NO. 625

143796

BOOK 243 PAGE 509

Newmont Exploration Limited
P.O. Box 669
Carlin, Nevada 89822

143796

CERTIFICATE OF LOCATION
LODE MINING CLAIM

TO ALL WHOM IT MAY CONCERN:

The undersigned hereby certifies that he has caused to be located the HIMAL 7 Lode Mining Claim on the 25th day of October, 1992.

The name and address of the locator is:

Newmont Exploration Limited
P.O. Box 669
Carlin, Nevada 89822

Said claim is located in the following quarter section(s):

NE 1/4 of Section 21, Township 34 N., Range 50 E.
NW 1/4 of Section 22, Township 34 N., Range 50 E.
SE 1/4 of Section 34 N., Range 50 E.
SW 1/4 of Section 34 N., Range 50 E.
Mount Diablo Base Line and Meridian, Eureka County, Nevada.

To tie this claim to the public survey, begin at the SW corner of Section 22, T. 34 N., R. 50 E., MDB&M, and travel:

3580 feet North
and
1300 feet East

to the northeast corner of the claim.

The claim is 1450 feet long and 600 feet wide, such that 20 feet is claimed in an East direction and 1430 feet is claimed in a West direction from the location monument, together with 300 feet on each side of the monument of location and center line of the claim. The general course of the claim is East to West.

The boundaries of this claim are monumented with 4 inch by 4 inch by 4 1/2 foot long wooden posts. Each monument is marked with a scribed metal tag, which states the claim name and number, and the location of the monument with respect to the claim.

To locate the monuments, begin at the northeast corner of the claim and travel:

600 feet South to the southeast corner, thence
725 feet West to the south side-center, thence
725 feet West to the southwest corner, thence
600 feet North to the northwest corner, thence
725 feet East to the north side-center, thence
725 feet East to the northeast corner of the claim.

The location work included the making of a claim map as provided in NRS 517.040, a copy of which is filed with the county recorder.

Dated this 30th day of November, 1992.

Matthew B. Powell

Matthew B. Powell, agent for:
Newmont Exploration Limited
P.O. Box 669
Carlin, Nevada 89822

Return to:

BOOK 243 PAGE 510
OFFICIAL RECORDS
RECORDED AT THE REQUEST OF
Newmont Exploration
93 JAN 14 P5:00

EUREKA COUNTY, NEVADA
M.N. REBALEATI, RECORDER
FILE NO. 625

143797

BOOK 243 PAGES 10

Mathew B. Powell, agent for:
Newmont Exploration Limited
P.O. Box 669
Carlin, Nevada 89822

Mathew B. Powell

Dated this 30th day of November, 1992.

The location work included the making of a claim map as provided in NRS 517.040, a copy of which is filed with the county recorder.

600 feet South to the southeast corner, thence
725 feet West to the south side-center, thence
725 feet West to the southwest corner, thence
600 feet North to the northwest corner, thence
725 feet East to the north side-center, thence
725 feet East to the northeast corner of the claim.

To locate the monuments, begin at the northeast corner of the claim and travel:

The boundaries of this claim are monumented with 4 inch by 4 inch by 4 1/2 foot long wooden posts. Each monument is marked with a scribed metal tag, which states the claim name and number, and the location of the monument with respect to the claim.

The claim is 1450 feet long and 600 feet wide, such that 1430 feet is claimed in an East direction and 20 feet is claimed in a West direction from the location monument, together with 300 feet on each side of the monument of location and center line of the claim. The general course of the claim is East to West.

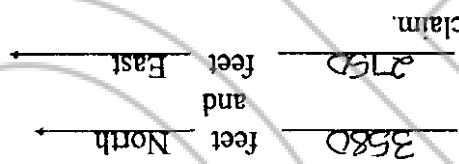

To tie this claim to the public survey, begin at the SW corner of Section 22, T. 34 N., R. 50 E., MDB&M, and travel:

- NE 1/4 of Section 34 N., Range 50 E.
- NW 1/4 of Section 34 N., Range 50 E.
- SE 1/4 of Section 34 N., Range 50 E.
- SW 1/4 of Section 34 N., Range 50 E.

Said claim is located in the following quarter section(s):

Newmont Exploration Limited
P.O. Box 669
Carlin, Nevada 89822

The name and address of the locator is:

The undersigned hereby certifies that he has caused to be located the HIMI 8 Lode Mining Claim on the 25th day of October, 1992.

TO ALL WHOM IT MAY CONCERN:

CERTIFICATE OF LOCATION
LODE MINING CLAIM

143797

Newmont Exploration Limited
P.O. Box 669
Carlin, Nevada 89822

Return to:

Return to:

Newmont Exploration Limited
P. O. Box 669
Carlin, Nevada 89822

143798

**CERTIFICATE OF LOCATION
LODE MINING CLAIM**

TO ALL WHOM IT MAY CONCERN:

The undersigned hereby certifies that he has caused to be located the HIMI 9 Lode Mining Claim on the 25th day of October, 1992.

The name and address of the locator is:

Newmont Exploration Limited
P. O. Box 669
Carlin, Nevada 89822

Said claim is located in the following quarter section(s):

NE 1/4 of Section 21, Township 34 N., Range 50 E.
NW 1/4 of Section 22, Township 34 N., Range 50 E.
SE 1/4 of Section 21, Township 34 N., Range 50 E.
SW 1/4 of Section 22, Township 34 N., Range 50 E.

Mount Diablo Base Line and Meridian, Eureka County, Nevada.

To tie this claim to the public survey, begin at the SW corner of Section 22, T. 34 N., R. 50 E., MDB&M, and travel:

2980 feet North
and
1300 feet East

to the northeast corner of the claim.

The claim is 1450 feet long and 600 feet wide, such that 20 feet is claimed in an East direction and 1430 feet is claimed in a West direction from the location monument, together with 300 feet on each side of the monument of location and center line of the claim. The general course of the claim is East to West.

The boundaries of this claim are monumented with 4 inch by 4 inch by 4 1/2 foot long wooden posts. Each monument is marked with a scribed metal tag, which states the claim name and number, and the location of the monument with respect to the claim.

To locate the monuments, begin at the northeast corner of the claim and travel:

600 feet South to the southeast corner, thence
725 feet West to the south side-center, thence
725 feet West to the southwest corner, thence
600 feet North to the northwest corner, thence
725 feet East to the north side-center, thence
725 feet East to the northeast corner of the claim.

The location work included the making of a claim map as provided in NRS 517.040, a copy of which is filed with the county recorder.

Dated this 30th day of November, 1992.

Matthew B. Powell

Matthew B. Powell, agent for:
Newmont Exploration Limited
P. O. Box 669
Carlin, Nevada 89822

143798

EUREKA COUNTY, NEVADA
M.N. REBALEATI, RECORDER
FILE NO. 625

'93 JAN 14 P5:00

BOOK 243 PAGE 511
OFFICIAL RECORDS
RECORDED AT THE REQUEST OF
Newmont Exploration

Return to:

Newmont Exploration Limited
P.O. Box 669
Carlin, Nevada 89822

143799

CERTIFICATE OF LOCATION
LODE MINING CLAIM

TO ALL WHOM IT MAY CONCERN:

The undersigned hereby certifies that he has caused to be located the HIMI VC Lode Mining Claim on the 25th day of October, 1992.

The name and address of the locator is:

Newmont Exploration Limited
P.O. Box 669
Carlin, Nevada 89822

Said claim is located in the following quarter section(s):

NE 1/4 of Section 22, Township 34 N., Range 50 E.
NW 1/4 of Section 22, Township 34 N., Range 50 E.
SE 1/4 of Section 22, Township 34 N., Range 50 E.
SW 1/4 of Section 22, Township 34 N., Range 50 E.

Mount Diablo Base Line and Meridian, Eureka County, Nevada.

To tie this claim to the public survey, begin at the SW corner of Section 22, T. 34 N., R. 50 E., MDB&M, and travel:

2980 feet North
and
2750 feet East

to the northeast corner of the claim.

The claim is 1450 feet long and 600 feet wide, such that 1430 feet is claimed in an East direction and 20 feet is claimed in a West direction from the location monument, together with 300 feet on each side of the monument of location and center line of the claim. The general course of the claim is East to West.

The boundaries of this claim are monumented with 4 inch by 4 inch by 4 1/2 foot long wooden posts. Each monument is marked with a scribed metal tag, which states the claim name and number, and the location of the monument with respect to the claim.

To locate the monuments, begin at the northeast corner of the claim and travel:

600 feet South to the southeast corner, thence
725 feet West to the south side-center, thence
725 feet West to the southwest corner, thence
600 feet North to the northwest corner, thence
725 feet East to the north side-center, thence
725 feet East to the northeast corner of the claim.

The location work included the making of a claim map as provided in NRS 517.060 copy of which is filed with the county recorder.

Dated this 30th day of November, 1992.

Matthew B. Powell

Matthew B. Powell, agent for:
Newmont Exploration Limited
P.O. Box 669
Carlin, Nevada 89822

BOOK 243 PAGE 512
OFFICIAL RECORDS
RECORDED AT THE REQUEST OF
Newmont Explorations
'93 JAN 14 P5:00
EUREKA COUNTY, NEVADA
M.N. REBALEATI, RECORDER
FILE NO. 143799
FEE \$ 6.25

BOOK 243 PAGE 513
OFFICIAL RECORDS
RECORDED AT THE REQUEST OF
Newmont Exploration

'93 JAN 14 P5:00

EUREKA COUNTY, NEVADA
M.I.N. REBALEATI, RECORDER
FILE NO. *625*

143800

BOOK 243 PAGES 13

Mathew B. Powell, agent for:
Newmont Exploration Limited
P.O. Box 669
Carlin, Nevada 89822

Mathew B. Powell

Dated this 30th day of November, 1992.

The location work included the making of a claim map as provided in NRS 517.040, a copy of which is filed with the county recorder.

600 feet South to the southeast corner, thence
725 feet West to the south side-center, thence
725 feet West to the southwest corner, thence
600 feet North to the northwest corner, thence
725 feet East to the north side-center, thence
725 feet East to the northeast corner of the claim.

To locate the monuments, begin at the northeast corner of the claim and travel:

The boundaries of this claim are monumented with 4 inch by 4 inch by 4 1/2 foot long wooden posts. Each monument is marked with a scribed metal tag, which states the claim name and number, and the location of the monument with respect to the claim.

The claim is 1450 feet long and 600 feet wide, such that 20 feet is claimed in an East direction and 1430 feet is claimed in a West direction from the location monument, together with 300 feet on each side of the monument of location and center line of the claim. The general course of the claim is East to West.

to the northeast corner of the claim.

2380 feet North and
1300 feet East

To tie this claim to the public survey, begin at the SW corner of Section 22, T 34 N, R. 50 E, MDB&M, and travel:

NE 1/4 of Section Township 34 N, Range 50 E
NW 1/4 of Section Township 34 N, Range 50 E
SE 1/4 of Section 21 Township 34 N, Range 50 E
SW 1/4 of Section 22 Township 34 N, Range 50 E
Mount Diablo Base Line and Meridian, Eureka County, Nevada.

Said claim is located in the following quarter section(s):

Newmont Exploration Limited
P.O. Box 669
Carlin, Nevada 89822

The name and address of the locator is:

Mining Claim on the 25th day of October, 1992.

The undersigned hereby certifies that he has caused to be located the HIMM // Lode

TO ALL WHOM IT MAY CONCERN:

CERTIFICATE OF LOCATION
LODE MINING CLAIM

143800

Newmont Exploration Limited
P.O. Box 669
Carlin, Nevada 89822

Return to:

Return to:

Newmont Exploration Limited
P.O. Box 669
Carlin, Nevada 89822

143801

CERTIFICATE OF LOCATION
LODE MINING CLAIM

TO ALL WHOM IT MAY CONCERN:

The undersigned hereby certifies that he has caused to be located the HIMI 1A Lode Mining Claim on the 25th day of October, 1992.

The name and address of the locator is:

Newmont Exploration Limited
P.O. Box 669
Carlin, Nevada 89822

Said claim is located in the following quarter section(s):

NE 1/4 of Section _____ Township 34 N., Range 50 E.
NW 1/4 of Section _____ Township 34 N., Range 50 E.
SE 1/4 of Section _____ Township 34 N., Range 50 E.
SW 1/4 of Section 22, Township 34 N., Range 50 E.

Mount Diablo Base Line and Meridian, Eureka County, Nevada.

To tie this claim to the public survey, begin at the SW corner of Section 22, T. 34 N., R. 50 E., MDB&M, and travel:

2380 feet North
and
2750 feet East

to the northeast corner of the claim.

The claim is 1450 feet long and 600 feet wide, such that 1430 feet is claimed in an East direction and 20 feet is claimed in a West direction from the location monument, together with 300 feet on each side of the monument of location and center line of the claim. The general course of the claim is East to West.

The boundaries of this claim are monumented with 4 inch by 4 inch by 4 1/2 foot long wooden posts. Each monument is marked with a scribed metal tag, which states the claim name and number, and the location of the monument with respect to the claim.

To locate the monuments, begin at the northeast corner of the claim and travel:

600 feet South to the southeast corner, thence
725 feet West to the south side-center, thence
725 feet West to the southwest corner, thence
600 feet North to the northwest corner, thence
725 feet East to the north side-center, thence
725 feet East to the northeast corner of the claim.

The location work included the making of a claim map as provided in NRS 517.040, a copy of which is filed with the county recorder.

Dated this 30th day of November, 1992.

Matthew B. Powell

Matthew B. Powell, agent for:
Newmont Exploration Limited
P.O. Box 669
Carlin, Nevada 89822

BOOK 243 PAGE 514
OFFICIAL RECORDS
RECORDED AT THE REQUEST OF
Newmont Exploration
'93 JAN 14 P 5:00
EUREKA COUNTY, NEVADA
M.N. REBALEATI, RECORDER
FILE NO. 143801
FEE \$ 25

Return to:

Newmont Exploration Limited
P.O. Box 669
Carlin, Nevada 89822

143802

CERTIFICATE OF LOCATION
LODE MINING CLAIM

TO ALL WHOM IT MAY CONCERN:

The undersigned hereby certifies that he has caused to be located the HIMM 13 Lode Mining Claim on the 25th day of October, 1992.

The name and address of the locator is:

Newmont Exploration Limited
P.O. Box 669
Carlin, Nevada 89822

Said claim is located in the following quarter section(s):

NE 1/4 of Section 34 N., Range 50 E.
NW 1/4 of Section 34 N., Range 50 E.
SE 1/4 of Section 21 Township 34 N., Range 50 E.
SW 1/4 of Section 22 Township 34 N., Range 50 E.
Mount Diablo Base Line and Meridian, Eureka County, Nevada.

To the this claim to the public survey, begin at the SW corner of Section 22, T 34 N., R. 50 E., MDB&M, and travel:

1780 feet North
and
1300 feet East

to the northeast corner of the claim.

The claim is 1450 feet long and 600 feet wide, such that 20 feet is claimed in an East direction and 1430 feet is claimed in a West direction from the location monument, together with 300 feet on each side of the monument of location and center line of the claim. The general course of the claim is East to West.

The boundaries of this claim are monumented with 4 inch by 4 inch by 4 1/2 foot long wooden posts. Each monument is marked with a scribed metal tag, which states the claim name and number, and the location of the monument with respect to the claim.

To locate the monuments, begin at the northeast corner of the claim and travel:

600 feet South to the southeast corner, thence
725 feet West to the south side-center, thence
725 feet West to the southwest corner, thence
600 feet North to the northwest corner, thence
725 feet East to the north side-center, thence
725 feet East to the northeast corner of the claim.

The location work included the making of a claim map as provided in NRS 517.040, a copy of which is filed with the county recorder.

Dated this 30th day of November, 1992.

Matthew B. Powell

Matthew B. Powell, agent for:
Newmont Exploration Limited
P.O. Box 669
Carlin, Nevada 89822

BOOK 243 PAGE 515

BOOK 243 PAGE 515
OFFICIAL RECORDS
RECORDED AT THE REQUEST OF
Newmont Exploration
93 JAN 14 P 5:00

EUREKA COUNTY, NEVADA
M.N. REBALEATI, RECORDER
FILE NO. 143802
625

Return to:

Newmont Exploration Limited
P.O. Box 669
Carlin, Nevada 89822

143803

CERTIFICATE OF LOCATION
LODE MINING CLAIM

TO ALL WHOM IT MAY CONCERN:

The undersigned hereby certifies that he has caused to be located the HIME 14 Lode Mining Claim on the 25th day of October, 1992.

The name and address of the locator is:

Newmont Exploration Limited
P.O. Box 669
Carlin, Nevada 89822

Said claim is located in the following quarter section(s):

- NE 1/4 of Section Township 34 N., Range 50 E.
 - NW 1/4 of Section Township 34 N., Range 50 E.
 - SE 1/4 of Section Township 34 N., Range 50 E.
 - SW 1/4 of Section 22 Township 34 N., Range 50 E.
- Mount Diablo Base Line and Meridian, Eureka County, Nevada.

To tie this claim to the public survey, begin at the SW corner of Section 22, T. 34 N. R. 50 E., MDB&M, and travel:

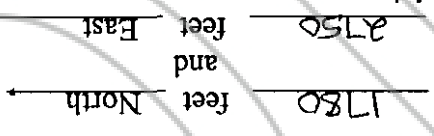

to the northeast corner of the claim.

The claim is 1450 feet long and 600 feet wide, such that 1430 feet is claimed in an East direction and 20 feet is claimed in a West direction from the location monument, together with 300 feet on each side of the monument of location and center line of the claim. The general course of the claim is East to West.

The boundaries of this claim are monumented with 4 inch by 4 inch by 4 1/2 foot long wooden posts. Each monument is marked with a scribed metal tag, which states the claim name and number, and the location of the monument with respect to the claim.

To locate the monuments, begin at the northeast corner of the claim and travel:

- 600 feet South to the southeast corner, thence
- 725 feet West to the south side-center, thence
- 725 feet West to the southwest corner, thence
- 600 feet North to the northwest corner, thence
- 725 feet East to the north side-center, thence
- 725 feet East to the northeast corner of the claim.

The location work included the making of a claim map as provided in NRS 517.040, a copy of which is filed with the county recorder.

Dated this 30th day of November, 1992.

Matthew B. Powell

Matthew B. Powell, agent for:
Newmont Exploration Limited
P.O. Box 669
Carlin, Nevada 89822

BOOK 243 PAGES 16

EUREKA COUNTY, NEVADA
M.N. REBALEATI, RECORDER
FILE NO.

143803

'93 JAN 14 P5:00

BOOK 243 PAGE 516
OFFICIAL RECORDS
RECORDED AT THE REQUEST OF
Newmont Exploration

Return to:

Newmont Exploration Limited
P.O. Box 669
Carlin, Nevada 89822

143804

CERTIFICATE OF LOCATION
LODE MINING CLAIM

TO ALL WHOM IT MAY CONCERN:

The undersigned hereby certifies that he has caused to be located the HIMM 15 Lode Mining Claim on the 25th day of October, 1992.

The name and address of the locator is:

Newmont Exploration Limited
P.O. Box 669
Carlin, Nevada 89822

Said claim is located in the following quarter section(s):

NE 1/4 of Section _____ Township 34 N., Range 50 E.
NW 1/4 of Section _____ Township 34 N., Range 50 E.
SE 1/4 of Section 21 Township 34 N., Range 50 E.
SW 1/4 of Section 22 Township 34 N., Range 50 E.

Mount Diablo Base Line and Meridian, Eureka County, Nevada.

To tie this claim to the public survey, begin at the SW corner of Section 22, T. 34 N., R. 50 E., MDB&M, and travel:

1180 feet North
and
1200 feet East

to the northeast corner of the claim.

The claim is 1450 feet long and 600 feet wide, such that 20 feet is claimed in an East direction and 1430 feet is claimed in a West direction from the location monument, together with 300 feet on each side of the monument of location and center line of the claim. The general course of the claim is East to West.

The boundaries of this claim are monumented with 4 inch by 4 inch by 4 1/2 foot long wooden posts. Each monument is marked with a scribed metal tag, which states the claim name and number, and the location of the monument with respect to the claim.

To locate the monuments, begin at the northeast corner of the claim and travel:

600 feet South to the southeast corner, thence
725 feet West to the south side-center, thence
725 feet West to the southwest corner, thence
600 feet North to the northwest corner, thence
725 feet East to the north side-center, thence
725 feet East to the northeast corner of the claim.

The location work included the making of a claim map as provided in NRS 517.040, a copy of which is filed with the county recorder.

Dated this 30th day of November, 1992.

Matthew B. Powell

Matthew B. Powell, agent for:
Newmont Exploration Limited
P.O. Box 669
Carlin, Nevada 89822

BOOK 243 PAGES 17

BOOK 243 PAGE 517
OFFICIAL RECORDS
RECORDED AT THE REQUEST OF
Newmont Exploration
93 JAN 14 P5:00

EUREKA COUNTY, NEVADA
M.N. REBALEATI, RECORDER
FILE NO. **143804**
FEE \$ 25

BOOK 243 PAGE 518
OFFICIAL RECORDS
RECORDED AT THE REQUEST OF
Newmont Exploration
93 JAN 14 P5:00

EUREKA COUNTY, NEVADA
M.N. REBALEATI, RECORDER
FILE NO. 143805
FEE \$ 25

BOOK 243 PAGE 518

Matthew B. Powell, agent for:
Newmont Exploration Limited
P.O. Box 669
Carlin, Nevada 89822

Matthew B. Powell

Dated this 30th day of November, 1992.

The location work included the making of a claim map as provided in NRS 517.040, a copy of which is filed with the county recorder.

600 feet South to the southeast corner, thence
725 feet West to the south side-center, thence
725 feet West to the southwest corner, thence
600 feet North to the northwest corner, thence
725 feet East to the north side-center, thence
725 feet East to the northeast corner of the claim.

To locate the monuments, begin at the northeast corner of the claim and travel:

The boundaries of this claim are monumented with 4 inch by 4 inch by 4 1/2 foot long wooden posts. Each monument is marked with a scribed metal tag, which states the claim name and number, and the location of the monument with respect to the claim.

The claim is 1450 feet long and 600 feet wide, such that 1430 feet is claimed in an East direction and 20 feet is claimed in a West direction from the location monument, together with 300 feet on each side of the monument of location and center line of the claim. The general course of the claim is East to West.

to the northeast corner of the claim.

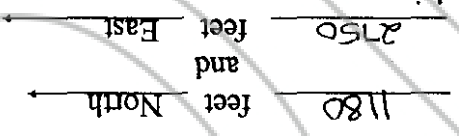

To tie this claim to the public survey, begin at the SW corner of Section 22, T. 34 N., R. 50 E., MDB&M, and travel:

NE 1/4 of Section Township 34 N., Range 50 E.
NW 1/4 of Section Township 34 N., Range 50 E.
SE 1/4 of Section Township 34 N., Range 50 E.
SW 1/4 of Section 22, Township 34 N., Range 50 E.
Mount Diablo Base Line and Meridian, Eureka County, Nevada.

Said claim is located in the following quarter section(s):

Newmont Exploration Limited
P.O. Box 669
Carlin, Nevada 89822

The name and address of the locator is:

The undersigned hereby certifies that he has caused to be located the HIMI He Lode Mining Claim on the 25th day of October, 1992.

TO ALL WHOM IT MAY CONCERN:

CERTIFICATE OF LOCATION
LODE MINING CLAIM

143805

Newmont Exploration Limited
P.O. Box 669
Carlin, Nevada 89822

Return to:

Return to:

Newmont Exploration Limited
P.O. Box 669
Carlin, Nevada 89822

143806

CERTIFICATE OF LOCATION
LODE MINING CLAIM

TO ALL WHOM IT MAY CONCERN:

The undersigned hereby certifies that he has caused to be located the HIMM 17 Lode Mining Claim on the 25th day of October, 1992.

The name and address of the locator is:

Newmont Exploration Limited
P.O. Box 669
Carlin, Nevada 89822

Said claim is located in the following quarter section(s):

NE 1/4 of Section 28, Township 34 N., Range 50 E.

NW 1/4 of Section 27, Township 34 N., Range 50 E.

SE 1/4 of Section 21, Township 34 N., Range 50 E.

SW 1/4 of Section 22, Township 34 N., Range 50 E.

Mount Diablo Base Line and Meridian, Eureka County, Nevada.

To the claim to the public survey, begin at the SW corner of Section 22, T. 34 N., R. 50 E., MDB&M, and travel:

580 feet North

1300 feet East

to the northeast corner of the claim.

The claim is 1450 feet long and 600 feet wide, such that 20 feet is claimed in an East direction and 1430 feet is claimed in a West direction from the location monument, together with 300 feet on each side of the monument of location and center line of the claim. The general course of the claim is East to West.

The boundaries of this claim are monumented with 4 inch by 4 inch by 4 1/2 foot long wooden posts. Each monument is marked with a scribed metal tag, which states the claim name and number, and the location of the monument with respect to the claim.

To locate the monuments, begin at the northeast corner of the claim and travel:

600 feet South to the southeast corner, thence
725 feet West to the south side-center, thence
725 feet West to the southwest corner, thence
600 feet North to the northwest corner, thence
725 feet East to the north side-center, thence
725 feet East to the northeast corner of the claim.

The location work included the making of a claim map as provided in NRS 517.040, a copy of which is filed with the county recorder.

Dated this 30th day of November, 1992.

Matthew B. Powell

Matthew B. Powell, agent for:
Newmont Exploration Limited
P.O. Box 669
Carlin, Nevada 89822

BOOK 243 PAGES 19

BOOK 243 PAGE 519
OFFICIAL RECORDS
RECORDED AT THE REQUEST OF
Newmont Exploration
'93 JAN 14 P5:00

EUREKA COUNTY, NEVADA
M.N. REBALEATI, RECORDER
FILE NO. 143806
FEE \$ 6.25

Return to:

Newmont Exploration Limited
P.O. Box 669
Carlin, Nevada 89822

CERTIFICATE OF LOCATION
LODE MINING CLAIM

TO ALL WHOM IT MAY CONCERN:

The undersigned hereby certifies that he has caused to be located the HMM 18 Lode Mining Claim on the 25th day of October, 1992.

The name and address of the locator is:

Newmont Exploration Limited
P.O. Box 669
Carlin, Nevada 89822

Said claim is located in the following quarter section(s):

NE 1/4 of Section 27 Township 34 N., Range 50 E.
NW 1/4 of Section 27 Township 34 N., Range 50 E.
SE 1/4 of Section 22 Township 34 N., Range 50 E.
SW 1/4 of Section 22 Township 34 N., Range 50 E.
Mount Diablo Base Line and Meridian, Eureka County, Nevada.

To tie this claim to the public survey, begin at the SW corner of Section 22, T. 34 N., R. 50 E., MDB&M, and travel:

580 feet North
and
2750 feet East

The claim is 1450 feet long and 600 feet wide, such that 1430 feet is claimed in an East direction and 20 feet is claimed in a West direction from the location monument, together with 300 feet on each side of the monument of location and center line of the claim. The general course of the claim is East to West.

The boundaries of this claim are monumented with 4 inch by 4 inch by 4 1/2 foot long wooden posts. Each monument is marked with a scribed metal tag, which states the claim name and number, and the location of the monument with respect to the claim.

To locate the monuments, begin at the northeast corner of the claim and travel:

600 feet South to the southeast corner, thence
725 feet West to the south side-center, thence
725 feet West to the southwest corner, thence
600 feet North to the northwest corner, thence
725 feet East to the north side-center, thence
725 feet East to the northeast corner of the claim.

The location work included the making of a claim map as provided in NRS 517.040, a copy of which is filed with the county recorder.

Dated this 30th day of November, 1992.

Matthew B. Powell

Matthew B. Powell, agent for:
Newmont Exploration Limited
P.O. Box 669
Carlin, Nevada 89822

143807

CERTIFICATE OF LOCATION
LODE MINING CLAIM

TO ALL WHOM IT MAY CONCERN:

The undersigned hereby certifies that he has caused to be located the HMM 18 Lode Mining Claim on the 25th day of October, 1992.

The name and address of the locator is:

Newmont Exploration Limited
P.O. Box 669
Carlin, Nevada 89822

Said claim is located in the following quarter section(s):

NE 1/4 of Section 27 Township 34 N., Range 50 E.
NW 1/4 of Section 27 Township 34 N., Range 50 E.
SE 1/4 of Section 22 Township 34 N., Range 50 E.
SW 1/4 of Section 22 Township 34 N., Range 50 E.
Mount Diablo Base Line and Meridian, Eureka County, Nevada.

To tie this claim to the public survey, begin at the SW corner of Section 22, T. 34 N., R. 50 E., MDB&M, and travel:

580 feet North
and
2750 feet East

The claim is 1450 feet long and 600 feet wide, such that 1430 feet is claimed in an East direction and 20 feet is claimed in a West direction from the location monument, together with 300 feet on each side of the monument of location and center line of the claim. The general course of the claim is East to West.

The boundaries of this claim are monumented with 4 inch by 4 inch by 4 1/2 foot long wooden posts. Each monument is marked with a scribed metal tag, which states the claim name and number, and the location of the monument with respect to the claim.

To locate the monuments, begin at the northeast corner of the claim and travel:

600 feet South to the southeast corner, thence
725 feet West to the south side-center, thence
725 feet West to the southwest corner, thence
600 feet North to the northwest corner, thence
725 feet East to the north side-center, thence
725 feet East to the northeast corner of the claim.

The location work included the making of a claim map as provided in NRS 517.040, a copy of which is filed with the county recorder.

Dated this 30th day of November, 1992.

Matthew B. Powell

Matthew B. Powell, agent for:
Newmont Exploration Limited
P.O. Box 669
Carlin, Nevada 89822

BOOK 243 PAGE 520

BOOK 243 PAGE 520
OFFICIAL RECORDS
RECORDED AT THE REQUEST OF
Newmont Exploration
93 JAN 14 P5:01

EUREKA COUNTY, NEVADA
M.N. REBAL. RECORDER
FILE NO. 6-25

143807

Return to:

Newmont Exploration Limited
P.O. Box 669
Carlin, Nevada 89822

143808

**CERTIFICATE OF LOCATION
LODE MINING CLAIM**

TO ALL WHOM IT MAY CONCERN:

The undersigned hereby certifies that he has caused to be located the HIMI 19 Lode Mining Claim on the 26th day of October, 1992.

The name and address of the locator is:

Newmont Exploration Limited
P.O. Box 669
Carlin, Nevada 89822

Said claim is located in the following quarter section(s):

NE 1/4 of Section 22, Township 34 N., Range 50 E.
NW 1/4 of Section 15, Township 34 N., Range 50 E.
SE 1/4 of Section 15, Township 34 N., Range 50 E.
SW 1/4 of Section 15, Township 34 N., Range 50 E.
Mount Diablo Base Line and Meridian, Eureka County, Nevada.

To tie this claim to the public survey, begin at the SW corner of Section 22, T. 34 N., R. 50 E., MDB&M, and travel:

5380 feet North
and
4200 feet East

to the northeast corner of the claim.

The claim is 1450 feet long and 600 feet wide, such that 20 feet is claimed in an East direction and 1430 feet is claimed in a West direction from the location monument, together with 300 feet on each side of the monument of location and center line of the claim. The general course of the claim is East to West.

The boundaries of this claim are monumented with 4 inch by 4 inch by 4 1/2 foot long wooden posts. Each monument is marked with a scribed metal tag, which states the claim name and number, and the location of the monument with respect to the claim.

To locate the monuments, begin at the northeast corner of the claim and travel:

600 feet South to the southeast corner, thence
725 feet West to the south side-center, thence
725 feet West to the southwest corner, thence
600 feet North to the northwest corner, thence
725 feet East to the north side-center, thence
725 feet East to the northeast corner of the claim.

The location work included the making of a claim map as provided in NRS 517.040, a copy of which is filed with the county recorder.

Dated this 30th day of November, 1992.

Matthew B. Powell

Matthew B. Powell, agent for:
Newmont Exploration Limited
P.O. Box 669
Carlin, Nevada 89822

BOOK 243 PAGE 521

BOOK 243 PAGE 521
OFFICIAL RECORDS
RECORDED AT THE REQUEST OF
Newmont Exploration
93 JAN 14 P5:01

EUREKA COUNTY, NEVADA
M.N. REBALEATI, RECORDER
FILE NO. 143808
FEES \$ 6.25

BOOK 243 PAGE 522
OFFICIAL RECORDS
RECORDED AT THE REQUEST OF
Newmont Exploration
93 JAN 14 P 5:01

EUREKA COUNTY, NEVADA
M.N. REBALEATI, RECORDER
FILE NO. 25

143809

BOOK 243 PAGE 522

Matthew B. Powell, agent for:
Newmont Exploration Limited
P.O. Box 669
Carlin, Nevada 89822

Matthew B. Powell

Dated this 30th day of November, 1992.

The location work included the making of a claim map as provided in NRS 517.040, a copy of which is filed with the county recorder.

600 feet South to the southeast corner, thence
725 feet West to the south side-center, thence
725 feet West to the southwest corner, thence
600 feet North to the northwest corner, thence
725 feet East to the north side-center, thence
725 feet East to the northeast corner of the claim.

To locate the monuments, begin at the northeast corner of the claim and travel:

The boundaries of this claim are monumented with 4 inch by 4 inch by 4 1/2 foot long wooden posts. Each monument is marked with a scribed metal tag, which states the claim name and number, and the location of the monument with respect to the claim.
To locate the monuments, begin at the northeast corner of the claim and travel:
The claim is 1450 feet long and 600 feet wide, such that 1430 feet is claimed in an East direction and 20 feet is claimed in a West direction from the location monument, together with 300 feet on each side of the monument of location and center line of the claim. The general course of the claim is East to West.
The boundaries of this claim are monumented with 4 inch by 4 inch by 4 1/2 foot long wooden posts. Each monument is marked with a scribed metal tag, which states the claim name and number, and the location of the monument with respect to the claim.

5380 feet North
and
5650 feet East

To tie this claim to the public survey, begin at the SW corner of Section 22, T. 34 N., R. 50 E., MDB&M, and travel:

NE 1/4 of Section 22, Township 34 N., Range 50 E.
NW 1/4 of Section 23, Township 34 N., Range 50 E.
SE 1/4 of Section 15, Township 34 N., Range 50 E.
SW 1/4 of Section 14, Township 34 N., Range 50 E.
Mount Diablo Base Line and Meridian, Eureka County, Nevada.

Said claim is located in the following quarter section(s):

Newmont Exploration Limited
P.O. Box 669
Carlin, Nevada 89822

The name and address of the locator is:

The undersigned hereby certifies that he has caused to be located the HIMI 20 Lode Mining Claim on the 26th day of October, 1992.

TO ALL WHOM IT MAY CONCERN:

CERTIFICATE OF LOCATION
LODE MINING CLAIM

143809

Newmont Exploration Limited
P.O. Box 669
Carlin, Nevada 89822

Return to:

Return to:

Newmont Exploration Limited
P. O. Box 669
Carlin, Nevada 89822

143810
CERTIFICATE OF LOCATION
LODE MINING CLAIM

TO ALL WHOM IT MAY CONCERN:

The undersigned hereby certifies that he has caused to be located the HMM 21 Lode Mining Claim on the 26th day of October, 1992.

The name and address of the locator is:

Newmont Exploration Limited
P. O. Box 669
Carlin, Nevada 89822

Said claim is located in the following quarter section(s):

NE 1/4 of Section 22, Township 34 N., Range 50 E.
NW 1/4 of Section 22, Township 34 N., Range 50 E.
SE 1/4 of Section 22, Township 34 N., Range 50 E.
SW 1/4 of Section 22, Township 34 N., Range 50 E.
Mount Diablo Base Line and Meridian, Eureka County, Nevada.

To tie this claim to the public survey, begin at the SW corner of Section 22, T. 34 N., R. 50 E., MDB&M, and travel:

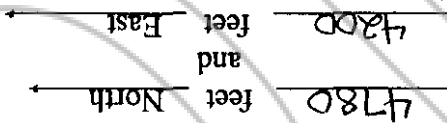

The claim is 1450 feet long and 600 feet wide, such that 20 feet is claimed in an East direction and 1430 feet is claimed in a West direction from the location monument, together with 300 feet on each side of the monument of location and center line of the claim. The general course of the claim is East to West.

The boundaries of this claim are monumented with 4 inch by 4 inch by 4 1/2 foot long wooden posts. Each monument is marked with a scribed metal tag, which states the claim name and number, and the location of the monument with respect to the claim.

To locate the monuments, begin at the northeast corner of the claim and travel:

600 feet South to the southeast corner, thence
725 feet West to the south side-center, thence
725 feet West to the southwest corner, thence
600 feet North to the northwest corner, thence
725 feet East to the north side-center, thence
725 feet East to the northeast corner of the claim.

The location work included the making of a claim map as provided in NRS 517.040, a copy of which is filed with the county recorder.

Dated this 30th day of November, 1992.

Matthew B. Powell

Matthew B. Powell, agent for:
Newmont Exploration Limited
P. O. Box 669
Carlin, Nevada 89822

BOOK 243 PAGES 23

BOOK 243 PAGE 523
OFFICIAL RECORDS
RECORDED AT THE REQUEST OF
Newmont Exploration
'93 JAN 14 P5:01

EUREKA COUNTY, NEVADA
M.N. REBALEATI, RECORDER
FILE NO. 925

143810

Return to:

Newmont Exploration Limited
P. O. Box 669
Carlin, Nevada 89822

143811

CERTIFICATE OF LOCATION
LODE MINING CLAIM

TO ALL WHOM IT MAY CONCERN:

The undersigned hereby certifies that he has caused to be located the HIMI 23 Lode Mining Claim on the 27th day of October, 1992.

The name and address of the locator is:

Newmont Exploration Limited
P. O. Box 669
Carlin, Nevada 89822

Said claim is located in the following quarter section(s):

NE 1/4 of Section 22, Township 34 N., Range 50 E.
NW 1/4 of Section 23, Township 34 N., Range 50 E.
SE 1/4 of Section _____, Township 34 N., Range 50 E.
SW 1/4 of Section _____, Township 34 N., Range 50 E.
Mount Diablo Base Line and Meridian, Eureka County, Nevada

To tie this claim to the public survey, begin at the SW corner of Section 22, T. 34 N., R. 50 E., MDB&M, and travel:

4780 feet North
and
5650 feet East

The claim is 1450 feet long and 600 feet wide, such that 1430 feet is claimed in an East direction and 20 feet is claimed in a West direction from the location monument, together with 300 feet on each side of the monument of location and center line of the claim. The general course of the claim is East to West.

The boundaries of this claim are monumented with 4 inch by 4 inch by 4 1/2 foot long wooden posts. Each monument is marked with a scribed metal tag, which states the claim name and number, and the location of the monument with respect to the claim.

To locate the monuments, begin at the northeast corner of the claim and travel:

600 feet South to the southeast corner, thence
725 feet West to the south side-center, thence
725 feet West to the southwest corner, thence
600 feet North to the northwest corner, thence
725 feet East to the north side-center, thence
725 feet East to the northeast corner of the claim.

The location work included the making of a claim map as provided in NRS 517.040, a copy of which is filed with the county recorder.

Dated this 30th day of November, 1992.

Matthew B. Powell

Matthew B. Powell, agent for:
Newmont Exploration Limited
P. O. Box 669
Carlin, Nevada 89822

BOOK 243 PAGE 524

BOOK 243 PAGE 524
OFFICIAL RECORDS
RECORDED AT THE REQUEST OF
Newmont Exploration
93 JAN 14 P5:01

EUREKA COUNTY, NEVADA
M.N. REBALEATI, RECORDER
FILE NO. 625
143811

Return to:

Newmont Exploration Limited
P. O. Box 669
Carlin, Nevada 89822

143812

**CERTIFICATE OF LOCATION
LODE MINING CLAIM**

TO ALL WHOM IT MAY CONCERN:

The undersigned hereby certifies that he has caused to be located the HIMM 23 Lode Mining Claim on the 26th day of October, 1992.

The name and address of the locator is:

Newmont Exploration Limited
P. O. Box 669
Carlin, Nevada 89822

Said claim is located in the following quarter section(s):

- NE 1/4 of Section 22, Township 34 N., Range 50 E.
 - NW 1/4 of Section , Township 34 N., Range 50 E.
 - SE 1/4 of Section , Township 34 N., Range 50 E.
 - SW 1/4 of Section , Township 34 N., Range 50 E.
- Mount Diablo Base Line and Meridian, Eureka County, Nevada.

To tie this claim to the public survey, begin at the SW corner of Section 22, T. 34 N., R. 50 E., MDB&M, and travel:

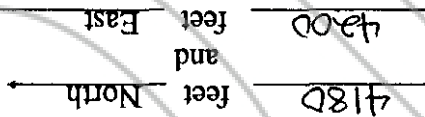

to the northeast corner of the claim.

The claim is 1450 feet long and 600 feet wide, such that 20 feet is claimed in an East direction and 1430 feet is claimed in a West direction from the location monument, together with 300 feet on each side of the monument of location and center line of the claim. The general course of the claim is East to West.

The boundaries of this claim are monumented with 4 inch by 4 inch by 4 1/2 foot long wooden posts. Each monument is marked with a scribed metal tag, which states the claim name and number, and the location of the monument with respect to the claim.

To locate the monuments, begin at the northeast corner of the claim and travel:

- 600 feet South to the southeast corner, thence
- 725 feet West to the south side-center, thence
- 725 feet West to the southwest corner, thence
- 600 feet North to the northwest corner, thence
- 725 feet East to the north side-center, thence
- 725 feet East to the northeast corner of the claim.

The location work included the making of a claim map as provided in NRS 517.040, a copy of which is filed with the county recorder.

Dated this 30th day of November, 1992.

Matthew B. Powell

Matthew B. Powell, agent for:
Newmont Exploration Limited
P. O. Box 669
Carlin, Nevada 89822

BOOK 243 PAGE 525

143812

EUREKA COUNTY, NEVADA
M.N. REBATE/LEAT. RECORDER
FILE NO. 25

'93 JAN 14 P5:01

Newmont Exploration

BOOK 243 PAGE 525
OFFICIAL RECORDS
RECORDED AT THE REQUEST OF

Return to:

Newmont Exploration Limited
P.O. Box 669
Carlin, Nevada 89822

143813

CERTIFICATE OF LOCATION
LODE MINING CLAIM

TO ALL WHOM IT MAY CONCERN:

The undersigned hereby certifies that he has caused to be located the HIMI 24 Lode Mining Claim on the 26th day of October, 1992.

The name and address of the locator is:

Newmont Exploration Limited
P.O. Box 669
Carlin, Nevada 89822

Said claim is located in the following quarter section(s):

NE 1/4 of Section 22, Township 34 N., Range 50 E.
NW 1/4 of Section 23, Township 34 N., Range 50 E.
SE 1/4 of Section _____, Township 34 N., Range 50 E.
SW 1/4 of Section _____, Township 34 N., Range 50 E.
Mount Diablo Base Line and Meridian, Eureka County, Nevada.

To tie this claim to the public survey, begin at the SW corner of Section 22, T. 34 N. R. 50 E., MDB&M, and travel:

4180 feet North
and
5650 feet East

The claim is 1450 feet long and 600 feet wide, such that 1430 feet is claimed in an East direction and 20 feet is claimed in a West direction from the location monument, together with 300 feet on each side of the monument of location and center line of the claim. The general course of the claim is East to West.

The boundaries of this claim are monumented with 4 inch by 4 inch by 4 1/2 foot long wooden posts. Each monument is marked with a scribed metal tag, which states the claim name and number, and the location of the monument with respect to the claim.

To locate the monuments, begin at the northeast corner of the claim and travel:

600 feet South to the southeast corner, thence
725 feet West to the south side-center, thence
725 feet West to the southwest corner, thence
600 feet North to the northwest corner, thence
725 feet East to the north side-center, thence
725 feet East to the northeast corner of the claim.

The location work included the making of a claim map as provided in NRS 517.040, a copy of which is filed with the county recorder.

Dated this 30th day of November, 1992.

Matthew B. Powell

Matthew B. Powell, agent for:
Newmont Exploration Limited
P.O. Box 669
Carlin, Nevada 89822

BOOK 243 PAGE 526

BOOK 243 PAGE 526
OFFICIAL RECORDS
RECORDED AT THE REQUEST OF
Newmont Exploration
'93 JAN 14 P5:01

EUREKA COUNTY, NEVADA
M.N. REBALEATI, RECORDER
FILE NO. 625
143813

Return to:

Newmont Exploration Limited
P.O. Box 669
Carlin, Nevada 89822

143814

**CERTIFICATE OF LOCATION
LODE MINING CLAIM**

TO ALL WHOM IT MAY CONCERN:

The undersigned hereby certifies that he has caused to be located the HIMI 25 Lode Mining Claim on the 26th day of October, 1992.

The name and address of the locator is:

Newmont Exploration Limited
P.O. Box 669
Carlin, Nevada 89822

Said claim is located in the following quarter section(s):

NE 1/4 of Section <u>22</u> , Township <u>34 N.</u> , Range <u>50 E.</u>
NW 1/4 of Section <u>34 N.</u> , Range <u>50 E.</u>
SE 1/4 of Section <u>34 N.</u> , Range <u>50 E.</u>
SW 1/4 of Section <u>34 N.</u> , Range <u>50 E.</u>

Mount Diablo Base Line and Meridian, Eureka County, Nevada.

To tie this claim to the public survey, begin at the SW corner of Section 22, T. 34 N., R. 50 E., MDB&M, and travel:

3580	feet	North
and		
4200	feet	East

to the northeast corner of the claim.

The claim is 1450 feet long and 600 feet wide, such that 20 feet is claimed in an East direction and 1430 feet is claimed in a West direction from the location monument, together with 300 feet on each side of the monument of location and center line of the claim. The general course of the claim is East to West.

The boundaries of this claim are monumented with 4 inch by 4 inch by 4 1/2 foot long wooden posts. Each monument is marked with a scribed metal tag, which states the claim name and number, and the location of the monument with respect to the claim.

To locate the monuments, begin at the northeast corner of the claim and travel:

600 feet South to the southeast corner, thence
725 feet West to the south side-center, thence
725 feet West to the southwest corner, thence
600 feet North to the northwest corner, thence
725 feet East to the north side-center, thence
725 feet East to the northeast corner of the claim.

The location work included the making of a claim map as provided in NRS 517.040, a copy of which is filed with the county recorder.

Dated this 30th day of November, 1992.

Matthew B. Powell

Matthew B. Powell, agent for:
Newmont Exploration Limited
P.O. Box 669
Carlin, Nevada 89822

BOOK 243 PAGES 27

BOOK 243 PAGE 527
OFFICIAL RECORDS
RECORDED AT THE REQUEST OF
Newmont Exploration
'93 JAN 14 P5:01

EUREKA COUNTY, NEVADA
M.N. REBALEATI, RECORDER
FILE NO. 625

143814

Return to:
Newmont Exploration Limited
P. O. Box 669
Carlin, Nevada 89822

143815

CERTIFICATE OF LOCATION
LODE MINING CLAIM

TO ALL WHOM IT MAY CONCERN:

The undersigned hereby certifies that he has caused to be located the HIME 26 Lode Mining Claim on the 26th day of October, 1992.

The name and address of the locator is:

Newmont Exploration Limited
P. O. Box 669
Carlin, Nevada 89822

Said claim is located in the following quarter section(s):

22 Township 34 N. Range 50 E. NE 1/4 of Section 23

23 Township 34 N. Range 50 E. NW 1/4 of Section 23

34 N. Range 50 E. SE 1/4 of Section 23

34 N. Range 50 E. SW 1/4 of Section 23

Mount Diablo Base Line and Meridian, Eureka County, Nevada.

To tie this claim to the public survey, begin at the SW corner of Section 22, T. 34 N., R. 50 E., MDB&M, and travel:

3580 feet North
and
5650 feet East

to the northeast corner of the claim.

The claim is 1450 feet long and 600 feet wide, such that 1430 feet is claimed in an East direction and 20 feet is claimed in a West direction from the location monument, together with 300 feet on each side of the monument of location and center line of the claim. The general course of the claim is East to West.

The boundaries of this claim are monumented with 4 inch by 4 inch by 4 1/2 foot long wooden posts. Each monument is marked with a scribed metal tag, which states the claim name and number, and the location of the monument with respect to the claim.

To locate the monuments, begin at the northeast corner of the claim and travel:

600 feet South to the southeast corner, thence
725 feet West to the south side-center, thence
725 feet West to the southwest corner, thence
600 feet North to the northwest corner, thence
725 feet East to the north side-center, thence
725 feet East to the northeast corner of the claim.

The location work included the making of a claim map as provided in NRS 517.040, a copy of which is filed with the county recorder.

Dated this 30th day of November, 1992.

Matthew B. Powell

Matthew B. Powell, agent for:
Newmont Exploration Limited
P. O. Box 669
Carlin, Nevada 89822

BOOK 243 PAGE 528

BOOK 243 PAGE 528
OFFICIAL RECORDS
RECORDED AT THE REQUEST OF
Newmont Exploration
'93 JAN 14 P5:01

EUREKA COUNTY, NEVADA
M.N. REBALEATI, RECORDER
FILE NO. 625

143815

Return to:

Newmont Exploration Limited
P. O. Box 669
Carlin, Nevada 89822

143816

CERTIFICATE OF LOCATION
LODE MINING CLAIM

TO ALL WHOM IT MAY CONCERN:

The undersigned hereby certifies that he has caused to be located the HIMM 27 Lode Mining Claim on the 26th day of October, 1992.

The name and address of the locator is:

Newmont Exploration Limited
P. O. Box 669
Carlin, Nevada 89822

Said claim is located in the following quarter section(s):

NE 1/4 of Section 22, Township 34 N., Range 50 E.
NW 1/4 of Section 22, Township 34 N., Range 50 E.
SE 1/4 of Section 22, Township 34 N., Range 50 E.
SW 1/4 of Section 22, Township 34 N., Range 50 E.
Mount Diablo Base Line and Meridian, Eureka County, Nevada.

To tie this claim to the public survey, begin at the SW corner of Section 22, T. 34 N., R. 50 E., MDB&M, and travel:

2980 feet North and
4200 feet East

The claim is 1450 feet long and 600 feet wide, such that 20 feet is claimed in an East direction and 1430 feet is claimed in a West direction from the location monument, together with 300 feet on each side of the monument of location and center line of the claim. The general course of the claim is East to West.

The boundaries of this claim are monumented with 4 inch by 4 inch by 4 1/2 foot long wooden posts. Each monument is marked with a scribed metal tag, which states the claim name and number, and the location of the monument with respect to the claim.

To locate the monuments, begin at the northeast corner of the claim and travel:

600 feet South to the southeast corner, thence
725 feet West to the south side-center, thence
725 feet West to the southwest corner, thence
600 feet North to the northwest corner, thence
725 feet East to the north side-center, thence
725 feet East to the northeast corner of the claim.

The location work included the making of a claim map as provided in NRS 517.040, a copy of which is filed with the county recorder.

Dated this 30th day of November, 1992.

Matthew B. Powell

Matthew B. Powell, agent for:
Newmont Exploration Limited
P. O. Box 669
Carlin, Nevada 89822

BOOK 243 PAGE 529

BOOK 243 PAGE 529
OFFICIAL RECORDS
RECORDED AT THE REQUEST OF
Newmont Exploration
'93 JAN 14 P5:01

EUREKA COUNTY, NEVADA
M.N. REBALANCE RECORDER
FILE NO. 25

143816

Return to:

Newmont Exploration Limited
P. O. Box 669
Carlin, Nevada 89822

143817

**CERTIFICATE OF LOCATION
LODE MINING CLAIM**

TO ALL WHOM IT MAY CONCERN:

The undersigned hereby certifies that he has caused to be located the HIMA 28 Lode Mining Claim on the 24th day of October, 1992.

The name and address of the locator is:

Newmont Exploration Limited
P. O. Box 669
Carlin, Nevada 89822

Said claim is located in the following quarter section(s):

NE 1/4 of Section 22 Township 34 N., Range 50 E.
NW 1/4 of Section 23 Township 34 N., Range 50 E.
SE 1/4 of Section 22 Township 34 N., Range 50 E.
SW 1/4 of Section 23 Township 34 N., Range 50 E.

Mount Diablo Base Line and Meridian, Eureka County, Nevada.

To tie this claim to the public survey, begin at the SW corner of Section 22, T. 34 N., R. 50 E., MDB&M, and travel:

2980 feet North
and
5650 feet East

to the northeast corner of the claim.

The claim is 1450 feet long and 600 feet wide, such that 1430 feet is claimed in an East direction and 20 feet is claimed in a West direction from the location monument, together with 300 feet on each side of the monument of location and center line of the claim. The general course of the claim is East to West.

The boundaries of this claim are monumented with 4 inch by 4 inch by 4 1/2 foot long wooden posts. Each monument is marked with a scribed metal tag, which states the claim name and number, and the location of the monument with respect to the claim.

To locate the monuments, begin at the northeast corner of the claim and travel:

600 feet South to the southeast corner, thence
725 feet West to the south side-center, thence
725 feet West to the southwest corner, thence
600 feet North to the northwest corner, thence
725 feet East to the north side-center, thence
725 feet East to the northeast corner of the claim.

The location work included the making of a claim map as provided in NRS 517.040, a copy of which is filed with the county recorder.

Dated this 30th day of November, 1992.

Matthew B. Powell

Matthew B. Powell, agent for:
Newmont Exploration Limited
P. O. Box 669
Carlin, Nevada 89822

BOOK 243 PAGES 30

EUREKA COUNTY, NEVADA
M.N. REBALEATI, RECORDER
FILE NO. 143817
FEE \$ 25

'93 JAN 14 P5:01

BOOK 243 PAGE 530
OFFICIAL RECORDS
RECORDED AT THE REQUEST OF
Newmont Exploration

BOOK 243 PAGE 531
OFFICIAL RECORDS
RECORDED AT THE REQUEST OF
Newmont Exploration

'93 JAN 14 P5:01

EUREKA COUNTY, NEVADA
M.N. REBALEATI, RECORDER
FILE NO. 143818

143818

BOOK 243 PAGES 31

Carlin, Nevada 89822

P.O. Box 669
Newmont Exploration Limited

Matthew B. Powell, agent for:

Matthew B. Powell

Dated this 30th day of November, 1992.

The location work included the making of a claim map as provided in NRS 517.040, a copy of which is filed with the county recorder.

600 feet South to the southeast corner, thence
725 feet West to the south side-center, thence
725 feet West to the southwest corner, thence
600 feet North to the northwest corner, thence
725 feet East to the north side-center, thence
725 feet East to the northeast corner of the claim.

To locate the monuments, begin at the northeast corner of the claim and travel:

The boundaries of this claim are monumented with 4 inch by 4 inch by 4 1/2 foot long wooden posts. Each monument is marked with a scribed metal tag, which states the claim name and number, and the location of the monument with respect to the claim.
The claim is 1450 feet long and 600 feet wide, such that 20 feet is claimed in an East direction and 1430 feet is claimed in a West direction from the location monument, together with 300 feet on each side of the monument of location and center line of the claim. The general course of the claim is East to West.

to the northeast corner of the claim.

3380 feet North
and
4200 feet East

R. 50 E., MDB&M, and travel:

To tie this claim to the public survey, begin at the SW corner of Section 22, T. 34 N.,

Mount Diablo Base Line and Meridian, Eureka County, Nevada.

NE 1/4 of Section Township 34 N., Range 50 E.
NW 1/4 of Section Township 34 N., Range 50 E.
SE 1/4 of Section 22 Township 34 N., Range 50 E.
SW 1/4 of Section Township 34 N., Range 50 E.

Said claim is located in the following quarter section(s):

Newmont Exploration Limited
P.O. Box 669
Carlin, Nevada 89822

The name and address of the locator is:

The undersigned hereby certifies that he has caused to be located the HIMI 29 Lode Mining Claim on the 26th day of October, 1992.

TO ALL WHOM IT MAY CONCERN:

CERTIFICATE OF LOCATION
LODE MINING CLAIM

143818

Newmont Exploration Limited
P.O. Box 669
Carlin, Nevada 89822

Return to:

BOOK 243 PAGE 532
OFFICIAL RECORDS
RECORDED AT THE REQUEST OF
Newmont Exploration
93 JAN 14 P 5:01

EUREKA COUNTY, NEVADA
M.N. REBALEATI, RECORDER
FILE NO. 143819
FEES \$ 6.25

BOOK 243 PAGES 32

Matthew B. Powell, agent for:
Newmont Exploration Limited
P.O. Box 669
Carlin, Nevada 89822

Matthew B. Powell

Dated this 30th day of November, 1992.

The location work included the making of a claim map as provided in NRS 517.040, a copy of which is filed with the county recorder.

600 feet South to the southeast corner, thence
725 feet West to the south side-center, thence
725 feet West to the southwest corner, thence
600 feet North to the northwest corner, thence
725 feet East to the north side-center, thence
725 feet East to the northeast corner of the claim.

To locate the monuments, begin at the northeast corner of the claim and travel:

The boundaries of this claim are monumented with 4 inch by 4 inch by 4 1/2 foot long wooden posts. Each monument is marked with a scribed metal tag, which states the claim name and number, and the location of the monument with respect to the claim.
The claim is 1450 feet long and 600 feet wide, such that 1430 feet is claimed in an East direction and 20 feet is claimed in a West direction from the location monument, together with 300 feet on each side of the monument of location and center line of the claim. The general course of the claim is East to West.
The boundaries of this claim are monumented with 4 inch by 4 inch by 4 1/2 foot long wooden posts. Each monument is marked with a scribed metal tag, which states the claim name and number, and the location of the monument with respect to the claim.
To locate the monuments, begin at the northeast corner of the claim and travel:

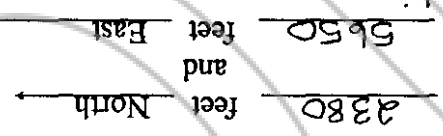

To tie this claim to the public survey, begin at the SW corner of Section 22, T. 34 N. R. 50 E., MDB&M, and travel:

NE 1/4 of Section 23 Township 34 N., Range 50 E.
NW 1/4 of Section 23 Township 34 N., Range 50 E.
SE 1/4 of Section 22, Township 34 N., Range 50 E.
SW 1/4 of Section 22, Township 34 N., Range 50 E.
Mount Diablo Base Line and Meridian, Eureka County, Nevada.

Said claim is located in the following quarter section(s):

Newmont Exploration Limited
P.O. Box 669
Carlin, Nevada 89822

The name and address of the locator is:

The undersigned hereby certifies that he has caused to be located the HIME 30 Lode Mining Claim on the 26th day of October, 1992.

TO ALL WHOM IT MAY CONCERN:

CERTIFICATE OF LOCATION
LODE MINING CLAIM

143819

Newmont Exploration Limited
P.O. Box 669
Carlin, Nevada 89822

Return to:

BOOK 243 PAGE 533
OFFICIAL RECORDS
RECORDED AT THE REQUEST OF
Newmont Exploration
93 JUN 14 P5:01

EUREKA COUNTY, NEVADA
M.M. REBALEATI, RECORDER
FILE NO. 143820
FEES \$ 6.25

BOOK 243 PAGE 533

Carlin, Nevada 89822
P.O. Box 669
Newmont Exploration Limited
Matthew B. Powell, agent for:

Matthew B. Powell

Dated this 30th day of November, 1992.

The location work included the making of a claim map as provided in NRS 517.040, a copy of which is filed with the county recorder.

600 feet South to the southeast corner, thence
725 feet West to the south side-center, thence
725 feet West to the southwest corner, thence
600 feet North to the northwest corner, thence
725 feet East to the north side-center, thence
725 feet East to the northeast corner of the claim.

To locate the monuments, begin at the northeast corner of the claim and travel:

The boundaries of this claim are monumented with 4 inch by 4 inch by 4 1/2 foot long wooden posts. Each monument is marked with a scribed metal tag, which states the claim name and number, and the location of the monument with respect to the claim.

The claim is 1450 feet long and 600 feet wide, such that 20 feet is claimed in an East direction and 1430 feet is claimed in a West direction from the location monument, together with 300 feet on each side of the monument of location and center line of the claim. The general course of the claim is East to West.

to the northeast corner of the claim.

1780 feet North and 4200 feet East

To tie this claim to the public survey, begin at the SW corner of Section 22, T 34 N, R. 50 E, MDB&M, and travel:

NE 1/4 of Section 34 N, Range 50 E
NW 1/4 of Section 34 N, Range 50 E
SE 1/4 of Section 22, Township 34 N, Range 50 E
SW 1/4 of Section 34 N, Range 50 E
Mount Diablo Base Line and Meridian, Eureka County, Nevada.

Said claim is located in the following quarter section(s):

Newmont Exploration Limited
P.O. Box 669
Carlin, Nevada 89822

The name and address of the locator is:

The undersigned hereby certifies that he has caused to be located the HIMI 31 Lode Mining Claim on the 26th day of October, 1992.

TO ALL WHOM IT MAY CONCERN:

CERTIFICATE OF LOCATION
LODE MINING CLAIM
143820

Newmont Exploration Limited
P.O. Box 669
Carlin, Nevada 89822

Return to:

Return to:

Newmont Exploration Limited
P. O. Box 669
Carlin, Nevada 89822

143821

**CERTIFICATE OF LOCATION
LODE MINING CLAIM**

TO ALL WHOM IT MAY CONCERN:

The undersigned hereby certifies that he has caused to be located the HIMM 3A Lode Mining Claim on the 26th day of October, 1992.

The name and address of the locator is:

Newmont Exploration Limited
P. O. Box 669
Carlin, Nevada 89822

Said claim is located in the following quarter section(s):

NE 1/4 of Section Township 34 N. Range 50 E.
NW 1/4 of Section Township 34 N. Range 50 E.
SE 1/4 of Section 22 Township 34 N. Range 50 E.
SW 1/4 of Section 23 Township 34 N. Range 50 E.

Mount Diablo Base Line and Meridian, Eureka County, Nevada.

To tie this claim to the public survey, begin at the SW corner of Section 22, T. 34 N. R. 50 E., MDB&M, and travel:

1780 feet North
and
5650 feet East

The claim is 1450 feet long and 600 feet wide, such that 1430 feet is claimed in an East direction and 20 feet is claimed in a West direction from the location monument, together with 300 feet on each side of the monument of location and center line of the claim. The general course of the claim is East to West.

The boundaries of this claim are monumented with 4 inch by 4 inch by 4 1/2 foot long wooden posts. Each monument is marked with a scribed metal tag, which states the claim name and number, and the location of the monument with respect to the claim.

To locate the monuments, begin at the northeast corner of the claim and travel:

600 feet South to the southeast corner, thence
725 feet West to the south side-center, thence
725 feet West to the southwest corner, thence
600 feet North to the northwest corner, thence
725 feet East to the north side-center, thence
725 feet East to the northeast corner of the claim.

The location work included the making of a claim map as provided in NRS 517.040, a copy of which is filed with the county recorder.

Dated this 30th day of November, 1992.

Matthew B. Powell

Matthew B. Powell, agent for:
Newmont Exploration Limited
P. O. Box 669
Carlin, Nevada 89822

BOOK 243 PAGE 534

BOOK 243 PAGE 534
OFFICIAL RECORDS
RECORDED AT THE REQUEST OF
Newmont Exploration
93 JAN 14 P5:01

EUREKA COUNTY, NEVADA
M.N. REBALEATI, RECORDER
FILE NO. 6-25

143821

BOOK 243 PAGE 535
OFFICIAL RECORDS
RECORDED AT THE REQUEST OF
Newmont Exploration
93 JAN 14 P501

EUREKA COUNTY, NEVADA
MIN. REBATE/LI. RECORDER
FILE NO. 625

143822

BOOK 243 PAGE 535

Matthew B. Powell, agent for:
Newmont Exploration Limited
P.O. Box 669
Carlin, Nevada 89822

Matthew B. Powell

Dated this 30th day of November, 1992.

The location work included the making of a claim map as provided in NRS 517.040, a copy of which is filed with the county recorder.

600 feet South to the southeast corner, thence
725 feet West to the south side-center, thence
725 feet West to the southwest corner, thence
600 feet North to the northwest corner, thence
725 feet East to the north side-center, thence
725 feet East to the northeast corner of the claim.

To locate the monuments, begin at the northeast corner of the claim and travel:

The boundaries of this claim are monumented with 4 inch by 4 inch by 4 1/2 foot long wooden posts. Each monument is marked with a scribed metal tag, which states the claim name and number, and the location of the monument with respect to the claim.
To locate the monuments, begin at the northeast corner of the claim and travel:
600 feet South to the southeast corner, thence
725 feet West to the south side-center, thence
725 feet West to the southwest corner, thence
600 feet North to the northwest corner, thence
725 feet East to the north side-center, thence
725 feet East to the northeast corner of the claim.

The claim is 1450 feet long and 600 feet wide, such that 20 feet is claimed in an East direction and 1430 feet is claimed in a West direction from the location monument, together with 300 feet on each side of the monument of location and center line of the claim. The general course of the claim is East to West.

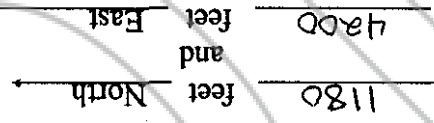

To tie this claim to the public survey, begin at the SW corner of Section 22, T. 34 N., R. 50 E., MDB&M, and travel:

NE 1/4 of Section 34 N., Range 50 E.
NW 1/4 of Section 34 N., Range 50 E.
SE 1/4 of Section 22 Township 34 N., Range 50 E.
SW 1/4 of Section 34 N., Range 50 E.
Mount Diablo Base Line and Meridian, Eureka County, Nevada.

Said claim is located in the following quarter section(s):

Newmont Exploration Limited
P.O. Box 669
Carlin, Nevada 89822

The name and address of the locator is:

The undersigned hereby certifies that he has caused to be located the HIME 33 Lode Mining Claim on the 26th day of October, 1992.

TO ALL WHOM IT MAY CONCERN:

CERTIFICATE OF LOCATION
LODE MINING CLAIM

143822

Newmont Exploration Limited
P.O. Box 669
Carlin, Nevada 89822

Return to:

Return to:

Newmont Exploration Limited
P.O. Box 669
Carlin, Nevada 89822

143823

CERTIFICATE OF LOCATION
LODE MINING CLAIM

TO ALL WHOM IT MAY CONCERN:

The undersigned hereby certifies that he has caused to be located the HIMI 34 Lode Mining Claim on the 26th day of October, 1992.

The name and address of the locator is:

Newmont Exploration Limited
P.O. Box 669
Carlin, Nevada 89822

Said claim is located in the following quarter section(s):

NE 1/4 of Section Township 34 N. Range 50 E.
NW 1/4 of Section Township 34 N. Range 50 E.
SE 1/4 of Section 22 Township 34 N. Range 50 E.
SW 1/4 of Section 23 Township 34 N. Range 50 E.
Mount Diablo Base Line and Meridian, Eureka County, Nevada.

To tie this claim to the public survey, begin at the SW corner of Section 22, T. 34 N., R. 50 E., MDB&M, and travel:

1180 feet North
and
5650 feet East

The claim is 1450 feet long and 600 feet wide, such that 1430 feet is claimed in an East direction and 20 feet is claimed in a West direction from the location monument, together with 300 feet on each side of the monument of location and center line of the claim. The general course of the claim is East to West.

The boundaries of this claim are monumented with 4 inch by 4 inch by 4 1/2 foot long wooden posts. Each monument is marked with a scribed metal tag, which states the claim name and number, and the location of the monument with respect to the claim.

To locate the monuments, begin at the northeast corner of the claim and travel:

600 feet South to the southeast corner, thence
725 feet West to the south side-center, thence
725 feet West to the southwest corner, thence
600 feet North to the northwest corner, thence
725 feet East to the north side-center, thence
725 feet East to the northeast corner of the claim.

The location work included the making of a claim map as provided in NRS 517.040, a copy of which is filed with the county recorder.

Dated this 30th day of November, 1992.

Matthew B. Powell

Matthew B. Powell, agent for:
Newmont Exploration Limited
P.O. Box 669
Carlin, Nevada 89822

BOOK 243 PAGE 536

BOOK 243 PAGE 536
OFFICIAL RECORDS
RECORDED AT THE REQUEST OF
Newmont Exploration
93 JAN 14 P5 01

EUREKA COUNTY, NEVADA
M.N. REBALEATI, RECORDER
FILE NO. 143823

Return to:

Newmont Exploration Limited
P.O. Box 669
Carlin, Nevada 89822

143824

CERTIFICATE OF LOCATION
LODE MINING CLAIM

TO ALL WHOM IT MAY CONCERN:

The undersigned hereby certifies that he has caused to be located the HMI 35 Lode Mining Claim on the 26th day of October, 1992.

The name and address of the locator is:

Newmont Exploration Limited
P.O. Box 669
Carlin, Nevada 89822

Said claim is located in the following quarter section(s):

NE 1/4 of Section 27, Township 34 N., Range 50 E.
NW 1/4 of Section 27, Township 34 N., Range 50 E.
SE 1/4 of Section 27, Township 34 N., Range 50 E.
SW 1/4 of Section 27, Township 34 N., Range 50 E.

Mount Diablo Base Line and Meridian, Eureka County, Nevada.

To tie this claim to the public survey, begin at the SW corner of Section 22, T. 34 N., R. 50 E., MDB&M, and travel:

580 feet North
and
4200 feet East

The claim is 1450 feet long and 600 feet wide, such that 20 feet is claimed in an East direction and 1430 feet is claimed in a West direction from the location monument, together with 300 feet on each side of the monument of location and center line of the claim. The general course of the claim is East to West.

The boundaries of this claim are monumented with 4 inch by 4 inch by 4 1/2 foot long wooden posts. Each monument is marked with a scribed metal tag, which states the claim name and number, and the location of the monument with respect to the claim.

To locate the monuments, begin at the northeast corner of the claim and travel:

600 feet South to the southeast corner, thence
725 feet West to the south side-center, thence
725 feet West to the southwest corner, thence
600 feet North to the northwest corner, thence
725 feet East to the north side-center, thence
725 feet East to the northeast corner of the claim.

The location work included the making of a claim map as provided in NRS 517.040, a copy of which is filed with the county recorder.

Dated this 30th day of November, 1992.

Matthew B. Powell

Matthew B. Powell, agent for:
Newmont Exploration Limited
P.O. Box 669
Carlin, Nevada 89822

BOOK 243 PAGES 37

BOOK 243 PAGE 537
OFFICIAL RECORDS
RECORDED AT THE REQUEST OF
Newmont Exploration
'93 JAN 14 P5:01

EUREKA COUNTY, NEVADA
M.N. REBALEATI, RECORDER
FILE NO. 143824
6/25

Return to:

Newmont Exploration Limited
P.O. Box 669
Carlin, Nevada 89822

143825

CERTIFICATE OF LOCATION
LODE MINING CLAIM

TO ALL WHOM IT MAY CONCERN:

The undersigned hereby certifies that he has caused to be located the HIMI 3b Lode Mining Claim on the 26th day of October, 1992.

The name and address of the locator is:

Newmont Exploration Limited
P.O. Box 669
Carlin, Nevada 89822

Said claim is located in the following quarter section(s):

NE 1/4 of Section 27, Township 34 N., Range 50 E.
NW 1/4 of Section 26, Township 34 N., Range 50 E.
SE 1/4 of Section 22, Township 34 N., Range 50 E.
SW 1/4 of Section 23, Township 34 N., Range 50 E.
Mount Diablo Base Line and Meridian, Eureka County, Nevada.

To tie this claim to the public survey, begin at the SW corner of Section 22, T. 34 N., R. 50 E., MDB&M, and travel:

580 feet North
and
5650 feet East

The claim is 1450 feet long and 600 feet wide, such that 1430 feet is claimed in an East direction and 20 feet is claimed in a West direction from the location monument, together with 300 feet on each side of the monument of location and center line of the claim. The general course of the claim is East to West.

The boundaries of this claim are monumented with 4 inch by 4 inch by 4 1/2 foot long wooden posts. Each monument is marked with a scribed metal tag, which states the claim name and number, and the location of the monument with respect to the claim.

To locate the monuments, begin at the northeast corner of the claim and travel:

600 feet South to the southeast corner, thence
725 feet West to the south side-center, thence
725 feet West to the southwest corner, thence
600 feet North to the northwest corner, thence
725 feet East to the north side-center, thence
725 feet East to the northeast corner of the claim.

The location work included the making of a claim map as provided in NRS 517.040 copy of which is filed with the county recorder.

Dated this 30th day of November, 1992.

Matthew B. Powell

Matthew B. Powell, agent for:
Newmont Exploration Limited
P.O. Box 669
Carlin, Nevada 89822

BOOK 243 PAGES 38

BOOK 243 PAGE 538
OFFICIAL RECORDS
RECORDED AT THE REQUEST OF
Newmont Exploration
92 JAN 14 P5:01

EUREKA COUNTY, NEVADA
MIN. REALEATI. RECORDER
FILE NO. 143825
6
25