

Carlín, Nevada 89822
P.O. Box 669
Newmont Exploration Limited
Mathew B. Powell, agent for:

Mathew B. Powell

Dated this 30th day of November, 1992.

The location work included the making of a claim map as provided in NRS 517.040, a copy of which is filed with the county recorder.

725 feet South to the east side-center, thence
725 feet South to the southeast corner, thence
600 feet West to the southwest corner, thence
725 feet North to the west side-center, thence
725 feet North to the northwest corner, thence
600 feet East to the northeast corner of the claim.

To locate the monuments, begin at the northeast corner of the claim and travel:

The boundaries of this claim are monumented with 4 inch by 4 inch by 4 1/2 foot long wooden posts. Each monument is marked with a scribed metal tag, which states the claim name and number, and the location of the monument with respect to the claim.
To locate the monuments, begin at the northeast corner of the claim and travel:
The claim is 1430 feet long and 600 feet wide, such that 1430 feet is claimed in a North direction and 20 feet is claimed in a South direction from the location monument, together with 300 feet on each side of the monument of location and center line of the claim. The general course of the claim is North to South.

to the northeast corner of the claim.

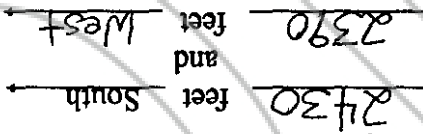

R. 50 E., MDB&M, and travel:

To tie this claim to the public survey, begin at the NE corner of Section 36, T. 35 N.,

Mount Diablo Base Line and Meridian, Eureka County, Nevada.
NE 1/4 of Section 36, Township 35 N., Range 50 E.
NW 1/4 of Section 36, Township 35 N., Range 50 E.
SE 1/4 of Section 36, Township 35 N., Range 50 E.
SW 1/4 of Section 36, Township 35 N., Range 50 E.

Said claim is located in the following quarter section(s):

Newmont Exploration Limited
P.O. Box 669
Carlín, Nevada 89822

The name and address of the locator is:

The undersigned hereby certifies that he has caused to be located the SETR 27 Lode Mining Claim on the 7th day of November, 1992.

TO ALL WHOM IT MAY CONCERN:

144177

CERTIFICATE OF LOCATION
LODE MINING CLAIM

EUREKA COUNTY, NEVADA
M.N. REBALLETI, RECORDER
FILE NO. _____
FEE \$6.25

BOOK 244 PAGE 359
OFFICIAL RECORDS
RECORDED AT THE REQUEST OF
Newmont Exploration Ltd
93 FEB -2 AM 1:10

Newmont Exploration Limited
P.O. Box 669
Carlín, Nevada 89822

144177

Return to: