

R 50 E

T 34 N

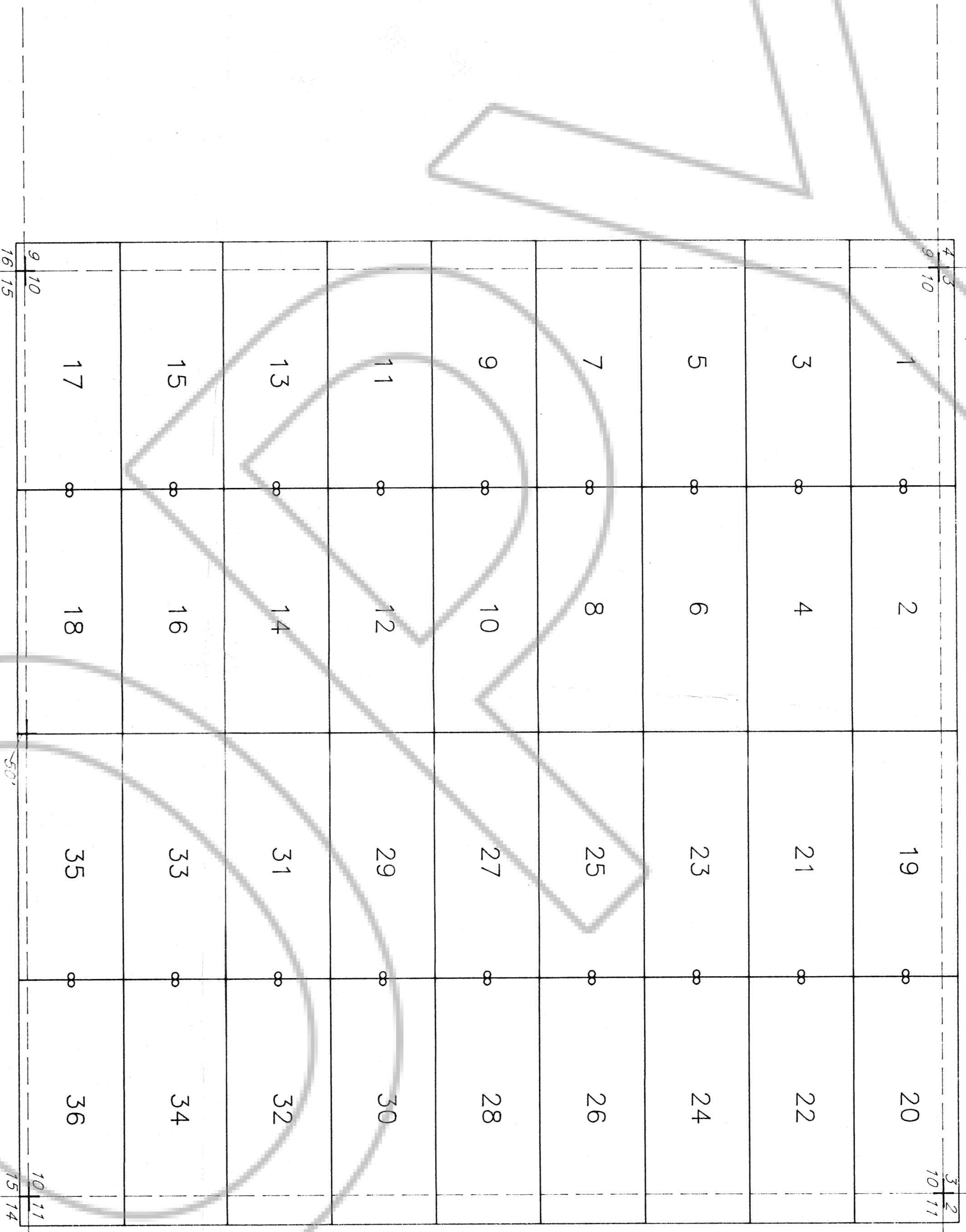

LOCATOR:  
 NEMMONT EXPLORATION LIMITED  
 P.O. Box 669  
 Carlin, Nevada 89822

LOCATION:  
 Section 10 T34N, R50E  
 Mount Diablo Base Line and Meridian  
 Esmeralda County, Nevada

THE POINT:  
 The SE corner of LABB 18 is located 50' South  
 of the S 1/4 corner of Section 10 T34N, R50E.

TYPICAL CLAIM:

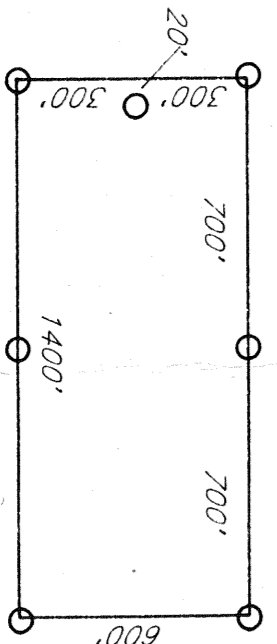

All posts are 4"x4"x4' wooden posts.  
 All claims are 1400' x 600'.  
 Location Monuments are 20' in from end center.

+ Found Section Corner

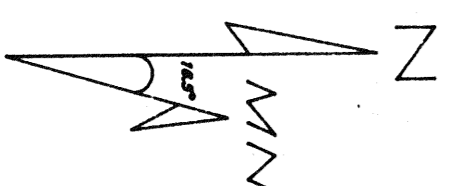

Magnetic Declination 16.5°E

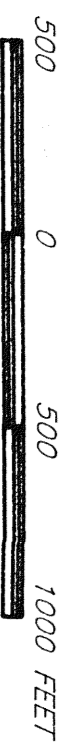

**BIG CREEK**  
**EXPLORATION SERVICES**

LABB 1-36 LODE MINING CLAIMS

December 1, 1992 Located: 11/6/92 Drawn By: CH  
 Completed: 11/19/92 Revised:

5130 Slope Drive, Sun Valley, Nevada 89433 • (702) 674-2708

FILED AT THE REQUEST OF Nemmont Exploration Ltd  
 on 2/2 1993 at OL (times, past 1 P.M.)  
 RECORDS & EMERALDA COUNTY, NEVADA M. N. REBELENTI, Recorder  
 Fee No. 144289 Fees 572.00