

LOCATOR: DAVID R. SHADDRICK, AGENT FOR
 RUBICON RESOURCES
 P.O. BOX 4940, SPARKS, NEVADA 89432

LOCATION:
 Sections 1, 2, 3, 4, 10, 11, 12
 T25N R48E EUREKA COUNTY, NEVADA

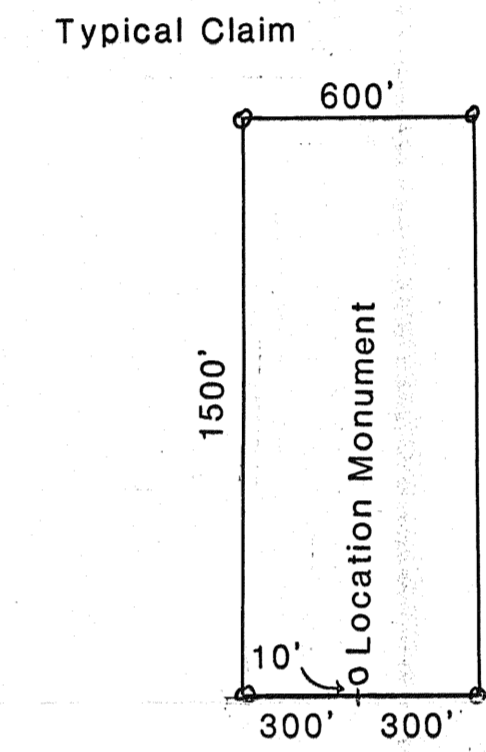

Located: GT 1-36 7/10/93
 GT 37-66 7/11/93

GT 1 - 66 LODGE MINING CLAIMS	
RUBICON RESOURCES	
Scale 1" = 500'	Drawn by : SS 7/15/93

FILED BY THE REQUEST OF *Rubicon Resources*
 on July 15 19 93 at 48 mins. past 12 - M.
 RECORDS OF EUREKA COUNTY, NEVADA M. N. REBELETTI, Recorder
 Fee \$ 9.20
 File No. 145889