

LOCATION DATES

Claims 10-45 Located September 8, 1993
 Claims 9, 87-92 Located September 9, 1993
 Claims 1-8 Located September 11, 1993
 Claims 93-98 Located September 21, 1993
 Claims 66-67 Located September 22, 1993

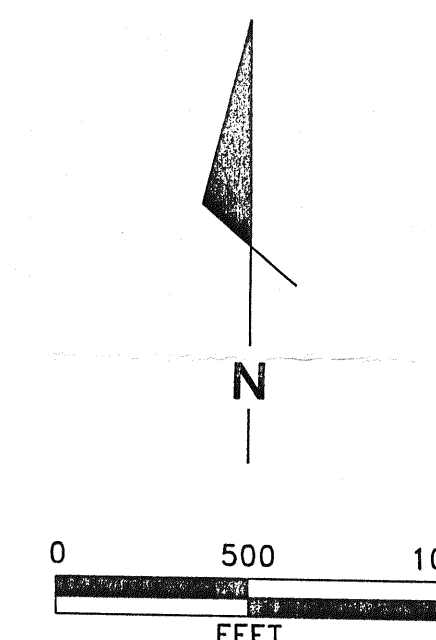

TYPICAL CLAIM

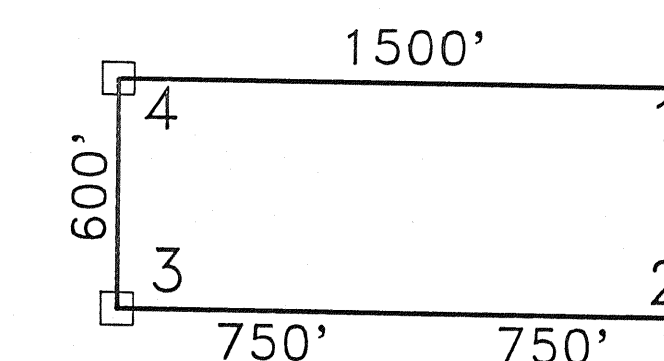

NOTES

ALL CLAIMS ARE 1500' X 600'
 LOCATION MONUMENTS ARE SET IN 20' FROM END LINES
 ALL MONUMENTS ARE 2" X 2" X 4' WOOD

TIE: NE CORNER OF SC 26 IS 100' NORTH,
 AND 500' EAST OF NW CORNER OF SECTION 19, T20N, R53E

LOCATOR:
 KENNECOTT EXPLORATION
 961 MATLEY LANE, SUITE 120
 RENO, NEVADA 89502

147021

FILED AT THE REQUEST OF *Kennecott*
 ON *Oct 14* 19 *93*, at *11:23* AM, by *MA*
 RECORDS OF EUREKA COUNTY, NEVADA M. H. REBALLO, Recorder
 File # *147021* Fee \$ *675.00*

SC 1-45 recorded 10-14-93

Kennecott
 Reno Exploration Office



File: SC.DWG
 Plt: 1=500

Data By: CN
 Drafted By: RL
 Date: 10-11-93
 Revised:

SC LODE CLAIMS
SC 1-45, 66-67, 87-98
EUREKA COUNTY, NEVADA