

R 53 E

T 20 N

EXISTING
PLS CLAIMS

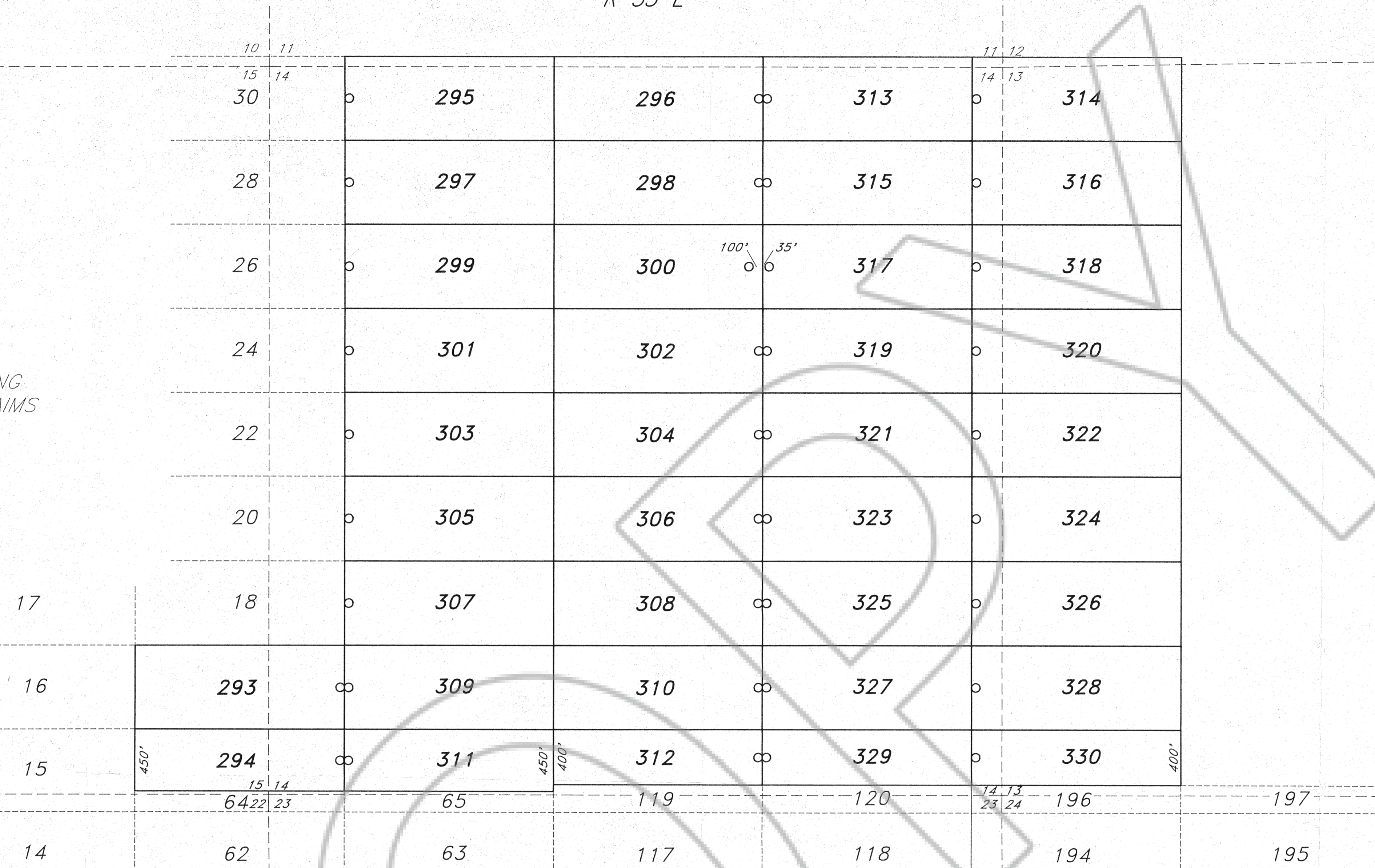

EXISTING
PLS CLAIMS

LOCATOR:
 PLACER DOME U.S. Inc.
 240 South Rock Blvd., Suite 117
 Reno, NV 89502

LOCATION:
 Sections 11-15 T20N, R53E
 Mount Diablo Base Line and Meridian
 Eureka County, Nevada

TIE POINT:
 The SW corner of PLS 330 is 18,200' North and
 100' West of the NW corner of Section 12,
 T19N, R53E, Eureka County, Nevada.

All claims are 1500' x 600' with location monuments
 located 20' in from end lines, except where noted.

LOCATION DATES:
 9/8/93 PLS 293-330

TYPICAL CLAIM:

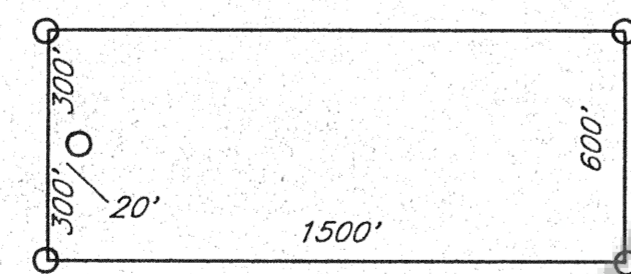

FILED BY THE REQUEST OF CGS, Inc.
 David 23
 RECORDED IN EUREKA COUNTY, NEVADA M. N. RODALENTI Order
 File No. 147424 Fee \$ 520.00

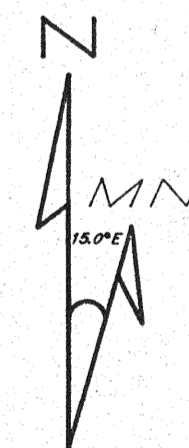

Magnetic Declination 15.0° E

PLS 293-330 LODE MINING CLAIMS		
Scale: 1"=500'	Located: September 8, 1993	Drawn By: GH
Sept. 17, 1993	Completed: September 8, 1993	Revised:
By: CONTRACT GEOLOGICAL SERVICES, INC.		
1395 Greg St., Suite 108, Sparks, Nevada 89431		Map 1 of 1

147424