

T 21 N

2

1

R 49 E  
R 50 E

6

5

HKV 1001	HKV 1002	HKV 1021	HKV 1022	HKV 1041	HKV 1042	HKV 1061	HKV 1062	HKV 1081	HKV 1082	HKV 1101
HKV 1003	HKV 1004	HKV 1023	HKV 1024	HKV 1043	HKV 1044	HKV 1063	HKV 1064	HKV 1083	HKV 1084	HKV 1103
HKV 1005	HKV 1006	HKV 1025	HKV 1026	HKV 1045	HKV 1046	HKV 1065	HKV 1066	HKV 1085	HKV 1086	HKV 1105
HKV 1007	HKV 1008	HKV 1027	HKV 1028	HKV 1047	HKV 1048	HKV 1067	HKV 1068	HKV 1087	HKV 1088	HKV 1107
HKV 1009	HKV 1010	HKV 1029	HKV 1030	HKV 1049	HKV 1050	HKV 1069	HKV 1070	HKV 1089	HKV 1090	HKV 1109
HKV 1011	HKV 1012	HKV 1031	HKV 1032	HKV 1051	HKV 1052	HKV 1071	HKV 1072	HKV 1091	HKV 1092	HKV 1111
HKV 1013	HKV 1014	HKV 1033	HKV 1034	HKV 1053	HKV 1054	HKV 1073	HKV 1074	HKV 1093	HKV 1094	HKV 1113
HKV 1015	HKV 1016	HKV 1035	HKV 1036	HKV 1055	HKV 1056	HKV 1075	HKV 1076	HKV 1095	HKV 1096	HKV 1115
HKV 1017	HKV 1018	HKV 1037	HKV 1038	HKV 1057	HKV 1058	HKV 1077	HKV 1078	HKV 1097	HKV 1098	HKV 1117
HKV 1019	HKV 1020	HKV 1039	HKV 1040	HKV 1059	HKV 1060	HKV 1079	HKV 1080	HKV 1099	HKV 1100	HKV 1119

11

12

7

8

TIE POINT

LOCATOR:  
 HOMESTAKE MINING COMPANY OF CALIFORNIA  
 650 California Street  
 San Francisco, CA 94108

TIE POINTS:  
 The SE Corner of HKV-1079 is the SE Corner  
 of Section 12 T21N, R49E

NOTES:  
 All claims are 1500' X 600' with location monuments  
 located 10' in from end lines.  
 All claim posts are 2"x2"x4' wood.

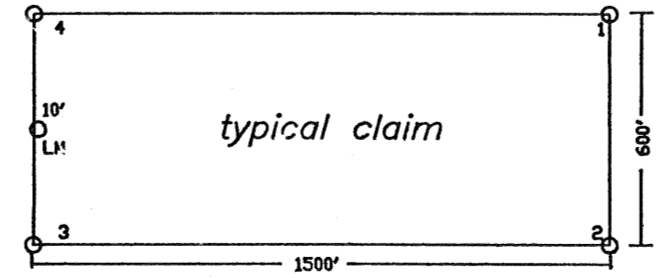

Location monuments are 10' from end center.  
 Numbering begins at Northeast Corner.  
 All claim posts are 2" X 2" X 4' wood posts.

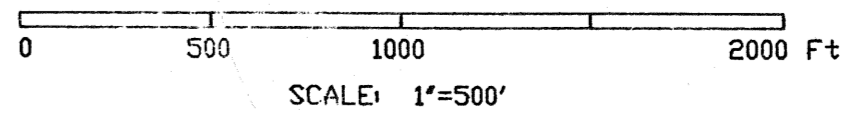

FILED AT THE REQUEST OF *Homestake Mining*  
 on *Dec. 3* 19 *93*, at *7* mins, past *3:41* P.M.  
 RECORDS OF EUREKA COUNTY, NEVADA M. N. REBALEATI, Recorder  
 File No. **149489** Fee \$ *24.660.00*

HKV 1001-1101, 1103, 1105, 1107,  
 1109, 1111, 1113, 1115, 1117, 1119  
 LODE MINING CLAIMS  
 Eureka County, Nevada  
 Sections 1, 2, 11 & 12 T21N, R49E  
 Sections 5, 6, 7 & 8 T21N, R50E

149489

November 1993

Map 1 of 14



HKV 1102	5 HKV 1121	HKV 1122	HKV 1141	HKV 1142	4 HKV 1197	HKV 1198	R50E	3	2		
HKV 1104	HKV 1123	HKV 1124	HKV 1143	HKV 1144	HKV 1199	HKV 1200					
HKV 1106	HKV 1125	HKV 1126	HKV 1145	HKV 1146	HKV 1201	HKV 1202	HKV 1255	HKV 1256	HKV 1307	HKV 1308	
HKV 1108	HKV 1127	HKV 1128	HKV 1147	HKV 1148	HKV 1203	HKV 1204	HKV 1257	HKV 1258	HKV 1309	HKV 1310	
HKV 1110	HKV 1129	HKV 1130	HKV 1149	HKV 1150	HKV 1205	HKV 1206	HKV 1259	HKV 1260	HKV 1311	HKV 1312	
HKV 1112	8 HKV 1131	HKV 1132	HKV 1151	HKV 1152	9 HKV 1207	HKV 1208	HKV 1261	10 HKV 1262	HKV 1313	HKV 1314	11
HKV 1114	HKV 1133	HKV 1134	HKV 1153	HKV 1154	HKV 1209	HKV 1210	HKV 1263	HKV 1264	HKV 1315	HKV 1316	
HKV 1116	HKV 1135	HKV 1136	HKV 1155	HKV 1156	HKV 1211	HKV 1212	HKV 1265	HKV 1266	HKV 1317	HKV 1318	
HKV 1118	HKV 1137	HKV 1138	HKV 1157	HKV 1158	HKV 1213	HKV 1214	HKV 1267	HKV 1268	HKV 1319	HKV 1320	
HKV 1120	HKV 1139	HKV 1140	HKV 1159	HKV 1160	HKV 1215	HKV 1216	HKV 1269	HKV 1270	HKV 1321	HKV 1322	
T21N			HKV 1161	HKV 1162	HKV 1217	HKV 1218	HKV 1271	HKV 1272	HKV 1323	HKV 1324	
			HKV 1163	HKV 1164	HKV 1219	HKV 1220	HKV 1273	HKV 1274	HKV 1325	HKV 1326	
			HKV 1165	HKV 1166	HKV 1221	HKV 1222	HKV 1275	HKV 1276	HKV 1327	HKV 1328	
			HKV 1167	HKV 1168	HKV 1223	HKV 1224	HKV 1277	HKV 1278	HKV 1329	HKV 1330	
			HKV 1169	HKV 1170	16 HKV 1225	HKV 1226	HKV 1279	15 HKV 1280	HKV 1331	HKV 1332	14
			HKV 1171	HKV 1172	HKV 1227	HKV 1228	HKV 1281	HKV 1282	HKV 1333	HKV 1334	
			HKV 1173	HKV 1174	HKV 1229	HKV 1230	HKV 1283	HKV 1284	HKV 1335	HKV 1336	
			HKV 1175	HKV 1176	HKV 1231	HKV 1232	HKV 1285	HKV 1286	HKV 1337	HKV 1338	
			HKV 1177	HKV 1178	HKV 1233	HKV 1234	HKV 1287	HKV 1288	HKV 1339	HKV 1340	

**LOCATOR:**  
 HOMESTAKE MINING COMPANY OF CALIFORNIA  
 650 California Street  
 San Francisco, CA 94108

**TIE POINTS:**  
 The SW Corner of HKV-1120 is 6000' East of  
 the SE Corner of Section 12 T21N, R49E  
 (Tie point on map 1 of 14)

**NOTES:**  
 All claims are 1500' X 600' with location monuments  
 located 10' in from end lines.  
 All claim posts are 2"x2"x4' wood.

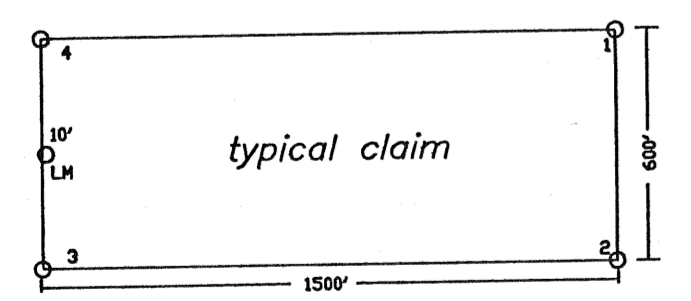

Location monuments are 10' from end center.  
 Numbering begins at Northeast Corner.  
 All claim posts are 2" X 2" X 4" wood posts.

FILED AT THE REQUEST OF Homestake Mining  
 on Dec 3 1993, at 7 mins. past 3 PM.  
 RECORDS OF EUREKA COUNTY, NEVADA M.N. REBALZATI, Recorder  
 File No. 149489 Fee \$ 24,660.00

HKV 1102-1178, 1197-1234  
 1255-1288, 1307-1340  
 LODE MINING CLAIMS  
 Eureka County, Nevada

Sections 4, 5, 8, 9, 10, 14, 15, 16  
 21 & 21 T21N, R50E

November 1993 Map 2 of 14

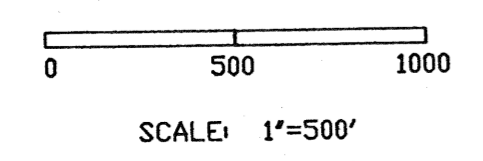



LOCATOR:

HOMESTAKE MINING COMPANY OF CALIFORNIA  
650 California Street  
San Francisco, CA 94108

TIE POINTS:

The SW corner of HKV-1391 is 3600' North and 22500'  
East of SE Corner Section 12 T21N, R49E  
(Tie point on map 1 of 14)

NOTES:

All claims are 1500' X 600' with location monuments  
located 10' in from end lines.

All claim posts are 2"x2"x4' wood.

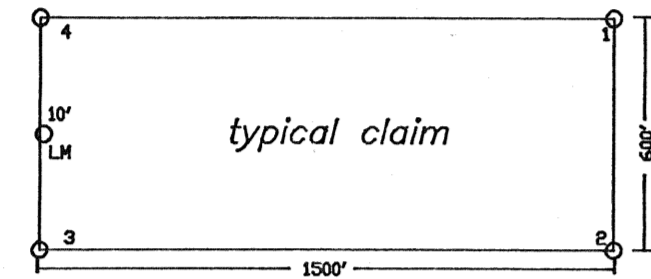

Location monuments are 10' from end center.  
Numbering begins at Northeast Corner.  
All claim posts are 2" X 2" X 4' wood posts.

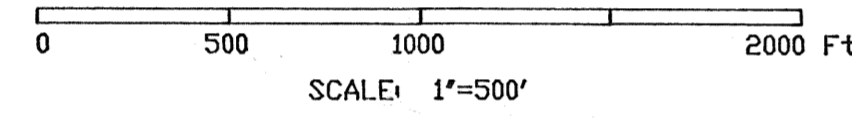

HKV 1390-1401, 1458-1491,  
1556-1589, 1662-1695, 1774-1803  
LODE MINING CLAIMS  
Eureka County, Nevada

Sections 35 & 36 T21N, R50E  
Section 31 T22N, R51E  
Sections 1, 2, 11 & 12 T21N, R50E  
Sections 5, 6, 7 & 8 T21N, R51E

November 1993

Map 3 of 14

35

36

31

R 50 E  
R 51 E

T 22 N

T 21 N

2

1

6

11

12

7

149489



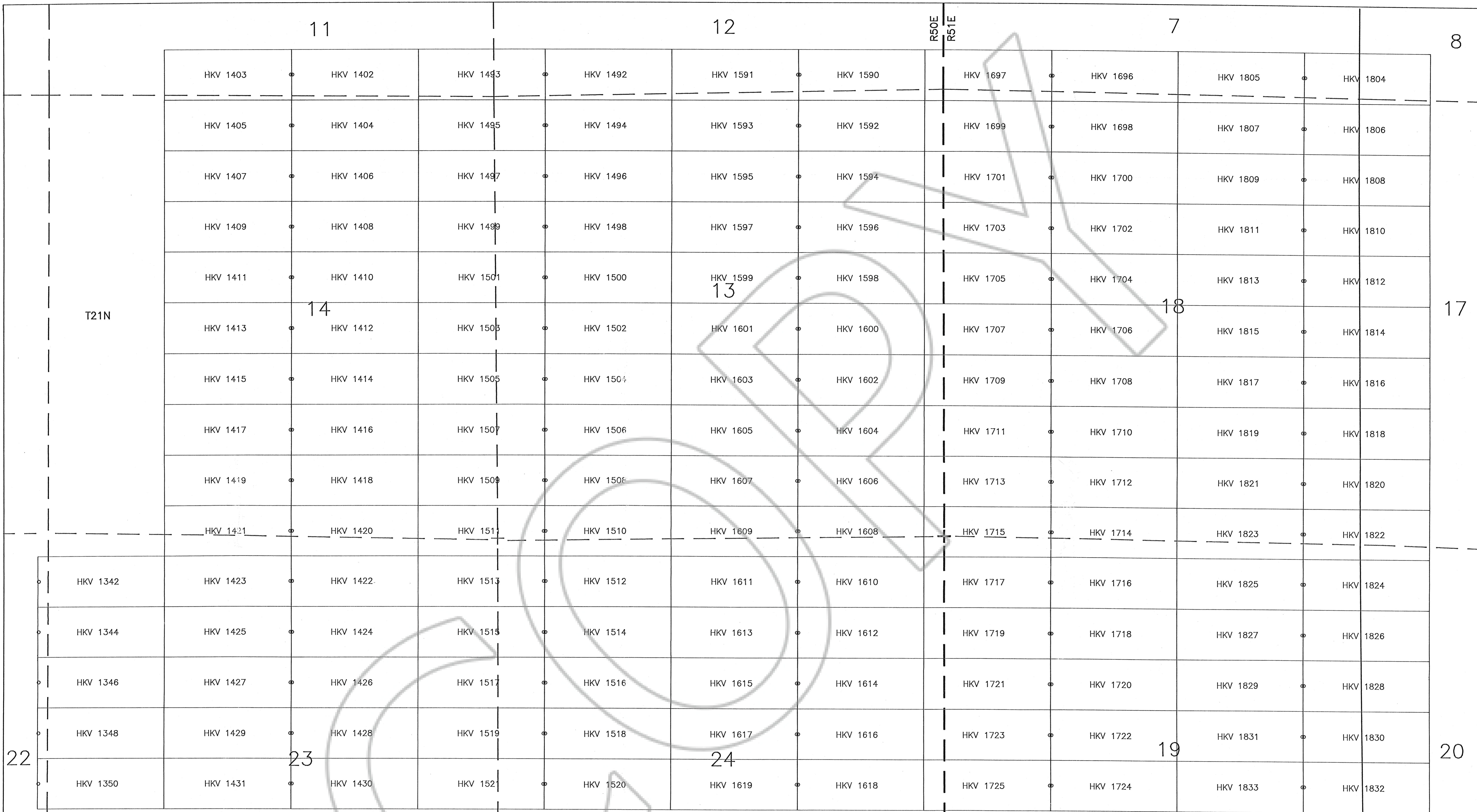

LOCATOR:  
 HOMESTAKE MINING COMPANY OF CALIFORNIA  
 650 California Street  
 San Francisco, CA 94108

TIE POINTS:  
 The SW Corner of HKV-1431 is 8400' South and 21000' East  
 of SE Corner Section 12 T21N, R49E  
 (Tie point on map 1 of 14)

NOTES:  
 All claims are 1500' X 600' with location monuments  
 located 10' in from end lines.  
 All claim posts are 2"x2"x4' wood.

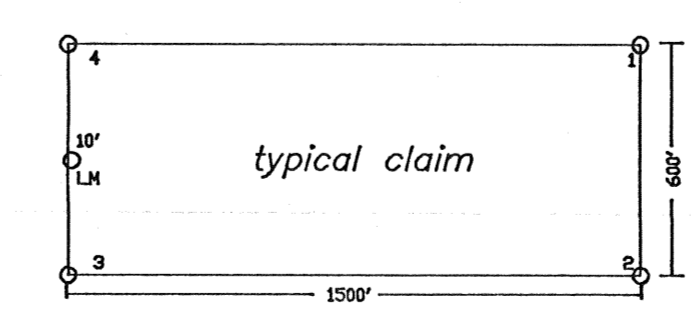

Location monuments are 10' from end center.  
 Numbering begins at Northeast Corner.  
 All claim posts are 2" X 2" X 4' wood posts.

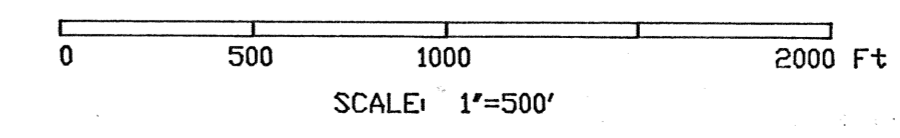
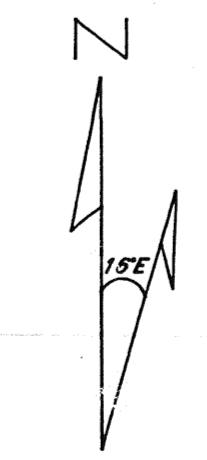

FILED AT THE REQUEST OF Homestake Mining  
 on Dec. 3 1993, at 2 mins, past 3 P.M.  
 RECORDS OF EUREKA COUNTY, NEVADA M. N. REBALEATI, Recorder  
 File No. 149489 Fee \$ 24,660.00

149489

HKV 1342,1344,1346,1348,1350,1402-1431,  
 1492-1521,1590-1619, 1696-1725, 1804-1833  
 LODGE MINING CLAIMS  
 Eureka County, Nevada  
 Sections 11,12,13,14,22,23 & 24 T21N, R50E  
 Sections 7,8,17,18,19 & 20 T21N, R51E  
 November 1993 Map 4 of 14



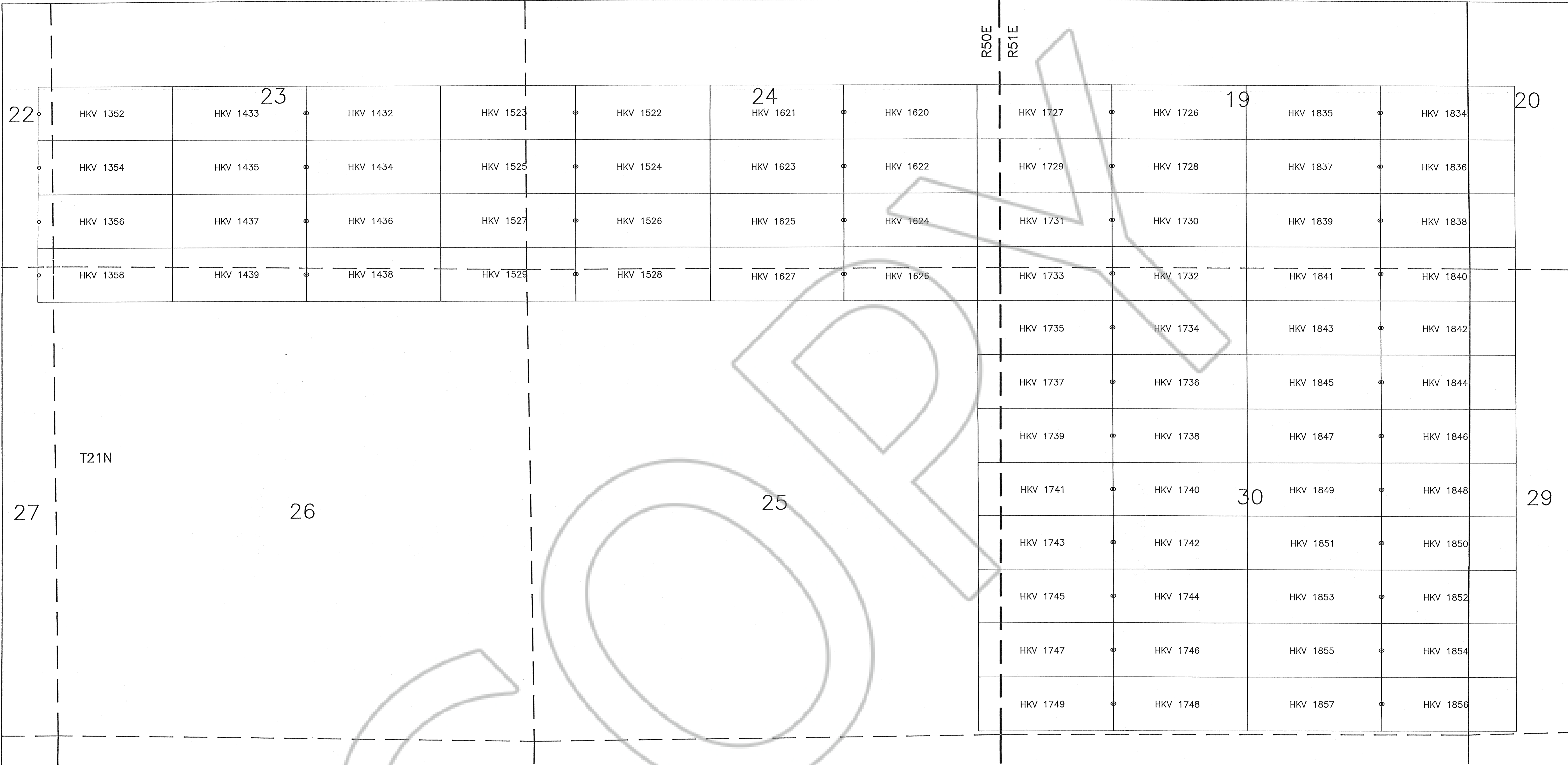

**LOCATOR:**

HOMESTAKE MINING COMPANY OF CALIFORNIA  
 650 California Street  
 San Francisco, CA 94108

**TIE POINTS:**

The NW Corner of HKV-1352 is 8400' South and 21000'  
 East of the SE Corner Section 12 T21N, R49E  
 (Tie point on map 1 of 14)

**NOTES:**

All claims are 1500' X 600' with location monuments  
 located 10' in from end lines.

All claim posts are 2"x2"x4' wood.

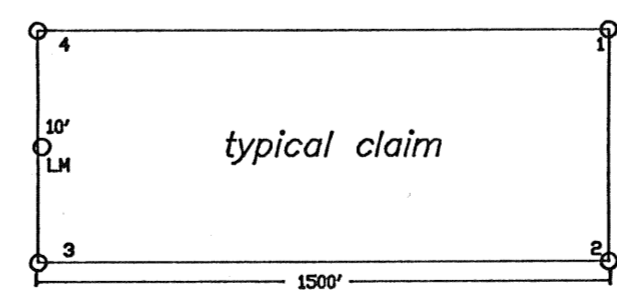

Location monuments are 10' from end center.  
 Numbering begins at Northeast Corner.  
 All claim posts are 2" X 2" X 4' wood posts.

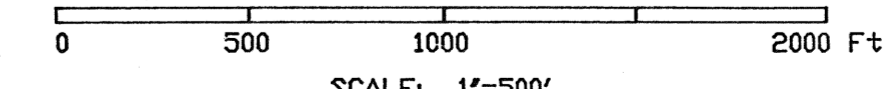
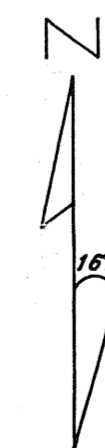

SCALE: 1"=500'

FILED AT THE REQUEST OF *Homestake Mining*  
 on *Dec 3* 19 *93*, at *7* mins, past *3* P.M.  
 RECORDS OF EUREKA COUNTY, NEVADA M. N. REBALEATI, Recorder  
 File No. **149489** Fee \$ **24,660.00**

HKV 1352,1354,1356,1358,1432-1439,  
 1522-1529, 1620-1627, 1726-1749,  
 1834-1857 LODE MINING CLAIMS  
 Eureka County, Nevada

Sections 22,23,24,25,26,27 T21N, R50E  
 Sections 19,20,29,30 T21N, R51E

November 1993

Map 5 of 14

149489



5				4		
HKV 1889	HKV 1888	HKV 1889	HKV 1888			
HKV 1891	HKV 1890	HKV 1991	HKV 1990			
HKV 1893	HKV 1892	HKV 1993	HKV 1992			
HKV 1895	HKV 1894	HKV 1995	HKV 1994			
HKV 1897	HKV 1896	HKV 1997	HKV 1996	9		
HKV 1899	HKV 1898	HKV 1999	HKV 1998			
HKV 1901	HKV 1900	HKV 2001	HKV 2000			
HKV 1903	HKV 1902	HKV 2003	HKV 2002			
HKV 1905	HKV 1904	HKV 2005	HKV 2004			
HKV 1907	HKV 1906	HKV 2007	HKV 2006	HKV 2089	HKV 2088	HKV 2187
HKV 1909	HKV 1908	HKV 2009	HKV 2008	HKV 2091	HKV 2090	HKV 2188
HKV 1911	HKV 1910	HKV 2011	HKV 2010	HKV 2093	HKV 2092	HKV 2189
HKV 1913	HKV 1912	HKV 2013	HKV 2012	HKV 2095	HKV 2094	HKV 2190
HKV 1915	HKV 1914	HKV 2015	HKV 2014	HKV 2097	HKV 2096	HKV 2191
HKV 1917	HKV 1916	HKV 2017	HKV 2016	HKV 2099	HKV 2098	HKV 2192
HKV 1919	HKV 1918	HKV 2019	HKV 2018	HKV 2101	HKV 2100	HKV 2193
HKV 1921	HKV 1920	HKV 2021	HKV 2020	HKV 2103	HKV 2102	HKV 2194
HKV 1923	HKV 1922	HKV 2023	HKV 2022	HKV 2105	HKV 2104	HKV 2195
20				21		

**LOCATOR:**  
 HOMESTAKE MINING COMPANY OF CALIFORNIA  
 650 California Street  
 San Francisco, CA 94108

**TIE POINTS:**  
 The NW corner of HKV-1907 is 37500' East  
 of the SE Corner of Section 12 T21N, R49E  
 (Tie point on map 1 of 14)

**NOTES:**  
 All claims are 1500' X 600' with location monuments  
 located 10' in from end lines.  
 All claim posts are 2"x2"x4' wood.

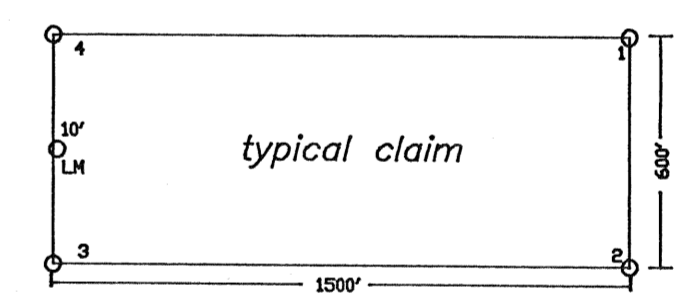

Location monuments are 10' from end center.  
 Numbering begins at Northeast Corner.  
 All claim posts are 2" X 2" X 4' wood posts.

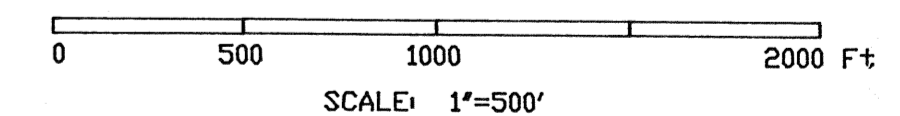
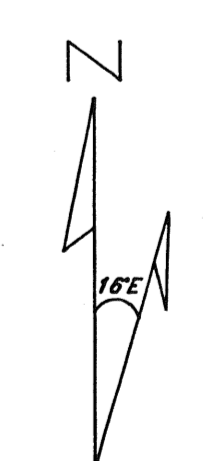

HKV 1888-1923, 1988-2023,  
 2088-2105 & 2187-2195  
 LODE MINING CLAIMS  
 Eureka County, Nevada  
**Sections 4, 5, 8, 9, 15, 16, 17,  
 20, 21, 22 T21N, R51E**  
 November 1993 Map 6 of 14

FILED AT THE REQUEST OF *Homestake Mining*  
 on *Dec 3* 19 *93*, at *2* mins, past *3* P.M.  
 RECORDS OF EUREKA COUNTY, NEVADA M. N. REBALEATI, Recorder  
 File No. *149489* Fee \$ *24,660.00*

149489

22











		HKV 749	o o	HKV 750
HKV 657	o o	HKV 658		
		HKV 751	o o	HKV 752
HKV 659	o o	HKV 660		
		HKV 753	o o	HKV 754
HKV 661	o o	HKV 662		
		HKV 755	o o	HKV 756
HKV 663	o o	HKV 664		
		HKV 757	o o	HKV 758
HKV 665	o o	HKV 666		
		HKV 759	o o	HKV 760
HKV 667	o o	HKV 668		
		HKV 761	o o	HKV 762
HKV 669	o o	HKV 670		
		HKV 763	o o	HKV 764
HKV 671	o o	HKV 672		

34

35

R51E  
R52E

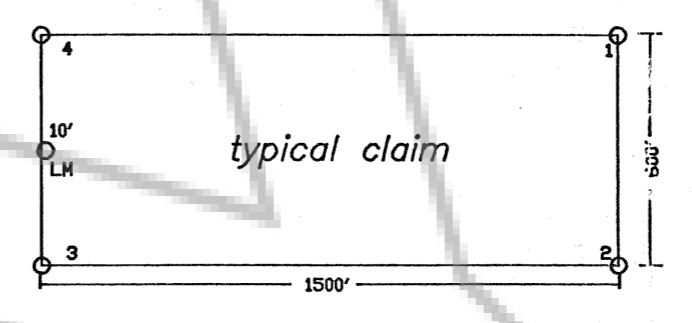

Location monuments are 10' from end center.  
Numbering begins at Northeast Corner.  
All claim posts are 2" X 2" X 4' wood posts.

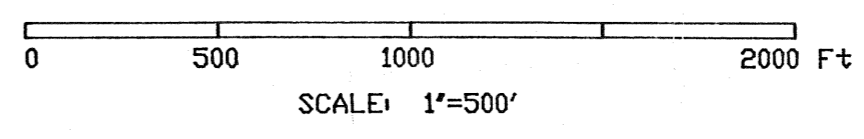
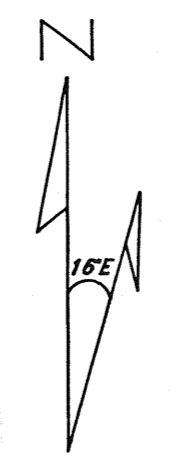

**LOCATOR:**

HOMESTAKE MINING COMPANY OF CALIFORNIA  
650 California Street  
San Francisco, CA 94108

**TIE POINTS:**

The SE corner of HKV-986 is 11700' North and 10800' West if the SW Corner of Section 16 T20N, R52E (Tie point on map 12 of 14)

**NOTES:**

All claims are 1500' X 600' with location monuments located 10' in from end lines.  
All claim posts are 2"x2"x4' wood.

HKV 657-688, 749-782,  
861-876, 929-944, 971-986  
**LODE MINING CLAIMS**  
Eureka County, Nevada  
**Sections 34 & 35 T21N, R51E**  
**Sections 1,2,3,10,11 & 12 T20N, R51E**  
November 1993 Map 9 of 14

		HKV 765	o o	HKV 766
HKV 673	o o	HKV 674		
		HKV 767	o o	HKV 768
HKV 675	o o	HKV 676		
		HKV 769	o o	HKV 770
HKV 677	o o	HKV 678		
		HKV 771	o o	HKV 772
HKV 679	o o	HKV 680		
		HKV 773	o o	HKV 776
HKV 681	o o	HKV 682		
		HKV 775	o o	HKV 786
HKV 683	o o	HKV 684		
		HKV 777	o o	HKV 778
HKV 685	o o	HKV 686		
		HKV 779	o o	HKV 780
HKV 687	o o	HKV 688		
		HKV 781	o o	HKV 782

3

2

T21N  
T20N

1

HKV 861	o o	HKV 862	HKV 929	o o	HKV 930	HKV 971	o o	HKV 972
		HKV 863	HKV 931	o o	HKV 932	HKV 973	o o	HKV 974
HKV 865	o o	HKV 866	HKV 933	o o	HKV 934	HKV 975	o o	HKV 976
		HKV 867	HKV 935	o o	HKV 936	HKV 977	o o	HKV 978
HKV 869	o o	HKV 870	HKV 937	o o	HKV 938	HKV 979	o o	HKV 980
		HKV 871	HKV 939	o o	HKV 940	HKV 981	o o	HKV 982
HKV 873	o o	HKV 874	HKV 941	o o	HKV 942	HKV 983	o o	HKV 984
		HKV 875	HKV 943	o o	HKV 944	HKV 985	o o	HKV 986

10

11

12

149489

R51E  
R52E

FILED AT THE REQUEST OF *Homestake Mining*  
on *Dec 7* 19 *93*, at *7* mins, past *3* M.  
RECORDS OF EUREKA COUNTY, NEVADA M. N. REBALEATI, Recorder  
File No. **149489** Fee \$ **24,600.00**



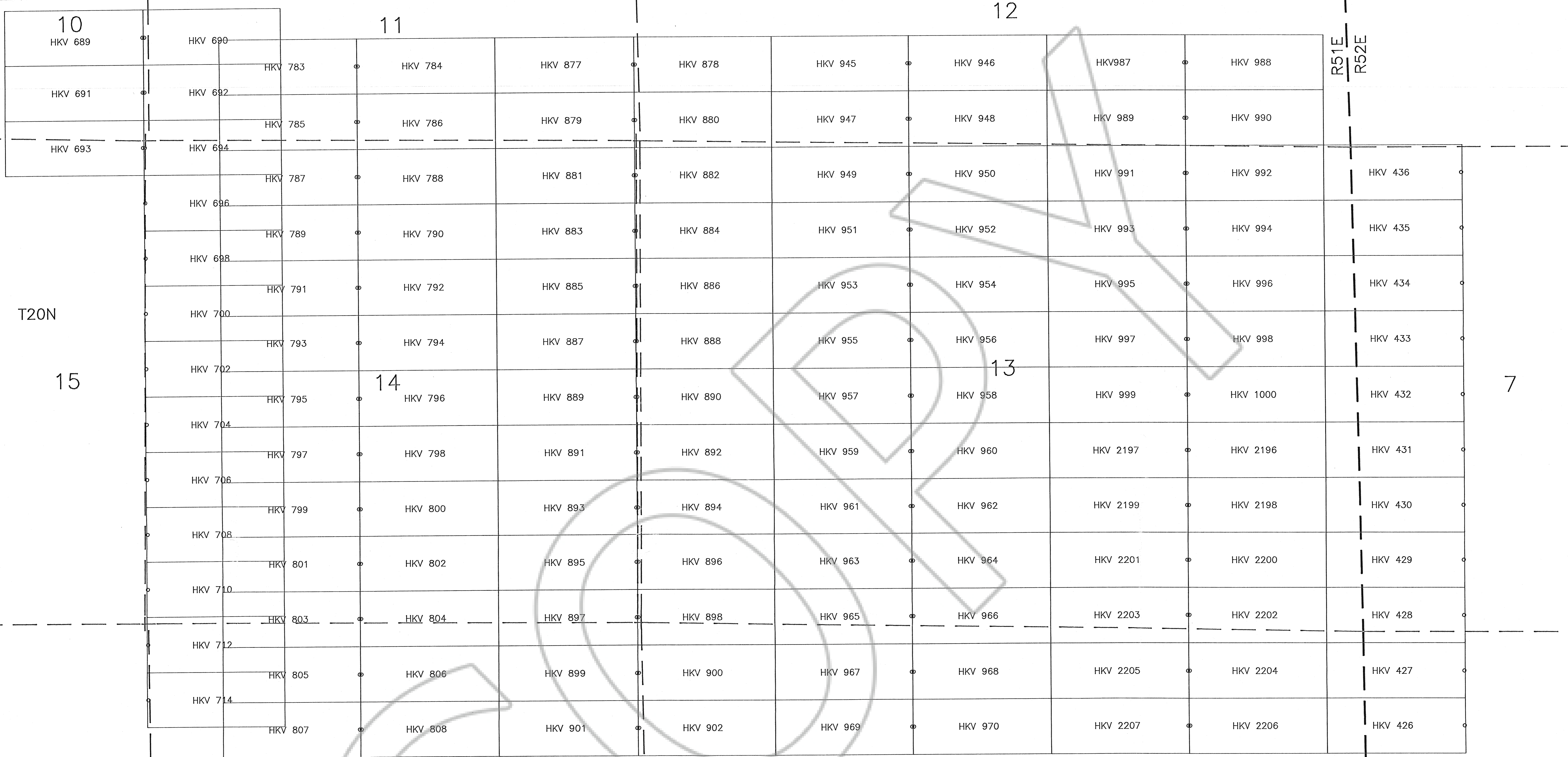

**LOCATOR:**

HOMESTAKE MINING COMPANY OF CALIFORNIA  
 650 California Street  
 San Francisco, CA 94108

**TIE POINTS:**

The NE Corner of HKV-988 is 11700 North and 10800'  
 West of the SW Corner of Section 16 T20N, R52E  
 (Tie point on map 12 of 14)

**NOTES:**

All claims are 1500' X 600' with location monuments  
 located 10' in from end lines.

All claim posts are 2"x2"x4' wood.

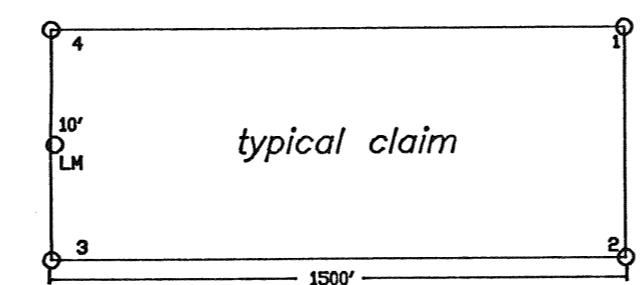

Location monuments are 10' from end center.  
 Numbering begins at Northeast Corner.  
 All claim posts are 2" X 2" X 4' wood posts.

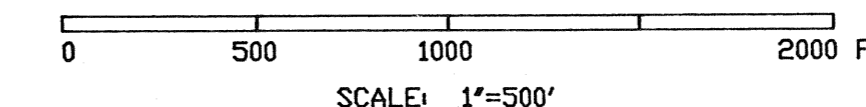

FILED AT THE REQUEST OF *Homestake Mining*  
 on *Dec 3* 19 *93*, at *7* mins past *3* PM,  
 RECORDS AT EUREKA COUNTY, NEVADA M. N. REBALEATI, Recorder  
 File No. **149489** Fee \$ **24,660.00**

HKV 689-694, 783-808, 877-902,  
 945-970, 987-1000, 2196-2207,  
 426-436 LODE MINING CLAIMS  
 Eureka County, Nevada

Sections 10, 11, 12, 13, 14, 15, 22, 23, 24 T20N, R51E  
 Section 7 & 18 T20N, R52E

November 1993

Map 10 of 14

149489



R52E

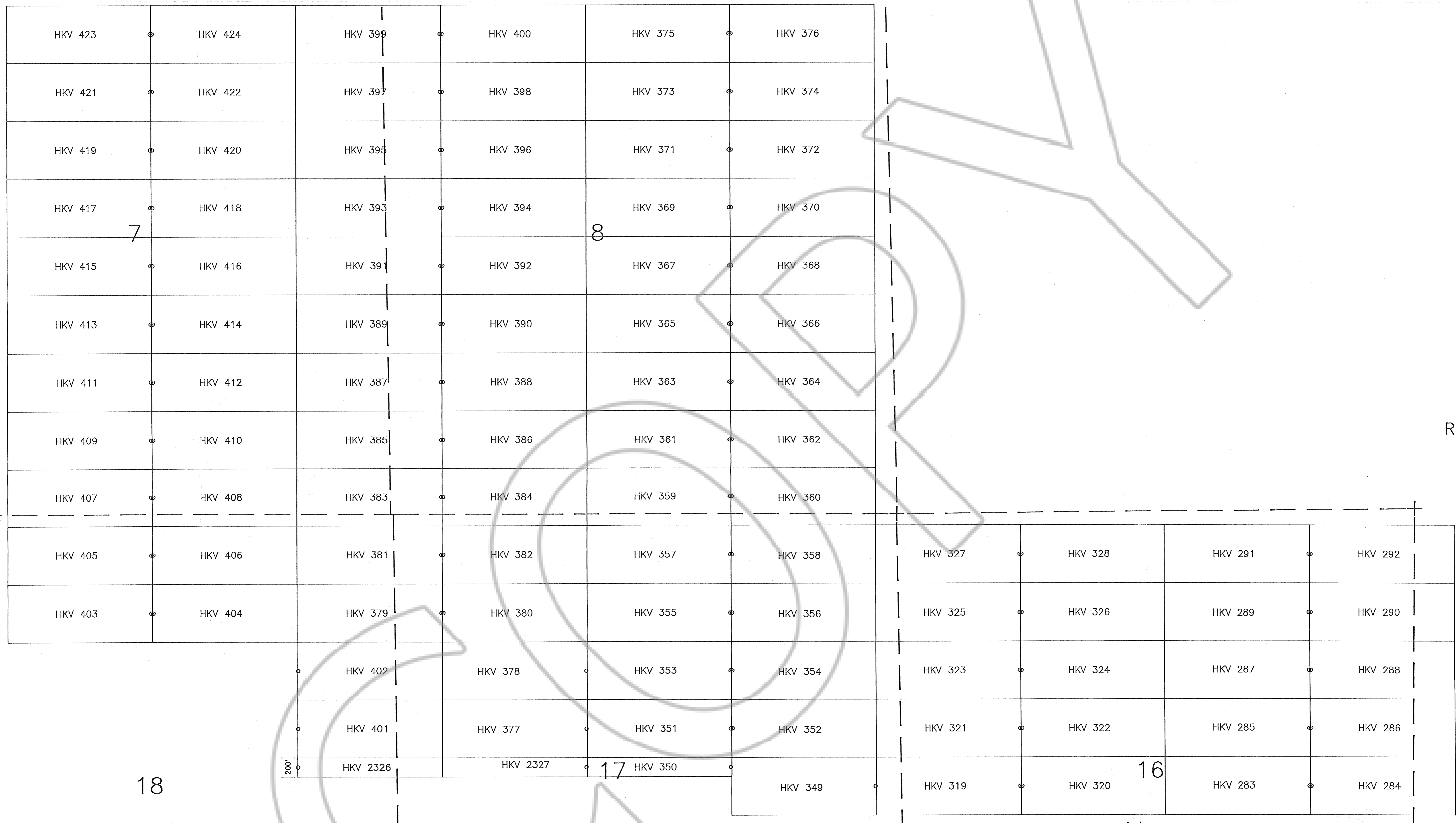

R20N

15

18

16

17

LOCATOR:

HOMESTAKE MINING COMPANY OF CALIFORNIA  
650 California Street  
San Francisco, CA 94108

TIE POINTS:

The SE Corner of HKV-284 is 2100' North and 5700'  
East of SW Corner of Section 16 T20N, R52E  
(Tie point on map 12 of 14)

NOTES:

All claims are 1500' X 600' with location monuments  
located 10' in from end lines.

All claim posts are 2"x2"x4' wood.

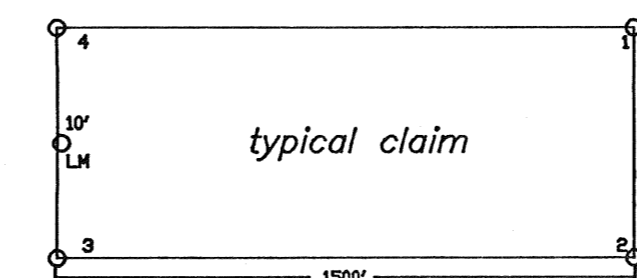

Location monuments are 10' from end center.  
Numbering begins at Northeast Corner.  
All claim posts are 2" X 2" X 4' wood posts.

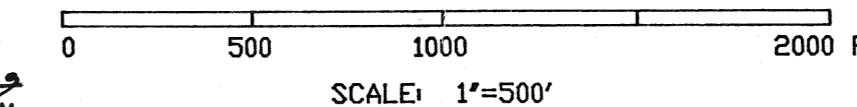
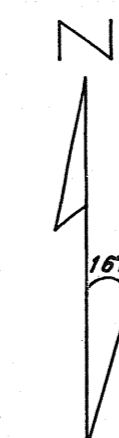

FILED AT THE REQUEST OF Honestake Mining  
on Dec 3 1993, at 7 mins, past 32 M.  
RECORDS OF EUREKA COUNTY, NEVADA M. N. REBALEATI, Recorder  
File No. 149489 Fee \$ 24,600.00

HKV 349-424, 319-328,  
283-292, 2326, 2327  
LODE MINING CLAIMS  
Eureka County, Nevada  
**Section 7, 8, 15, 16, 17, 18, T20N, R52E**  
November 1993 Map 11 of 14



18

17

R52E

16

15

HKV 348	HKV 317	HKV 318	HKV 281	HKV 282		
HKV 347	HKV 315	HKV 316	HKV 279	HKV 280		
HKV 346	HKV 313	HKV 314	HKV 277	HKV 278		
HKV 345	HKV 311 Tie Point	HKV 312	HKV 275	HKV 276		
	HKV 309	HKV 310	HKV 273	HKV 274		
	HKV 307	HKV 308	HKV 271	HKV 272		
	HKV 305	HKV 306	HKV 269	HKV 270		
	HKV 303	HKV 304	HKV 267	HKV 268		
HKV 343	HKV 344	HKV 334	HKV 301	HKV 302	HKV 265	HKV 266
HKV 341	HKV 342	HKV 332	HKV 299	HKV 300	HKV 263	HKV 264
HKV 339	HKV 340	HKV 331	HKV 297	HKV 298	HKV 261	HKV 262
HKV 337	HKV 338	HKV 330	HKV 295	HKV 296	HKV 259	HKV 260
HKV 335	HKV 336	HKV 329	HKV 293	HKV 294	HKV 257	HKV 258

19

T20N

20

21

22

29

28

27

LOCATOR:

HOMESTAKE MINING COMPANY OF CALIFORNIA  
650 California Street  
San Francisco, CA 94108

TIE POINTS:

The NE corner of HKV-282 is 2100' North and  
5700' East of the SW Corner of Section 16 T20N, R52E

NOTES:

All claims are 1500' X 600' with location monuments  
located 10' in from end lines.  
All claim posts are 2"x2"x4' wood.

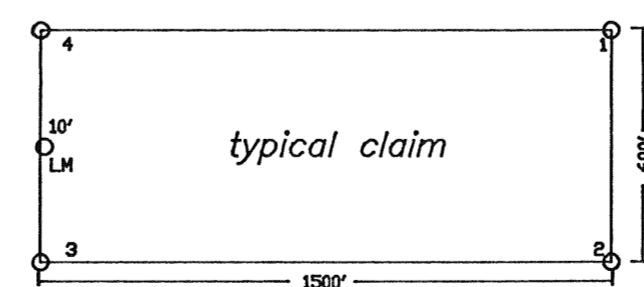

Location monuments are 10' from end center.  
Numbering begins at Northeast Corner.  
All claim posts are 2" X 2" X 4' wood posts.



0 500 1000 2000 Ft

SCALE: 1"=500'

FILED AT THE REQUEST OF Homestake Mining  
on Dec 3 1993, at 7 mins, past 3 P.M.  
RECORDS OF EUREKA COUNTY, NEVADA M. N. REBALEATI, Recorder  
File No. 149489 Fee \$ 24,660.00

HKV 329-332, 334-344, 293-318  
345-348, 257-282  
LODE MINING CLAIMS  
Eureka County, Nevada

Sections 15, 16, 17, 20, 21, 22, 27, 28, 29 T20N, R52E

November 1993

Map 12 of 14

149489



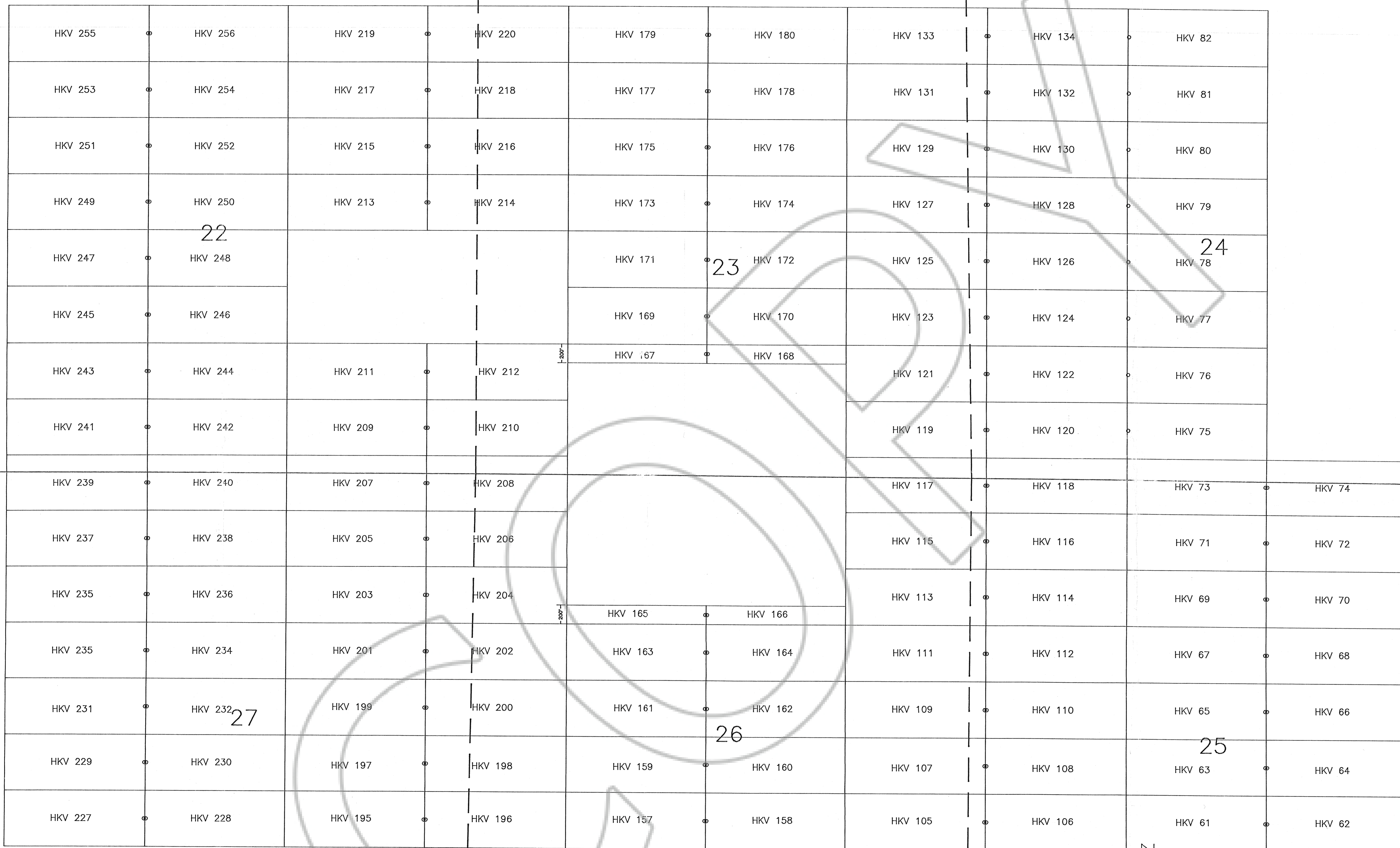

LOCATOR:  
 HOMESTAKE MINING COMPANY OF CALIFORNIA  
 650 California Street  
 San Francisco, CA 94108

149489

TIE POINTS:  
 The SE corner of HKV-62 is 500' West and 3950' South  
 of the SE Corner of Section 24 T20N, R52E

NOTES:  
 All claims are 1500' X 600' with location monuments  
 located 10' in from end lines.  
 All claim posts are 2"x2"x4' wood.

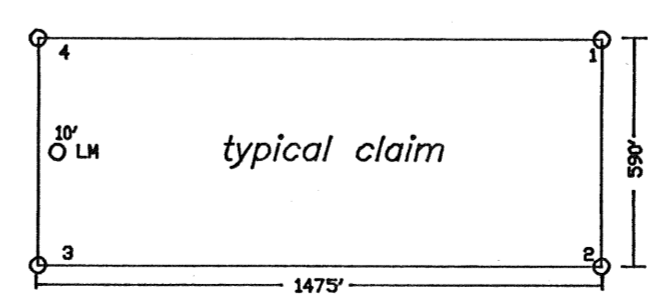

Location monuments are 10' from end center.  
 Numbering begins at Northeast Corner.  
 All claim posts are 2 X 2 wood posts.

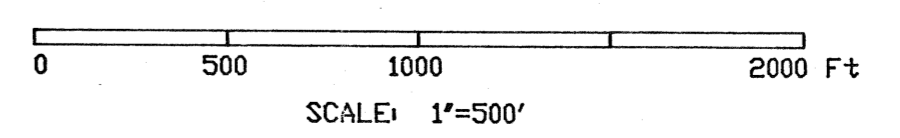

FILED AT THE REQUEST OF Homestake Mining  
 on Dec. 3 1993, at 2 mins. past 3 p.m.  
 RECORDS OF EUREKA COUNTY, NEVADA M. N. REBELETTI, Recorder  
 File No. 149489 Fee \$ 24,660.00

HKV 61-82, 105-134, 157-180  
 195-220, 227-256 LODE MINING CLAIMS  
 Eureka County, Nevada

Sections 22, 23, 24, 25, 26 & 27 T20N, R52E

November 1993 Map 13 of 14



27

26

25

HKV 225	HKV 226	HKV 193	HKV 194	HKV 155	HKV 156	HKV 103	HKV 104	HKV 59	HKV 60
HKV 223	HKV 224	HKV 191	HKV 192	HKV 153	HKV 154	HKV 101	HKV 102	HKV 57	HKV 58
HKV 221	HKV 222	HKV 189	HKV 190	HKV 151	HKV 152	HKV 99			
			HKV 188	HKV 149	HKV 150	HKV 97			
			HKV 187	HKV 147	HKV 148	HKV 95			
			HKV 186	HKV 145	HKV 146	HKV 93			
			HKV 185	HKV 143	HKV 144	HKV 91	HKV 92	HKV 47	HKV 48
			HKV 184	HKV 141	HKV 142	HKV 89	HKV 90	HKV 45	HKV 46
			HKV 183	HKV 139	HKV 140	HKV 87	HKV 88	HKV 43	HKV 44
			HKV 182	HKV 137	HKV 138	HKV 85	HKV 86	HKV 41	HKV 42
			HKV 181	HKV 135	HKV 136	HKV 83	HKV 84	HKV 39	HKV 40

R52E  
R53E

34

35

36

T20N  
T19N

6

R52E  
R53E

LOCATOR:  
 HOMESTAKE MINING COMPANY OF CALIFORNIA  
 650 California Street  
 San Francisco, CA 94108

149489

TIE POINTS:  
 The NE corner of HKV-60 is 500' West and 3950' South  
 of the SE Corner of Section 24 T20N, R52E  
 (Tie point on map 13 of 14)

NOTES:  
 All claims are 1500' X 600' with location monuments  
 located 10' in from end lines.  
 All claim posts are 2"x2"x4' wood.

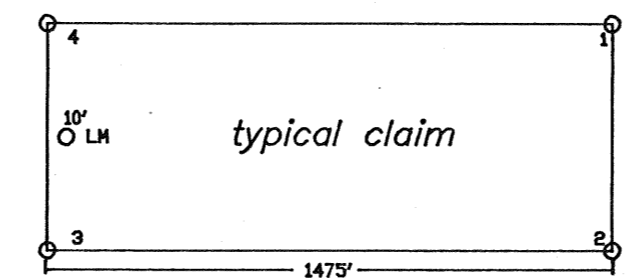

Location monuments are 10' from end center.  
 Numbering begins at Northeast Corner.  
 All claim posts are 2 X 2 wood posts.

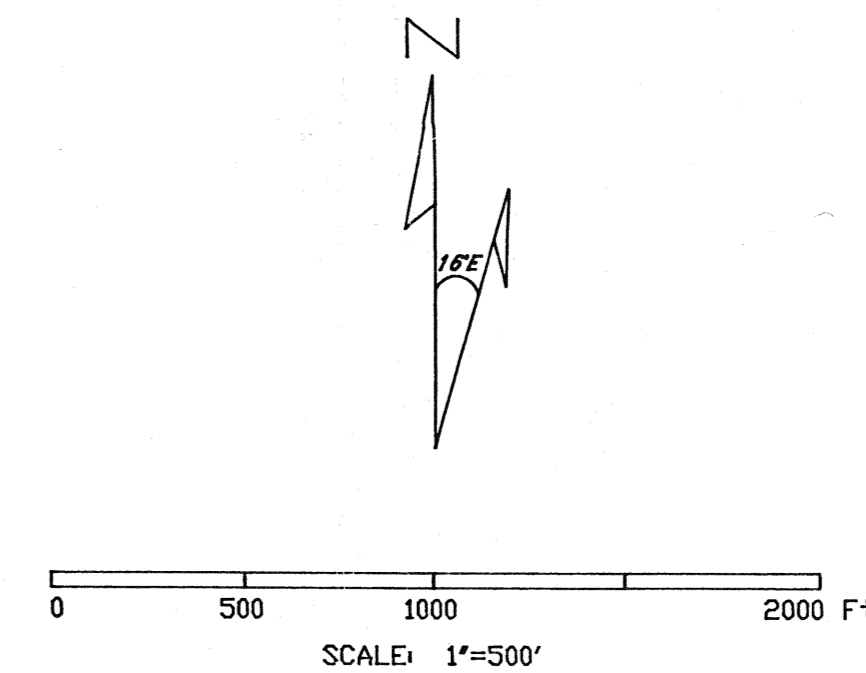

FILED AT THE REQUEST OF *Homestake Mining*  
 on Dec 3, 1993, at 7:22 mins, past 3:22 M.  
 RECORDS OF EUREKA COUNTY, NEVADA M. H. REBALEATI, Recorder  
 File No. 149489 Fee \$ 27,650.00

HKV 39-48, 57-60, 83-93, 95, 97, 99,  
 101-104, 135-156, 181-194, 221-226  
 LODGE MINING CLAIMS  
 Eureka County, Nevada  
 Sections 25, 26, 27, 34, 35, 36, 37 T20N, R52E

November 1993

Map 14 of 14