

NORTHEAST
CORNER
SECTION 12
T18N, R52E
MT. DIABLO P.M.

DUE SOUTH 4,271 FEET

DUE WEST 7,780 FEET

NOTES:

- 1) CORNER OF SECTIONS 10, 11, 14 & 15 IS PROJECTED.
- 2) LOCATION MONUMENTS ARE 10' FROM END CENTER OF CLAIMS.
- 3) ALL CLAIM CORNERS AND LOCATION MONUMENTS ARE 2" x 2" x 4' WOOD POSTS.
- 4) LOCATION DATE IS APRIL 25, 1994.
- 5) MAP WAS AMENDED TO MORE CLOSELY SHOW POSITION OF CLAIMS ON GROUND BY TYING TO ESTABLISHED MONUMENT.
- 6) COMMON CORNER OF SECTIONS 10, 11, 14 & 15 WAS PROJECTED 5,280' SOUTH AND 10,560' WEST FROM NORTHEAST CORNER SECTION 12, T18N, R52E.

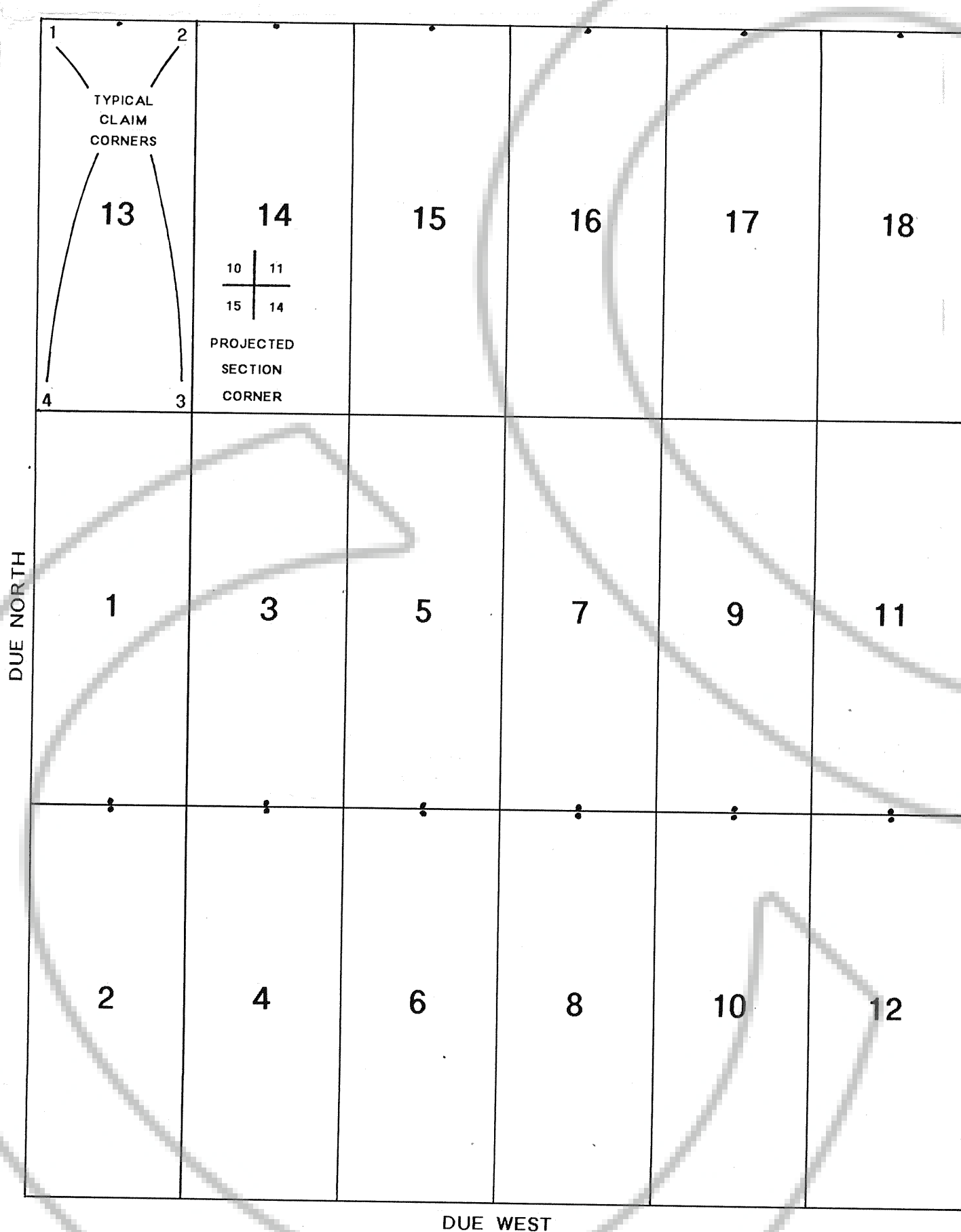

AMENDED MAP
MAP AMENDS EUREKA COUNTY FILE NO. 152507
RECORDED ON APRIL 25, 1994

FT LODGE MINING CLAIMS NO'S 1-18
UNSURVEYED SECTIONS 10, 11, 14 & 15
T18N, R52E, MDB&M EUREKA COUNTY, NEVADA

OWNER:
HOLY TERROR MINING COMPANY
682 NORTH MAIN STREET
BUFFALO, WYOMING 82834
(303) 684-5579

T
1
8
N

MADE AT THE REQUEST OF Holy Terror Mining Co.
on May 10, 1994, at 10 mins. past 2 P.M.
RECORDS OF EUREKA COUNTY, NEVADA M. N. REBALEATI, Recorder
File No. 152598 Fee \$ 5.00

152598

R 52 E