

**Buckaroo 391-394**  
 Claims measure 1,500 ft on bearing due East  
 and 600 ft on bearing due North

NE corner of Buckaroo 389 is SE corner  
 of previously recorded Buckaroo 313

**Buckaroo 389-390**  
 Claims measure 1,500 ft on bearing due East  
 and 400 ft on bearing due North

Previously recorded Buckaroo claims

TIE POINT: SE corner of Buckaroo 270  
 is 13,029' due West and 297' due South  
 of section corner 18/19 of T 20 N, R 53 E  
 and 13/24 of T 20 N, R 52 E

Claims are in unsurveyed sections.  
 Section grid shown is approximate.

	R 52 E	R 53 E
T 20 N	13 24	18 19

**Buckaroo 219-226, 269-276**  
 Claims measure 1,500 ft on bearing due North  
 and 600 ft on bearing due East.

FILED AT THE REQUEST OF Euro Nevada Mining  
 on Oct 6 1994, at 05 mins, past 22 M.  
 RECORDS OF EUREKA COUNTY, NEVADA M. N. REBALEATI, Recorder  
 File No. 155422 Fee \$ 330.00

**Buckaroo Claims**

**Buckaroo 219-226, 269-276, 389-394**

Unknown Mining District, Eureka County, Nevada  
 Sections 9, 10, 15, and 22  
 of T 20 N, R 52 E, MDBM.

Located and owned by:  
 Euro-Nevada Mining Corp., Inc.  
 6121 Lakeside Drive, Suite 240,  
 Reno, Nevada 89511

Location date: Buckaroo 219-226 located July 9, 1994  
 Buckaroo 269-276 located July 10, 1994  
 Buckaroo 389-394 located September 3, 1994

Typical claim:

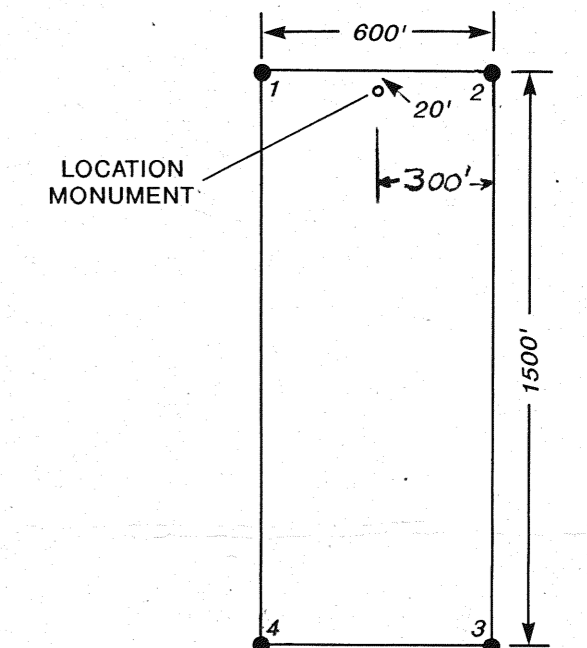

Location monument is 20' from end line.  
 All corners and location monuments are 4' by 2" X 2"  
 wooden posts with aluminum tags.  
 Numbering posts begin in the NW claim corner.

*Peter Maciulaitis*  
 Peter Maciulaitis, agent September 6, 1994

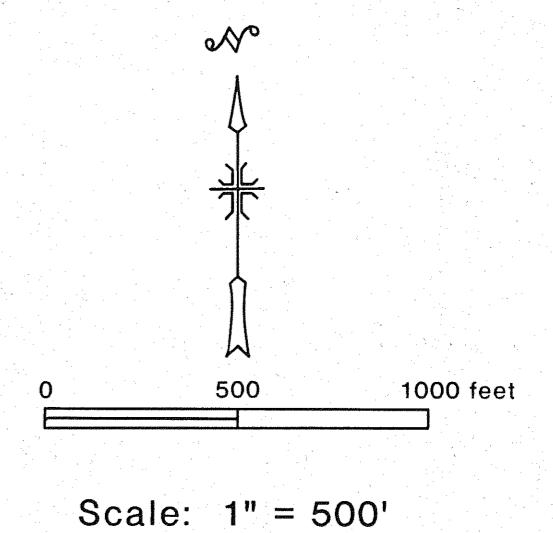

Scale: 1" = 500'