

EXPLANATION

Tie: from the found common SE corner of Section 21 and the SW corner of Section 22, T24N, R48E, 4500' east and 520' north to the northeast corner, ie corner #1 of KS 142.

Tie: from the found common SE corner of Section 21 and the SW corner of Section 22, T24N, R48E, 1500' east and 5320' north to the northeast corner, ie corner #1 of KS 151.

All claims are located in T24N, R48E, Eureka County, NV
 Subdued lines represent existing KS claims.
 Dashed lines represent projected section lines.

All claims are 600 feet wide by 1500 feet long with the location monument set 20 feet from the end line and 300 feet from either side, unless otherwise noted.

Total number of claims= 14.

KS 140-148 located: 6/10/94.
 Monumenting completed: 6/10/94.
 KS 149-153 located: 6/24/94
 Monumenting completed: 6/24/94

Scale: 1"=500'

NOTE: This map is only a graphical depiction of the location of the properties and is not to be used for surveying or any other purpose that requires exactness in accuracy.

This material is furnished by Placer Dome U.S. Inc., without warranty or representation of any kind, expressed or implied, except that this material was correct to the best of its knowledge at the time the material was prepared. Placer Dome U.S. Inc. expressly disclaims liability for any factual or interpretive errors in the material.

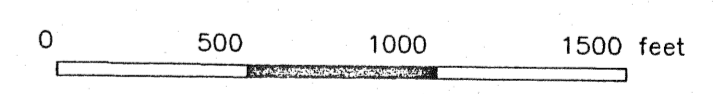
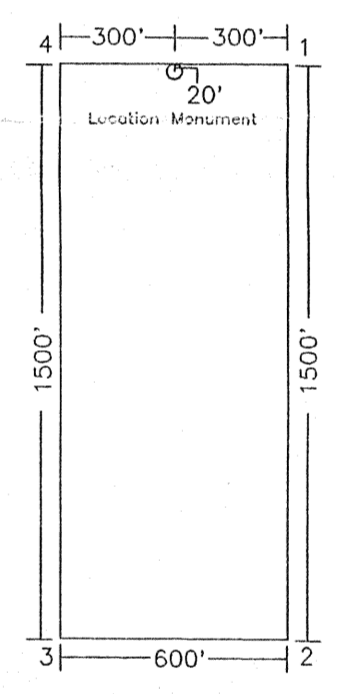

AMENDED MAP

DRAWN: CMB		KS 140-148	
DATE: 4-14-94		KS 149-153	
REVISED: CMB		Eureka County, NV	
DATE: 9-16-94		ACAD FILE: KS-CLM1	

Walt: Hot Springs 7.5 Minute Quad

FILED AT THE REQUEST OF Placer Dome
 on Dec 14 19 97 at 27 mins. past 11 AM.
 RECORDS OF EUREKA COUNTY, NEVADA M. N. REBALL
 File No. 156163 Fee \$ 7.00