

LOCATOR:
KENNECOTT EXPLORATION
961 MATLEY LANE, SUITE 120
RENO, NEVADA 89502

LOCATION DATES

Claims 45-54 Located April 17, 1996
Claims 1-16, 41-44, 55-80 Located April 18, 1996
Claims 17-40 Located April 19, 1996

12000' EAST

12000' WEST

6000' NORTH

T. 19 N
T. 18 N

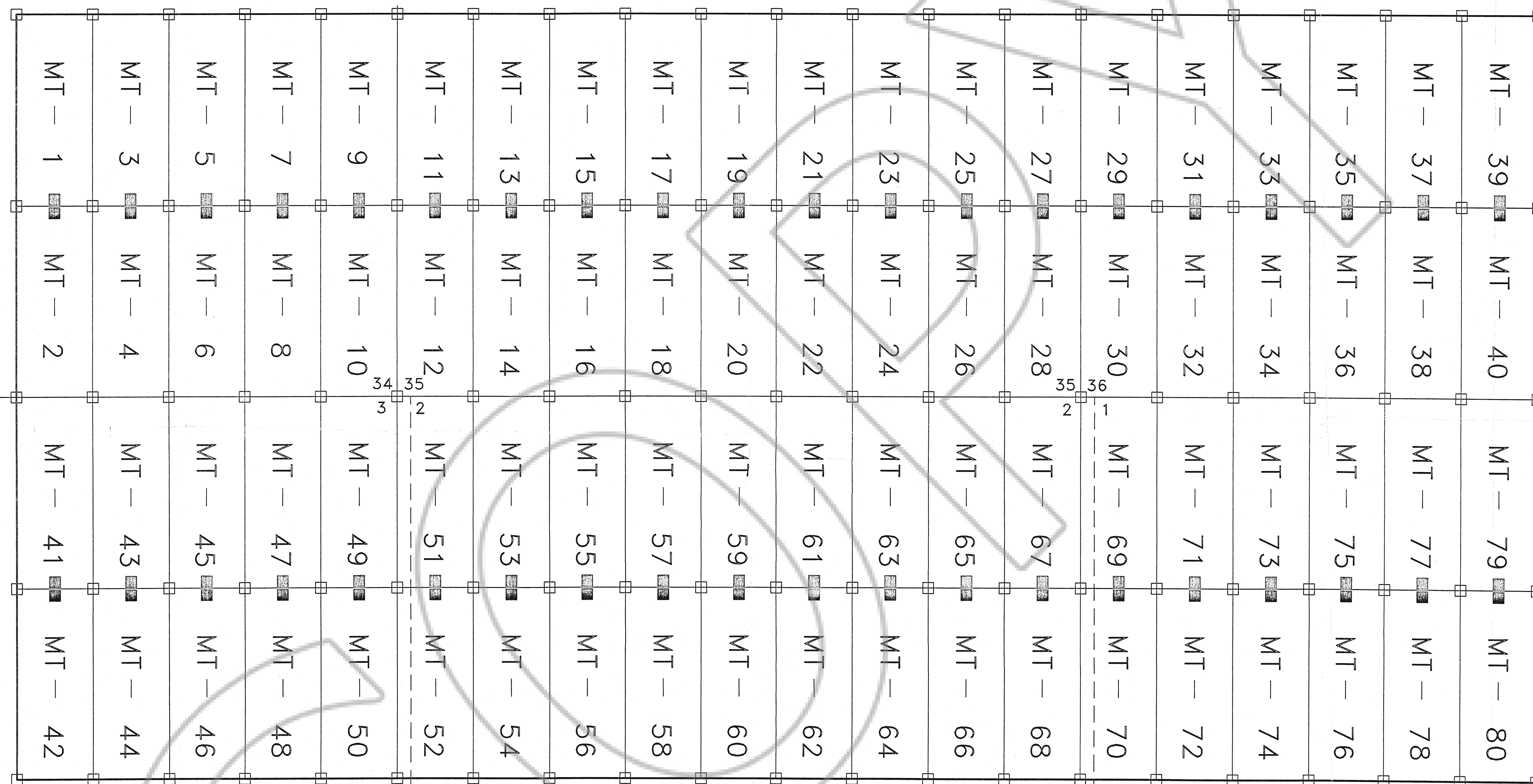

TIE: 3386.25'
N270°37'59" W

R. 49 E
R. 50 E

6000' SOUTH

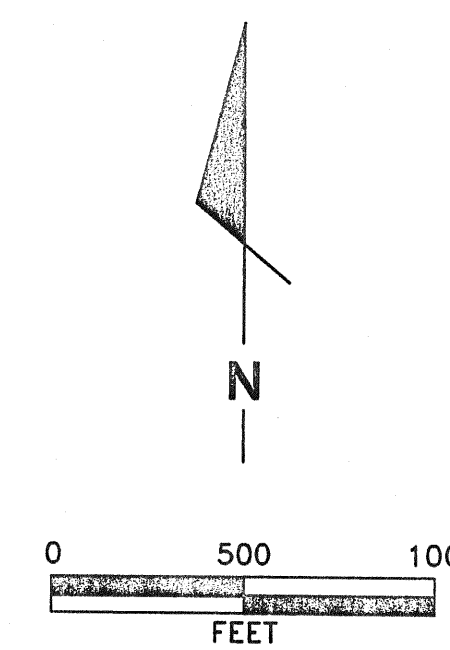

TYPICAL CLAIM

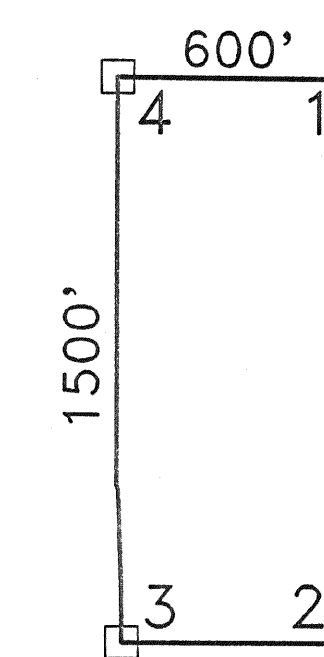

NOTES

ALL CLAIMS ARE 1500' X 600'
LOCATION MONUMENTS ARE SET IN 5' FROM END LINES
ALL MONUMENTS ARE 2" X 2" X 4' WOOD

FILED AT THE REQUEST OF *Kennecott Exploration*
on *July 10 1996*, at *11:11 AM*
RECORDS OF EUREKA COUNTY, NEVADA M. N. REBELETTI, Recorder
Fee \$ *1200.00*
File No. **163378**

Kennecott
Reno Exploration Office



File: MT
Plt: 1=500

Data By:
Drafted By:
Date: 6-24-96
Revised:

**MT LODE CLAIMS
MT 1-80
EUREKA COUNTY, NEVADA**