

164265

EASEMENT

Received of Citizenstelecom - Nevada, a corporation (Grantee), valuable consideration for which the undersigned, RAY BAILEY - JACKIE BAILEY (Grantors), hereby grant and convey to that corporation, the exclusive easement and right to construct, reconstruct, operate, maintain, repair, replace and remove telephone lines and all necessary cables, pipes, and appurtenances under a strip of land, the center line of said strip described as follows:

See EXHIBIT "A" attached hereto and incorporated herein.

TOGETHER with the right to fell or trim any trees or brush thereon, or upon our adjacent lands, for obtaining and maintaining proper access for said line. Grantee agrees to maintain easement and any used adjacent lands in as good or better condition than prior to the execution of this easement.

Grantor agrees not to erect or construct any building or other structure, or drill or operate any well, or construct any reservoir or other obstruction, or add to the ground level in said strip, and further agrees not to deposit, or permit or allow to be deposited, earth, rubbish, debris, or any other substance or material, on said strip or so near thereto as to constitute, in the opinion of the Grantee, a hazard to its said facilities.

The provisions of this easement shall remain in effect until Grantee ceases to use its facilities for a period of one year, after a proven period of non use for one year this easement will revert to Grantor.

IN WITNESS WHEREOF, we have hereunto set our hands and seals this 29 day of July, 1996.

Witnessed by:

Wayne Tolbert

Ray Bailey (SEAL)

Jackie Bailey (SEAL)

STATE OF _____)
SS.

STATE OF NEVADA)
COUNTY OF WASHOE)

On July 29, 1996, before me, the undersigned, a Notary Public for said State personally appeared, Wayne Tolbert, personally known to me to be the person whose name is subscribed to this instrument as a witness thereto, who, being duly sworn, deposed and said that he was present and saw Ray Bailey and Jackie Bailey (known to the witness to be the persons whose names are subscribed to this instrument) execute it, acknowledged to the witness that they executed it, and that at their request the witness thereupon subjected his name as a witness thereto.

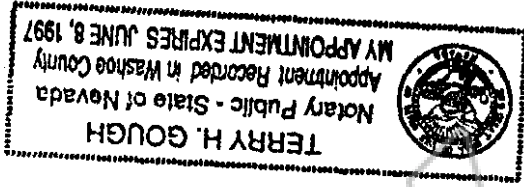

Terry H. Gough
Notary Signature

names are subscribed to the within instrument and acknowledged that they executed the same. Known to me to be the individuals whose names are subscribed to the within instrument and acknowledged that they executed the same. Signed and sealed _____, 19____.

SIGNATURE _____



P.O. BOX 5816 EIKO, NEVADA 89802
702-738-8512

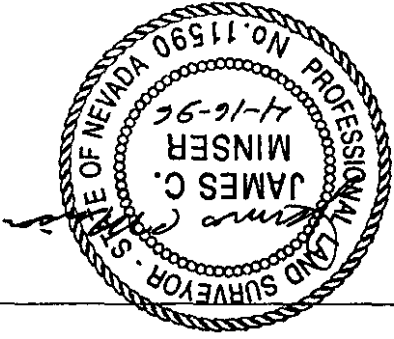

FIELD UTILITY LOCATION - BAILEY EASEMENT
I, JAMES C. MINSER, CERTIFY THAT I HAVE SURVEYED THE STRUCTURES SHOWN
ABOVE, AND THAT THEY OCCUPY THE POSITIONS SHOWN.
THIS SURVEY IS LOCATED IN THE SW 1/4 OF S.33, T.30N., R.52E., M.D.M.
EUREKA COUNTY NEVADA.

◆ FOUND REBAR - PLS 7000

PEDESTAL # 11

POWER POLE

UTILITY EASEMENT 10 FT. X 382 FT.

STATE HIGHWAY 278

1"=60'



PARCEL 2

PARCEL 1

DESCRIPTION - BAILEY EASEMENT

An easement for utility purposes on a strip of land ten feet in width, situated in the Southwest 1/4 of Section 33, T.30N., R.52E., M.D.M., Eureka County, Nevada, and also being a portion of Parcel 2 as, shown on a Parcel Map for Wallace Hale and Donna Ray Bailey, recorded as File No. 137905 in the Office of the Eureka County Recorder, the centerline of said strip described as follows:
BEGINNING at a point on the line between Parcel 1 and Parcel 2 of said Parcel Map, whence the westerly common corner of Parcel 1 and Parcel 2 bears S.84°03'35"W., 5.00 feet distant;
thence S.05°56'25"E., parallel with the westerly line of Parcel 2, a distance of 382.00 feet.
Basis of Bearings is said Parcel Map.

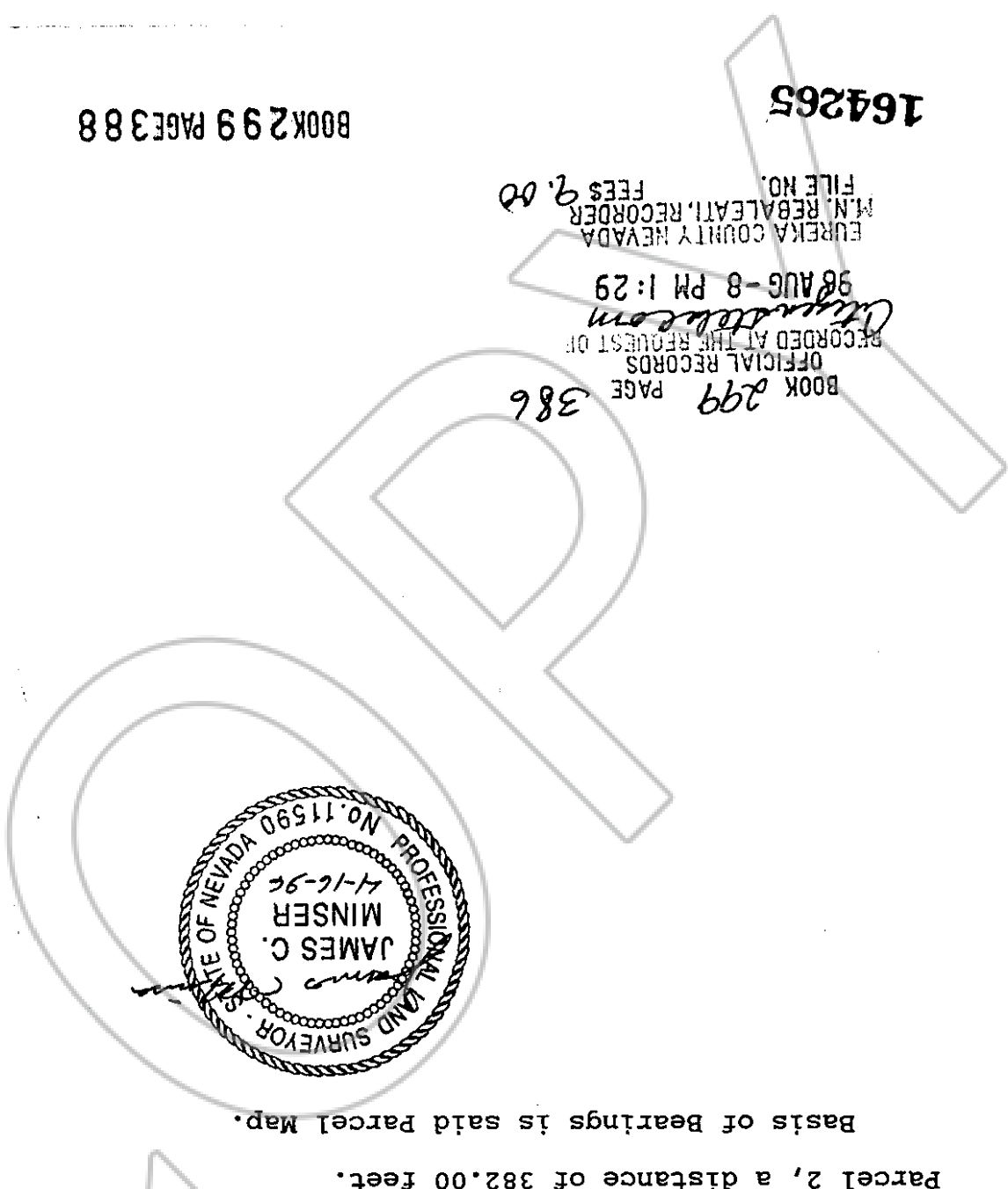

BOOK 299 PAGE 386
RECORDED AT THE REQUEST OF
Official Records
98 AUG - 8 PM 1:29
EUREKA COUNTY NEVADA
M.N. REBALLET, RECORDER
FILE NO.
FEES \$ 2.00

164265

BOOK 299 PAGE 388