

CURVE DATA

CURVE	RADIUS	LENGTH	TANGENT	DELTA
C9	338.47'	238.76'	182.98'	40°18'59"
C10	2006.50'	479.64'	246.97'	18°46'11"
C11	166.00'	186.00'	132.00'	90°00'00"
C12	166.00'	186.00'	132.00'	90°00'00"
C13	443.97'	234.97'	120.23'	29°55'10"
C14	338.83'	63.90'	32.05'	11°04'00"
C15	1453.30'	383.28'	91.80'	07°19'08"
C16	848.45'	348.27'	188.27'	07°50'43"
C17	848.45'	348.27'	188.27'	07°50'43"
C18	1837.16'	148.04'	74.11'	06°51'22"
C19	403.74'	298.24'	151.71'	41°11'19"
C20	146.00'	146.00'	102.00'	90°00'00"
C21	453.54'	102.57'	52.2746'	13°02'46"
C22	263.28'	39.98'	20.03'	08°42'04"
C23	146.99'	146.99'	103.96'	90°00'00"
C24	694.00'	294.80'	152.37'	29°31'11"
C25	694.00'	294.80'	152.37'	29°31'11"
C26	391.76'	176.31'	88.41'	10°36'50"

LINE DATA

LINE	DIRECTION	DISTANCE
L1	N 82°37'22" E	619.55'
L2	N 12°17'37" E	175.68'
L3	N 56°19'48" E	251.92'
L4	N 80°00'47" E	156.72'
L5	N 85°52'31" W	168.17'
L6	N 89°45'00" E	158.92'
L7	N 07°37'44" W	657.44'
L8	N 16°19'48" W	128.81'
L9	N 16°19'48" W	128.81'
L10	N 16°19'48" W	128.81'

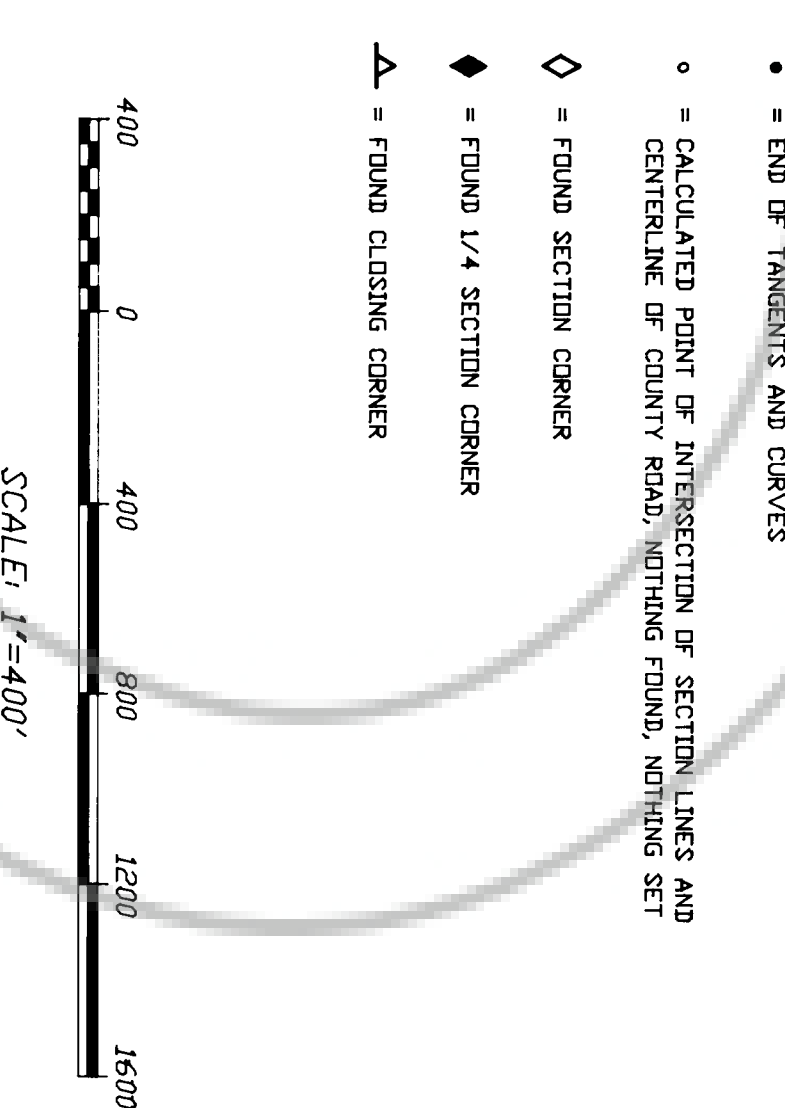

- LEGEND**
- = END OF TANGENTS AND CURVES
 - o = CALCULATED POINT OF INTERSECTION OF SECTION LINES AND CENTERLINE OF COUNTY ROAD, NOTHING FOUND, NOTHING SET
 - ◊ = FOUND SECTION CORNER
 - ◆ = FOUND 1/4 SECTION CORNER
 - △ = FOUND CLOSING CORNER

NOTES:

- 1) THE BASIS OF BEARING IS THE NEVADA COORDINATE SYSTEM OF 1983, EAST ZONE, AS DETERMINED BY SILAR OBSERVATION.
- 2) THIS MAP DESCRIBES THE CENTERLINE OF A GRAVEL ROAD OF VARYING WIDTH, THE ALIGNMENT OF ROADWAYS OF THIS TYPE CAN BE DETERMINED BY FIELD SURVEY. THE PURPOSE OF THIS MAP IS TO BEVELER A RECORD OF THE ALIGNMENT OF THE CENTERLINE OF THE ROADWAY ON THE DATE OF THE SURVEY.

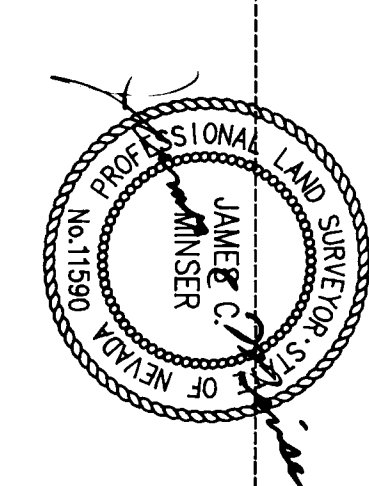

LAND SURVEYOR'S CERTIFICATE

I, JAMES C. NINSLER, DO HEREBY CERTIFY THAT THIS IS A TRUE AND ACCURATE MAP OF THE LAND SURVEYED UNDER MY SUPERVISION AND CONTROL AND THAT THE ALIGNED POINTS OF INTERSECTION AND THE POINTS AT WHICH THE CENTERLINE OF THE ROADWAY CROSS THE SECTION LINES ARE OF THE CHARACTER AND OCCUPY THE POSITIONS INDICATED HEREIN AND ARE SUFFICIENT TO ENABLE THIS SURVEY TO BE RETRACED.

PLS. NO. 11590

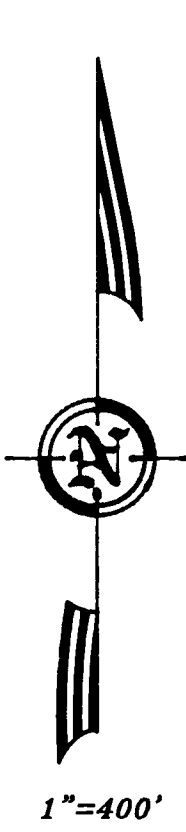

RECORD OF SURVEY
FOR
CITIZENS TELECOM OF NEVADA

UNION PASS COUNTY ROAD
SECTIONS 2, 3, 11, 14, 15, 1227 N., R.52 E., M.D.B. & M.
SECTIONS 27, 28, 34, 1.28 N., R.52 E., M.D.B. & M.
EUREKA COUNTY, NEVADA

APPREX
SURVEYING AND PLANNING

P.O. BOX 8816
ELKO, NEVADA
702-738-8512

4 OF 4

165068