

DIAMOND VALLEY WEED CONTROL DISTRICT

THE DISTRICT BOUNDARY SHOWN ON THIS MAP HAS BEEN REVIEWED AND IS HEREBY ACCEPTED.

B. J. Wood
MANAGER
April 18-97
DATE

SURVEYOR'S CERTIFICATE

I, WANE KOOPER, DO HEREBY CERTIFY THAT THIS MAP WAS COMPILED FROM AN INTERPRETATION OF RECORDED INFORMATION AND THE MAP REPRESENTS THE BOUNDARY OF THE DIAMOND VALLEY WEED CONTROL DISTRICT EXISTING THIS DATE.

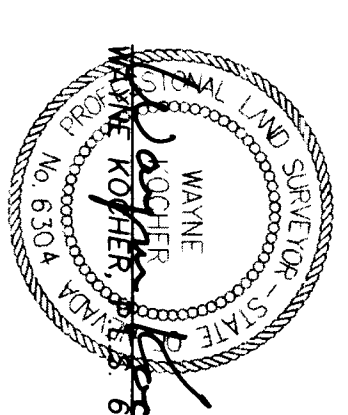

Wane Cooper
4/4/97

DIAMOND VALLEY WEED CONTROL DISTRICT

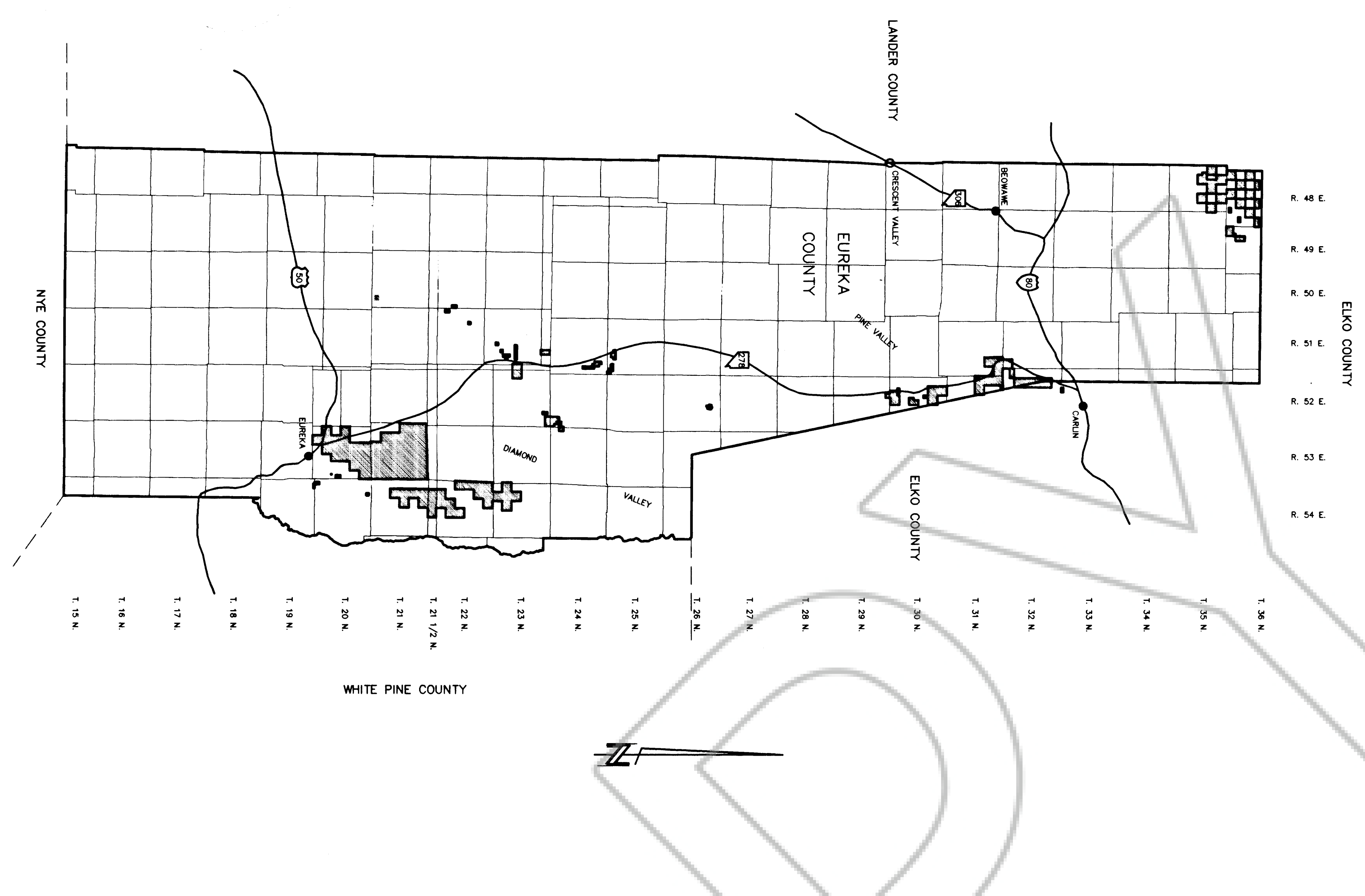

- T. 19 N., R. 54 E., M.D.M.
Section 6 - Lots 1 and 2, S 1/2 NE 1/4
Section 5 - SW 1/4 NW 1/4
Section 31 - E 1/2 SW 1/4
- T. 20 N., R. 53 E., M.D.M.
(Parcel 1)
Section 24 - Lots 4 and 5, W 1/2 NE 1/4
(Parcel 2)
Section 24 - SW 1/4 SE 1/4, SE 1/4 SW 1/4
- T. 25 N., R. 51 E., M.D.M.
Section 34 - N 1/2 NE 1/4, SE 1/4 NE 1/4 (06-200-03)
Section 35 - SW 1/4 NW 1/4 (06-200-03)
Section 36 - S 1/2 NW 1/4 SW 1/4 NE 1/4, N 1/2 SE 1/4, SE 1/4 SE 1/4 (06-200-04)
Section 37 - NW 1/4 SW 1/4 (06-200-05)
- T. 24 N., R. 51 E., M.D.M.
Section 1 - SW 1/2 SW 1/2 (06-300-01)
Section 2 - E 1/2 SE 1/4 (06-300-01)
Section 11 - NE 1/4 NE 1/4 (06-300-01)
Section 12 - W 1/2 NW 1/4, SE 1/4 NW 1/4, E 1/2 SW 1/4 (06-300-01)
Section 13 - E 1/2 NW 1/4 (06-300-01)
Section 2 - NW 1/4, Lot 11 (07-040-01)
Section 13 - N 1/2 SW 1/4 (07-040-03)
Section 14 - N 1/2 SW 1/4 (07-040-04)
Section 24 - NW 1/4 NE 1/4 SW 1/4 (07-040-06)
- T. 22 N., R. 50 E., M.D.M.
Section 27 - NE 1/4 SE 1/4 (07-040-06)
Section 27 - NE 1/4 SE 1/4 (07-040-06)
Section 19 - Lot 5 (07-050-12)
Section 9 (07-050-13)
Section 24 - E 1/2 NE 1/4 (07-100-02)
Section 8 - NW 1/4 SE 1/4 (07-110-01)
Section 19 - Lots 3 & 4, SE 1/4 SW 1/4 (07-110-03)
Section 21 - NE 1/4 NE 1/4, NE 1/4 NW 1/4 (07-110-03)
Section 35 - SW 1/4 NE 1/4, NE 1/4 SE 1/4, SW 1/4 (07-170-02)
Section 35 - SW 1/4 NW 1/4, NW 1/4 SW 1/4 (07-170-02)
- T. 23 N., R. 52 E., M.D.M.
Section 1 - Lot 1 of the NE 1/4, Lot 3 of the NW 1/4
Section 2 - SW 1/4 NE 1/4, NW 1/4 SE 1/4
Section 23 - SE 1/4 SE 1/4, SW 1/4 SE 1/4
Section 25 - All of the S 1/2, all of the NE 1/4, SE 1/4 NW 1/4
Section 30 - Lots 3 and 4 of the SW 1/4
- T. 32 N., R. 52 E., M.D.M.
Sections 8, 17, 20 (portions)
T. 31 N., R. 52 E., M.D.M.
Sections 6, 7, 17, 18 (portions)
T. 31 N., R. 51 E., M.D.M.
Sections 1, 2, 11 (portions)
Section 36
- (Parcel 1) - Book 220, Pages 121-123
T. 30 N., R. 52 E., M.D.M.
Section 21 - E 1/2 E 1/2 SW 1/4
Section 32 - All of SE 1/4, NE 1/4 NW 1/4, NW 1/4 NE 1/4, S 1/2 NE 1/4
Section 33 - All
T. 29 N., R. 52 E., M.D.M.
Section 4 - W 1/2 NW 1/4
Section 5 - Fractional E 1/2 NE 1/4
Excepting that part of Sections 21 and 33, and that part of the W 1/2 NW 1/2 of Section 33, lying West of the center-line of the Eureka and Palisade Railroad tract (Parcel 1) - The Red Jacket Consolidated Lode Mining Claim being a portion of Section 10, 20, 21, 22, 23, 24, 25, 26, 27, 28, 29, 30, 31, 32, 33, 34, 35, 36, 37, 38, 39, 40, 41, 42, 43, 44, 45, 46, 47, 48, 49, 50, 51, 52, 53, 54, 55, 56, 57, 58, 59, 60, 61, 62, 63, 64, 65, 66, 67, 68, 69, 70, 71, 72, 73, 74, 75, 76, 77, 78, 79, 80, 81, 82, 83, 84, 85, 86, 87, 88, 89, 90, 91, 92, 93, 94, 95, 96, 97, 98, 99, 100, 101, 102, 103, 104, 105, 106, 107, 108, 109, 110, 111, 112, 113, 114, 115, 116, 117, 118, 119, 120, 121, 122, 123, 124, 125, 126, 127, 128, 129, 130, 131, 132, 133, 134, 135, 136, 137, 138, 139, 140, 141, 142, 143, 144, 145, 146, 147, 148, 149, 150, 151, 152, 153, 154, 155, 156, 157, 158, 159, 160, 161, 162, 163, 164, 165, 166, 167, 168, 169, 170, 171, 172, 173, 174, 175, 176, 177, 178, 179, 180, 181, 182, 183, 184, 185, 186, 187, 188, 189, 190, 191, 192, 193, 194, 195, 196, 197, 198, 199, 200, 201, 202, 203, 204, 205, 206, 207, 208, 209, 210, 211, 212, 213, 214, 215, 216, 217, 218, 219, 220, 221, 222, 223, 224, 225, 226, 227, 228, 229, 230, 231, 232, 233, 234, 235, 236, 237, 238, 239, 240, 241, 242, 243, 244, 245, 246, 247, 248, 249, 250, 251, 252, 253, 254, 255, 256, 257, 258, 259, 260, 261, 262, 263, 264, 265, 266, 267, 268, 269, 270, 271, 272, 273, 274, 275, 276, 277, 278, 279, 280, 281, 282, 283, 284, 285, 286, 287, 288, 289, 290, 291, 292, 293, 294, 295, 296, 297, 298, 299, 300, 301, 302, 303, 304, 305, 306, 307, 308, 309, 310, 311, 312, 313, 314, 315, 316, 317, 318, 319, 320, 321, 322, 323, 324, 325, 326, 327, 328, 329, 330, 331, 332, 333, 334, 335, 336, 337, 338, 339, 340, 341, 342, 343, 344, 345, 346, 347, 348, 349, 350, 351, 352, 353, 354, 355, 356, 357, 358, 359, 360, 361, 362, 363, 364, 365, 366, 367, 368, 369, 370, 371, 372, 373, 374, 375, 376, 377, 378, 379, 380, 381, 382, 383, 384, 385, 386, 387, 388, 389, 390, 391, 392, 393, 394, 395, 396, 397, 398, 399, 400, 401, 402, 403, 404, 405, 406, 407, 408, 409, 410, 411, 412, 413, 414, 415, 416, 417, 418, 419, 420, 421, 422, 423, 424, 425, 426, 427, 428, 429, 430, 431, 432, 433, 434, 435, 436, 437, 438, 439, 440, 441, 442, 443, 444, 445, 446, 447, 448, 449, 450, 451, 452, 453, 454, 455, 456, 457, 458, 459, 460, 461, 462, 463, 464, 465, 466, 467, 468, 469, 470, 471, 472, 473, 474, 475, 476, 477, 478, 479, 480, 481, 482, 483, 484, 485, 486, 487, 488, 489, 490, 491, 492, 493, 494, 495, 496, 497, 498, 499, 500, 501, 502, 503, 504, 505, 506, 507, 508, 509, 510, 511, 512, 513, 514, 515, 516, 517, 518, 519, 520, 521, 522, 523, 524, 525, 526, 527, 528, 529, 530, 531, 532, 533, 534, 535, 536, 537, 538, 539, 540, 541, 542, 543, 544, 545, 546, 547, 548, 549, 550, 551, 552, 553, 554, 555, 556, 557, 558, 559, 560, 561, 562, 563, 564, 565, 566, 567, 568, 569, 570, 571, 572, 573, 574, 575, 576, 577, 578, 579, 580, 581, 582, 583, 584, 585, 586, 587, 588, 589, 590, 591, 592, 593, 594, 595, 596, 597, 598, 599, 600, 601, 602, 603, 604, 605, 606, 607, 608, 609, 610, 611, 612, 613, 614, 615, 616, 617, 618, 619, 620, 621, 622, 623, 624, 625, 626, 627, 628, 629, 630, 631, 632, 633, 634, 635, 636, 637, 638, 639, 640, 641, 642, 643, 644, 645, 646, 647, 648, 649, 650, 651, 652, 653, 654, 655, 656, 657, 658, 659, 660, 661, 662, 663, 664, 665, 666, 667, 668, 669, 670, 671, 672, 673, 674, 675, 676, 677, 678, 679, 680, 681, 682, 683, 684, 685, 686, 687, 688, 689, 690, 691, 692, 693, 694, 695, 696, 697, 698, 699, 700, 701, 702, 703, 704, 705, 706, 707, 708, 709, 710, 711, 712, 713, 714, 715, 716, 717, 718, 719, 720, 721, 722, 723, 724, 725, 726, 727, 728, 729, 730, 731, 732, 733, 734, 735, 736, 737, 738, 739, 740, 741, 742, 743, 744, 745, 746, 747, 748, 749, 750, 751, 752, 753, 754, 755, 756, 757, 758, 759, 760, 761, 762, 763, 764, 765, 766, 767, 768, 769, 770, 771, 772, 773, 774, 775, 776, 777, 778, 779, 780, 781, 782, 783, 784, 785, 786, 787, 788, 789, 790, 791, 792, 793, 794, 795, 796, 797, 798, 799, 800, 801, 802, 803, 804, 805, 806, 807, 808, 809, 810, 811, 812, 813, 814, 815, 816, 817, 818, 819, 820, 821, 822, 823, 824, 825, 826, 827, 828, 829, 830, 831, 832, 833, 834, 835, 836, 837, 838, 839, 840, 841, 842, 843, 844, 845, 846, 847, 848, 849, 850, 851, 852, 853, 854, 855, 856, 857, 858, 859, 860, 861, 862, 863, 864, 865, 866, 867, 868, 869, 870, 871, 872, 873, 874, 875, 876, 877, 878, 879, 880, 881, 882, 883, 884, 885, 886, 887, 888, 889, 890, 891, 892, 893, 894, 895, 896, 897, 898, 899, 900, 901, 902, 903, 904, 905, 906, 907, 908, 909, 910, 911, 912, 913, 914, 915, 916, 917, 918, 919, 920, 921, 922, 923, 924, 925, 926, 927, 928, 929, 930, 931, 932, 933, 934, 935, 936, 937, 938, 939, 940, 941, 942, 943, 944, 945, 946, 947, 948, 949, 950, 951, 952, 953, 954, 955, 956, 957, 958, 959, 960, 961, 962, 963, 964, 965, 966, 967, 968, 969, 970, 971, 972, 973, 974, 975, 976, 977, 978, 979, 980, 981, 982, 983, 984, 985, 986, 987, 988, 989, 990, 991, 992, 993, 994, 995, 996, 997, 998, 999, 1000

- (Parcel 27)
T. 35 N., R. 48 E., M.D.M.
Section 8 - SW 1/4 NW 1/4 westerly of Boulder Creek, NW 1/4 easterly of Dumphy Road
Section 16 - E 1/2 NE 1/4
Section 3 - Lot 1, Lot 2, Lot 3, Lot 4, S 1/2 N 1/2, S 1/2
Section 1 - Lot 1, Lot 2, Lot 3, Lot 4, S 1/2 N 1/2, S 1/2
Section 9 - All
Section 11 - All
Section 15 - All
Section 17 - All
T. 36 N., R. 48 E., M.D.M.
Section 13 - S 1/2
Section 15 - S 1/2
Section 19 - S 1/2
Section 19 - Lot 1, Lot 2, Lot 3, Lot 4, S 1/2 N 1/2, S 1/2
Section 23 - All
Section 25 - N 1/2 SW 1/4
Section 27 - All
Section 29 - All
Section 31 - Lot 1, Lot 2, Lot 3, Lot 4, S 1/2 N 1/2, S 1/2
Section 33 - All
Section 35 - N 1/2 SW 1/4
T. 36 N., R. 49 E., M.D.M.
(Parcel 28)
Section 29 - W 1/2
(Parcel 29)
Section 31 - Lot 1, Lot 6, Lot 7, Lot 8, W 1/2 E 1/2 SW 1/4
(Parcel 7) of record in Book 523, pages 652-656
T. 33 N., R. 52 E., M.D.M. (Elko County)
Section 33 - Parcel located in the S 1/2 SW 1/4
(Parcel 8) of record in Book 523, pages 652-656
T. 32 N., R. 52 E., M.D.M. (Elko/Eureka Counties)
Section 17 - That part lying easterly of the easterly boundary line of Western Pacific Railroad Right-of-Way
Section 20 - That part of W 1/2 NW 1/4, NW 1/4 SW 1/4 lying easterly of the easterly boundary line of Western Pacific Railroad Right-of-Way, excepting that portion of the NW 1/4 SW 1/4 lying easterly of the easterly boundary line of Nevada State Highway 51
(Parcel 9) of record in Book 523, pages 652-656
T. 31 N., R. 51 E., M.D.M.
Section 1 - That portion lying easterly and northerly of the center-line of Nevada State Highway 51
T. 31 N., R. 52 E., M.D.M.
Section 6 - That part of SE 1/4 SW 1/4 lying northerly of the center-line of Nevada State Highway 51
Section 7 - That portion lying easterly and northerly of the center-line of Nevada State Highway 51
Section 17 - That portion of W 1/2 lying easterly and northerly of the center-line of Nevada State Highway 51 and NE 1/4 SE 1/4 lying easterly and northerly of the center-line of Nevada State Highway 51
(Parcel 10) of record in Book 523, pages 652-656
T. 30 N., R. 52 E., M.D.M.
Section 5 - All
Section 8 - All
Section 9 - All
Section 16 - W 1/2 NW 1/4
Excepting those portions of land conveyed to Shurtz, being the SW 1/4 of Section 3, portions of N 1/2 and SE 1/4 of Section 3, Section 4, and the W 1/2 of Section 5, 1/2 Highway 51 of Section 16, T. 30 N., R. 52 E., lying easterly of the center-line of Nevada State Highway 51 and NE 1/4 SE 1/4 lying easterly and northerly of the center-line of Nevada State Highway 51
Section 27 - W 1/2
(Parcel 11) of record in Book 523, pages 652-656
T. 31 N., R. 52 E., M.D.M.
Section 5 - N 1/2 NW 1/4
T. 32 N., R. 52 E., M.D.M.
Section 29 - All
Section 31 - N 1/2
Excepting all lands within boundaries of the Southern Pacific Railroad and Nevada State Highway 51
Parcel 12 of record in Book 523, pages 660
T. 32 N., R. 52 E., M.D.M.
Section 20 - That part of W 1/2 NW 1/4, NW 1/2 SW 1/4 lying easterly of the easterly boundary line of the Western Pacific Railway Company right-of-way, excepting that portion of land conveyed to the State of Nevada, of record in Book 24, page 378

Seguro Ramal/Antelope Valley (Richardson, James A., Wood, Rebecca and James V. No land description)

BOUNDARY MAP

DIAMOND VALLEY WEED CONTROL DISTRICT

LOCATED WITHIN T. 35-36 N., R. 48 E., T. 36 N., R. 49 E., T. 22 N., R. 50 E., T. 22-25, 31-32 N., R. 51 E., T. 23, 24, 29-32 N., R. 52 E., T. 19-21 N., R. 53 E., T. 19-23 N., R. 54 E., M.D.M. EUREKA COUNTY, NEVADA

LANDS AND ASSOCIATES
SUN COASTERS
SURVEYING AND MAPPING
CARRSON CITY, NEVADA
SHEET 1 OF 2
DATE: April 2, 1997
JOB NO.: 3494.016
FEE: \$110 fee

RECORDER'S CERTIFICATE

FILED AT THE REQUEST OF
Diamond Valley Weed Control District
ON THE *20th* DAY OF *April* 1997,
AT *12* MIN. PAST *1 P.M.* IN THE
OFFICIAL RECORDS OF EUREKA COUNTY,
NEVADA.
FILE NUMBER: *166750*
FEE: *\$110 fee*

VICINITY MAP

N.T.S.