

166832

BOOK 308 PAGE 13
OFFICIAL RECORDS
RECORDED AT THE REQUEST OF
D. P. Ward
97 MAY 20 AM 10:50
EUREKA COUNTY NEVADA
M.M. REBALLETI, RECORDER
FILE NO. 166832
FEES \$9.50

This is not a recording notice and cannot be so used
legally. Location work must be recorded by
use of "certificates of location."

WITNESSES
LOCATOR
Mike Higgins Agent

[REDACTED]
D. P. WARD
FAY WARD

Located this _____ day of _____, 19__
County, Nevada
WHITE R. 49E
Mining District

situated in _____
KAY 55

and the size of the claim is _____ feet wide. This claim shall be known as the
600
feet long by _____
1500

The general course of the claim or ledge is _____
NORTH and SOUTH
middle of the vein
41 39 37
54 31 N. R. 49E
S5 KAN 52

direction, and three hundred feet on each side of the
direction, and _____ feet in a NORTH
50
discovery monument _____ feet in a SOUTH
1450
mineral bearing ground as a 700E claim. From this
locate _____ and claim _____ the following described piece of
Notice is hereby given that the undersigned hereby

LOCATION NOTICE

166832

166833

BOOK 308 PAGE 114
OFFICIAL RECORDS
RECORDED AT THE REQUEST OF
D. P. Wood
97 MAY 20 AM 10:50
EUREKA COUNTY NEVADA
M. N. REBALATI, RECORDER
FILE NO. FEES \$9.50

This is not a recording notice and cannot be so used
legally. Location work must be recorded by
use of "certificates of location."

WITNESSES

LOCATOR

DATE Hopper Hgeat

[REDACTED]

D. J. WARD
E. W. WARD

Located this day of 1922

67
County, Nevada

67
Mining District

situated in

600 feet wide. This claim shall be known as the

and the size of the claim is 1500 feet long by

The general course of the claim or ledge is

NORTH and SOUTH

54 T. 31 N. R. 49 E

middle of the vein

direction, and three hundred feet on each side of the

direction, and 50 feet in a NORTH

discovery monument 1450 feet in a SOUTH

mineral bearing ground as a 1000 claim. From this

locate and claim the following described piece of

Notice is hereby given that the undersigned hereby

LOCATION NOTICE

166833

166834
LOCATION NOTICE

Notice is hereby given that the undersigned hereby locate and claim the following described piece of

mineral bearing ground as a LOBE-claim. From this

discovery monument 1450 feet in a SOUTH

direction, and 50 feet in a NORTH

direction, and three hundred feet on each side of the

middle of the vein 547314.1249C

| | |
|----|----|
| ES | KS |
| SI | SI |

The general course of the claim or ledge is NORTH and SOUTH

and the size of the claim is 1500 feet long by

600 feet wide. This claim shall be known as the

situated in KAY

Mining District 6th

County, Nevada 6th

Located this 6th day of May, 1999

D P Ward

EMM WARD

LOCATOR [REDACTED]

WITNESSES [REDACTED]

Dale Hopper Agent

This is not a recording notice and cannot be so used legally. Location work must be recorded by use of "certificates of location."

BOOK 308 PAGE 115

OFFICIAL RECORDS

RECORDED AT THE REQUEST OF D P Ward

97 MAY 20 AM 10:51

EUREKA COUNTY NEVADA

M.N. REBALATI, RECORDER

FILE NO. 166834

FEES 9.50

BOOK 308 PAGE 115

166835
LOCATION NOTICE

Notice is hereby given that the undersigned hereby locate and claim the following described piece of

mineral bearing ground as a 1000 claim. From this discovery monument 150 feet in a SOUTH

direction, and 50 feet in a NORTH

direction, and three hundred feet on each side of the

middle of the vein

39 37 35 50 50 50

The general course of the claim or ledge is

WEST and SOUTH

and the size of the claim is 1500 feet long by

600 feet wide. This claim shall be known as the

situated in Ray 52

Mining District

ELIAS County, Nevada

Located this 9th day of April, 1997

D J WARD

RAY WARD

LOCATOR

WITNESSES

[Redacted]

[Redacted]

[Redacted]

[Redacted]

[Redacted]

[Redacted]

[Redacted]

[Redacted]

[Redacted]

[Redacted]

[Redacted]

[Redacted]

[Redacted]

[Redacted]

[Redacted]

[Redacted]

[Redacted]

[Redacted]

[Redacted]

[Redacted]

[Redacted]

[Redacted]

[Redacted]

[Redacted]

[Redacted]

[Redacted]

[Redacted]

[Redacted]

[Redacted]

[Redacted]

[Redacted]

[Redacted]

[Redacted]

[Redacted]

[Redacted]

[Redacted]

[Redacted]

[Redacted]

[Redacted]

BOOK 308 PAGE 116
OFFICIAL RECORDS
RECORDED AT THE REQUEST OF
D. P. Ward
97 MAY 20 AM 10:51
EUREKA COUNTY NEVADA
M.N. REBAL EATI, RECORDER
FILE NO. 166835
FEES 9.50

BOOK 308 PAGE 116

166835

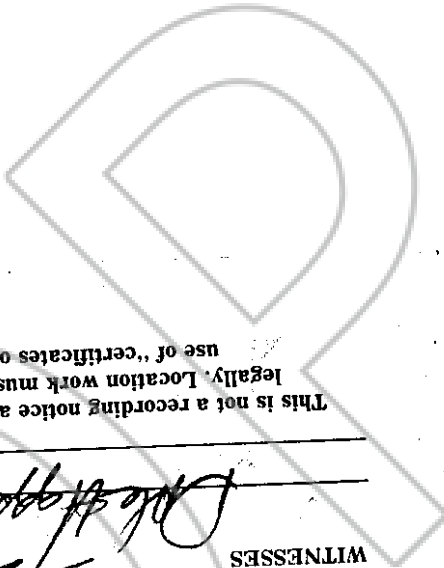

166836

BOOK 308 PAGE 117
OFFICIAL RECORDS
RECORDED AT THE REQUEST OF
D P Wood
97 MAY 20 AM 10:51
EUREKA COUNTY NEVADA
M.N. REBALZATI, RECORDER
FILE NO.
FEES \$ 9.50

LOCATION NOTICE

Notice is hereby given that the undersigned hereby locate _____ and claim _____ the following described piece of mineral bearing ground as a 1000 claim. From this discovery monument 1450 feet in a SOUTH direction, and 50 feet in a NORTH direction, and three hundred feet on each side of the middle of the vein 52 | 50 | 48 S.4 T.31 N. R. 49 E.

| | | |
|----|----|----|
| 53 | 51 | 49 |
|----|----|----|

The general course of the claim or ledge is NORTH and SOUTH and the size of the claim is 450 feet long by 100 feet wide. This claim shall be known as the May 31 situated in MINING DISTRICT EUREKA County Nevada 19 97 Located this 19 97 day of MAY 19 97 in 23 WARD 23 WARD 23 WARD 23 WARD

LOCATOR _____
WITNESSES _____
John H. Hapner
Agent

This is not a recording notice and cannot be so used legally. Location work must be recorded by use of "certificates of location."

166836

166837

EUREKA COUNTY NEVADA
M.N. REBAL EATL. RECORDER
FILE NO. FEES 9.50

97 MAY 20 AM 10:52

BOOK 308 PAGE 118
OFFICIAL RECORDS
RECORDED AT THE REQUEST OF
D.P. Ward

This is not a recording notice and cannot be so used
legally. Location work must be recorded by
use of "certificates of location."

WITNESSES
LOCATOR

[Redacted Name]
D. J. WARD
E. J. WARD

Located this day of 6th
County Nevada

Mining District
situated in

feet wide. This claim shall be known as the
600
and the size of the claim is
1500 feet long by

The general course of the claim or ledge is
NORTH and SOUTH

S. 4 T. 31 N. R. 49 E. 52
middle of the vein

direction, and three hundred feet on each side of the
37 35 33

direction, and feet in a NORTH

discovery monument feet in a SOUTH

mineral bearing ground as a 10 DE claim. From this

locate and claim the following described piece of

Notice is hereby given that the undersigned hereby

LOCATION NOTICE

166837

166838

EUREKA COUNTY NEVADA
M.N. REBALANCE ORDER
FILE NO. FEES \$2.50

BOOK 308 PAGE 119
OFFICIAL RECORDS
RECORDED AT THE REQUEST OF
D. J. WAIRD
97 MAY 20 AM 10:52

LOCATION NOTICE

Notice is hereby given that the undersigned hereby locate and claim the following described piece of mineral bearing ground as a LOPE claim. From this discovery monument 1450 feet in a SOUTH direction, and 50 feet in a NORTH direction, and three hundred feet on each side of the middle of the vein 51 49 47 45 43 41 39 37 35 33 31 29 27 25 23 21 19 17 15 13 11 9 7 5 3 1 0 1 3 5 7 9 11 13 15 17 19 21 23 25 27 29 31 33 35 37 39 41 43 45 47 49 51 53 55 57 59 61 63 65 67 69 71 73 75 77 79 81 83 85 87 89 91 93 95 97 99 100 101 103 105 107 109 111 113 115 117 119 121 123 125 127 129 131 133 135 137 139 141 143 145 147 149 151 153 155 157 159 161 163 165 167 169 171 173 175 177 179 181 183 185 187 189 191 193 195 197 199 200 201 203 205 207 209 211 213 215 217 219 221 223 225 227 229 231 233 235 237 239 241 243 245 247 249 251 253 255 257 259 261 263 265 267 269 271 273 275 277 279 281 283 285 287 289 291 293 295 297 299 300 301 303 305 307 309 311 313 315 317 319 321 323 325 327 329 331 333 335 337 339 341 343 345 347 349 351 353 355 357 359 361 363 365 367 369 371 373 375 377 379 381 383 385 387 389 391 393 395 397 399 400 401 403 405 407 409 411 413 415 417 419 421 423 425 427 429 431 433 435 437 439 441 443 445 447 449 451 453 455 457 459 461 463 465 467 469 471 473 475 477 479 481 483 485 487 489 491 493 495 497 499 500 501 503 505 507 509 511 513 515 517 519 521 523 525 527 529 531 533 535 537 539 541 543 545 547 549 551 553 555 557 559 561 563 565 567 569 571 573 575 577 579 581 583 585 587 589 591 593 595 597 599 600 601 603 605 607 609 611 613 615 617 619 621 623 625 627 629 631 633 635 637 639 641 643 645 647 649 651 653 655 657 659 661 663 665 667 669 671 673 675 677 679 681 683 685 687 689 691 693 695 697 699 700 701 703 705 707 709 711 713 715 717 719 721 723 725 727 729 731 733 735 737 739 741 743 745 747 749 751 753 755 757 759 761 763 765 767 769 771 773 775 777 779 781 783 785 787 789 791 793 795 797 799 800 801 803 805 807 809 811 813 815 817 819 821 823 825 827 829 831 833 835 837 839 841 843 845 847 849 851 853 855 857 859 861 863 865 867 869 871 873 875 877 879 881 883 885 887 889 891 893 895 897 899 900 901 903 905 907 909 911 913 915 917 919 921 923 925 927 929 931 933 935 937 939 941 943 945 947 949 951 953 955 957 959 961 963 965 967 969 971 973 975 977 979 981 983 985 987 989 991 993 995 997 999 1000

The general course of the claim or ledge is NORTH and SOUTH and the size of the claim is 1,500 feet long by 100 feet wide. This claim shall be known as the KAY 49 situated in ELI Mining District ELI County, Nevada. Located this 19 day of MAY 19 97.

WITNESSES
LOCATOR D. J. WAIRD
[Redacted]

This is not a recording notice and cannot be so used legally. Location work must be recorded by use of "certificates of location."

166838

166839

LOCATION NOTICE

Notice is hereby given that the undersigned hereby locate and claim the following described piece of mineral bearing ground as a 100' claim. From this

discovery monument 150' feet in a SOUTH direction, and 50' feet in a NORTH

direction, and three hundred feet on each side of the middle of the vein

57 23 31
50 15 46
S. T. 31. M. R. 49 E.

The general course of the claim or ledge is NORTH and SOUTH

and the size of the claim is 1500 feet long by 700 feet wide. This claim shall be known as the

RAY 48 situated in Mining District

EMERSON County Nevada Located this day of MAY 19 97

D. F. WARD
FAY WARD

LOCATOR

WITNESSES
Dale Hopper Hagent

This is not a recording notice and cannot be so used legally. Location work must be recorded by use of "certificates of location."

BOOK 308 PAGE 120
OFFICIAL RECORDS
RECORDED AT THE REQUEST OF
97 MAY 20 AM 10:52
EUREKA COUNTY NEVADA
M.N. REBAL EATL. RECORDER
FILE NO. 950

166839

BOOK 308 PAGE 120

LOCATION NOTICE

166840

Notice is hereby given that the undersigned hereby locate and claim the following described piece of mineral bearing ground as a LODE claim. From this discovery monument 1450 feet in a SOUTH direction, and 50 feet in a NORTH direction, and three hundred feet on each side of the middle of the vein

| | |
|----|----|
| 47 | 45 |
| 49 | 45 |
| 50 | 42 |

S.4 T.31N. R.49E.

The general course of the claim or ledge is NORTH and SOUTH and the size of the claim is 1500 feet long by 600 feet wide. This claim shall be known as the KAY situated in Mining District 6th FURBER County, Nevada

Located this 19 day of May, 19 97

D. P. WARD
FAY WARD

LOCATOR

WITNESSES
DR. HOGAN
AGENT

This is not a recording notice and cannot be so used legally. Location work must be recorded by use of "certificates of location."

BOOK 308 PAGE 121
OFFICIAL RECORDS
RECORDED AT THE REQUEST OF
D. P. WARD
97 MAY 20 AM 10: 53
EUREKA COUNTY NEVADA
M.N. REBAL EATL. RECORDER
FILE NO. 166840
BOOK 308 PAGE 121
FEES \$ 8.50

BOOK 308 PAGE 121

166841

LOCATION NOTICE

Notice is hereby given that the undersigned hereby locate and claim the following described piece of mineral bearing ground as a 100% claim. From this discovery monument 1450 feet in a SOUTH direction, and 50 feet in a NORTH direction, and three hundred feet on each side of the middle of the vein

S.4 T.31 N. R. 49 E.

The general course of the claim or ledge is NORTH and SOUTH and the size of the claim is 1,500 feet long by 600 feet wide. This claim shall be known as the KAY #11 situated in Mining District

ELIASKA County, Nevada Located this 27th day of MARCH, 1917

D.P. WARD
JAY WARD

LOCATOR

WITNESSES
O. H. Hopp
H. G. H. V.

This is not a recording notice and cannot be so used legally. Location work must be recorded by use of "certificates of location."

BOOK 308 PAGE 122
166841
EUREKA COUNTY NEVADA
M.N. REBAL EATI, RECORDER
FILE NO.
FEE \$ 2.50
BOOK 308 PAGE 122
OFFICIAL RECORDS
RECORDED AT THE REQUEST OF
D. P. Ward
97 MAY 20 AM 10:54

166842

EUREKA COUNTY NEVADA
M.N. REBALVALI, RECORDER
FILE NO. FEES \$9.50

97 MAY 20 AM 10:54

RECORDED AT THE REQUEST OF
D. P. Ward
OFFICIAL RECORDS

BOOK 308 PAGE 123

This is not a recording notice and cannot be so used
legally. Location work must be recorded by
use of "certificates of location."

WITNESSES
LOCATOR
Agent

DEWARD
FAVILLARD
Located this 6th day of MAY, 1997
EUREKA
County, Nevada

Mining District
situated in KAY 115
and the size of the claim is 1500 feet long by
100 feet wide. This claim shall be known as the
The general course of the claim or ledge is
MONTH and SOUTH

| | |
|----|----|
| 47 | 45 |
| 46 | 42 |

middle of the vein
direction, and three hundred feet on each side of the
direction, and 50 feet in a NORTH
discovery monument 1450 feet in a SOUTH
mineral bearing ground as a LODE claim. From this
locate and claim the following described piece of
Notice is hereby given that the undersigned hereby

LOCATION NOTICE

166842

166843

LOCATION NOTICE

Notice is hereby given that the undersigned hereby

locate and claim the following described piece of

mineral bearing ground as a LODE claim. From this

discovery monument 1450 feet in a NORTH

direction, and 50 feet in a SOUTH

direction, and three hundred feet on each side of the

middle of the vein 127

3

S. 4 T31 R49 E

The general course of the claim or ledge is NORTH

and SOUTH

and the size of the claim is 1500 feet long by

600 feet wide. This claim shall be known as the

KAY 44 (44)

situated in

_____ Mining District

_____ EUREKA

County, Nevada

Located this 6th day of APRIL, 1997

DONALD WARD

FAY WARD

WITNESSES

LOCATOR

BOOK 308 PAGE 124

166843

BOOK 308 PAGE 124

OFFICIAL RECORDS

RECORDED AT THE REQUEST OF

D P Ward

97 MAY 20 AM 10:54

EUREKA COUNTY NEVADA

M. N. REBALATI, RECORDER

FILE NO.

FEES 9.50

This is not a recording notice and cannot be so used legally. Location work must be recorded by use of "certificates of location."

166844

LOCATION NOTICE

Notice is hereby given that the undersigned hereby

locate and claim the following described piece of

mineral bearing ground as a 1000 claim, from this

discovery monument 1450 feet in a NORTH

direction, and 50 feet in a SOUTH

direction, and three hundred feet on each side of the

middle of the vein

S. + T. B. N. R. 192

The general course of the claim or ledge is

NORTH and SOUTH

and the size of the claim is 1500 feet long by

100 feet wide. This claim shall be known as the

situated in KAY 113

Mining District

ESMERALDA County, Nevada

Located this 19 day of May, 1997

D. P. HARRIS

KAY 113

[REDACTED]

[REDACTED]

LOCATOR

WITNESSES

Dale Hopper

Hager

This is not a recording notice and cannot be so used

legally. Location work must be recorded by

use of "certificates of location."

BOOK 308 PAGE 125

OFFICIAL RECORDS

RECORDED AT THE REQUEST OF

D. P. HARRIS

97 MAY 20 AM 10:55

EUREKA COUNTY NEVADA

M. N. REBALZATI, RECORDER

FILE NO. 9.50

166844

BOOK 308 PAGE 125

166845

LOCATION NOTICE

Notice is hereby given that the undersigned hereby locate and claim the following described piece of mineral bearing ground as a 100 ft claim. From this discovery monument 1450 feet in a SOUTH direction, and 50 feet in a NORTH direction, and three hundred feet on each side of the middle of the vein 31 29 16 1/2 x 42 S. 4 T. 31 N. R. 49 C.

The general course of the claim or ledge is NORTH and SOUTH

and the size of the claim is 1,500 feet long by 600 feet wide. This claim shall be known as the KAY #2

situated in Mining District

County Nevada ELIKA

Located this day of 19 97

WITNESSES

LOCATOR

This is not a recording notice and cannot be so used legally. Location work must be recorded by use of "certificates of location."

BOOK 308 PAGE 126

166845

BOOK 308 PAGE 126
OFFICIAL RECORDS
RECORDED AT THE REQUEST OF
D. P.illard
97 MAY 20 AM 10:55
EUREKA COUNTY NEVADA
M.N. REBAL EATL. RECORDER
FEES 9.50
FILE NO.

166846
LOCATION NOTICE

Notice is hereby given that the undersigned hereby locate and claim the following described piece of mineral bearing ground as a LOBE claim. From this discovery monument 1450 feet in a SOUTH direction, and 50 feet in a NORTH direction, and three hundred feet on each side of the middle of the vein 43 40 38 12 11 39

S + T. 31. L. R. 496.

The general course of the claim or ledge is

NORTH and SOUTH

and the size of the claim is 4500 feet long by

600 feet wide. This claim shall be known as the

situated in KAY #1

Mining District

EURYKA County, Nevada

Located this 6 day of APRIL, 1997

D. BILKARD
EAR BILKARD

LOCATOR

WITNESSES
Ear Bilkard
Agent

This is not a recording notice and cannot be so used legally. Location work must be recorded by use of "certificates of location."

BOOK 308 PAGE 127
OFFICIAL RECORDS
RECORDED AT THE REQUEST OF
BOOK 308 PAGE 127
97 MAY 20 AM 10:55
EURYKA COUNTY NEVADA
M.N. REBAL EATL. RECORDER
FILE NO. 166846
FEES 9.50

BOOK 308 PAGE 127

BOOK 308 PAGE 128

166847

BOOK 308 PAGE 127
OFFICIAL RECORDS
RECORDED AT THE REQUEST OF
97 MAY 20 AM 10:56
EUREKA COUNTY NEVADA
M.N. REBALANCE RECORDER
FILE NO.
FEES \$9.50

This is not a recording notice and cannot be so used
legally. Location work must be recorded by
use of "certificates of location."

WITNESSES
Dr. Higgins Agent
LOCATOR

D. J. WARD
FAY WARD

Located this *6th* day of *June*, 19*22*
EUREKA County, Nevada

Mining District
situated in *KAY 40*

and the size of the claim is *1500* feet long by *600* feet wide. This claim shall be known as the

The general course of the claim or ledge is *NORTH* and *SOUTH*

S. + T. 31. R. 496.

middle of the vein

| | | |
|----|------|----|
| 43 | 132' | 38 |
| 41 | | 39 |

direction, and three hundred feet on each side of the
direction, and *50* feet in a *SOUTH*

discovery monument *1450* feet in a *NORTH*

mineral bearing ground as a *100'* claim. From this
locate and claim the following described piece of

Notice is hereby given that the undersigned hereby

LOCATION NOTICE

166847

166848

LOCATION NOTICE

Notice is hereby given that the undersigned hereby locate and claim the following described piece of

mineral bearing ground as a 1000 claim. From this discovery monument 1450 feet in a SOUTH

direction, and 50 feet in a NORTH

direction, and three hundred feet on each side of the middle of the vein

40 | 38 | 36
41 | 37 | 39

S.47314 R.495

The general course of the claim or ledge is

NORTH and SOUTH

and the size of the claim is 1500 feet long by

600 feet wide. This claim shall be known as the

KAY 39

situated in

Mining District

EUREKA

County, Nevada

Located this 30th day of MARCH, 1997

D P WARD

FAY WARD

WITNESSES

LOCATOR

D P WARD
FAY WARD

This is not a recording notice and cannot be so used legally. Location work must be recorded by use of "certificates of location."

BOOK 308 PAGE 129
OFFICIAL RECORDS
RECORDED AT THE REQUEST OF
D P WARD
97 MAY 20 AM 10: 56
EUREKA COUNTY NEVADA
M.N. REBAL EATL. RECORDER
FILE NO.
166848
BOOK 308 PAGE 129
FEES \$9.50

BOOK 308 PAGE 129

166849

LOCATION NOTICE

Notice is hereby given that the undersigned hereby

locate and claim the following described piece of

mineral bearing ground as a 100' claim. From this

discovery monument 1450 feet in a North

direction, and 50 feet in a South

direction, and three hundred feet on each side of the

middle of the vein

40 38 36

41 39 37

S. 4-T. 31 N. R. 49 E.

The general course of the claim or ledge is

North and South

and the size of the claim is 1500 feet long by

600 feet wide. This claim shall be known as the

KAY 38

situated in

Mining District

County, Nevada

Located this

day of

1997

D. P. BLAND

JAY BLAND

LOCATOR

WITNESSES

DATE

LOCATOR

WITNESSES

DATE

LOCATOR

WITNESSES

DATE

LOCATOR

WITNESSES

DATE

LOCATOR

WITNESSES

DATE

LOCATOR

WITNESSES

DATE

LOCATOR

WITNESSES

DATE

LOCATOR

WITNESSES

DATE

LOCATOR

WITNESSES

DATE

LOCATOR

WITNESSES

DATE

LOCATOR

WITNESSES

DATE

LOCATOR

WITNESSES

DATE

LOCATOR

This is not a recording notice and cannot be so used legally. Location work must be recorded by use of "certificates of location."

BOOK 308 PAGE 130
OFFICIAL RECORDS
RECORDED AT THE REQUEST OF
D. P. BLAND
97 MAY 20 AM 10:56
EUREKA COUNTY NEVADA
M.N. REBAL EATL. RECORDER
FILE NO. 166849
FEES 9.50

BOOK 308 PAGE 130

166849

166850

LOCATION NOTICE

Notice is hereby given that the undersigned hereby

locate and claim the following described piece of

mineral bearing ground as a 100E claim. From this

discovery monument 1450 feet in a SOUTH

direction, and 50 feet in a NORTH

direction, and three hundred feet on each side of the

middle of the vein

38 36 34

39 37 35

S. + T. 31 & R. 49 E.

The general course of the claim or ledge is

NORTH and SOUTH

and the size of the claim is 1500 feet long by

100 feet wide. This claim shall be known as the

situated in RAY

MINING District

EUREKA County, Nevada

Located this 19 day of APRIL, 1997

D P WARD

RAY WARD

[REDACTED]

LOCATOR

WITNESSES

W. Hoppers Agent

This is not a recording notice and cannot be so used
legally. Location work must be recorded by
use of "certificates of location."

BOOK 308 PAGE 131

166850

BOOK 308 PAGE 131
OFFICIAL RECORDS
RECORDED AT THE REQUEST OF
D P Ward
97 MAY 20 AM 10:57
EUREKA COUNTY NEVADA
M. N. REBALATI, RECORDER
FILE NO. _____
FEES \$9.50

166851

LOCATION NOTICE

Notice is hereby given that the undersigned hereby

locate and claim the following described piece of

mineral bearing ground as a LODE claim. From this

discovery monument 1450 feet in a NORTH

direction, and feet in a

direction, and three hundred feet on each side of the

middle of the vein 38 36 34

39 37 35

S. 4 T. 31 N. R. 49 E.

The general course of the claim or ledge is

NORTH and SOUTH

and the size of the claim is 1,500 feet long by

600 feet wide. This claim shall be known as the

situated in KAY 36

Mining District

EVREKA

County, Nevada

Located this day of , 1992

D. P. Ward

KAY 36

WITNESSES

 LOCATOR

This is not a recording notice and cannot be so used
legally. Location work must be recorded by
use of "certificates of location."

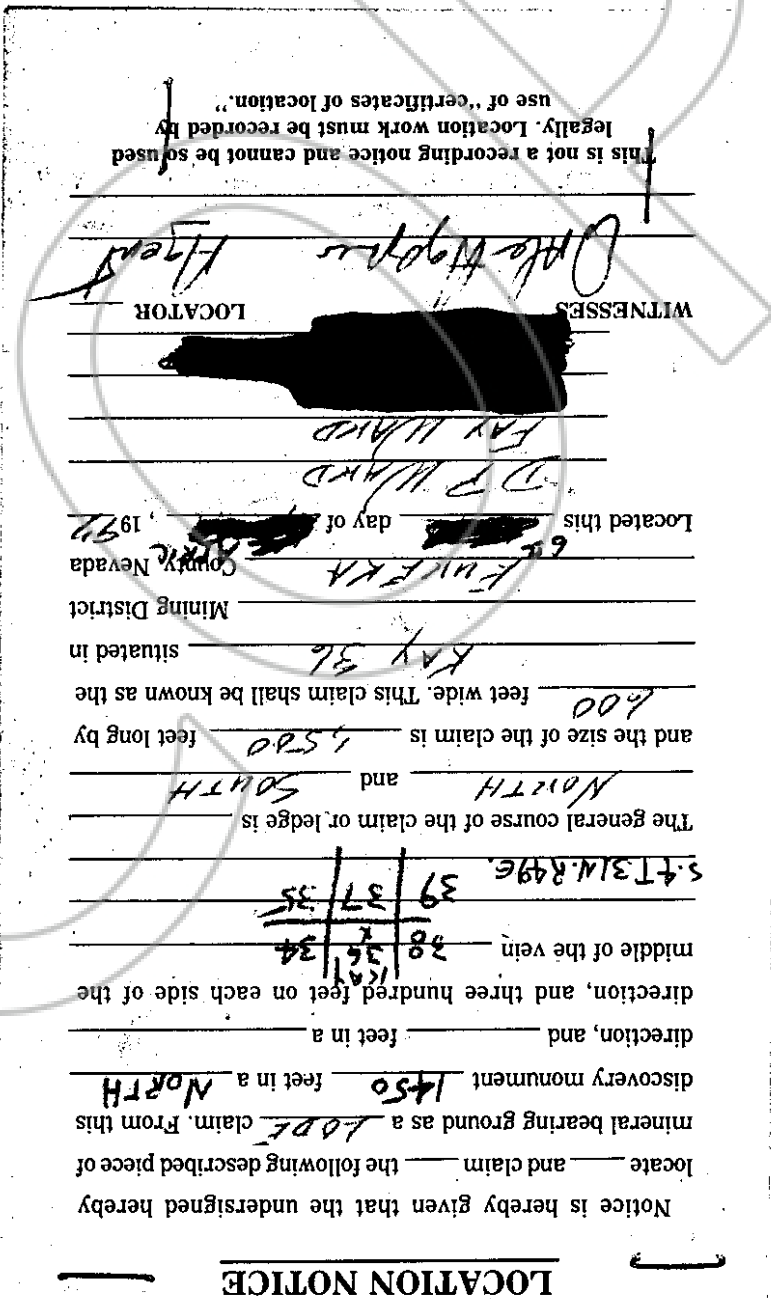

BOOK 308 PAGE 132 166851

BOOK 308 PAGE 132
OFFICIAL RECORDS
RECORDED AT THE REQUEST OF
D. P. Ward
97 MAY 20 AM 10:57
EVREKA COUNTY NEVADA
M. N. REBALZATI, RECORDER
FILE NO.
FEES \$ 9.50



166852

LOCATION NOTICE

Notice is hereby given that the undersigned hereby locate and claim the following described piece of

mineral bearing ground as a LOBE claim. From this discovery monument 1450 feet in a SOUTH

direction, and 50 feet in a NORTH direction, and three hundred feet on each side of the middle of the vein

| | | |
|----|----|----|
| 37 | 34 | 32 |
| 37 | 34 | 32 |
| 37 | 34 | 32 |

The general course of the claim or ledge is NORTH and SOUTH

and the size of the claim is 1500 feet long by 600

feet wide. This claim shall be known as the KAY 35

situated in 6th LUREKA Mining District

6th LUREKA County, Nevada

Located this 27 day of MAY, 1912

D F WARD and FAY WARD

LOCATOR Agent

WITNESSES Doyle W. Cooper

This is not a recording notice and cannot be so used legally. Location work must be recorded by use of "certificates of location."

BOOK 308 PAGE 133

166852

BOOK 308 PAGE 133
OFFICIAL RECORDS
RECORDED AT THE REQUEST OF
D F Ward
97 MAY 20 AM 10: 58
EUREKA COUNTY NEVADA
M. N. REBALZATI, RECORDER
FILE NO. _____
FEES \$ 9.50

166853

LOCATION NOTICE

Notice is hereby given that the undersigned hereby

locate and claim the following described piece of

mineral bearing ground as a LOBE claim. From this

discovery monument 1950 feet in a NORTH

direction, and 50 feet in a SOUTH

direction, and three hundred feet on each side of the

middle of the vein

36 37 38

S.4T.31N.R.49E. 37 38 39

The general course of the claim or ledge is

NORTH and SOUTH

and the size of the claim is 4500 feet long by

600 feet wide. This claim shall be known as the

situated in KAY 34

Mining District

EURKA County, Nevada

Located this 6th day of April, 1922

D J WARD

FAY WARD

WITNESSES

[Redacted]

LOCATOR

[Redacted]

[Redacted]

[Redacted]

[Redacted]

[Redacted]

[Redacted]

[Redacted]

[Redacted]

[Redacted]

[Redacted]

[Redacted]

[Redacted]

[Redacted]

[Redacted]

[Redacted]

[Redacted]

[Redacted]

[Redacted]

[Redacted]

[Redacted]

[Redacted]

[Redacted]

[Redacted]

[Redacted]

[Redacted]

[Redacted]

[Redacted]

[Redacted]

[Redacted]

[Redacted]

[Redacted]

[Redacted]

[Redacted]

[Redacted]

[Redacted]

[Redacted]

[Redacted]

This is not a recording notice and cannot be so used legally. Location work must be recorded by use of "certificates of location."

BOOK 308 PAGE 134
OFFICIAL RECORDS
RECORDED AT THE REQUEST OF
97 MAY 20 AM 10:58
EURKA COUNTY NEVADA
M.H. REBALATI, RECORDER
FILE NO. 166853
FEES 2.50

BOOK 308 PAGE 134

166854

LOCATION NOTICE

Notice is hereby given that the undersigned hereby

locate and claim the following described piece of mineral bearing ground as a LODF claim. From this

discovery monument 1450 feet in a SOUTH

direction, and 50 feet in a NORTH

direction, and three hundred feet on each side of the

middle of the vein 34 32 30

S. + T. 31. N. R. 49 E. 35 KAY 31

The general course of the claim or ledge is

NORTH and SOUTH

and the size of the claim is 1500 feet long by

600 feet wide. This claim shall be known as the

situated in KAY 33

Mining District

68 NEVADA County, Nevada

Located this 6th day of APRIL, 1992

DRWARD

FAY WARD

WITNESSES

[Redacted]

LOCATOR

[Signature]

This is not a recording notice and cannot be so used

legally. Location work must be recorded by

use of "certificates of location."

BOOK 308 PAGE 135

OFFICIAL RECORDS

RECORDED AT THE REQUEST OF

D. Ward

97 MAY 20 AM 10:58

EUREKA COUNTY NEVADA

M.N. REBAL EATL. RECORDER

FILE NO.

FEES 9.50

166854

BOOK 308 PAGE 135

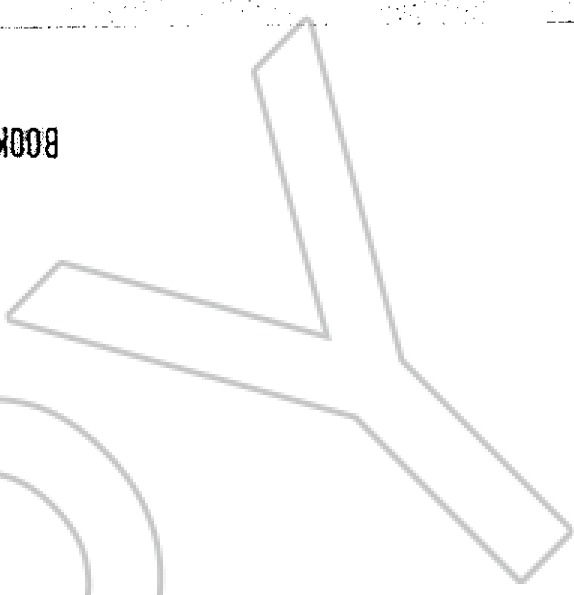

166855

LOCATION NOTICE

Notice is hereby given that the undersigned hereby

locate and claim the following described piece of mineral bearing ground as a 100E claim. From this

discovery monument 1450 feet in a North direction, and 50 feet in a South

direction, and three hundred feet on each side of the middle of the vein

S. 4 T. 31 N. R. 49 E. 35 33 31

The general course of the claim or ledge is North and South

and the size of the claim is 4500 feet long by 100

feet wide. This claim shall be known as the Kay 32

situated in Mining District County, Nevada

Located this 6th day of June, 1922

D. P. Ward Kay Ward

WITNESSES

D. P. Ward Kay Ward

Agent

This is not a recording notice and cannot be so used legally. Location work must be recorded by use of "certificates of location."

BOOK 308 PAGE 136

166855

BOOK 308 PAGE 136
OFFICIAL RECORDS
RECORDED AT THE REQUEST OF
97 MAY 20 AM 10:58
EUREKA COUNTY NEVADA
M. N. REBELEATH, RECORDER
FILE NO. FEES 2.50

166856

LOCATION NOTICE

Notice is hereby given that the undersigned hereby

locate and claim the following described piece of

mineral bearing ground as a 100E claim. From this

discovery monument 1450 feet in a SOUTH

direction, and 50 feet in a NORTH

direction, and three hundred feet on each side of the

middle of the vein

~~32 30 28~~

~~32 30 29~~

The general course of the claim or ledge is

NORTH and SOUTH

and the size of the claim is 1500

feet long by 700

feet wide. This claim shall be known as the

_____ MAY 31

situated in _____

_____ MINING DISTRICT

_____ COUNTY, NEVADA

Located this _____ day of _____, 1992

_____ DP WARD

_____ FAY WARD

WITNESSES _____

LOCATOR _____

Orlo Hopper Head

This is not a recording notice and cannot be so used legally. Location work must be recorded by use of "certificates of location."

BOOK 308 PAGE 137

166856

BOOK 308 PAGE 137
OFFICIAL RECORDS
RECORDED AT THE REQUEST OF
DP WARD
97 MAY 20 AM 10:59
EUREKA COUNTY NEVADA
M.N. REBAL EATL. RECORDED
FILE NO. _____
FEES 9.50

LOCATION NOTICE

Notice is hereby given that the undersigned hereby

locate and claim the following described piece of

mineral bearing ground as a LOPE claim. From this

discovery monument 1450 feet in a NORTH

direction, and 50 feet in a SOUTH

direction, and three hundred feet on each side of the

middle of the vein 32 30 28

1541 31 29

S.4731N.R.49E.33 31 29

The general course of the claim or ledge is

NORTH and SOUTH

and the size of the claim is 150' feet long by

400 feet wide. This claim shall be known as the

situated in KAY

Mining District EUREKA

County, Nevada 1991

Located this 28 day of APRIL, 19 91

DP WARD

FM WARD

WITNESSES

[Redacted]

LOCATOR

Mike H. Jones

Agent

This is not a recording notice and cannot be so used legally. Location work must be recorded by use of "certificates of location."

BOOK 308 PAGE 138

166857

EUREKA COUNTY NEVADA
M.N. REBALANCE, RECORDER
FILE NO. 166857
FEES \$9.50

97 MAY 20 AM 10:59

RECORDED AT THE REQUEST OF
OFFICIAL RECORDS
BOOK 308 PAGE 138

166857

166858

LOCATION NOTICE

Notice is hereby given that the undersigned hereby

locate and claim the following described piece of

mineral bearing ground as a 100' claim. From this

discovery monument 1450 feet in a SOUTH

direction, and 50 feet in a NORTH

direction, and three hundred feet on each side of the

middle of the vein 30' 28'

54' 13' N. R. 49 E. 20' 11' W.

The general course of the claim or ledge is

NORTH and SOUTH

and the size of the claim is 1500 feet long by

1000 feet wide. This claim shall be known as the

situated in Kay 29

Mining District

County, Nevada

Located this 18th day of May 1997

D. J. Ward

J. M. Ward

WITNESSES

[Redacted]

LOCATOR

[Redacted]

[Redacted]

This is not a recording notice and cannot be so used
legally. Location work must be recorded by
use of "certificates of location."

BOOK 308 PAGE 139

166858

EUREKA COUNTY NEVADA
M.N. REBALLET, RECORDER
FILE NO. FEES \$9.50

97 MAY 20 AM 10:59

BOOK 308 PAGE 139
OFFICIAL RECORDS
RECORDED AT THE REQUEST OF
D. J. Ward

166859

LOCATION NOTICE

Notice is hereby given that the undersigned hereby

locate and claim the following described piece of

mineral bearing ground as a 1000' claim. From this

discovery monument 1450 feet in a NORTH

direction, and 50 feet in a SOUTH

direction, and three hundred feet on each side of the

middle of the vein

30' 29' 31' 29'

S4T31N.R.19E.

The general course of the claim or ledge is

NORTH and SOUTH

and the size of the claim is 1500 feet long by

100 feet wide. This claim shall be known as the

situated in MAY 28

Mining District

EUREKA County, Nevada

Located this 6th day of APRIL 19 97

J. WARD

JAY WARD

WITNESSES

[Redacted]

LOCATOR

Agent

Use of "certificates of location."

This is not a recording notice and cannot be so used legally. Location work must be recorded by use of "certificates of location."

BOOK 308 PAGE 140

OFFICIAL RECORDS

RECORDED AT THE REQUEST OF

EUREKA COUNTY NEVADA

M.N. REBALLETI, RECORDER

FILE NO. FEES \$9.50

97 MAY 20 AM 10:59

166859

BOOK 308 PAGE 140