

169739

T. 19 N.

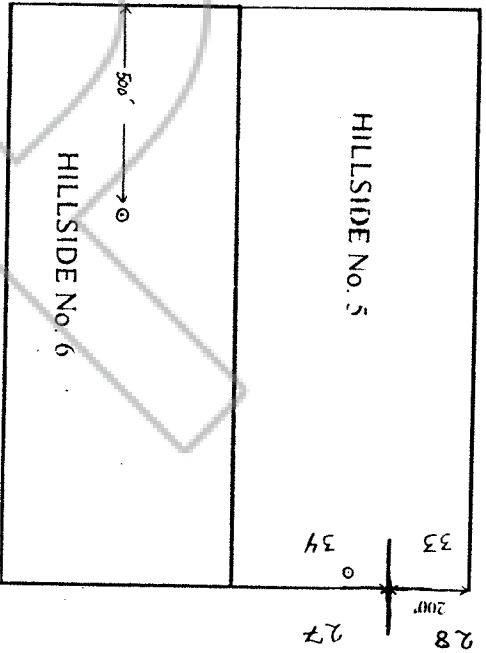

R. 53 E.

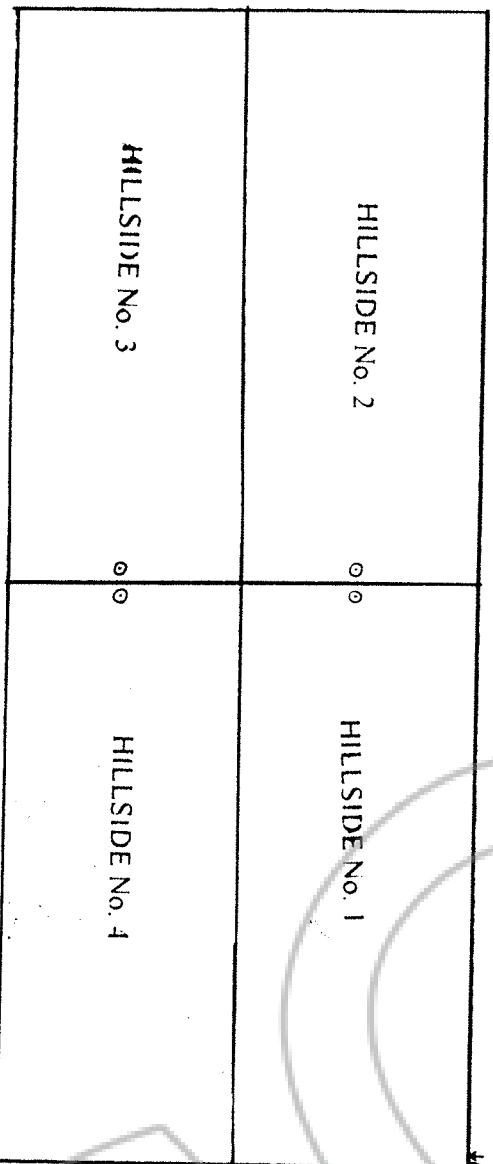

SILVER VIKING CORPORATION
 150415 1000th Ave. G, East Ely, Nevada 89315

LODE CLAIM MAP
 DIAMOND MINING AREA
 Eureka Mining District Eureka County Nevada

Scale: 1" = 500' Date: 12/15/97
 Drafting: RGV Revised:

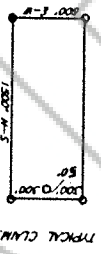
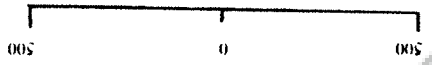

LOCATOR:
 Silver Viking Corporation
 150415 1000th Ave. G
 East Ely, Nevada 89315

LOCATION:
 Sections 27, 33, 34, T19N, R53E, M.D.B.M. Eureka County, Nevada

LOCATION DATES:
 11/7/97 - HILLSIDE 1-4
 11/9/97 - HILLSIDE 5, 6

THE POINTS:
 The NW corner of HILLSIDE 5 is 200' West of the NW corner section 34, T19N, R53E, M.D.B.M. Eureka County, Nevada.
 The NW corner of HILLSIDE 1 is 2200' East and 50' North of the NW corner section 34, T19N, R53E, M.D.B.M. Eureka County, Nevada.

NOTES:
 All claims are 1500' x 600' with location monuments located 50' in from the end lines, unless otherwise indicated on the map. All monuments are at least 2" x 2" x 4' wooden posts.

FILED AT THE REQUEST OF Alberik Berg Corp
 on July 5 19 98, at 29 minutes past 10 P.M.
 RECORDER **169739** COUNTY, NEVADA M. N. REBALEATI, Recorder
 File No. _____ Fee \$ 20.00

Page 1 of 2

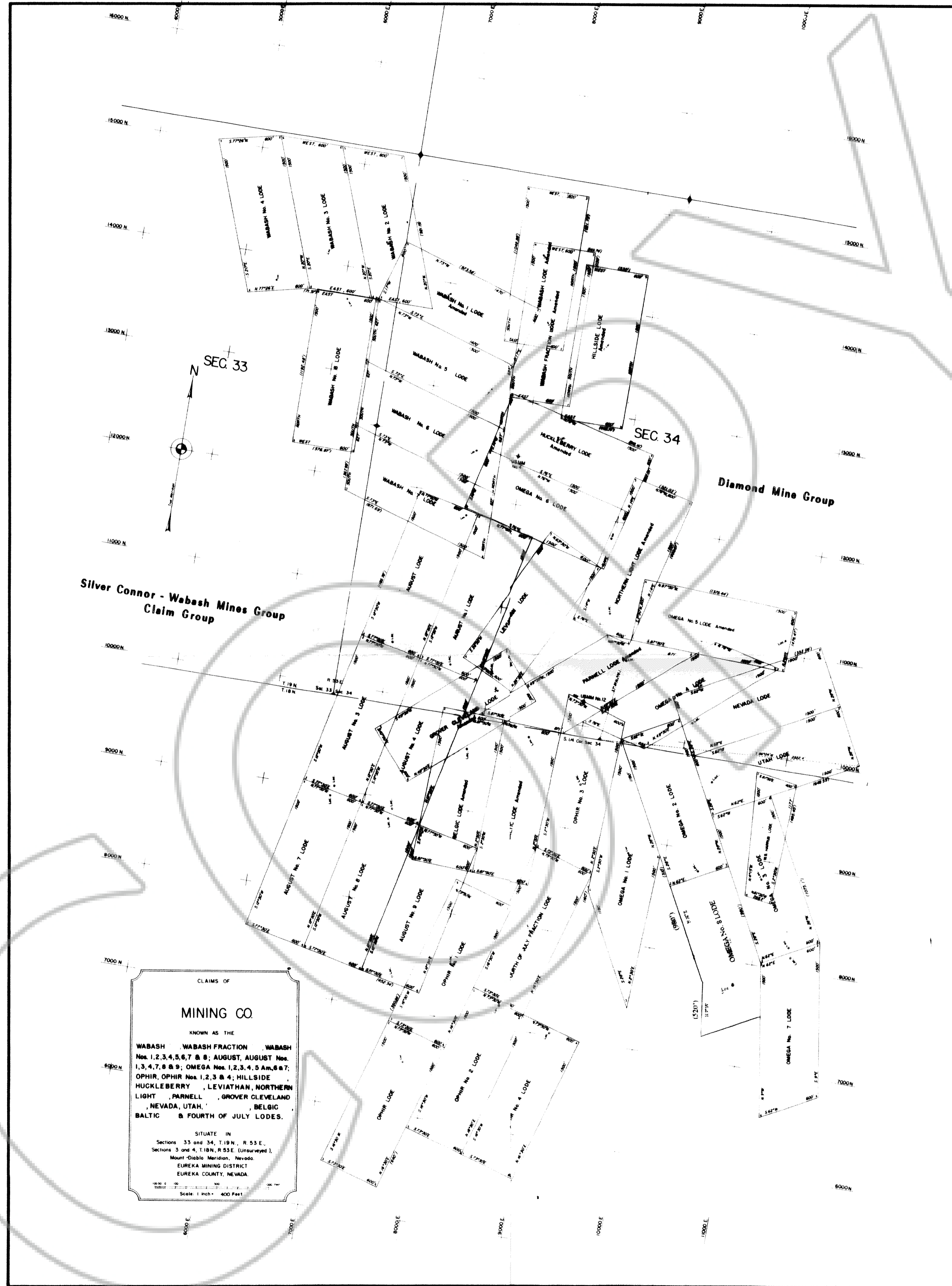

EXPLANATION

LOCATOR:
Silver Viking Corporation
150415 1000th Ave. G
East Ely, Nevada 89315

TIE POINTS:
The SE corner of NORTHERN LIGHT is 972.1' N7°30'E of the South 1/4 corner section 34, T19N, R53E, M.D.B.M. Eureka County, Nevada.
The SE corner of UTAH is 2522.4' N86°04'E of the South 1/4 corner section 34, T19N, R53E, M.D.B.M. Eureka County, Nevada.

LOCATION DATES:
11/7/97 - OMEGA 1-3, 5, 7, 8, OPHIR 3, UTAH, NEVADA, PARNEL, NORTHERN LIGHT
11/8/97 - AUGUST, AUGUST 1, 3, 4, 7-9, BELGIC, BALTIC, LEVIATHAN, GROVER CLEVELAND, OMEGA 6, OPHIR 1, 2, OPHIR, FOURTH OF JULY FRACTION
11/9/97 - WABASH, WABASH FRACTION, WABASH 1-8, HILLSIDE, HUCKLEBERRY
11/11/97 - OMEGA 4, OPHIR 4

NOTES:
All claims are 1500' x 600' with location monuments located 50' in from the end lines, unless otherwise indicated on the map.
All monuments are at least 2" x 2" x 4' wooden posts.

TYPICAL CLAIM:

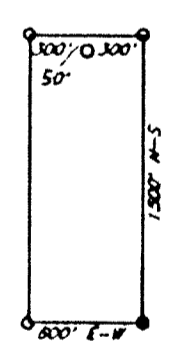

A SILVER CONNOR - WABASH PROJECT

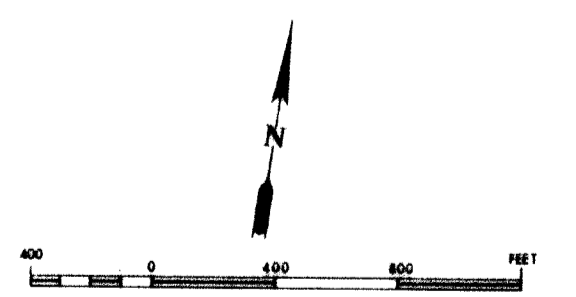

CLAIMS OF
MINING CO
KNOWN AS THE
WABASH WABASH FRACTION WABASH Nos. 1, 2, 3, 4, 5, 6, 7 & 8; AUGUST, AUGUST Nos. 1, 3, 4, 7, 8 & 9; OMEGA Nos. 1, 2, 3, 4, 5, 6, 7 & 8; OPHIR, OPHIR Nos. 1, 2, 3 & 4; HILLSIDE HUCKLEBERRY, LEVIATHAN, NORTHERN LIGHT, PARNELL, GROVER CLEVELAND, NEVADA, UTAH, BELGIC, BALTIC & FOURTH OF JULY LODES.
SITUATE IN
Sections 33 and 34, T19N, R53E,
Mount Diablo Meridian, Nevada
EUREKA MINING DISTRICT
EUREKA COUNTY, NEVADA
Scale: 1 inch = 400 Feet

SILVER VIKING CORPORATION
150415 1000th Ave. G, East Ely, Nevada 89315

LODE CLAIM MAP
DIAMOND MINING AREA
Eureka Mining District Eureka County Nevada

Scale: 1" = 500' Date: 12/15/97
Drafting: RGV Revised: