

▲ The Claim Location Marker is a 3' x 6' steel pipe, located approximately as follows:
 1.93 miles N 76d E from Grays Peak;
 0.55 miles S 27d W from Surprise Peak;
 2.50 miles N 8d E from South Hill

NOTES:

1. ALRAT claims, #'s 1 thru 4, located 01-21-98
 ALRAT claim, # 5 located 01-30-98
2. There is a total of 5 claims
3. These claims located by: Alta Gold Company
 1525 E. Newlands Dr. #1
 Fernley, Nevada 89408
4. Claims are 600' x 1500' with Location Monuments
 25' from the end lines.
5. At all Corners and Location Monuments are
 2"x2"x4' long wood posts with aluminum tags
 denoting the appropriate corners.
6. ○ = Corner Post
 ● = Location Monument

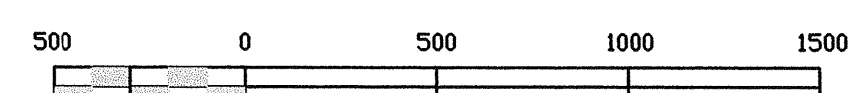
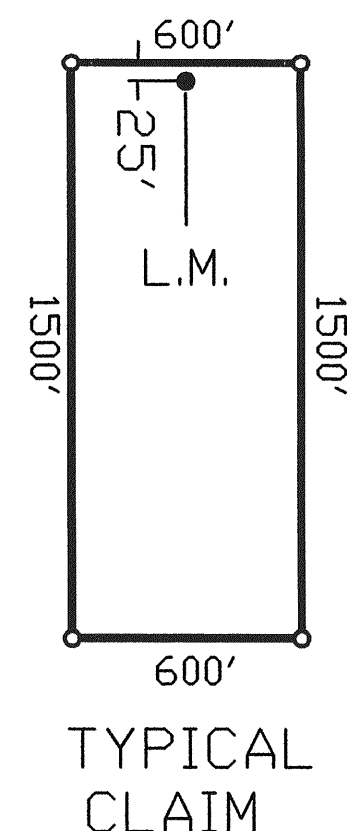
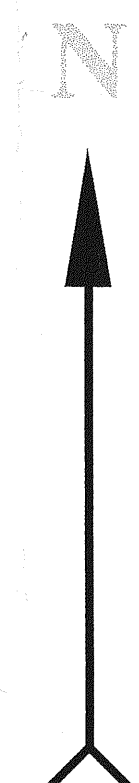

SCALE: 1" = 500'

FILED AT THE REQUEST OF Alta Gold Co.
 on March 23 1998, at 3:30 mins, past 2 P.M.,
 RECORDS 169906 EUREKA COUNTY, NEVADA M.N. REGALATI, Recorder
 File No. 169906 Fee \$ 25.00

ALRAT GROUP
LODE CLAIMS
T. 18 N., R. 53 E., M.D.B.&M.
EUREKA MINING DISTRICT
EUREKA COUNTY, NEVADA

