

172307

DESCRIPTION of CITIZENS TELECOM EASEMENT  
SHEEP CREEK COUNTY ROAD

A strip of land ten feet in width, situated in Sections 13, 12, 11, 10, 9, 8, 5, and 6, T. 27N., R. 51E., Sections 31 and 30, T. 28N., R. 51 E., and Section 25, T. 28N., R. 50E., M.D.M., Eureka County, Nevada, the Centerline of which is parallel to, and lies 25 feet Northeastly of, the centerline of Sheep Creek County Road, as shown on Record of Survey, File No. 165067, at the Office of the Eureka County Recorder.

Said strip has a total length of 41,060 feet, and comprises approximately 9.42 Acres.

Exhibit "A," attached, is a part of this Description.

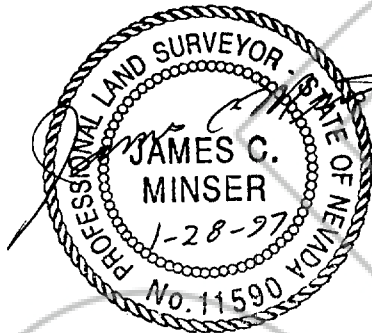

*James C. Minser*

*Judy E. Finch 6-23-99*

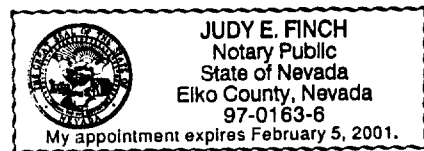

BOOK 327 PAGE 497

EXHIBIT "A"

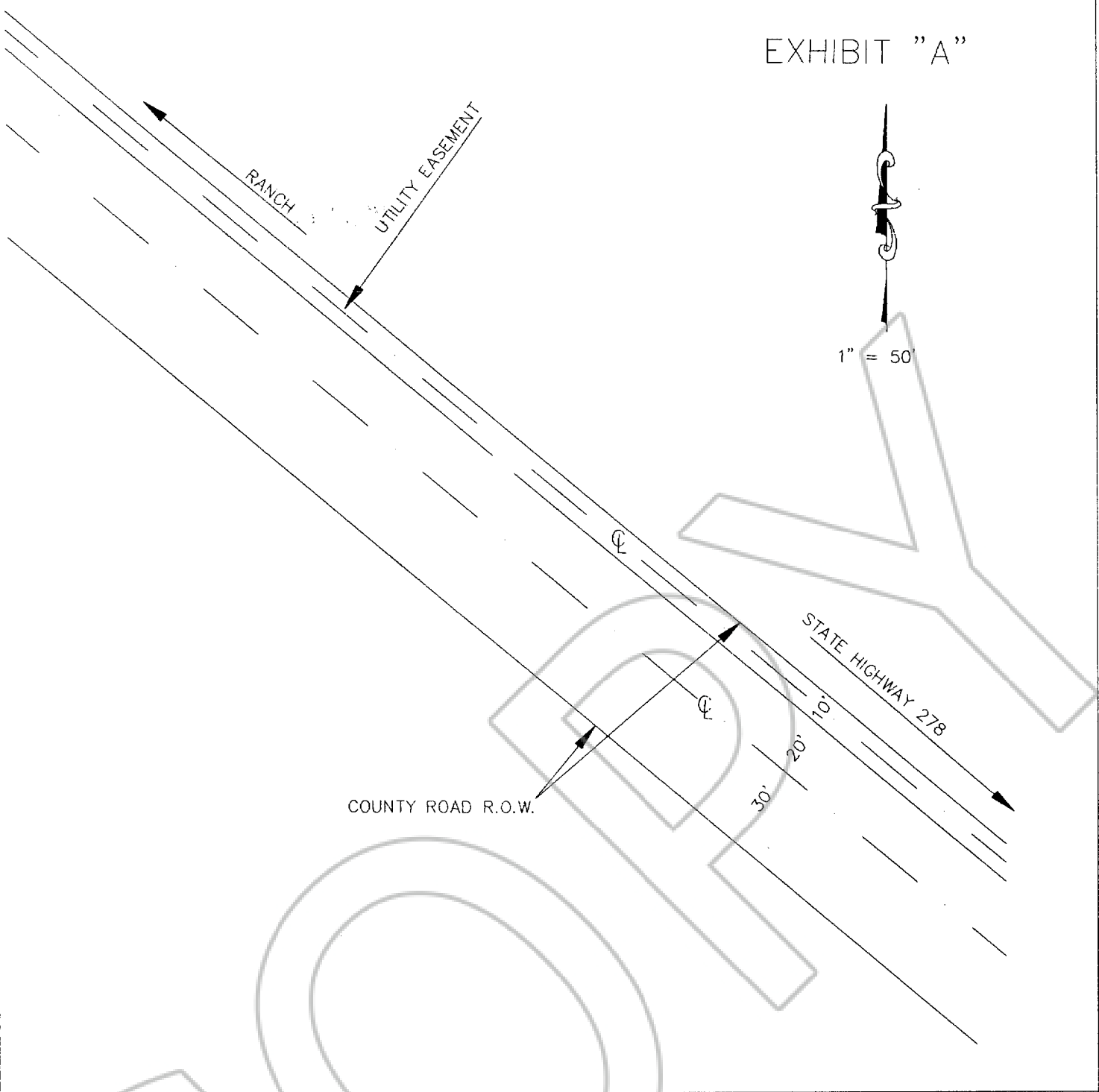

EASEMENT DETAIL - SHEEP CREEK ROAD

I, JAMES C. MINSER, CERTIFY THAT I HAVE SURVEYED THE STRUCTURES SHOWN ABOVE, AND THAT THEY OCCUPY THE POSITIONS SHOWN.

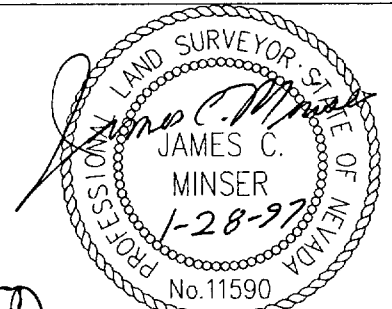

P.O. BOX 5816 ELKO, NEVADA 89802  
702-738-8512



JUDY E. FINCH  
Notary Public  
State of Nevada  
Elko County, Nevada  
97-0163-6  
My appointment expires February 5, 2001

*Judy E. Finch 6-23-98*

*James C. Minser*  
BOOK 327 PAGE 498

BOOK 327 PAGE 497  
OFFICIAL RECORDS  
RECORDED AT THE REQUEST OF  
*Citizens Telecom*  
99 JUN 29 PM 1:40

EUREKA COUNTY NEVADA  
M.N. REBALEATI, RECORDER  
FILE NO. FEES 9.00  
**172307**

COPY

BOOK 327 PAGE 499