

172371

R 48 E

29 28

32 33

28 27

33 34

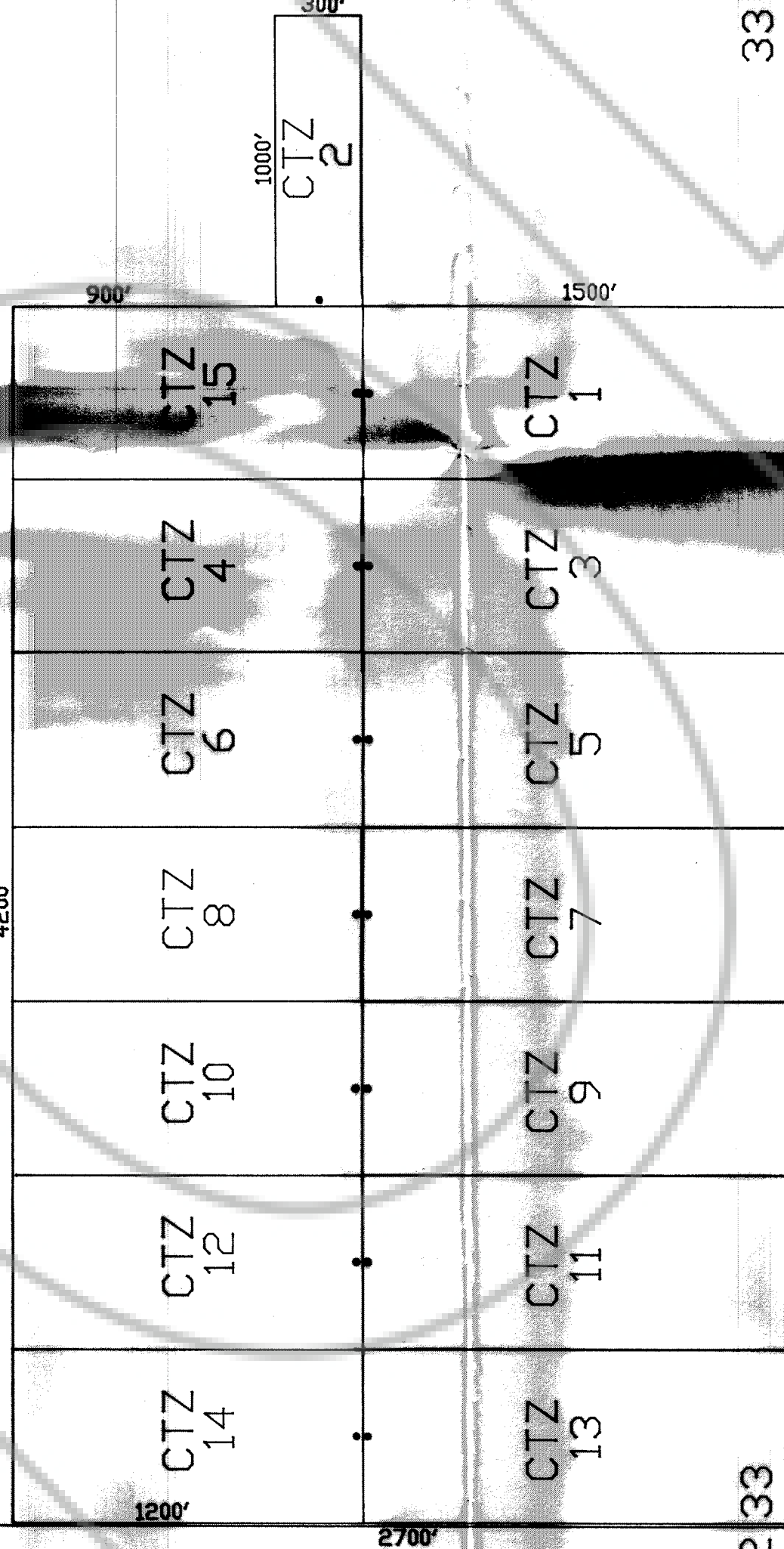

T 26 N 32 33

T 25 N

4 3

33 34

The SE corner of CTZ 1 is located approximately 900' west of the NV corner of section 1, T25N, R48E, MDBM

LOCATOR: NEVADA GOLD EXPLORATION, INC.
1475 GREG STREET
SPARKS, NEVADA 89431

LOCATION DATE: CTZ 1-15 MAY 21, 1999

TIE POINT: The SE corner of CTZ 1 is located approximately 900' due west of the NV corner of Section 1, T25N, R48E, MDBM

LOCATION: PROJECTED SECTION 33, T26N, R48E, MDBM, EUREKA COUNTY, NEVADA

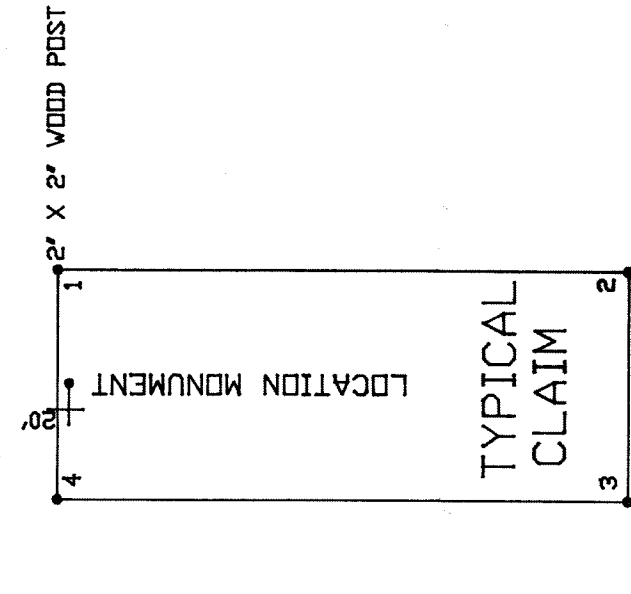

ALL CLAIMS ARE 1500' X 600' UNLESS OTHERWISE NOTED.

North

SCALE

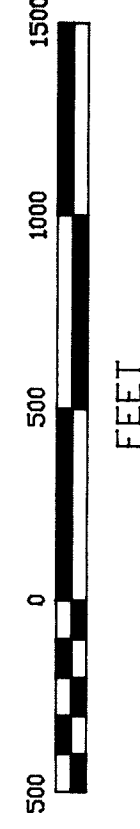

LODE CLAIM MAP

CTZ 1-15

Nevada Gold Exploration, Inc.
1475 Greg Street
Sparks, Nevada 89431

DRAWN BY: A.D.	DATE: 5/25/99	SCALE: 1"=500'	SHEET 1 of 1
Mineral Exploration Services, Ltd., 3545 Airway Dr., #106, Reno, NV 89511			

FILED AT THE REQUEST OF Nevada Gold Exploration
ON July 23 19 99 at 2:46 PM, PER L.L.M.
RECORDS OF EUREKA COUNTY, NEVADA M.N. REGISTRY DIVISION
FILE # 172371 Fee \$ 250.00