

ASSIGNMENT OF OVERRIDING ROYALTY INTEREST

KNOW ALL MEN BY THESE PRESENTS:

That A. WADE NOLLKAMPER, whose address is 656 North CR 1080, Kingsville, Texas 78363 (hereinafter referred to as assignor), for and in consideration of the sum of Ten Dollars (\$10.00) and other valuable consideration, cash in hand paid by the party named below (hereinafter referred to as Assignee), the receipt of which is hereby acknowledged, has conveyed, transferred, assigned and set over and by these presents does convey, transfer, assign, set over and deliver unto the Assignee an overriding royalty interest, in the percentage set opposite his name, in and to all oil, gas, casinghead gas, and other hydrocarbon substances produced, saved and marketed from the Oil and Gas Leases and lands described on Exhibit "A", attached hereto and made part hereof, said leases and lands being situated in Elko, Eureka, and White Pine Counties, Nevada.

Assign	Overriding Royalty Interest
MICH. JAMES KRUEGER P. O. B1538 Kingsv. Texas 78363	0.25 %

The interest conveyed hereby shall be free and clear of all costs and expenses except severance and production taxes (including windfall profit taxes, if any) and all other taxes levied and assessed upon the overriding royalty share of production hereby assigned.

If Assignor's interest in the Oil and Gas leases described on Exhibit "A" is less than the entire interest, or if said Oil and Gas Leases cover less than the entire fee title, then the overriding royalty interest conveyed hereby shall be reduced proportionately. This assignment is made without any warranties whatsoever, either express or implied.

TO HAVE AND HOLD the above described property and rights, together with all and singular the rights and appurtenances thereto and belonging to Assignee, his heirs, successors, personal representatives, and assigns forever.

IN WITNESS WHEREOF this document is executed this 5 day of December, 2000.

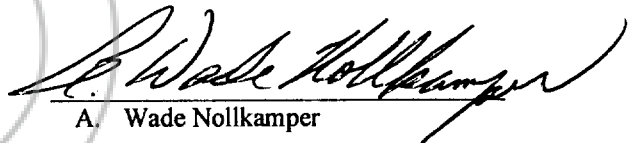

A. Wade Nollkamper

STATE OF TEXAS
COUNTY OF KLEBER

This instrument is acknowledged before me this 5th day of December, 2000, by
A. Wade Nollkamper

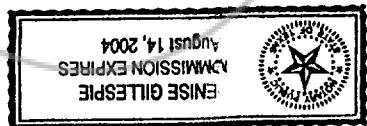
Given under my hand and seal of office this 5th day of December, 2000.

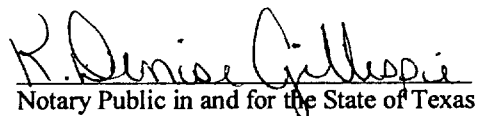

Notary Public in and for the State of Texas

My Commission Expires: 14-04

EXHIBIT "A"

<u>Lessor</u>	<u>Lessee</u>	<u>Date</u>	<u>County</u>	<u>State</u>	<u>Legal Description</u>	<u>Gross Acres</u>	<u>Recording Data</u>
Chestine D. Cook, Individually & as heir & devisee of Franklin Barry Cook, deceased	V. F. Neuhaus Properties, Inc.	4/28/97	Elko	Eureka Nevada	Township 31 North, Range 52 East, MDM Sec. 33: All	640.00	Bk 993, Pg 109 Bk 308, Pg 171
Ja Nell Cook, Individually & as heir & devisee of Charles Cook, Jr., deceased	V. F. Neuhaus Properties, Inc.	4/28/97	Elko	Eureka Nevada	Township 31 North, Range 52 East, MDM Sec. 33: All	640.00	Bk 993, Pg 111 Bk 308, Pg 173
Dawn E. Cook, a single woman	V. F. Neuhaus Properties, Inc.	4/28/97	Elko	Eureka Nevada	Township 31 North, Range 52 East, MDM Sec. 33: All	640.00	Bk 993, Pg 113 Bk 308, Pg 175
Carla Stivers, formerly known as Carla A. Poole, a married woman dealing in her sole & separate property	V. F. Neuhaus Properties, Inc.	4/28/97	Elko	Eureka Nevada	Township 31 North, Range 52 East, MDM Sec. 33: All	640.00	Bk 993, Pg 115 Bk 308, Pg 177
Todd Cook, dealing in his sole & separate property	V. F. Neuhaus Properties, Inc.	4/28/97	Elko	Eureka Nevada	Township 31 North, Range 52 East, MDM Sec. 33: All	640.00	Bk 993, Pg 117 Bk 308, Pg 179
Julian Tomera Ranches, Inc., Stonehouse Ranch Division	V. F. Neuhaus Properties, Inc.	7/2/99	Elko	Eureka Nevada	Township 31 North, Range 52 East, MDM Sec. 33: All	640.00	Bk 1106, Pg 709 Bk 328, Pg 278
USA: N-61507	V. F. Neuhaus Properties, Inc.	4/1/97	Elko	Eureka Nevada	Township 30 North, Range 52 East, MDM Sec. 4: Lots 1, 2, 3, 4, S2N2, S2 (All) Sec. 10: All	1,642.26	
USA: N-61605	V. F. Neuhaus Properties, Inc.	6/1/97	Elko	Eureka Nevada	Township 31 North, Range 52 East, MDM Sec. 28: All Sec. 34: All	1,280.00	
USA: N-61812	V. F. Neuhaus Properties, Inc.	8/1/97	Elko	Eureka Nevada	Township 30 North, Range 52 East, MDM Sec. 2: Lots 1, 2, 3, 4, S2N2, S2 (All) Sec. 14: All	1,281.36	

EXHIBIT "A"

<u>Lessor</u>	<u>Lessee</u>	<u>Date</u>	<u>County</u>	<u>State</u>	<u>Legal Description</u>	<u>Gross Acres</u>	<u>Recording Data</u>
USA: N-62207	V. F. Neuhaus Properties, Inc.	1/1/98	Elko	Nevada	Township 27 North, Range 56 East, MDM Sec. 9: All Sec. 10: W2NW/4	720.00	
USA: N-62215	V. F. Neuhaus Properties, Inc.	1/1/98	White Pine	Nevada	Township 14 North, Range 64 East, MDM Sec. 1: Lots 1,2,3,4, S2N2, S2 (All) Sec. 2: Lots 1,2,3,4, S2N2, S2 (All)	1,282.74	
USA: N-62216	V. F. Neuhaus Properties, Inc.	1/1/98	White Pine	Nevada	Township 14 North, Range 64 East, MDM Sec. 11: All Sec. 12: All	1,598.00	
USA: N-62217	V. F. Neuhaus Properties, Inc.	1/1/98	White Pine	Nevada	Township 14 North, Range 65 east, MDM Sec. 7: Lots 1,2,3,4, E2W2	1,916.26	
USA: N-62031	V. F. Neuhaus Properties, Inc.	1/1/98	Elko	Nevada	Township 14 North, Range 65 East, MDM Sec. 18: Lots 1,2,3,4, E2W2 Sec. 19: Lots 1,2,3,4, E2W2	1,640.00	
USA: N-62032	V. F. Neuhaus Properties, Inc.	1/1/98	Elko	Nevada	Township 28 North, Range 56 East, MDM Sec. 8: W2, NE/4, NE/4SE/4 Sec. 9: NW/4, W2NE/4, NE/4NE/4, NW/4SW/4, Sec. 9: SE/4SW/4, NE/4SE/4, NW/4SW/4 Sec. 15: SE/4 Sec. 22: NE/4 Sec. 23: NW/4	884.08	
USA: N-62033	V. F. Neuhaus Properties, Inc.	1/1/98	White Pine	Nevada	Township 27 North, Range 56 East, MDM Sec. 3: W2SW/4 Sec. 4: Lots 1,2,3,4, S2N2, S2 (All) Sec. 5: Lots 1,2, S2NE/4	840.00	
					Township 25 North, Range 56 East, MDM Sec. 27: All Sec. 34: NW/4NE/4, NW/4		

EXHIBIT "A"

<u>Lessor</u>	<u>Lessee</u>	<u>Date</u>	<u>County</u>	<u>State</u>	<u>Legal Description</u>	<u>Gross Acres</u>	<u>Recording Data</u>
USA: N-62034	V. F. Neuhaus Properties, Inc.	1/1/98	Elko	Nevada	Township 38 North, Range 67 East, MDM Sec. 8: SW/4 Sec. 18: Lots 1,2,3,4, E2W2, E2 (All)	781.40	
USA: N-62035	V. F. Neuhaus Properties, Inc.	1/1/98	Elko	Nevada	Township 38 North, Range 67 East, MDM Sec. 30: Lots 3, 4, E2SW/4, SE/4 Sec. 32: NW/4, SE/4 Township 38 North, Range 66 East, MDM Sec. 36: E2	2,145.11	
USA: N-62036	V. F. Neuhaus Properties, Inc.	1/1/98	Elko	Nevada	Township 37 North, Range 67 East, MDM Sec. 4: Lots 3, 4, S2NW/4, W/SW/4 Sec. 6: Lots 1,2,3,4,5,6,7,8,9,10,11 Sec. 6: S2NE/4, SE/4NW/4, E2SW/4 Sec. 8: Lots 1,2,3,4, NW/4 Township 37 North, Range 67 East, MDM Sec. 22: S2SE/4 Sec. 26: W2, W2E2 Sec. 34: NE/4	720.00	
USA: N-62037	V. F. Neuhaus Properties, Inc.	1/1/98	Elko	Nevada	Township 36 North, Range 67 East, MDM Sec. 2: Lots 1,2,3,4,7,8, S2N2, N2SE/4 Sec. 12: N2NW/4 Sec. 14: W2 Sec. 16: E2SE/4 Township 35 North, Range 67 East, MDM Sec. 4: Lots 5 through 20, inclusive (All) Sec. 16: NE/4 Sec. 20: S2 Sec. 22: S2NW/4, SW/4, W2SE/4 Sec. 28: All	1,600.27	
USA: N-62038	V. F. Neuhaus Properties, Inc.	1/1/98	Elko	Nevada	Township 35 North, Range 67 East, MDM Sec. 4: Lots 5 through 20, inclusive (All) Sec. 16: NE/4 Sec. 20: S2 Sec. 22: S2NW/4, SW/4, W2SE/4 Sec. 28: All	2,298.36	

EXHIBIT "A"

<u>Lessor</u>	<u>Lessee</u>	<u>Date</u>	<u>County</u>	<u>State</u>	<u>Legal Description</u>	<u>Gross Acres</u>	<u>Recording Data</u>
USA: N-62039	V. F. Neuhaus Properties, Inc.	1/1/98	Elko	Nevada	Township 34 North, Range 66 East, MDM Sec. 12: NE/4, E2NW/4, N2SE/4	1,320.00	
USA: N-62040	V. F. Neuhaus Properties, Inc.	1/1/98	Elko	Nevada	Township 34 North, Range 67 East, MDM Sec. 4: SW/4 Sec. 6: SE/4SE/4 Sec. 8: All Sec. 18: NE/4	2,208.08	
USA: N-62041	V. F. Neuhaus Properties, Inc.	1/1/98	White Pine	Nevada	Township 33 North, Range 66 East, MDM Sec. 1: Lots 1, 2, 3, 4, S2N2	4,480.00	
USA: N-62042	V. F. Neuhaus Properties, Inc.	1/1/98	White Pine	Nevada	Township 20 North, Range 64 East, MDM Sec. 2: S2S2 Sec. 3: SE/4 Sec. 10: E2, SW/4 Sec. 11: All Sec. 14: All Sec. 16: E2 Sec. 21: All Sec. 22: W2, NE/4 Sec. 28: N2	1,920.00	
					Township 19 North, Range 64 East, MDM Sec. 15: W2 Sec. 16: All Sec. 21: All Sec. 22: W2		

EXHIBIT "A"

Lessor
USA: N-62030

Lessee
V. F. Neuhaus Properties, Inc.

Date
10/1/97

County
White Pine

State
Nevada

Legal Description
Township 25 North, Range 56 East, MDM
Sec. 28: All
Sec. 33: N2

Gross Acres
960.00

Recording Data

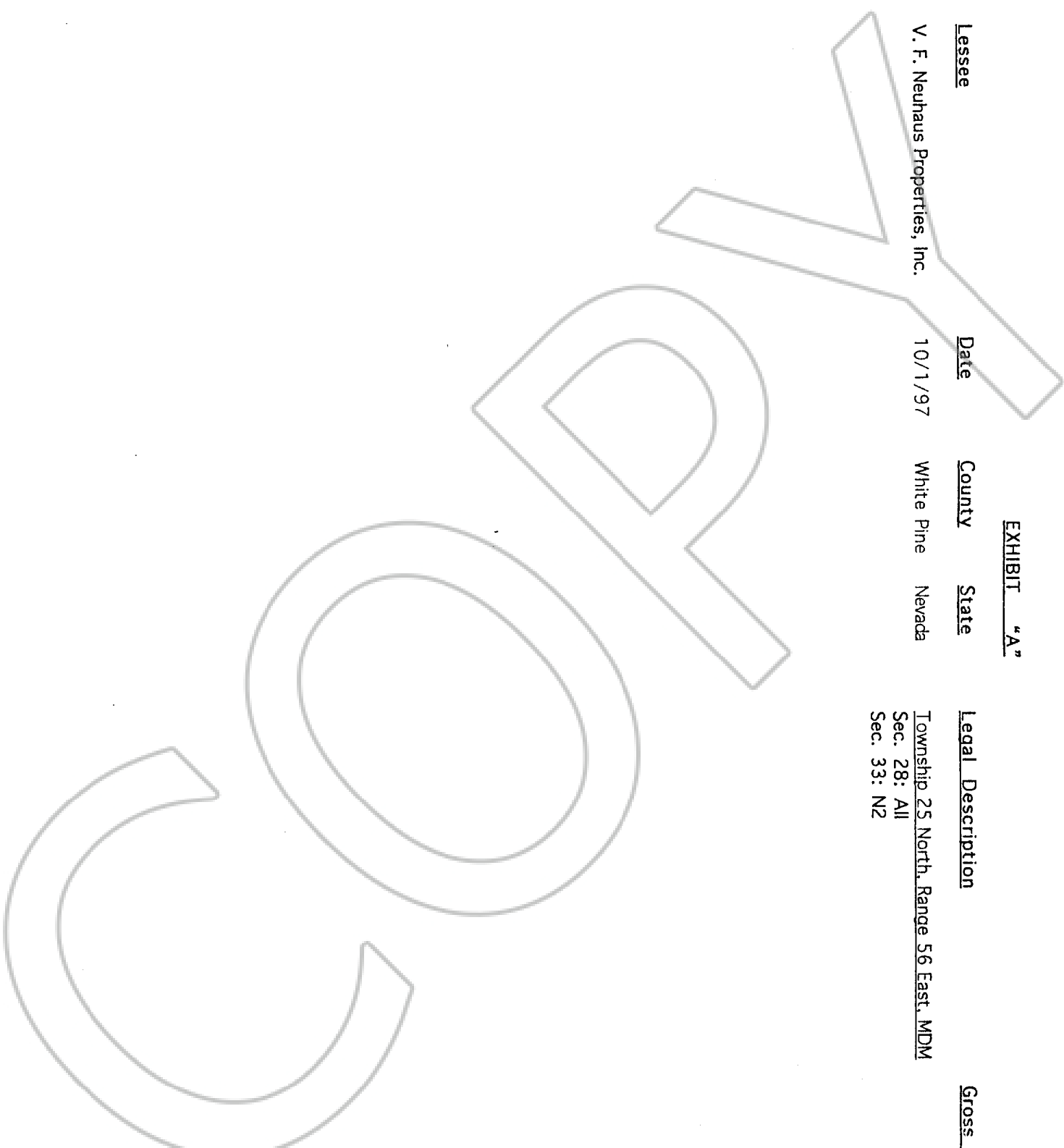

BOOK 339 P 267
OFFICIAL RECORD
RECORDED AT THE REQUEST OF
Joe Mc Mahon Jr
01 JAN -2 PM 24

EUREKA COUNTY NEVA
M.N. REBALEATI, RECORDER
FILE NO. *12⁰⁰*

175723

BOOK 339 PAGE 272

INDEXED

FEE *12⁰⁰* FILE # 465204
REQUEST OF

Joe McMahon, Jr
00 DEC 11 AM 11:07

DK *0* PG *31374*
JERRY D. REYNOLDS
ELKO CO. RECORDER

0 31379