

176397**RELEASE OF MINING LEASE**

THIS RELEASE OF MINING LEASE is made this 29TH day of January, 2001, by **WESTERN STATE MINERALS CORPORATION**, a Utah corporation whose address is 4975 Van Gordon Set, Wheat Ridge, Colorado 80033 ("WSMC") and **26 RANCH INC.**, a Colorado corporation whose address is 4975 Van Gordon Street, Wheat Ridge, Colorado 80033 ("26 Ranch").

RECITALS

- A. 26 Ranch owns certain fee lands situated in Lander and Eureka Counties, Nevada, as more particularly described in Exhibit A attached hereto and incorporated by reference herein (the "Property").
- B. 26 Ranch and Sheep Creek Corp., a Colorado corporation ("Sheep Creek"), entered into a Mining Lease dated as of October 1, 1993. A Memorandum of Mining Lease dated October 29, 1993 made in respect of the said Mining Lease was recorded in the official records of Lander County, Nevada, in Book 402, Page 572, and in the official records of Eureka County, Nevada, in Book 256, Page 338. Said Mining Lease was amended by that certain Amendment to Mining Lease made and entered into September 12, 1995. For purposes of this Release of Mining Lease, the term "Lease" shall mean, collectively, the said Mining Lease, the said Amendment to Mining Lease, and the said Memorandum of Mining Lease.
- C. Pursuant to the Lease, 26 Ranch leased and granted to Sheep Creek any and all ores, metals, minerals and materials found in, on, or under the Property (the "Valuable Minerals"), other than oil, aggregates, geothermal resources and oil, gas and other hydrocarbons, together with such other rights as are described in the Lease, including without limitation the right to enter the Property and do any and all things necessary or desirable to accomplish the purposes set forth in the Lease, and the right to use existing roads on real property owned or controlled by 26 Ranch adjacent to portions of the Property as more particularly described in Exhibit B attached hereto and incorporated by reference herein (the "Additional Property").
- D. Pursuant to the Lease, Sheep Creek granted to 26 Ranch a purchase right in the event Sheep Creek decided to sell or otherwise transfer any or all of its interest in any real property adjacent to the Property or within the exterior boundaries of the grazing allotment area depicted in Exhibit C attached hereto and incorporated by reference herein.
- E. Pursuant to an agreement dated December 22, 2000, 26 Ranch and Sheep Creek agreed to terminate the Lease effective December 22, 2000, and Sheep Creek agreed to execute and deliver to 26 Ranch a release of its rights and interest in and to the Property.

F. WSMC Sheep Creek and certain third parties possessing no interest in the Lease entered into the certain Agreement and Plan of Merger made December 28, 2000 (the "Plan"). Articles of Merger in respect of the Plan were made and duly filed with the Secretaries of State of the States of Utah and Colorado on December 28, 2000 (the "Articles"). Pursuant to the Plan and Articles, Sheep Creek merged with and into WSMC effective December 22, 2000, and WSMC was the surviving corporation following such merger.

G. This Release of Mining Lease is made by WSMC, as successor by merger to Sheep Creek, in satisfaction of Sheep Creek's obligation to execute and deliver a release of its rights and interests in the Property, and by 26 Ranch to acknowledge termination of the Lease.

NOW, THEREFORE, WSMC and 26 Ranch hereby agree as follows:

1. WSMC on behalf of itself and its successors and assigns, does hereby release, relinquish and surrender to 26 Ranch all right, title and interest which WSMC may have in or to the Property, the Additional Property, and the Valuable Minerals.

2. WSMC and 26 Ranch each acknowledge and agree: (a) that the Lease terminated on December 22, 2000; (b) to waive performance by the other party of any duty or obligation otherwise required under the Lease to be performed following such date; and (c) that from and after such date, neither WSMC nor 26 Ranch shall have any duty or obligation to the other under the Lease, whether such duty or obligation arises before or after such date.

IN WITNESS WHEREOF, WSMC and 26 Ranch have executed this Release of Mining Lease on the date first set forth above.

WESTERN STATE MINERALS CORPORATION

26 RANCH INC.

By: *Arden Morrow*
Title: President

By: *John F. Carmody*
Title: VICE PRESIDENT

STATE OF COLORADO)
) ss.
COUNTY OF Jefferson)

On this 29th day of January, 2001, before me, Robin Jones,
a Notary Public for the state of Colorado, personally appeared Arden B. Morrow,
known to me to be the President of Western States Minerals Corporation, a
Utah corporation, and a person whose name is subscribed to the within instrument and
acknowledged to me that he executed the same.

WITNESS my hand and official seal.

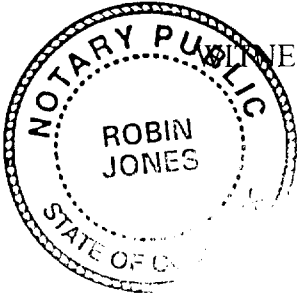

Robin Jones
Notary Public, State of Colorado
My Commission Expires: ***My Commission Expires July 10, 2004***

STATE OF COLORADO)
) ss.
COUNTY OF Jefferson)

On this 29th day of January, 2001, before me, Robin Jones,
a Notary Public for the state of Colorado, personally appeared John F. Carmody,
known to me to be the Vice-President of 26 Ranch Inc., a Colorado corporation,
and the person whose name is subscribed to the within instrument and acknowledged to me
that he executed the same.

WITNESS my hand and official seal.

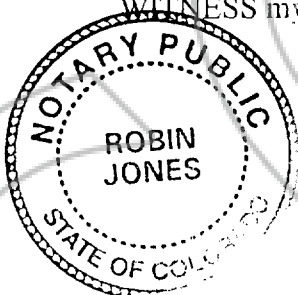

Robin Jones
Notary Public, State of Colorado
My Commission Expires: ***My Commission Expires July 10, 2004***

EXHIBIT A
To
Release Of Mining Lease
Dated January 25, 2001
By
Western States Minerals Corporation
And
26 Ranch Inc.

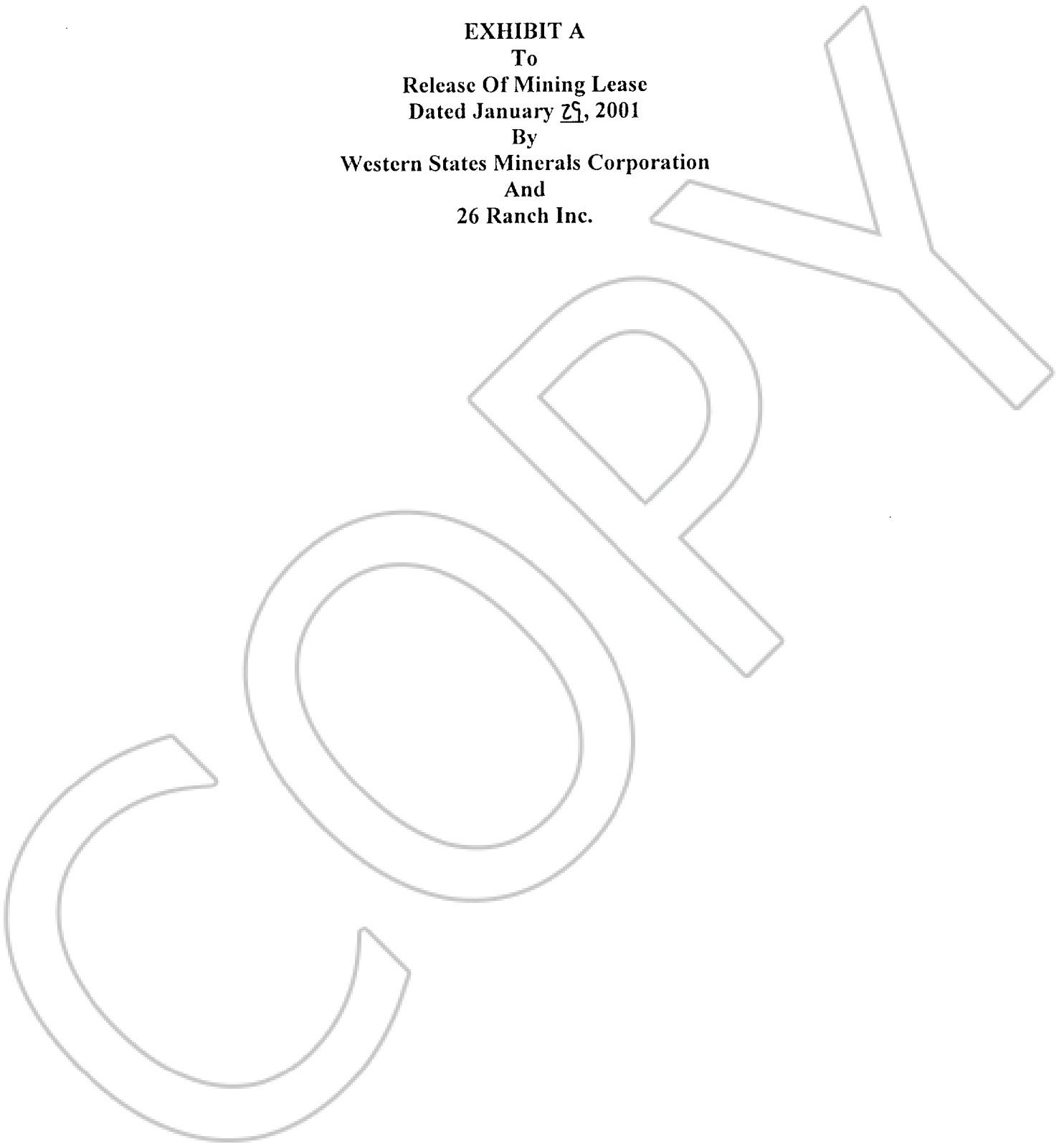

Sheep Creek Corp. Legal Descriptions

NEVADA COUNTY NAME	TOWN SHIP NO.	RANGE EAST	SEC. NO.	ACRES	LEGAL DESCRIPTION	ASSESSOR'S PARCEL NUMBER		
LANDER	33	47	9		WESTERLY AND NORTHWESTERLY OF THE FOLLOWING DESCRIBED LINE; COMMENCING AT THE SOUTHWEST CORNER OF SAID SECTION 9; THENCE SOUTH 89 DEGREES 54 MINUTES EAST 518.00 FEET; THENCE NORTH 45 DEGREES 30 MINUTES EAST 3,759.10 FEET, MORE OR LESS, TO A POINT OF INTERSECTION WITH THE SOUTH LINE OF THE NORTHEAST QUARTER OF SAID SECTION 9 AND THE ACTUAL POINT OF BEGINNING OF THE LINE TO BE DESCRIBED; THENCE FROM SAID POINT CONTINUING NORTH 45 DEGREES 30 MINUTES EAST 2,894.20 FEET MORE OR LESS, TO A POINT OF INTERSECTION WITH THE EAST LINE OF SAID SECTION 9.	APN 08-150-13		
LANDER	33	47	9					
LANDER	33	47	9					
LANDER	33	47	9					
LANDER	33	47	9					
LANDER	33	47	9					
LANDER	33	47	9					
LANDER	33	47	9					
LANDER	33	47	9					
LANDER	33	47	9					
LANDER	33	47	17	113			ALL THAT PORTION LYING NORTHERLY AND NORTHWESTERLY OF THE FOLLOWING DESCRIBED LINE; BEGINNING AT A POINT ON THE EAST LINE OF SAID SECTION 17, THAT IS DISTANT SOUTHERLY THEREON, 667.50 FEET FROM THE NORTHEAST CORNER OF SAID SECTION 17; THENCE SOUTH 38 DEGREES 51 MINUTES WEST 1,400.00 FEET; THENCE SOUTH 63 DEGREES 15 MINUTES WEST 1,960.00 FEET MORE OR LESS, TO A POINT OF INTERSECTION WITH THE SOUTH LINE OF THE NORTHEAST QUARTER OF SAID SECTION 17.	
LANDER	33	47	17					
LANDER	33	47	17					
LANDER	33	47	17					
LANDER	33	47	17					
LANDER	33	47	17					
LANDER	33	47	17					
LANDER	33	47	17					
LANDER	33	47	17					
LANDER	33	47	17					
LANDER	33	47	17					
				1,174				
LANDER	34	46	25	640	ALL	APN 08-080-30		
LANDER	34	46	27	640	ALL	APN 08-080-28		
LANDER	34	46	29	640	ALL	APN 08-080-26		
LANDER	34	46	31	584	ALL	APN 08-080-31		
LANDER	34	46	33	640	ALL	APN 08-080-33		
LANDER	34	46	35	640	ALL	APN 08-080-35		
				3,784				
LANDER	34	47	1	680	ALL	APN 08-090-06		
LANDER	34	47	11	640	ALL	APN 08-090-12		
LANDER	34	47	13	500	LOTS 1&2(E2NE4); W2NE4; W2	APN 08-090-21		
LANDER	34	47	21	640	ALL	APN 08-090-26		
LANDER	34	47	23	475	LOTS 1&2(S2SW4); N2SW4; N2	APN 08-090-28		
LANDER	34	47	25	300	LOTS 1&2(N2NE4); LOTS 6&7(W2SW4); AND THAT PORTION OF THE SOUTH HALF OF NORTHEAST QUARTER LYING WESTERLY AND NORTHWESTERLY OF THE FOLLOWING DESCRIBED LINE; BEGINNING AT A POINT ON THE EAST LINE OF SAID SECTION 25, THAT IS DISTANT SOUTHERLY THEREON 1,690.20 FEET FROM THE NORTHEAST CORNER OF SAID SECTION 25; THENCE SOUTH 44 DEGREES 00 MINUTES WEST 1,320.30 FEET, MORE OR LESS, TO A POINT OF INTERSECTION WITH THE SOUTH LINE OF THE NORTHEAST QUARTER OF SAID SECTION 25. AND THAT PORTION OF THE EAST HALF OF SOUTHWEST QUARTER LYING WESTERLY AND NORTHWESTERLY OF THE FOLLOWING DESCRIBED LINE; COMMENCING AT THE NORTHEAST CORNER OF SAID SECTION 25; THENCE SOUTHERLY ALONG THE EAST LINE OF SAID SECTION 25, A DISTANCE OF 1,690.20 FEET; THENCE SOUTH 44 DEGREES 00 MINUTES WEST 3,762.80 FEET, MORE OR LESS, TO A POINT OF INTERSECTION WITH THE EAST LINE OF THE SOUTHWEST QUARTER OF SAID SECTION 25 AND THE ACTUAL POINT OF BEGINNING OF THE LINE TO BE DESCRIBED; THENCE	APN 08-100-02 & APN 08-100-03		
LANDER	34	47	25					
LANDER	34	47	25					
LANDER	34	47	25					
LANDER	34	47	25					
LANDER	34	47	25					
LANDER	34	47	25					
LANDER	34	47	25					
LANDER	34	47	25					
LANDER	34	47	25					
LANDER	34	47	25					
LANDER	34	47	25					
LANDER	34	47	25					
LANDER	34	47	25					
LANDER	34	47	25					
LANDER	34	47	25					
LANDER	34	47	25					
LANDER	34	47	25					

EXHIBIT B
To
Release Of Mining Lease
Dated January 21, 2001
By
Western States Minerals Corporation
And
26 Ranch Inc.

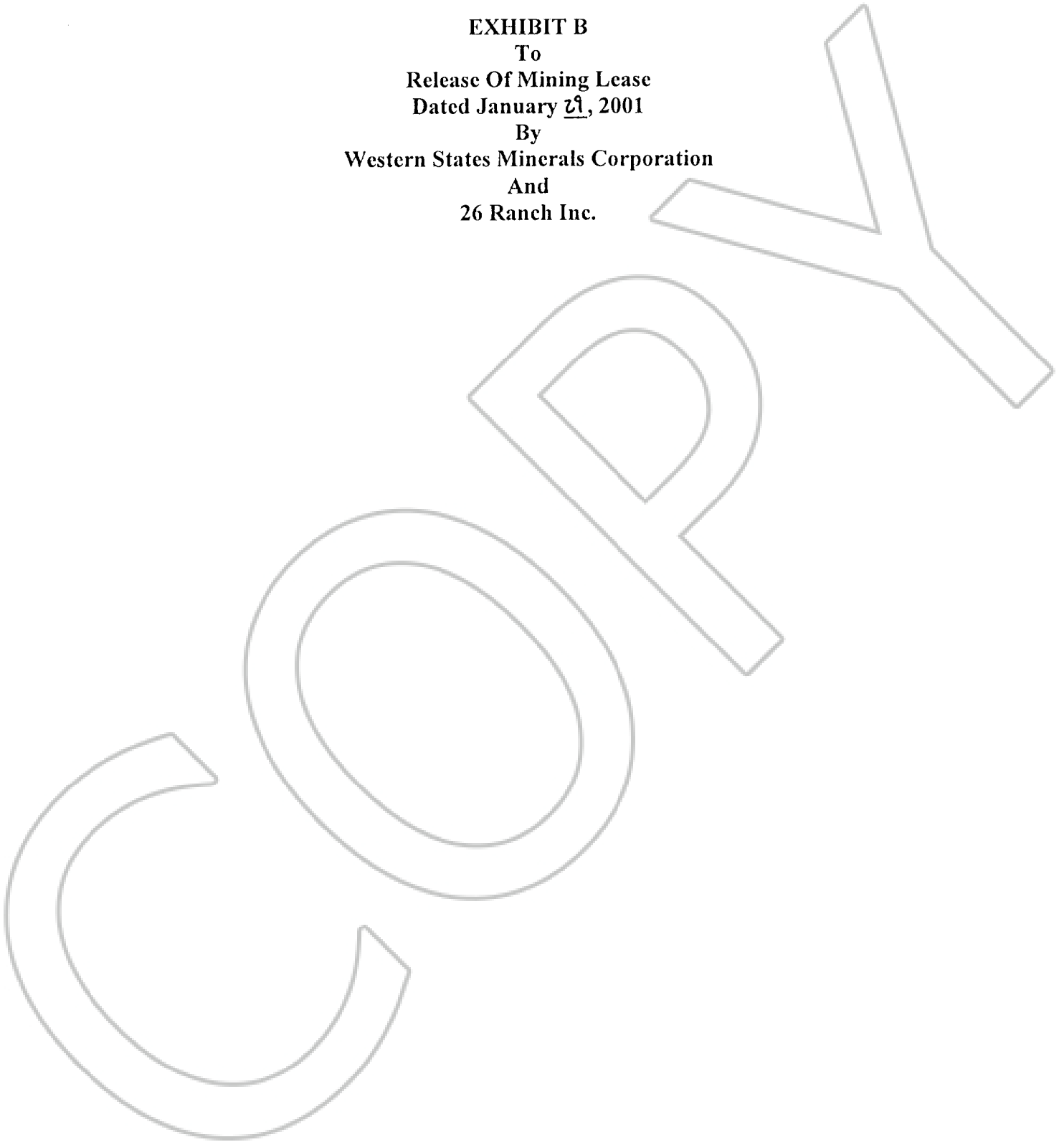

Gatecliff Corp. Legal Descriptions

NEVADA COUNTY NAME	TOWNSHIP NO.	RANGE EAST	SECTION NO.	ACRES	LEGAL DESCRIPTION	ASSESSOR'S PARCEL NUMBER
LANDER	32	45	2	638.1	ALL	APN 08-260-01
				638.1		
HUMBOLDT	33	44	4	561.1	W2E2E2; W2E2; W2	APN 07-471-02
HUMBOLDT	33	44	5	642	ALL	APN 07-471-02
HUMBOLDT	33	44	8	80	N2NE4	APN 07-471-02
HUMBOLDT	33	44	9	480	W2E2E2; W2E2; E2SW4; NW4	APN 07-471-02
HUMBOLDT	33	44	16	320	W2E2E2; W2E2; E2NW4	APN 07-471-02
HUMBOLDT	33	44	21	40	W2E2NE4	APN 07-471-02
				2.123		
LANDER	33	44	3	280	W2NW4; SW4SE4; SW4	APN 08-120-24
LANDER	33	44	4	80	E2E2E2	APN 08-120-24
LANDER	33	44	9	80	E2E2E2	APN 08-120-24
LANDER	33	44	10	640	ALL	APN 08-120-24
LANDER	33	44	12	595	N2NE4; SW4NE4; W2; SE4 EXCEPTING THEREFROM 4.5 ACRES, MORE OR LESS, AS CONVEYED BY DEED DATED AUGUST 9, 1907, EXECUTED BY RUSSELL LAND AND CATTLE COMPANY TO WESTERN PACIFIC RAILWAY COMPANY, RECORDED IN BOOK 51, PAGE 183, DEED RECORDS OF LANDER COUNTY, NEVADA.	APN 08-120-10
LANDER	33	44	12			
LANDER	33	44	12			
LANDER	33	44	12			
LANDER	33	44	12			
LANDER	33	44	12			
LANDER	33	44	14	44	NW4NW4; S2NW4; S2	APN 08-120-24
LANDER	33	44	15	64	ALL	APN 08-120-24
LANDER	33	44	16	8	E2E2E2	APN 08-120-24
LANDER	33	44	21	4	E2E2NE4	APN 08-120-24
LANDER	33	44	22	60	N2; SE4; N2SW4; SE4SW4	APN 08-120-24
LANDER	33	44	23	64	ALL	APN 08-120-24
LANDER	33	44	24	64	ALL	APN 08-120-24
LANDER	33	44	25	64	ALL	APN 08-120-24
LANDER	33	44	26	64	ALL	APN 08-120-24
LANDER	33	44	36	511	ALL EXCEPTING THEREFROM 30 ACRES, MORE OR LESS, AS CONVEYED BY DEED DATED APRIL 22, 1903, EXECUTED BY RUSSELL AND BRADLEY LAND AND CATTLE COMPANY TO CENTRAL PACIFIC RAILWAY COMPANY; RECORDED IN BOOK 49, PAGE 754, DEED RECORDS OF LANDER COUNTY, NEVADA.	APN 08-120-24
LANDER	33	44	36			
LANDER	33	44	36			
LANDER	33	44	36			
LANDER	33	44	36			
				6.64		
HUMBOLDT	34	44	31	52	ALL	APN 07-471-02
HUMBOLDT	34	44	32	64	ALL	APN 07-471-02
HUMBOLDT	34	44	33	56	W2E2; W2; W2E2E2	APN 07-471-02
				1.82		
LANDER	34	44	26	2	NW4; N2SW4; SE4SW4	APN 08-780-22
LANDER	34	44	33	8	E2E2E2	APN 08-780-30
LANDER	34	44	36	18	SW4NW4; N2SW4; SE4SW4	APN 08-780-49
LANDER	34	44	36	12	NW4SE4; E2SE4	APN 08-780-49
				64		
LANDER	34	46	1	64	ALL	APN 08-080-06
LANDER	34	46	3	66	ALL	APN 08-080-04

NEVADA COUNTY NAME	TOWN SHIP NO.	RANGE EAST	SEC. NO.	ACR.	LEGAL DESCRIPTION	ASSESSOR'S PARCEL NUMBER
LANDER	34	46	5	84	ALL	APN 08-080-02
LANDER	34	46	7	86	ALL	APN 08-080-07
LANDER	34	46	9	80	ALL	APN 08-080-09
LANDER	34	46	11	80	ALL	APN 08-080-11
LANDER	34	46	13	80	ALL	APN 08-080-14
LANDER	34	46	15	80	ALL	APN 08-080-16
LANDER	34	46	17	80	ALL	APN 08-080-18
LANDER	34	46	19	88	ALL	APN 08-080-19
LANDER	34	46	21	80	ALL	APN 08-080-21
LANDER	34	46	23	80	ALL	APN 08-080-23
				7.48		
LANDER	34	47	3	.00	ALL	APN 08-090-04
LANDER	34	47	5	.00	ALL	APN 08-090-02
LANDER	34	47	7	.00	ALL	APN 08-090-08
LANDER	34	47	9	.00	ALL	APN 08-090-10
LANDER	34	47	15	.00	ALL	APN 08-090-19
LANDER	34	47	17	.00	ALL	APN 08-090-17
LANDER	34	47	19	.00	ALL	APN 08-090-24
				4.00		
LANDER	35	45	9	.00	E2SE4; SW4SE4	APN 08-040-18
LANDER	35	45	10	.00	N2; W2SW4	APN 08-040-18
LANDER	35	45	10	.00	E2SW4; SE4	APN 08-040-18
LANDER	35	45	16	.00	N2NE4; SW4NE4; S2NW4; NW4SW4; NE4NW4	APN 08-040-18
LANDER	35	45	20	.00	NW4NE4; N2NW4	APN 08-040-37
				1.00		
ELKO	36	45	4	.00	SE4NE4; E2SE4	APN 04-110-02
ELKO	36	45	10	.00	NW4NW4; SE4NW4; NE4SW4; SW4SW4	APN 04-110-02
ELKO	36	45	16	.00	NW4NE4	APN 04-110-02
				.00		
				25.65		

NEVADA COUNTY NAME	TOWNSHIP NO.	RANGE EAST	SECTION NO.	ACRE:	LEGAL DESCRIPTION	ASSESSOR'S PARCEL NUMBER
HUMBOLD	34	43	13	42	SE 1/4 SE 1/4, EXCEPT A STRIP OF LAND 100 FEET IN WIDTH BEING 50 FEET ON EACH SIDE OF AND PARALLEL WITH THE LOCATED CENTER LINE OF THE WESTERN PACIFIC RAILWAY COMPANY'S LINE OF RAILROAD AS THE SAME IS STAKED OUT AND LOCATED OVER AND ACROSS SECTION 13, AS SET FORTH IN DEED RECORDED IN BOOK 41, PAGE 221, DEED RECORDS OF HUMBOLD COUNTY, NEVADA	APN 07-401-27 APN 07-401-27 APN 07-401-27 APN 07-401-27 APN 07-401-27 APN 07-401-27 APN 07-401-27
HUMBOLD	34	43	24	167	E 1/2 E 1/2	APN 07-401-27 APN 07-401-27
				200		
HUMBOLD	34	44	18	39	LOT 4 OF THE SW 1/4	APN 07-421-16
HUMBOLD	34	44	19	624	ALL (LOTS 1,2,3 & 4; E 1/2 W 1/2; E 1/2)	APN 07-421-16
HUMBOLD	34	44	20	40	SW 1/4 SW 1/4	APN 07-421-16
HUMBOLD	34	44	29	640	ALL	APN 07-421-16
HUMBOLD	34	44	30	586	E 1/2 SW 1/4; LOT 3 SW 1/4; E 1/2; NW 1/4 (LOTS 1 & 2; E 1/2 NW 1/4)	APN 07-421-16 APN 07-421-16
				1,929		
				2,129		

Tennile Corp. Legal Descriptions

NEVADA COUNTY NAME	TOWNSHIP NO.	RANGE EAST	SECTION NO.	ACRES	LEGAL DESCRIPTION	ASSESSOR'S PARCEL NUMBER
ELKO	36	46	1	79	LOT 1(NE4NE4); SE4NE4	APN 04-230-01
ELKO	36	46	5	160	SW4SE4; NW4SW4; S2SW4	APN 04-230-01
ELKO	36	46	6	240	LOTS 1,2,3,&4(N2N2); SE4NE4; NW4SE4	APN 04-230-01
ELKO	36	46	6	40	NE4SE4	APN 04-230-01
ELKO	36	46	7	160	N2SE4; SE4SE4; NE4SW4	APN 04-230-01
ELKO	36	46	7	78	LOT 2(SW4NW4); LOT 3(NW4SW4)	APN 04-230-01
ELKO	36	46	8	160	NW4NE4; S2NE4; NE4NW4	APN 04-230-01
ELKO	36	46	9	40	SE4SW4	APN 04-230-01
ELKO	36	46	17	160	SW4NE4; N2NW4; SE4NW4	APN 04-230-01
ELKO	36	46	18	40	NE4NE4	APN 04-230-01
				1.151		
LANDER	36	46	16	120	SW4SE4;	APN 08-020-03
LANDER	36	46	16		N2SW4	APN 08-020-02
LANDER	36	46	17	40	NE4SE4	APN 08-020-02
				160		
ELKO	36	47	6	119	LOT 5(SW4NW4); W2SW4	APN 04-360-01
ELKO	36	47	7	152	W2W2	APN 04-360-01
ELKO	36	47	10	40	SE4SE4	APN 04-360-01
ELKO	36	47	11	240	N2SE4; SW4	APN 04-360-01
ELKO	36	47	12	240	N2NE4; NE4NW4; S2NW4; NW4SW4	APN 04-360-01
ELKO	36	47	15	240	N2NE4; SW4NE4; NE4NW4; S2NW4	APN 04-360-01
ELKO	36	47	16	40	SE4NE4	APN 04-360-01
ELKO	36	47	18	7	LOT 1(NW4NW4); LOT 2(SW4NW4)	APN 04-360-01
				1.152		
LANDER	36	47	16	200	N2SE4; S2SW4; SW4SE4	APN 08-030-06
LANDER	36	47	18	71	LOT 3(NW4SW4); LOT 4(SW4SW4)	APN 08-030-06
LANDER	36	47	19	313	NW4; W2SE4; N2SW4; SE4SW4	APN 08-030-06
LANDER	36	47	20	200	NE4NE4; S2NE4; NW4SE4; NE4SW4; S2SW4	APN 08-030-06
LANDER	36	47	21	00	N2NW4	APN 08-030-06
LANDER	36	47	29	00	NW4NW4	APN 08-030-06
LANDER	36	47	30	200	NE4NE4; W2E2	APN 08-030-06
LANDER	36	47	30	100	SE4NE4; SE4NW4; E2SW4	APN 08-030-06
				1.344		
ELKO	36	48	5	42	LOT 2(NW4NE4); LOTS 3&4(N2NW4); S2NW4	APN 04-480-01
ELKO	36	48	6	102	LOTS 6&7(W2SW4); SE4NE4; E2SW4; N2SE4	APN 04-480-01
				44		
ELKO	37	45	26	00	NW4NW4	APN 04-120-03
ELKO	37	45	36	00	SE4NE4; SW4SE4	APN 04-120-03
				.00		
ELKO	37	46	13	.00	SE4SE4	APN 04-240-01
ELKO	37	46	24	.00	E2E2; SW4NE4; W2SE4	APN 04-240-01
ELKO	37	46	25	.00	E2E2; W2NE4; SW4SE4	APN 04-240-01
ELKO	37	46	25	.00	E2W2; NW4SE4	APN 04-240-01

NEVADA COUNTY NAME	TOWNSHIP NO.	RANGE EAST	SECTION NO.	ACRES	LEGAL DESCRIPTION	ASSESSOR'S PARCEL NUMBER
ELKO	37	46	28	80	S2NW4	APN 04-240-01
ELKO	37	46	29	160	S2N2	APN 04-240-01
ELKO	37	46	30	120	NW4NE4; SE4NE4; NE4NW4	APN 04-240-01
ELKO	37	46	36	160	E2E2	APN 04-240-01
ELKO	37	46	36	80	NW4NE4; NE4NW4	APN 04-240-01
				1,400		
ELKO	37	47	13	40	SE4NE4	APN 04-370-01
				40		
ELKO	37	48	6	240	LOT 1(NE4NE4); S2NE4; E2SW4; NW4SE4	APN 04-490-01
ELKO	37	48	7	200	SW4NE4; E2NW4; W2SE4	APN 04-490-01
ELKO	37	48	17	80	N2SW4	APN 04-490-01
ELKO	37	48	18	200	LOT 2(SW4NW4); N2NE4; SE4NE4; SE4NW4; NE4SE4	APN 04-490-01
ELKO	37	48	20	40	NE4NE4	APN 04-490-01
ELKO	37	48	25	200	S2S2; NE4SE4	APN 04-490-01
ELKO	37	48	26	120	S2SE4; SE4SW4	APN 04-490-01
ELKO	37	48	28	120	W2SE4; SE4SW4	APN 04-490-01
ELKO	37	48	32	120	NE4SE4; S2SE4	APN 04-490-01
ELKO	37	48	33	320	NE4; E2NW4; N2SW4	APN 04-490-01
ELKO	37	48	34	160	N2N2	APN 04-490-01
ELKO	37	48	35	40	NW4NW4	APN 04-490-01
				1,870		
ELKO	38	47	12	160	NW4NW4; SE4NW4; W2SE4	APN 04-380-02
ELKO	38	47	13	80	NE4NE4; NW4SW4	APN 04-380-02
				240		
ELKO	38	48	1	80	SW4NE4; NW4SE4	APN 04-500-01
ELKO	38	48	4	80	W2SW4	APN 04-500-01
ELKO	38	48	12	120	SE4NW4; N2SW4	APN 04-500-01
ELKO	38	48	17	80	NW4NW4	APN 04-500-01
				320		
				8,337		

NEVADA COUNTY NAME	TOWN SHIP NO.	RANGE EAST	SEC. NO.	ACRE	LEGAL DESCRIPTION	ASSESSOR'S PARCEL NUMBER
ELKO	36	51	5	.83	NW4SW4; SE4SW4	APN 04-840-03
ELKO	36	51	6	1.95	SE4NE4; SW4NW4; NE4SE4; W2SW4	APN 04-840-03
ELKO	36	51	6	1.53	LOT 2(NW4NE4); LOTS 3&4(N2NW4); SW4NE4	APN 04-840-03
ELKO	36	51	8	.83	N2NW4	APN 04-840-03
				5.13		
ELKO	37	49	2	.43	LOT 4(NW4NW4)	APN 04-610-02
ELKO	37	49	3	1.10	LOTS 1,2,3&4(N2N2)	APN 04-610-02
ELKO	37	49	4	2.22	LOTS 1&2(N2NE4); LOT 3(NE4NW4); S2NW4; W2SW4	APN 04-610-02
ELKO	37	49	5	2.53	LOT 2(NW4NE4); SW4NE4; NW4SE4; S2SE4; E2SW4	APN 04-610-02
ELKO	37	49	6	.77	LOT 4(NW4NW4); LOT 7(SW4SW4)	APN 04-610-02
ELKO	37	49	7	.71	LOT 4(SW4SW4)	APN 04-610-02
ELKO	37	49	8	2.40	W2NE4; E2W2	APN 04-610-02
ELKO	37	49	13	1.70	NE4SE4; S2SE4; SE4SW4	APN 04-610-02
ELKO	37	49	16	.70	N2NE4	APN 04-610-02
ELKO	37	49	17	3.30	W2NE4; E2NW4; SE4	APN 04-610-02
ELKO	37	49	18	.18	LOT 4(SW4SW4)	APN 04-610-02
ELKO	37	49	19	.70	LOT 4(SW4SW4)	APN 04-610-02
ELKO	37	49	20	3.30	E2	APN 04-610-02
ELKO	37	49	24	2.30	NE4NW4; W2W2	APN 04-610-02
ELKO	37	49	25	2.30	W2W2; S2SE4; SE4SW4	APN 04-610-02
ELKO	37	49	25	1.70	N2NE4; NE4NW4	APN 04-610-02
ELKO	37	49	26	.70	SE4SE4	APN 04-610-02
ELKO	37	49	29	1.30	NW4NE4; N2NW4; SW4NW4	APN 04-610-02
ELKO	37	49	30	2.30	NE4NE4; S2NE4; NW4SE4; NE4SW4; LOT 3(NW4SW4); LOT 4(SW4SW4)	APN 04-610-02
ELKO	37	49	30	.70	E2NE4	APN 04-610-02
ELKO	37	49	36	.70	N2NE4	APN 04-610-02
ELKO	37	49	36	.70	NW4NW4	APN 04-610-02
				3.34		
ELKO	37	50	3	.52	LOT 1(NE4NE4); LOT 3(NE4NW4); S2SW4; S2SE4	APN 04-730-01
ELKO	37	50	6	.94	LOT 2(NW4NE4)	APN 04-730-01
ELKO	37	50	6	.48	LOT 5(SW4NW4); SE4NW4; E2SW4	APN 04-730-01
ELKO	37	50	7	.00	E2NW4; NE4SW4; SE4SW4; SW4SE4	APN 04-730-01
ELKO	37	50	8	.00	NE4SE4; SW4SE4	APN 04-730-01
ELKO	37	50	9	.00	NE4NE4; S2NE4; N2SW4	APN 04-730-01
ELKO	37	50	10	.99	NE4NW4; S2NW4; NW4SE4; SE4SE4	APN 04-730-01
ELKO	37	50	15	.01	LOTS 1&2(E2NE4); SW4NE4; NE4SW4; S2SW4; NW4SE4	APN 04-730-01
ELKO	37	50	16	.00	SW4SE4	APN 04-730-01
ELKO	37	50	17	.00	E2NW4; SW4	APN 04-730-01
ELKO	37	50	18	.40	LOT 2(SW4NW4); LOT 3(NW4SW4); E2NW4; NE4SW4; N2SE4	APN 04-730-01
ELKO	37	50	18	.00	SW4SE4	APN 04-730-01
ELKO	37	50	19	.00	NE4NE4	APN 04-730-01
ELKO	37	50	20	.00	NE4NW4; N2NE4; SE4NE4; SE4NW4; E2SW4	APN 04-730-01
ELKO	37	50	20	.00	NW4NW4	APN 04-730-01
ELKO	37	50	20	.00	E2SE4	APN 04-730-01
ELKO	37	50	21	.00	W2NW4; N2NE4; NE4NW4; N2SW4; SE4SW4; S2SE4	APN 04-730-01
ELKO	37	50	22	.05	SW4SW4; LOT 2(SE4NE4); NW4NE4; N2NW4; N2SW4; SE4SW4; W2SE4	APN 04-730-01
ELKO	37	50	27	.00	E2SW4; W2NW4; NW4SW4	APN 04-730-01
ELKO	37	50	28	.00	SE4NW4; N2SW4; SW4SW4	APN 04-730-01
ELKO	37	50	28	.00	N2NW4; N2SE4	APN 04-730-01
ELKO	37	50	29	.00	SE4NW4; NE4SW4; W2SE4	APN 04-730-01
ELKO	37	50	29	.00	N2N2	APN 04-730-01
ELKO	37	50	30	.00	NE4NE4	APN 04-730-01
ELKO	37	50	30	3.41	NW4NE4; N2NW4	APN 04-730-01

NEVADA COUNTY NAME	TOWN SHIP NO.	RANGE EAST	SEC. NO.	ACRES	LEGAL DESCRIPTION	ASSESSOR'S PARCEL NUMBER
ELKO	36	51	5		80.1 NW4SW4; SE4SW4	APN 04-840-03
ELKO	36	51	6		195.7 SE4NE4; SW4NW4; NE4SE4; W2SW4	APN 04-840-03
ELKO	36	51	6		158.1 LOT 2(NW4NE4); LOTS 3&4(N2NW4); SW4NE4	APN 04-840-03
ELKO	36	51	8		80.1 N2NW4	APN 04-840-03
				513.1		
ELKO	37	49	2	40.1	LOT 4(NW4NW4)	APN 04-610-02
ELKO	37	49	3	161.1	LOTS 1,2,3&4(N2N2)	APN 04-610-02
ELKO	37	49	4	281.1	LOTS 1&2(N2NE4); LOT 3(NE4NW4); S2NW4; W2SW4	APN 04-610-02
ELKO	37	49	5	280.1	LOT 2(NW4NE4); SW4NE4; NW4SE4; S2SE4; E2SW4	APN 04-610-02
ELKO	37	49	6	75.1	LOT 4(NW4NW4); LOT 7(SW4SW4)	APN 04-610-02
ELKO	37	49	7	37.1	LOT 4(SW4SW4)	APN 04-610-02
ELKO	37	49	8	240.1	W2NE4; E2W2	APN 04-610-02
ELKO	37	49	13	160.1	NE4SE4; S2SE4; SE4SW4	APN 04-610-02
ELKO	37	49	16	80.1	N2NE4	APN 04-610-02
ELKO	37	49	17	320.1	W2NE4; E2NW4; SE4	APN 04-610-02
ELKO	37	49	18	37.1	LOT 4(SW4SW4)	APN 04-610-02
ELKO	37	49	19	38.1	LOT 4(SW4SW4)	APN 04-610-02
ELKO	37	49	20	320.1	E2	APN 04-610-02
ELKO	37	49	24	200.1	NE4NW4; W2W2	APN 04-610-02
ELKO	37	49	25	280.1	W2W2; S2SE4; SE4SW4	APN 04-610-02
ELKO	37	49	25	120.1	N2NE4; NE4NW4	APN 04-610-02
ELKO	37	49	26	40.1	SE4SE4	APN 04-610-02
ELKO	37	49	29	160.1	NW4NE4; N2NW4; SW4NW4	APN 04-610-02
ELKO	37	49	30	275.1	NE4NE4; S2NE4; NW4SE4; NE4SW4; LOT 3(NW4SW4); LOT 4(SW4SW4)	APN 04-610-02
ELKO	37	49	30	80.1	E2NE4	APN 04-610-02
ELKO	37	49	36	80.1	N2NE4	APN 04-610-02
ELKO	37	49	36	40.1	NW4NW4	APN 04-610-02
				3,341		
ELKO	37	50	3	221.1	LOT 1(NE4NE4); LOT 3(NE4NW4); S2SW4; S2SE4	APN 04-730-01
ELKO	37	50	6	36.1	LOT 2(NW4NE4)	APN 04-730-01
ELKO	37	50	6	158.1	LOT 5(SW4NW4); SE4NW4; E2SW4	APN 04-730-01
ELKO	37	50	7	200.1	E2NW4; NE4SW4; SE4SW4; SW4SE4	APN 04-730-01
ELKO	37	50	8	84.1	NE4SE4; SW4SE4	APN 04-730-01
ELKO	37	50	9	200.1	NE4NE4; S2NE4; N2SW4	APN 04-730-01
ELKO	37	50	10	198.1	NE4NW4; S2NW4; NW4SE4; SE4SE4	APN 04-730-01
ELKO	37	50	15	25.1	LOTS 1&2(E2NE4); SW4NE4; NE4SW4; S2SW4; NW4SE4	APN 04-730-01
ELKO	37	50	16	40.1	SW4SE4	APN 04-730-01
ELKO	37	50	17	240.1	E2NW4; SW4	APN 04-730-01
ELKO	37	50	18	273.1	LOT 2(SW4NW4); LOT 3(NW4SW4); E2NW4; NE4SW4; N2SE4	APN 04-730-01
ELKO	37	50	18	40.1	SW4SE4	APN 04-730-01
ELKO	37	50	19	40.1	NE4NE4	APN 04-730-01
ELKO	37	50	20	280.1	NE4NW4; N2NE4; SE4NE4; SE4NW4; E2SW4	APN 04-730-01
ELKO	37	50	20	40.1	NW4NW4	APN 04-730-01
ELKO	37	50	20	80.1	E2SE4	APN 04-730-01
ELKO	37	50	21	400.1	W2NW4; N2NE4; NE4NW4; N2SW4; SE4SW4; S2SE4	APN 04-730-01
ELKO	37	50	22	385.1	SW4SW4; LOT 2(SE4NE4); NW4NE4; N2NW4; N2SW4; SE4SW4; W2SE4	APN 04-730-01
ELKO	37	50	22	200.1	E2SW4; W2NW4; NW4SW4	APN 04-730-01
ELKO	37	50	28	160.1	SE4NW4; N2SW4; SW4SW4	APN 04-730-01
ELKO	37	50	28	160.1	N2NW4; N2SE4	APN 04-730-01
ELKO	37	50	29	160.1	SE4NW4; NE4SW4; W2SE4	APN 04-730-01
ELKO	37	50	29	160.1	N2N2	APN 04-730-01
ELKO	37	50	30	40.1	NE4NE4	APN 04-730-01
ELKO	37	50	30	111.1	NW4NE4; N2NW4	APN 04-730-01

NEVADA COUNTY NAME	TOWN SHIP NO.	RANGE EAST	SEC. NO.	ACRES	LEGAL DESCRIPTION	ASSESSOR'S PARCEL NUMBER
ELKO	37	50	31	15	S2N2	APN 04-730-01
ELKO	37	50	32	24	NW4NE4; NE4NE4; S2NE4; NE4SW4; NW4SE4	APN 04-730-01
ELKO	37	50	32	16	NW4	APN 04-730-01
ELKO	37	50	33	12	NW4NE4; N2NW4	APN 04-730-01
ELKO	37	50	34	22	LOTS 1&2(E2NE4); W2SE4; NW4NE4; NE4NW4	APN 04-730-01
				5.084		
ELKO	37	51	1	59	LOTS 1,2,3&4(N2N2); S2NE4; SE4NW4; S2	APN 04-850-01
ELKO	37	51	2	23	LOT 1(NE4NE4); SW4NE4; SE4NW4; N2SW4; NW4SE4	APN 04-850-01
ELKO	37	51	3	16	W2W2	APN 04-850-01
ELKO	37	51	4	40	LOT 1(NE4NE4); SW4NW4; S2	APN 04-850-01
ELKO	37	51	5	8	LOT 2(NW4NE4); SE4NE4	APN 04-850-01
ELKO	37	51	7	31	LOTS 1&2(W2NW4); LOT 3(NW4SW4); NW4NE4;	APN 04-850-01
ELKO	37	51	7		NE4NW4; SW4SE4; S2SW4	
ELKO	37	51	8	16	NW4NE4; S2NE4; NE4NW4	APN 04-850-01
ELKO	37	51	9	32	S2SW4; S2NE4; SW4NW4; N2SW4; NW4SE4	APN 04-850-01
ELKO	37	51	10	64	ALL	APN 04-850-01
ELKO	37	51	12	16	W2NE4; E2NW4	APN 04-850-01
ELKO	37	51	13	4	SW4SW4	APN 04-850-01
ELKO	37	51	14	44	S2NE4; NW4; NE4SW4; SE4	APN 04-850-01
ELKO	37	51	15	4	NW4SW4	APN 04-850-01
ELKO	37	51	16	28	SW4SW4; NW4NW4; E2SW4; N2SE4; SW4SE4	APN 04-850-01
ELKO	37	51	17	38	SW4SE4; N2SW4; SE4SW4; NW4SE4; SE4SE4;	APN 04-850-01
ELKO	37	51	17		SW4NE4; E2NE4	
ELKO	37	51	18	19	SW4NE4; NW4NE4; SW4SE4; SE4SW4; LOT 4(SW4SW4)	APN 04-850-01
ELKO	37	51	18	8	N2SE4	APN 04-850-01
ELKO	37	51	19	4	NE4SW4	APN 04-850-01
ELKO	37	51	20	20	SW4SW4; E2W2	APN 04-850-01
ELKO	37	51	21	24	NE4NW4; NW4SE4; S2SE4; SW4NE4; SE4NW4	APN 04-850-01
ELKO	37	51	22	8	SE4NE4; SE4NW4	APN 04-850-01
ELKO	37	51	24	40	N2; W2SE4	APN 04-850-01
ELKO	37	51	27	8	NW4NW4; SW4SW4	APN 04-850-01
ELKO	37	51	28	20	E2NE4; NE4SE4; S2S2	APN 04-850-01
ELKO	37	51	29	40	SW4NW4; SE4SE4; E2W2; W2E2	APN 04-850-01
ELKO	37	51	30	5	LOT 3(NW4SW4)	APN 04-850-01
ELKO	37	51	31	20	NW4SE4; SE4NW4; E2SW4; NE4SE4	APN 04-850-01
ELKO	37	51	32	30	NE4NE4; W2NE4; N2S2; SE4SE4	APN 04-850-01
				6.74		
ELKO	37	52	2	25	LOT 2(NW4NE4); SW4NE4; SE4NW4; N2SW4;	APN 05-100-02
ELKO	37	52	2		SW4SW4; NW4SE4	
ELKO	37	52	3	20	SE4; N2SW4	APN 05-100-02
ELKO	37	52	4	30	SW4NE4; S2NW4; SW4; N2SE4	APN 05-100-02
ELKO	37	52	5	32	LOTS 1&2(N2NE4); S2NE4; SE4	APN 05-100-02
ELKO	37	52	7	16	S2S2	APN 05-100-02
ELKO	37	52	8	10	S2S2	APN 05-100-02
ELKO	37	52	9	40	NW4; SE4; S2SW4	APN 05-100-02
ELKO	37	52	10	40	E2NE4; S2	APN 05-100-02
ELKO	37	52	11	40	NW4NW4; W2SW4; SW4NW4; NW4SE4	APN 05-100-02
ELKO	37	52	18	40	W2E2	APN 05-100-02
ELKO	37	52	19	40	W2NE4; S2NW4; N2SW4; SE4	APN 05-100-02
				3.28		
ELKO	37	53	5	33	LOT 1(NE4NE4)	APN 05-320-02
				.83		

South Fork Corp. Legal Descriptions

NEVADA COUNTY NAME	TOWN SHIP NO.	RANGE EAST	SEC. NO.	ACRES	LEGAL DESCRIPTION	ASSESSOR'S PARCEL NUMBER
ELKO	38	49	1	32	S2NE4; N2NW4; SE4NW4; N2SE4; SE4SE4	APN 04-620-02
ELKO	38	49	2	4	NE4NE4	APN 04-620-02
ELKO	38	49	7	4	SE4NE4	APN 04-620-02
ELKO	38	49	8	16	S2N2	APN 04-620-02
ELKO	38	49	9	8	W2SW4	APN 04-620-02
ELKO	38	49	16	20	SW4SW4; W2NW4; E2SW4	APN 04-620-02
ELKO	38	49	17	8	SE4SE4; SE4SW4	APN 04-620-02
ELKO	38	49	19	7	LOT 4(SW4SW4); SE4SE4	APN 04-620-02
ELKO	38	49	21	16	W2NW4; NW4SW4; SE4SW4	APN 04-620-02
ELKO	38	49	22	12	NE4SE4; S2SE4	APN 04-620-02
ELKO	38	49	23	20	NW4SE4; S2SE4; N2SW4	APN 04-620-02
ELKO	38	49	24	4	SW4SW4	APN 04-620-02
ELKO	38	49	25	28	SW4NW4; NE4; N2NW4	APN 04-620-02
ELKO	38	49	26	12	SE4NE4; N2SW4	APN 04-620-02
ELKO	38	49	27	24	W2NE4; SE4NW4; NE4SW4; S2SW4	APN 04-620-02
ELKO	38	49	28	20	E2NW4; NW4SW4; S2SW4	APN 04-620-02
ELKO	38	49	29	8	SE4SE4; NE4SW4	APN 04-620-02
ELKO	38	49	30	4	NE4SE4	APN 04-620-02
ELKO	38	49	31	3	LOT 1(NW4NW4)	APN 04-620-02
ELKO	38	49	32	24	E2NE4; SE4NW4; S2SE4; NE4SW4	APN 04-620-02
ELKO	38	49	33	12	NE4SE4; S2SE4	APN 04-620-02
ELKO	38	49	34	28	W2W2; NE4SE4; S2SE4	APN 04-620-02
ELKO	38	49	35	24	SW4NE4; N2S2; SW4SW4	APN 04-620-02
ELKO	38	49	36	16	N2S2	APN 04-620-02
				3.53		
ELKO	38	50	3	6	ALL	APN 04-740-01
ELKO	38	50	4	6	ALL	APN 04-740-01
ELKO	38	50	5	3	LOTS 1,2,3&4(N2N2); SE4NE4; SE4; SE4SW4	APN 04-740-01
ELKO	38	50	6	7	SW4SW4	APN 04-740-01
ELKO	38	50	7	3	N2NW4; SE4NW4; SE4; NE4SW4	APN 04-740-01
ELKO	38	50	8	5	NE4; E2NW4; S2	APN 04-740-01
ELKO	38	50	9	6	ALL	APN 04-740-01
ELKO	38	50	10	6	ALL	APN 04-740-01
ELKO	38	50	15	6	ALL	APN 04-740-01
ELKO	38	50	16	6	ALL	APN 04-740-01
ELKO	38	50	17	6	ALL	APN 04-740-01
ELKO	38	50	18	3	E2	APN 04-740-01
ELKO	38	50	19	4	E2; E2SW4	APN 04-740-01
ELKO	38	50	20	6	ALL	APN 04-740-01
ELKO	38	50	21	6	ALL	APN 04-740-01
ELKO	38	50	22	6	ALL	APN 04-740-01
ELKO	38	50	27	3	N2NE4; SW4NE4; NW4; NW4SW4	APN 04-740-01
ELKO	38	50	28	5	N2; NW4SE4; SW4	APN 04-740-01
ELKO	38	50	29	6	ALL	APN 04-740-01
ELKO	38	50	30	6	ALL	APN 04-740-01
ELKO	38	50	31	7	N2; N2S2	APN 04-740-01
ELKO	38	50	32	4	N2; N2S2	APN 04-740-01
				11.49		
ELKO	38	51	6	2	N2; SE4; N2SW4; SW4SW4	APN 04-860-02
ELKO	38	51	7	3	N2NE4; SE4NE4; NW4; SE4SW4; SE4	APN 04-860-02
ELKO	38	51	18	9	NE4; SE4NW4; E2SE4; SW4	APN 04-860-02
ELKO	38	51	19	7	SE4SE4; E2NE4; SE4NW4; N2SE4; SE4SW4;	APN 04-860-02
ELKO	38	51	19		LOTS 1&2(W2NW4); LOT 4(SW4SW4)	
ELKO	38	51	20	0	S2S2	APN 04-860-02

South Fork Corp. Legal Descriptions

NEVADA COUNTY NAME	TOWN SHIP NO.	RANGE EAST	SEC. NO.	ACRES	LEGAL DESCRIPTION	ASSESSOR'S PARCEL NUMBER
ELKO	38	51	21	80.1	S2SE4	APN 04-860-02
ELKO	38	51	22	40.1	SW4SE4	APN 04-860-02
ELKO	38	51	23	80.1	S2SW4	APN 04-860-02
ELKO	38	51	25	640.1	N2; S2	APN 04-860-02
ELKO	38	51	26	640.1	N2N2; S2N2; S2	APN 04-860-02
ELKO	38	51	27	480.1	N2; N2S2	APN 04-860-02
ELKO	38	51	28	400.1	NE4NE4; NW4NE4; S2NE4; NW4; N2SE4	APN 04-860-02
ELKO	38	51	29	240.1	NE4; N2NW4	APN 04-860-02
ELKO	38	51	30	427.1	W2; NE4NE4; W2NE4	APN 04-860-02
ELKO	38	51	34	80.1	W2SW4	APN 04-860-02
ELKO	38	51	35	640.1	ALL	APN 04-860-02
ELKO	38	51	36	640.1	ALL	APN 04-860-02
				6.425		
ELKO	38	52	1	200.1	LOT 1(NE4NE4); SE4NE4; N2SE4; SW4SE4	APN 05-110-01
ELKO	38	52	2	320.1	LOT 4(NW4NW4); SE4NW4; SW4; S2SE4	APN 05-110-01
ELKO	38	52	4	480.1	S2N2; S2	APN 05-110-01
ELKO	38	52	5	75.1	LOTS 1&2(N2NE4)	APN 05-110-01
ELKO	38	52	6	300.1	LOT 3(NE4NW4); LOTS 4,5,6&7(W2W2); SE4NW4; E2SW4	APN 05-110-01
ELKO	38	52	7	200.1	NE4; NE4NW4	APN 05-110-01
ELKO	38	52	8	200.1	SW4NW4; SW4	APN 05-110-01
ELKO	38	52	9	640.1	ALL	APN 05-110-01
ELKO	38	52	10	640.1	ALL	APN 05-110-01
ELKO	38	52	11	640.1	ALL	APN 05-110-01
ELKO	38	52	12	120.1	W2NE4; SW4SE4	APN 05-110-01
ELKO	38	52	13	440.1	NW4NE4; S2N2; N2S2; SE4SW4; SW4SE4	APN 05-110-01
ELKO	38	52	14	280.1	N2NE4; SE4NE4; SE4NW4; N2SW4; SW4SW4	APN 05-110-01
ELKO	38	52	15	400.1	NE4; SW4; E2NW4	APN 05-110-01
ELKO	38	52	15	240.1	W2NW4; SE4	APN 05-110-01
ELKO	38	52	16	320.1	SW4NE4; N2NW4; SE4NW4; NE4SW4; S2SW4; NW4SE4	APN 05-110-01
ELKO	38	52	17	480.1	W2NE4; S2SE4; W2	APN 05-110-01
ELKO	38	52	18	40.1	SE4SE4	APN 05-110-01
ELKO	38	52	19	310.1	NW4NE4; SE4NW4; NE4SW4; LOT 4(SW4SW4); SE4	APN 05-110-01
ELKO	38	52	20	480.1	E2NW4; NW4SE4; SW4SE4; S2SW4; W2NW4; N2SW4; E2SE4	APN 05-110-01
ELKO	38	52	21	80.1	W2NW4	APN 05-110-01
ELKO	38	52	24	440.1	W2E2; E2W2; W2NW4; NW4SW4	APN 05-110-01
ELKO	38	52	25	360.1	SE4SE4; W2E2; E2W2	APN 05-110-01
ELKO	38	52	25	520.1	SW4NE4; NW4; S2	APN 05-110-01
ELKO	38	52	27	240.1	N2NW4; SE4NW4; SW4NE4; N2SE4	APN 05-110-01
ELKO	38	52	29	320.1	E2NW4; NE4SW4; SW4SW4; W2NW4; NW4SW4; SE4SW4	APN 05-110-01
ELKO	38	52	30	420.1	LOTS 1&2(W2NW4); LOT 4(SW4SW4); E2	APN 05-110-01
ELKO	38	52	31	350.1	N2SE4; W2NE4; N2SW4; S2S2	APN 05-110-01
ELKO	38	52	32	320.1	W2SE4; E2SE4; SW4	APN 05-110-01
ELKO	38	52	33	80.1	S2NW4	APN 05-110-01
ELKO	38	52	34	160.1	N2N2	APN 05-110-01
ELKO	38	52	35	520.1	N2; NE4SW4; SE4	APN 05-110-01
ELKO	38	52	36	520.1	N2NE4; SW4NE4; W2; N2SE4	APN 05-110-01
				11.25		
ELKO	38	53	17	20.1	W2NW4	APN 05-330-02
ELKO	38	53	32	20.1	NE4NE4; SW4NE4	APN 05-330-02
ELKO	38	53	33	40.1	SE4SW4; SW4SE4; N2NE4; NW4; N2SW4	APN 05-330-02
ELKO	38	53	34	20.1	NW4NW4	APN 05-330-02
				60		
ELKO	39	49	8	20.1	SE4SE4	APN 04-630-03

South Fork Corp. Legal Descriptions

NEVADA COUNTY NAME	TOWN SHIP NO.	RANGE EAST	SEC. NO.	ACRES	LEGAL DESCRIPTION	ASSESSOR'S PARCEL NUMBER
ELKO	39	49	9	160.0	S2S2	APN 04-630-03
ELKO	39	49	10	160.0	S2S2	APN 04-630-03
ELKO	39	49	11	160.0	S2S2	APN 04-630-03
ELKO	39	49	12	80.0	S2SW4	APN 04-630-03
ELKO	39	49	13	240.0	S2NE4; NW4	APN 04-630-03
ELKO	39	49	14	240.0	NE4; E2NW4	APN 04-630-03
ELKO	39	49	15	200.0	N2NE4; E2SE4; NE4SW4	APN 04-630-03
ELKO	39	49	16	280.0	NW4NW4; SE4NW4; NW4SE4; S2SE4; NE4SW4; SW4SW4	APN 04-630-03
ELKO	39	49	17	160.0	E2E2	APN 04-630-03
ELKO	39	49	20	240.0	E2NE4; SE4	APN 04-630-03
ELKO	39	49	21	400.0	S2NE4; NE4NW4; SW4NW4; W2SE4; SW4	APN 04-630-03
ELKO	39	49	22	360.0	W2NW4; N2SE4; SE4SE4; SW4	APN 04-630-03
ELKO	39	49	23	160.0	S2S2	APN 04-630-03
ELKO	39	49	24	240.0	S2SE4; SW4	APN 04-630-03
ELKO	39	49	25	640.0	ALL	APN 04-630-03
ELKO	39	49	26	640.0	ALL	APN 04-630-03
ELKO	39	49	27	640.0	ALL	APN 04-630-03
ELKO	39	49	28	200.0	N2N2; SE4NE4	APN 04-630-03
ELKO	39	49	29	160.0	NE4	APN 04-630-03
ELKO	39	49	31	80.0	S2NE4	APN 04-630-03
ELKO	39	49	34	160.0	N2NE4; SE4NE4; NE4NW4	APN 04-630-03
ELKO	39	49	35	560.0	N2; SE4; N2SW4	APN 04-630-03
ELKO	39	49	36	640.0	ALL	APN 04-630-03
				6,840		
ELKO	39	50	7	150.0	S2S2	APN 04-750-02
ELKO	39	50	10	110.0	LOT 3(NE4SE4); W2SE4	APN 04-750-02
ELKO	39	50	15	300.0	SW4; W2SE4; LOTS 3&4(E2SE4)	APN 04-750-02
ELKO	39	50	16	280.0	W2W2; N2SE4; NE4SW4	APN 04-750-02
ELKO	39	50	17	640.0	ALL	APN 04-750-02
ELKO	39	50	18	590.0	N2; SE4; NE4SW4; S2SW4	APN 04-750-02
ELKO	39	50	19	500.0	N2; NW4SE4; SE4SE4; N2SW4; SW4SW4	APN 04-750-02
ELKO	39	50	20	240.0	NW4NW4; SE4; SE4SW4	APN 04-750-02
ELKO	39	50	21	640.0	E2SE4; N2; W2SE4; SW4	APN 04-750-02
ELKO	39	50	22	540.0	N2NW4; W2NE4; S2NW4; SW4; W2SE4; LOTS 1&2(E2NE4)	APN 04-750-02
ELKO	39	50	27	480.0	S2SW4; SW4SE4; NW4NE4; NW4; N2SW4; LOTS 3&4(E2SE4)	APN 04-750-02
ELKO	39	50	28	640.0	NE4NE4; S2NE4; SE4NW4; N2SW4; SW4SW4; NW4SE4;	APN 04-750-02
ELKO	39	50	28		NE4SE4; S2SE4; SE4SW4; NW4NE4; N2NW4; SW4NW4	
ELKO	39	50	29	600.0	SE4SE4; NE4NE4; NE4SE4; W2E2; W2	APN 04-750-02
ELKO	39	50	30	300.0	LOTS 1,2,3&4(W2W2); E2SW4; S2SE4	APN 04-750-02
ELKO	39	50	31	580.0	N2; SE4; NW4SW4; S2SW4	APN 04-750-02
ELKO	39	50	32	640.0	SW4NE4; SE4NW4; SE4NE4; SW4NW4; N2N2; S2	APN 04-750-02
ELKO	39	50	33	640.0	NW4NE4; NW4NW4; E2NE4; NE4NW4; SW4NW4;	APN 04-750-02
ELKO	39	50	33		SW4NE4; SE4NW4; S2	
ELKO	39	50	34	600.0	S2NE4; E2NW4; S2; NW4NE4; NW4NW4; SW4NW4;	APN 04-750-02
ELKO	39	50	34		LOT 1(NE4NE4)	
				8,507		
ELKO	39	51	36	100.0	E2E2	APN 04-870-03
				100		
ELKO	39	52	21	00	SE4SE4	APN 05-120-05
ELKO	39	52	22	400	E2NE4; SW4SW4; SE4SE4; E2W2; W2E2	APN 05-120-05
ELKO	39	52	23	400	NW4NE4; S2NE4; NE4NW4; SW4NW4; N2SE4; SW4SE4; S2SW4	APN 05-120-05
ELKO	39	52	24	100	S2S2	APN 05-120-05
ELKO	39	52	25	100	NE4SW4; S2SW4	APN 05-120-05

South Fork Corp. Legal Descriptions

NEVADA COUNTY NAME	TOWN SHIP NO.	RANGE EAST	SEC. NO.	ACRES	LEGAL DESCRIPTION	ASSESSOR'S PARCEL NUMBER
ELKO	39	52	26	160.1	NE4	APN 05-120-05
ELKO	39	52	26	80.1	E2SE4	APN 05-120-05
ELKO	39	52	28	240.1	NE4; NE4NW4; SE4SW4	APN 05-120-05
ELKO	39	52	29	40.1	NE4SE4	APN 05-120-05
ELKO	39	52	30	140.1	LOTS 1,2,3&4(W2W2)	APN 05-120-05
ELKO	39	52	31	298.1	LOTS 1,2,3&4(W2W2); SW4NE4; SE4NW4; E2SW4	APN 05-120-05
ELKO	39	52	32	240.1	SW4NE4; NW4SW4; S2S2	APN 05-120-05
ELKO	39	52	33	240.1	NE4NE4; S2NE4; N2SE4; SW4SE4	APN 05-120-05
ELKO	39	52	34	240.1	NW4; E2SE4	APN 05-120-05
ELKO	39	52	34	80.1	W2SE4	APN 05-120-05
ELKO	39	52	35	320.1	E2NE4; NW4; S2SW4	APN 05-120-05
ELKO	39	52	35	160.1	N2S2	APN 05-120-05
ELKO	39	52	36	640.1	ALL	APN 05-120-05
				4,079		
ELKO	39	53	30	80.1	SW4NE4; NE4NW4	APN 05-340-02
				80.1		
				71.651		

EXHIBIT C
To
Release Of Mining Lease
Dated January 29, 2001
By
Western States Minerals Corporation
And
26 Ranch Inc.

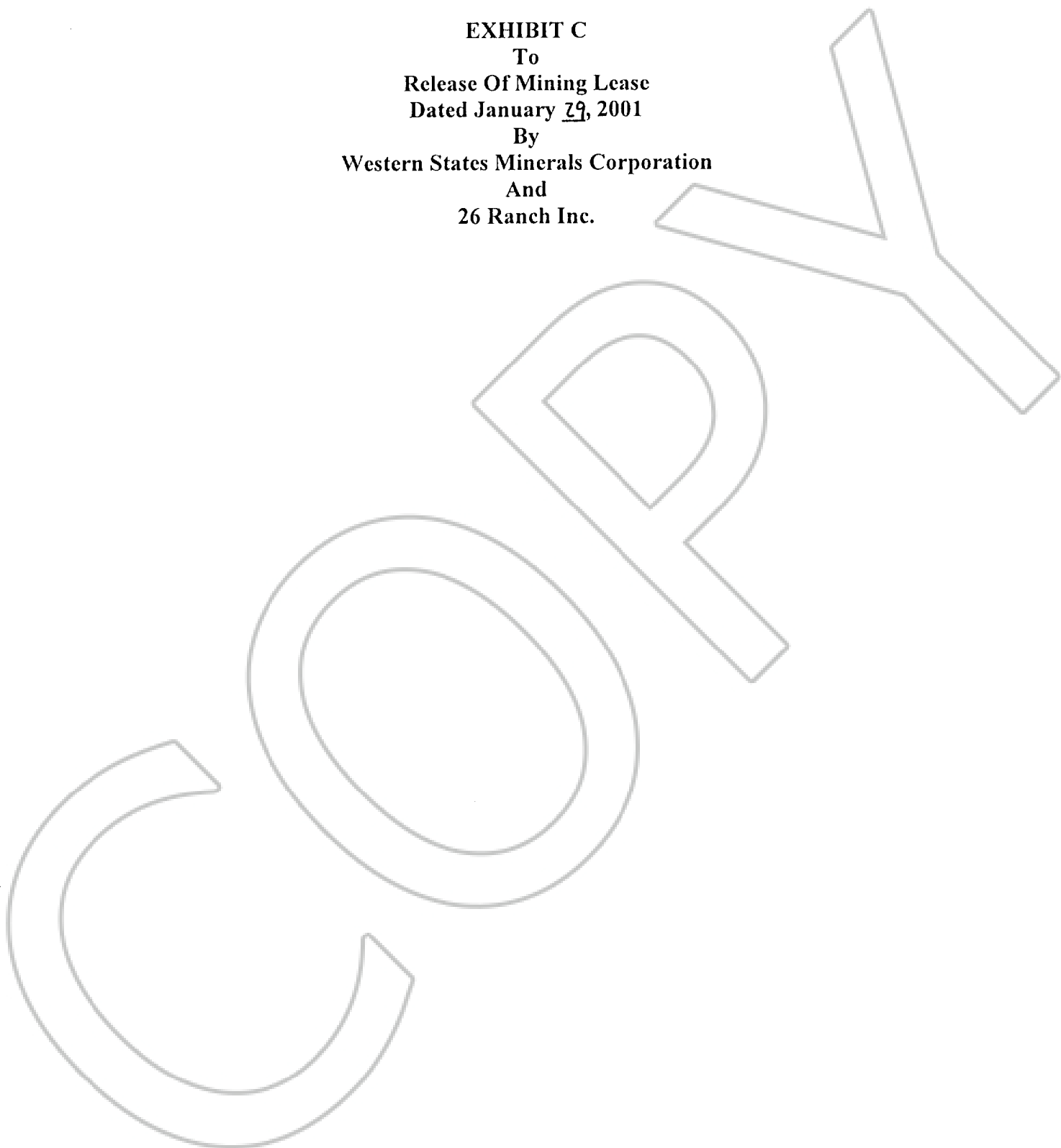
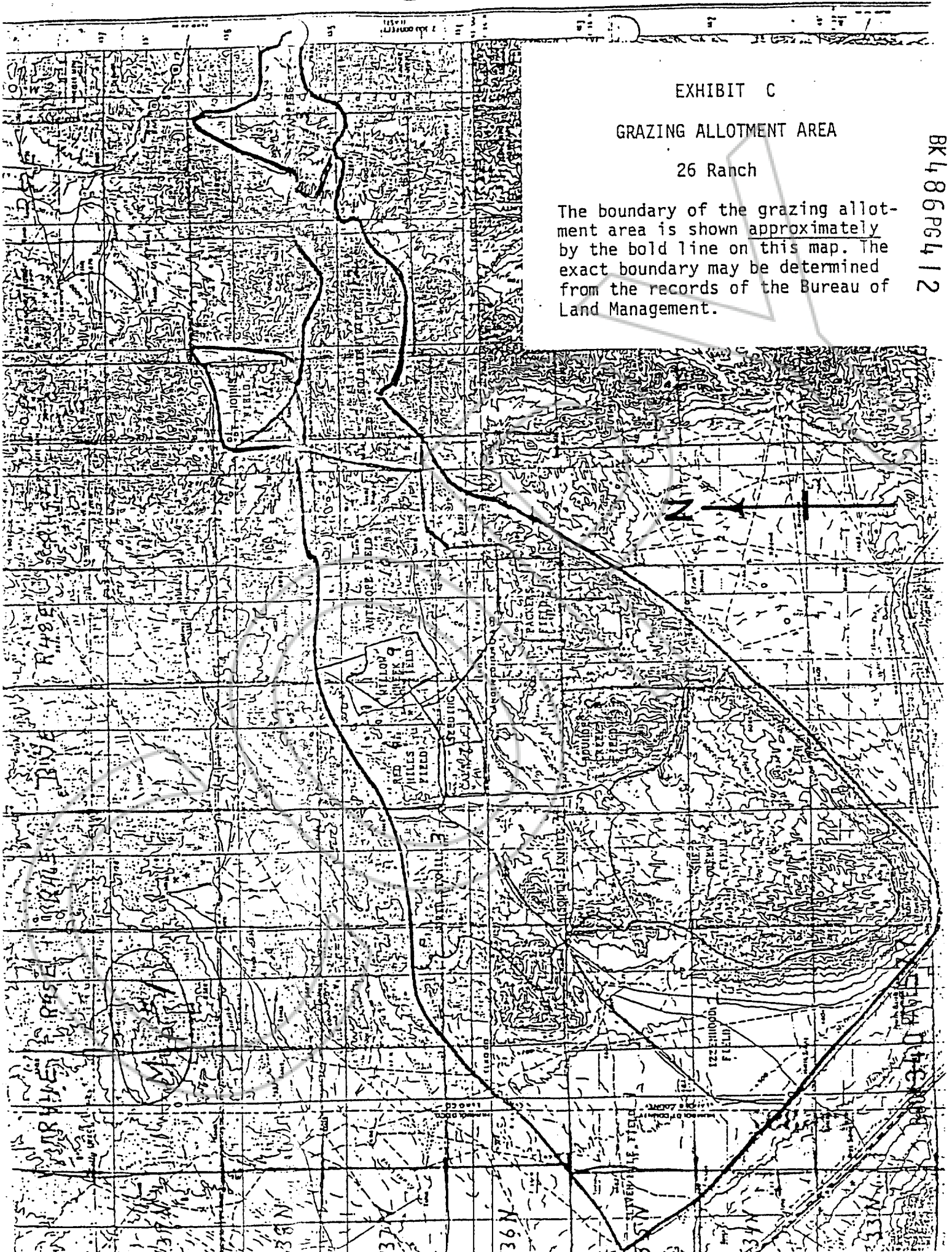

EXHIBIT C
GRAZING ALLOTMENT AREA
26 Ranch

The boundary of the grazing allotment area is shown approximately by the bold line on this map. The exact boundary may be determined from the records of the Bureau of Land Management.

BK486Pg412



COPY

BOOK 340 PA 556
OFFICIAL RECORD
RECORDED AT THE REGISTRY
Alfers & Carver LLC
01 MAR 28 PM 1:3
BUREAU COUNTY NEVA
M.N. REBALEATI, RECORDER
FILE NO. TS 2900

176397

218683

OFFICIAL RECORDS
LANDER CO. NEV
RECORD REQUESTED BY
Alfers & Carver LLC
01 FEB 26 PM 4: 00

IDONNA M. TREVINO
RECORDER

FEE 29.00 DEP *466*